

MUNICIPALITY OF ROCHESTER

PREPARED BY THE
MINNESOTA DEPARTMENT OF TRANSPORTATION
 OFFICE OF TRANSPORTATION SYSTEM MANAGEMENT
 IN COOPERATION WITH
U.S. DEPARTMENT OF TRANSPORTATION
 FEDERAL HIGHWAY ADMINISTRATION

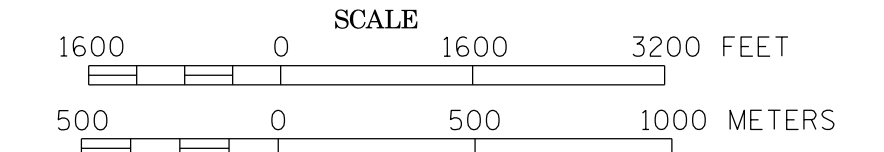

2015
 BASIC DATA - 2014

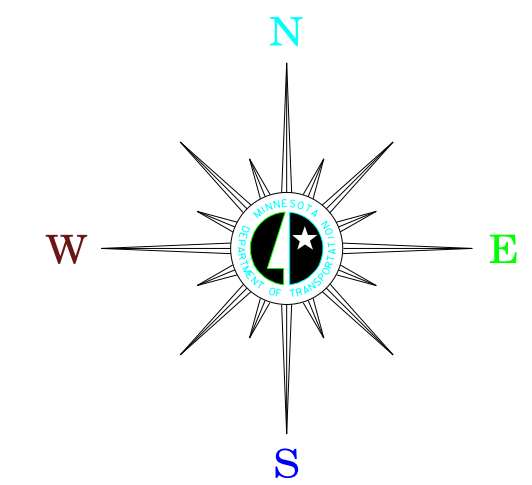

LEGEND

- INTERSTATE TRUNK HIGHWAY..... (I-35)
- U.S. TRUNK HIGHWAY..... (16)
- STATE TRUNK HIGHWAY..... (55)
- COUNTY STATE AID HIGHWAY..... (23)
- COUNTY ROAD..... (15)
- CORPORATE LIMITS.....
- PUBLIC ROAD.....
- PRIVATE ROAD.....

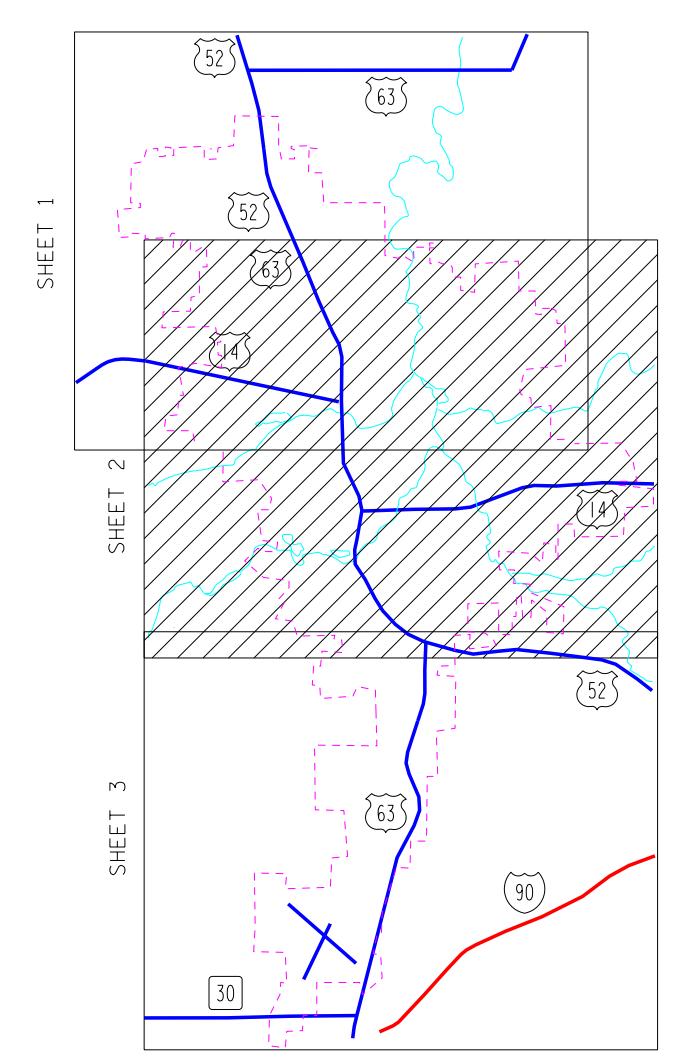
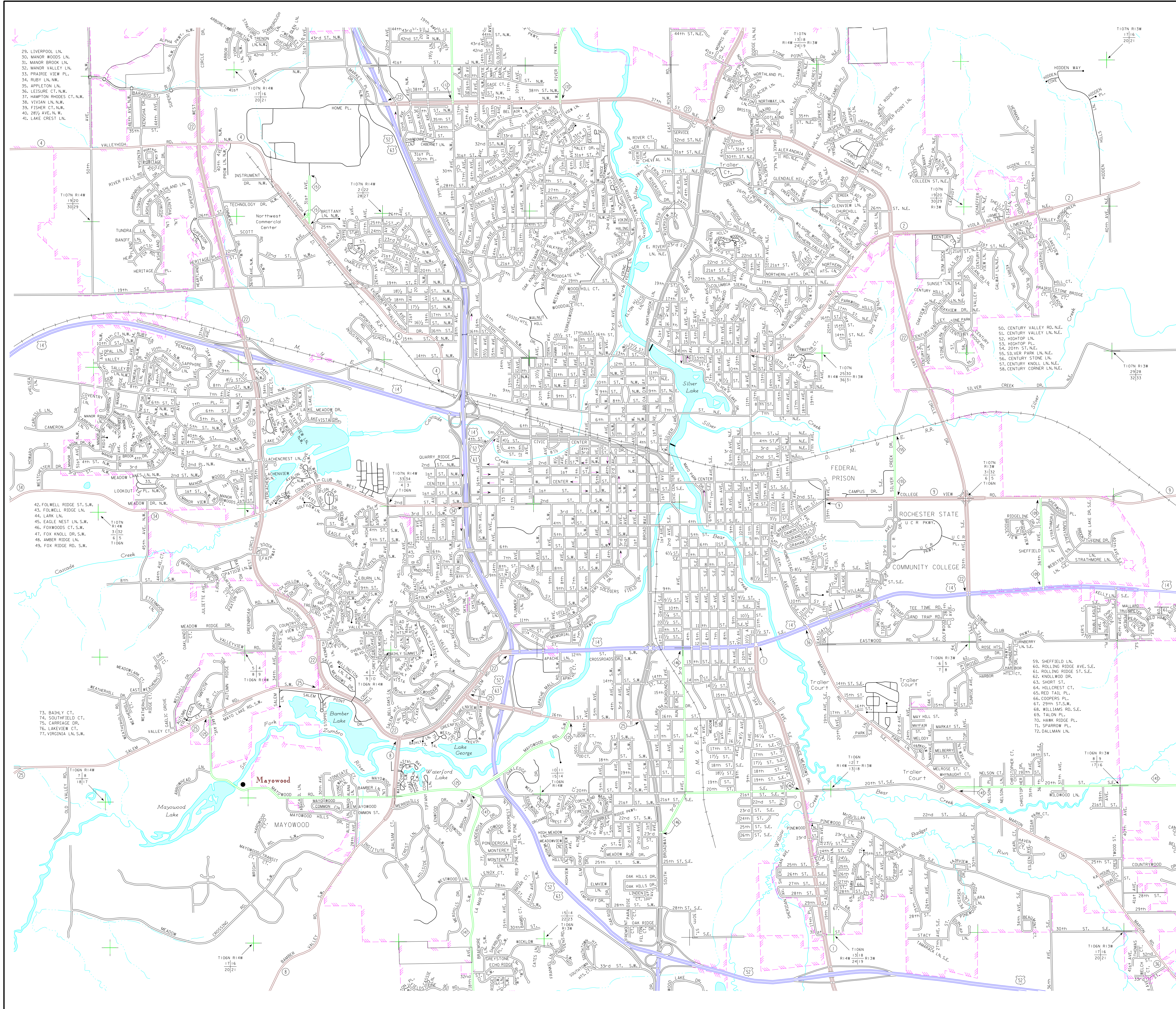

- 29. LIVERPOOL LN.
- 30. MANOR WOODS LN.
- 31. MANOR BROOK LN.
- 32. MANOR VALLEY LN.
- 33. PRAIRIE VIEW PL.
- 34. RUBY LN. NW.
- 35. APLETON LN. NW.
- 36. LEISURE CT. N.W.
- 37. HAMPTON WOODS CT. N.W.
- 38. VIVIAN LN. N.W.
- 39. FISHER CT. N.W.
- 40. 28 1/2 AVE. N. W.
- 41. LAKE CREST LN.

- 42. FOLWELL RIDGE ST. S.W.
- 43. FOLWELL RIDGE LN.
- 44. LARK LN.
- 45. EAGLE NEST LN. S.W.
- 46. FOXWOODS CT. S.W.
- 47. FOX KNOLL DR. S.W.
- 48. AMBER RIDGE LN.
- 49. FOX RIDGE RD. S.W.

- 73. BADLY CT.
- 74. SOUTHFIELD CT.
- 75. CARRIAGE DR.
- 76. LAKEVIEW CT.
- 77. VIRGINIA LN. S.W.