

MUNICIPALITY OF TROSKY

PREPARED BY THE
MINNESOTA DEPARTMENT OF TRANSPORTATION
OFFICE OF TRANSPORTATION SYSTEM MANAGEMENT

IN COOPERATION WITH
U.S. DEPARTMENT OF TRANSPORTATION
FEDERAL HIGHWAY ADMINISTRATION

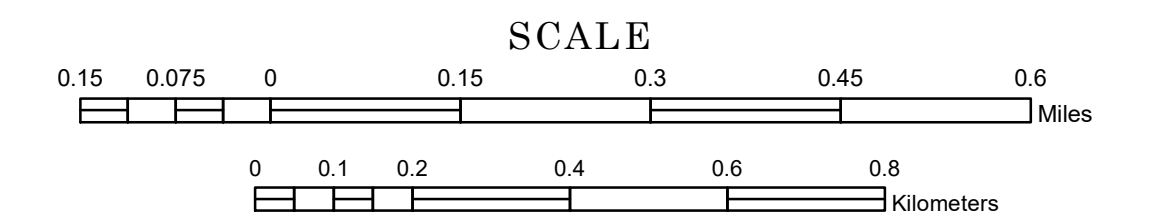

2023

Projection:
Transverse Mercator
NAD 1986
UTM Zone 15



North American Datum
of 1986

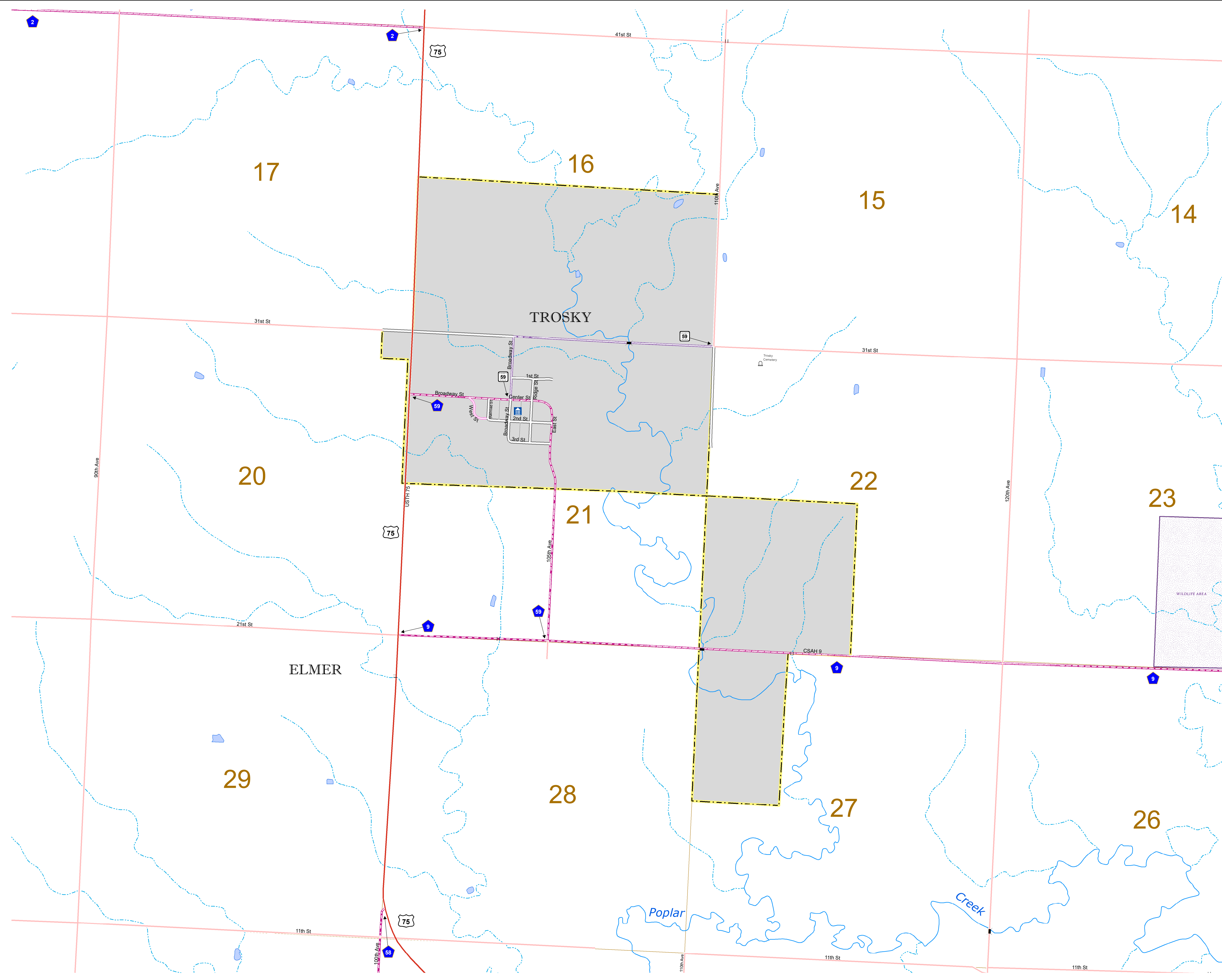

ROAD AND ROADWAY FEATURES	PUBLIC SERVICE FEATURES
INTERSTATE	MINDOT OFFICE
US HIGHWAY	MINDOT TRUCK STATION
STATE AID HIGHWAY	HIGHWAY PATROL DISTRICT OFFICE
COUNTY STATE AID HIGHWAY	STATE TRAVEL INFORMATION CENTER
COUNTY ROAD	REST AREA (Full Service)
MUNICIPAL STREET	REST AREA (Quick Turn)
MUNICIPAL STATE AID STREET	WAYSIDE (Only on Pkwy/Torq)
PRIVATE STREET/ROAD	PUBLIC ACCESS POINT
TOWNSHIP ROAD	LOCAL PARK
UNORGANIZED TERRITORY ROAD	FARMS/BOUNDS
RAMP OR CONNECTOR	PORT OF ENTRY
INTERSTATE EXIT	PARK AND RIDE LOT
GREAT RIVER ROAD	PUBLIC UNIVERSITY/COLLEGE
OTHER ROADS	PRIVATE UNIVERSITY/COLLEGE
FARMROAD	ELEMENTARY SCHOOL
STATE PARK	MIDDLE SCHOOL
NATIONAL PARK	HIGH SCHOOL
MONUMENT	AVIATION FEATURES
STATE FOREST	COMMERCIAL AIRPORT
NATIONAL FOREST	GENERAL AIRPORT
STATE GAME	AIRSTRIP
	SEAPLANE
	AIRPORT RUNWAY
RAILROAD AND RAILWAY FEATURES	CULTURAL FEATURES
EMPIRE BUILDER STATION (AMTRAK)	STATE HISTORICAL MARKER
NORTHWEST STATION (COMMUTER)	HISTORIC DISTRICT
LIGHT RAIL	HISTORIC SITE
BLUE LINE STATION	MONUMENT
GREEN LINE STATION	CEMETERY
INFRASTRUCTURE FEATURES	BOUNDARY FEATURES
LONG BRIDGE (100' OR GREATER SPAN)	TRIBAL LAND
MEDIUM BRIDGE (20' TO 100' SPAN)	COUNTY
MINOR BRIDGE (5' TO 20' SPAN)	MUNICIPALITY
ROAD TUNNEL (100' OR GREATER SPAN)	ADJACENT MUNICIPALITY
RAILROAD BRIDGE (100' OR GREATER SPAN)	FEDERAL ADJUSTED URBAN AREA (2014)
RAILROAD BRIDGE (LESSER 100' SPAN)	MILITARY
SKYWAY	STATE PARK
PEDESTRIAN BRIDGE	REGIONAL PARK
PEDESTRIAN TUNNEL	NATIONAL FOREST
DAM	NATIONAL AND STATE FOREST
LOCK AND DAM	STATE FOREST
PUBLIC FACILITIES	NATIONAL TRAIL
STATE CAPITOL	WILDLIFE REFUGE AREA
FEDERAL COURTHOUSE	WILDLIFE MANAGEMENT AREA
COUNTY COURTHOUSE	HYDROLOGIC FEATURES
ARMORY	RIVER OR STREAM (PERMANENT)
CITY HALL	LAKE, POND OR RESERVOIR
TOWN HALL	STREAM (INTERMITTENT)
COMMUNITY CENTER	DRAINAGE DITCH
ARENA	WETLAND
STADIUM	ISLAND OR LAND
POST OFFICE	REGIONAL WATERSHED
POLICE STATION	
FIRE STATION	
PUBLIC LIBRARY	
PUBLIC MUSEUM	
EVENT CENTER	
CITY CENTERS	
TRIBAL GOVERNMENT CENTER	
CITY CENTER	
LOCALLY INCORPORATED PLACE	
UNINCORPORATED COMMUNITY	

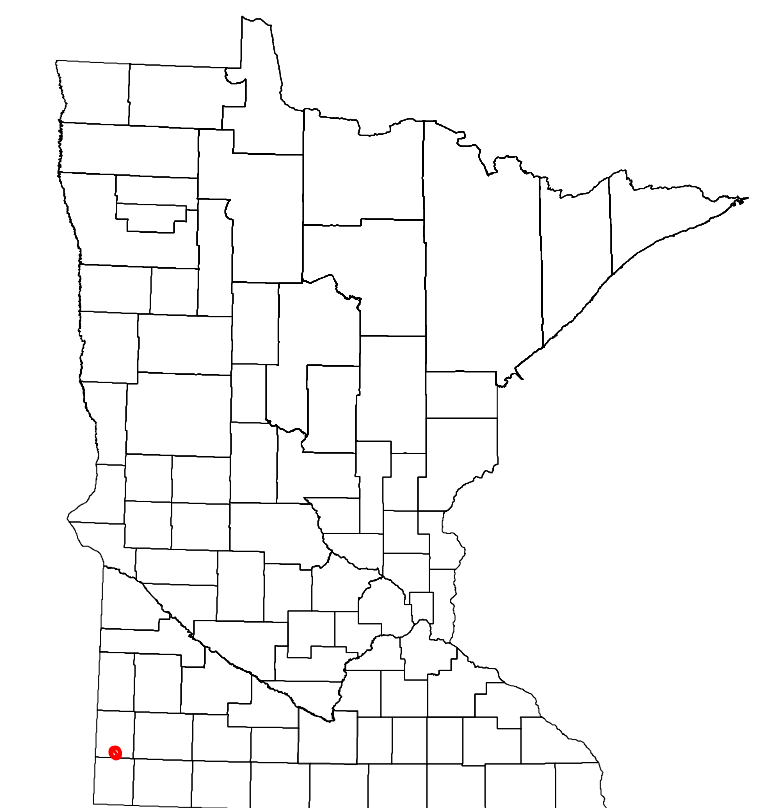

LAST EDITED ON 12-10-2023

Population (U.S. Census 2020): 98

To request information from this document in an alternative format, call 651-366-4718 or 1-800-657-3774 (Greater Minnesota); 711 or 1-800-627-3529 (Minnesota Relay). You may also send an e-mail to ADArequest.dot@state.mn.us. (Please request at least one week in advance.)