

STREET SERIES DULUTH

PREPARED BY THE
MINNESOTA DEPARTMENT OF TRANSPORTATION
OFFICE OF TRANSPORTATION SYSTEM MANAGEMENT

IN COOPERATION WITH
U.S. DEPARTMENT OF TRANSPORTATION
FEDERAL HIGHWAY ADMINISTRATION

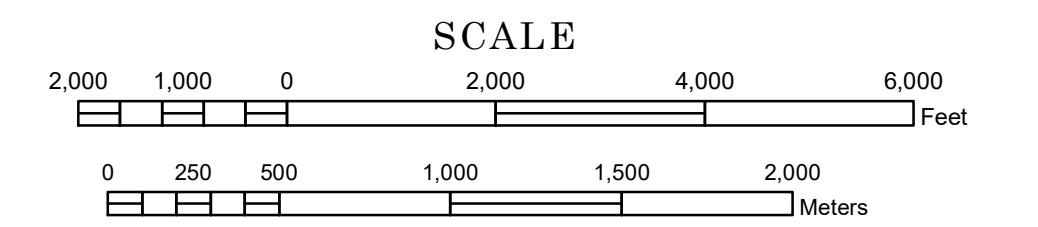

1 in = 1,840 ft

2022

Projection:
Transverse Mercator
NAD 1986
UTM Zone 15

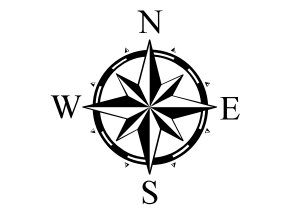

North American Datum
of 1986

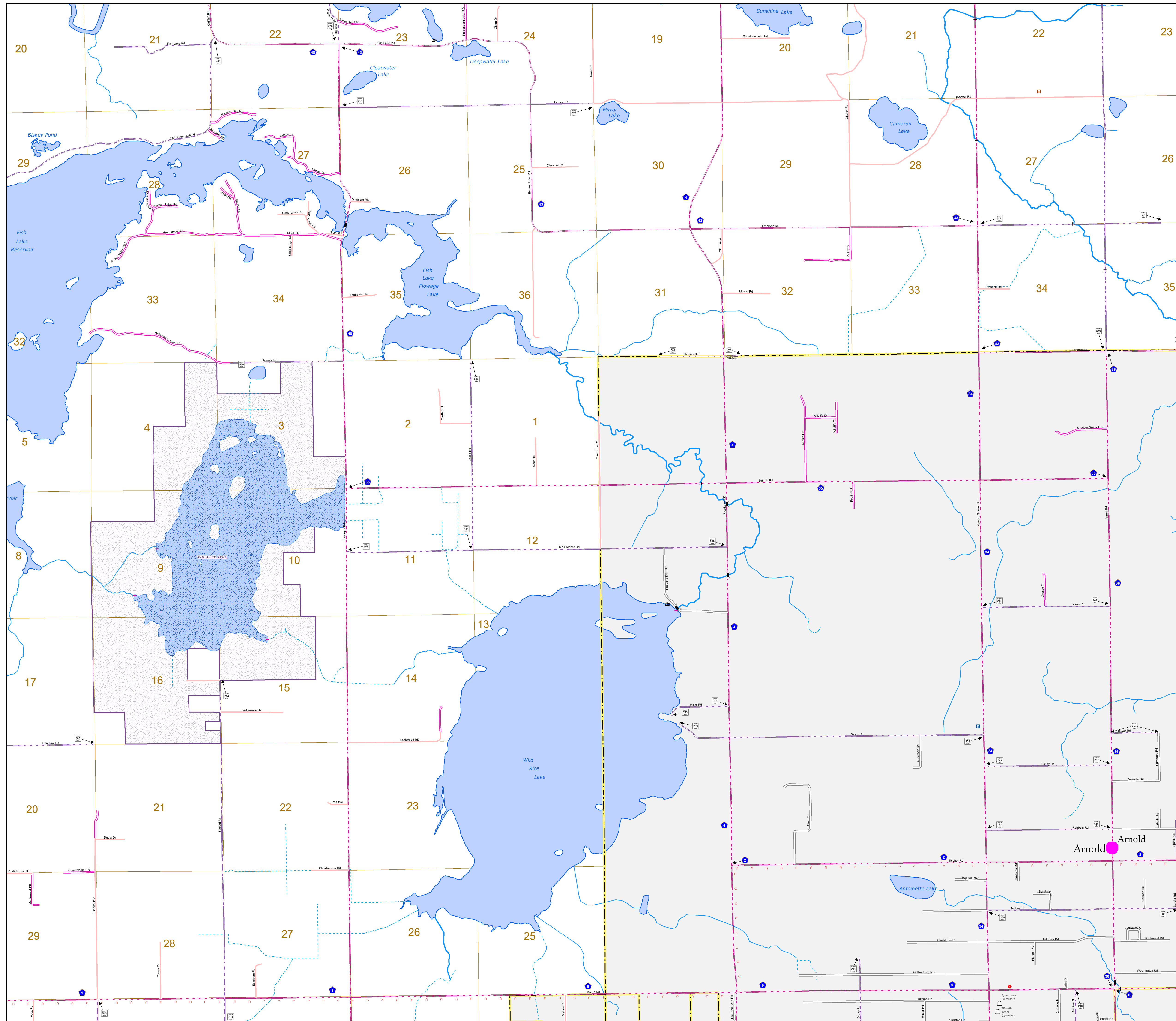

ROAD AND ROADWAY FEATURES		PUBLIC SERVICE FEATURES	
INTERSTATE		MINDOT OFFICE	
US HIGHWAY		MINDOT TRUCK STATION	
MN HIGHWAY		HIGHWAY PATROL DISTRICT OFFICE	
COUNTY STATE AID HIGHWAY		STATE TRAVEL INFORMATION CENTER	
COUNTY ROAD		REST AREA (Full Service)	
MUNICIPAL STATE AID STREET		REST AREA (Vault Toilet)	
MUNICIPAL STREET		WAYSIDE (Vault or Pit Toilet)	
PRIVATE STREET/ROAD		LOCAL PARK	
TOWNSHIP ROAD		PUBLIC ACCESS POINT	
UNORGANIZED TERRITORY ROAD		FAIRGROUNDS	
RAMP OR CONNECTOR		PORT OF ENTRY	
INTERSTATE EXIT		PARK AND RIDE LOT	
GREAT RIVER ROAD		MN STATE COLLEGE AND UNIVERSITY SYSTEM (MNSCU)	
OTHER ROADS		UNIVERSITY OF MN SYSTEM	
Farmhouse		CULTURAL FEATURES	
Shed		STATE HISTORICAL MARKER	
Home Service		HISTORIC DISTRICT	
Munitor		HISTORIC SITE	
AVIATION FEATURES		MONUMENT	
COMMERCIAL AIRPORT		BOUNDARY FEATURES	
GENERAL AIRPORT		TRIBAL LAND	
AIRSTRIP		COUNTY	
SEAPLANE		MUNICIPALITY	
AIRPORT RUNWAY		ADJACENT MUNICIPALITY	
RAILROAD AND RAILWAY FEATURES		FEDERAL ADJUSTED URBAN AREA (2014)	
RAILWAY		MILITARY	
EMPIRE BUILDER STATION (Active)		VOYAGEURS NATIONAL PARK	
NORTHSTAR STATION (Construction)		BOUNDARY WATERS CANOE AREA WILDERNESS	
LIGHT RAIL		STATE PARK	
BLUE LINE		REGIONAL PARK	
GREEN LINE		NATIONAL FOREST	
INFRASTRUCTURE FEATURES		NATIONAL AND STATE FOREST	
LONG BRIDGE (300' or Greater Span)		STATE FOREST	
MAJOR BRIDGE (20' to 300' Span)		NATIONAL TRAIL	
MINOR BRIDGE (5' to 20' Span)		WILDLIFE REFUGE AREA	
DAM		WILDLIFE MANAGEMENT AREA	
LOCK AND DAM		RIVER OR STREAM (Perennial)	
PUBLIC FACILITIES		LAKE, POND OR RESERVOIR	
STATE CAPITOL		STREAM (Intermittent)	
FEDERAL COURTHOUSE		DRAINAGE DITCH	
COUNTY COURTHOUSE		HYDROLOGIC FEATURES	
ARMORY		WETLAND	
CITY CENTERS		ISLAND OR LAND	
TRIBAL GOVERNMENT CENTER		REGIONAL WATERSHED	
CITY CENTER			
LOCALLY KNOWN PLACE			
UNINCORPORATED COMMUNITY			