

# TOWNSHIP OF SHOOKS

PREPARED BY THE  
MINNESOTA DEPARTMENT OF TRANSPORTATION  
OFFICE OF TRANSPORTATION SYSTEM MANAGEMENT

IN COOPERATION WITH  
U.S. DEPARTMENT OF TRANSPORTATION  
FEDERAL HIGHWAY ADMINISTRATION

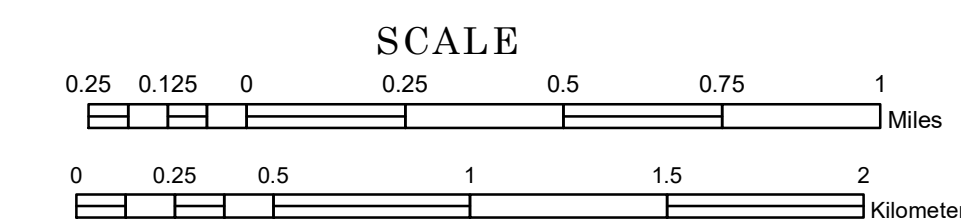

2022

Projection:  
Transverse Mercator  
NAD 1986  
UTM Zone 15

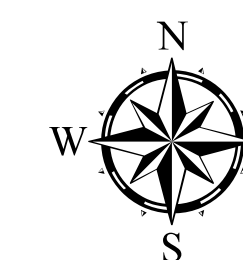

North American Datum  
of 1986

ROAD AND ROADWAY FEATURES		AVIATION FEATURES	
INTERSTATE	CONCRETE	COMMERCIAL AIRPORT	GENERAL AIRPORT
US HIGHWAY	BITUMINOUS	AIRSTRIP	SEAPLANE
MN HIGHWAY	GRAVEL	AIRPORT RUNWAY	BOUNDARY FEATURES
COUNTY STATE AID HIGHWAY	DIRT/UNIMPROVED	TRIAL LAND	TRIBAL LAND
COUNTY ROAD	OTHER	STATE OF MINNESOTA	COUNTY
TOWNSHIP ROAD	UNKNOWN	MUNICIPALITY	MUNICIPALITY
UNORGANIZED TERRITORY ROAD		UNORGANIZED TERRITORY	FEDERAL ADJUSTED URBAN AREA (2014)
OTHER ROADS		CIVIL TOWNSHIP	CIVIL TOWNSHIP
Municipal	RAMP OR CONNECTOR	CONGRESSIONAL TOWNSHIP	SECTION
Private	INTERSTATE EXIT	MILITARY	MILITARY
Nature Service	RAILROAD AND RAILWAY FEATURES	VOYAGEURS NATIONAL PARK	BOUNDARY NATIONAL PARK
Muslim	EMPIRE BUILDER STATION (AMTRAK)	STATE PARK	STATE PARK
	NORTHSTAR STATION (COMPUTER)	NATIONAL FOREST	NATIONAL FOREST
	LIGHT RAIL	STATE FOREST	NATIONAL AND STATE FOREST
	BLUE LINE	WILDLIFE REFUGUE AREA	WILDLIFE REFUGUE AREA
	GREEN LINE	WILDLIFE MANAGEMENT AREA	WILDLIFE MANAGEMENT AREA
	INFRASTRUCTURE FEATURES	HYDROLOGIC FEATURES	HYDROLOGIC FEATURES
	LONG BRIDGE (200' OR GREATER SPAN)	LAKE, POND OR RESERVOIR	LAKE, POND OR RESERVOIR
	MAJOR BRIDGE (20' TO 200' SPAN)	STREAM (INTERMITTENT)	STREAM (INTERMITTENT)
	MINOR BRIDGE (5' TO 20' SPAN)	DRAINAGE DITCH	DRAINAGE DITCH
	DAM	WETLAND	WETLAND
	LOCK AND DAM	ISLAND OR LAND	ISLAND OR LAND
	CITY CENTERS	REGIONAL WATERSHED	REGIONAL WATERSHED
	STATE CAPITAL		
	COUNTY SEAT		
	CITY CENTER		
	UNINCORPORATED COMMUNITY		
	PUBLIC SERVICE FEATURES		
	MNDOT OFFICE		
	MNDOT TRUCK STATION		
	HIGHWAY PATROL DISTRICT OFFICE		
	STATE TRAVEL INFORMATION CENTER		
	REST AREA (FULL SERVICE)		
	REST AREA (VAULT TOILET)		
	WAYSIDE (VAULT OR PIT TOILET)		
	PARK AND RIDE LOT		
	PORT OF ENTRY		
	PUBLIC ACCESS POINT		
	MN STATE COLLEGE AND UNIVERSITY SYSTEM (MNSCU)		
	UNIVERSITY OF MN SYSTEM		
	FAIRGROUNDS		
	CULTURAL FEATURES		
	STATE HISTORICAL MARKER		
	HISTORIC DISTRICT		
	HISTORIC SITE		
	MONUMENT		

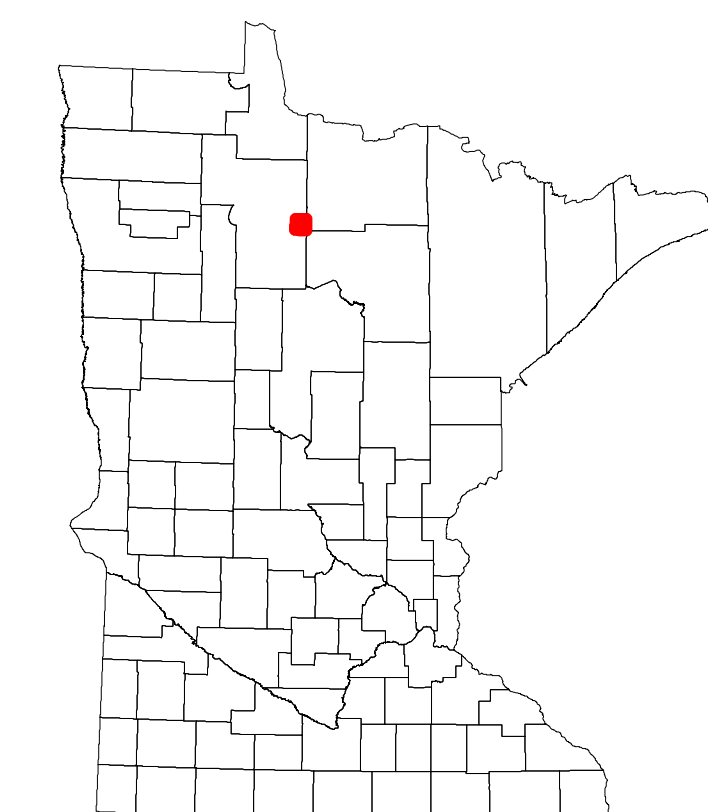

Population (U.S. Census 2010): 189

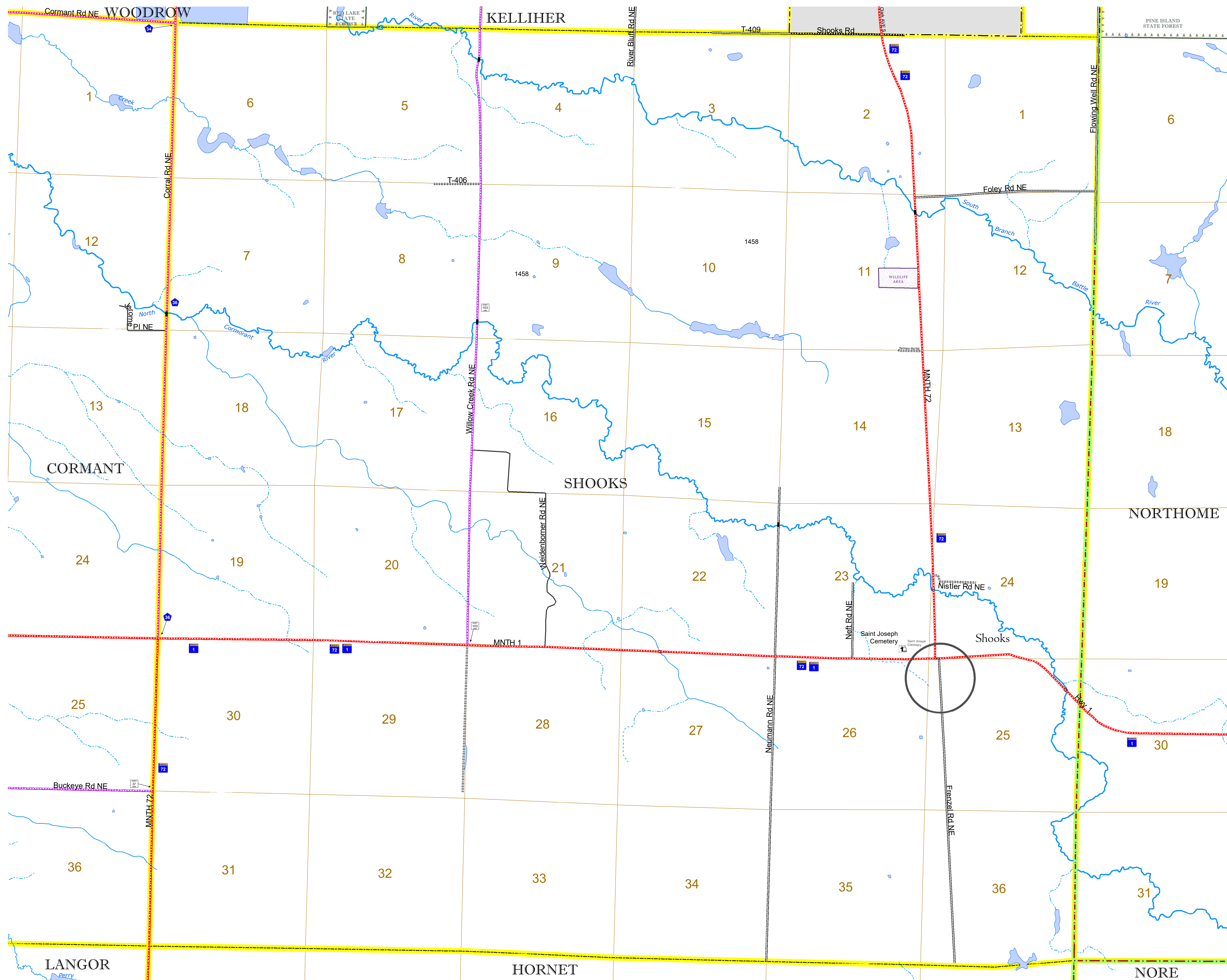

To request information from this document in an alternative format, call 651-366-4718 or 1-800-657-3774 (Greater Minnesota); 711 or 1-800-627-3529 (Minnesota Relay). You may also send an e-mail to ADAREquest.dot@state.mn.us. (Please request at least one week in advance.)