

TOWNSHIP OF LINDEN

PREPARED BY THE
MINNESOTA DEPARTMENT OF TRANSPORTATION
OFFICE OF TRANSPORTATION SYSTEM MANAGEMENT

IN COOPERATION WITH
U.S. DEPARTMENT OF TRANSPORTATION
FEDERAL HIGHWAY ADMINISTRATION



1 in = 1,600 ft
2023

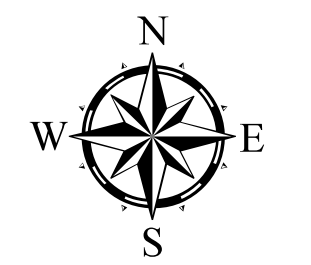

Projection:
Transverse Mercator
NAD 1986
UTM Zone 15

North American Datum
of 1986

ROAD AND ROADWAY FEATURES	BOUNDARY FEATURES
INTERSTATE	CONCRETE
US HIGHWAY	BITUMINOUS
MN HIGHWAY	GRAVEL
COUNTY STATE AID HIGHWAY	DIRT/UNIMPROVED
COUNTY ROAD	OTHER
TOWNSHIP ROAD	UNKNOWN
UNORGANIZED TERRITORY ROAD	
OTHER ROADS	RAMP OR CONNECTOR
Municipal	Private
National Monument	State Forest
National Park	National Wildlife Refuge
National Forest	State Park
Preserve	
RAILROAD AND RAILWAY FEATURES	AVIATION FEATURES
EMPIRE BUILDER STATION (AMTRAK)	COMMERCIAL AIRPORT
NORTHSTAR STATION (COMPUTER)	GENERAL AIRPORT
	AIRSTRIP
	SEAPLANE
	AIRPORT RUNWAY
INFRASTRUCTURE FEATURES	BOUNDARY FEATURES
LONG BRIDGE (200' or Greater Span)	TRIBAL LAND
MAJOR BRIDGE (20' to 200' Span)	STATE OF MINNESOTA
MINOR BRIDGE (5' to 20' Span)	COUNTY
DAM	MUNICIPALITY
LOCK AND DAM	UNORGANIZED TERRITORY
	FEDERAL ADJUSTED URBAN AREA (2014)
	CIVIL TOWNSHIP
	CONGRESSIONAL TOWNSHIP
CITY CENTERS	UNINCORPORATED COMMUNITY
STATE CAPITAL	COUNTY SEAT
	CITY CENTER
	COMMUNITY
PUBLIC SERVICE FEATURES	MILITARY
MNDOT OFFICE	VOYAGEURS NATIONAL PARK
MNDOT TRUCK STATION	BOUNDARY WATERS CANOE AREA WILDERNESS
HIGHWAY PATROL DISTRICT OFFICE	STATE PARK
STATE TRAVEL INFORMATION CENTER	REGIONAL PARK
REST AREA (Full Service)	NATIONAL FOREST
REST AREA (Vault Toilet)	NATIONAL AND STATE FOREST
WAYSIDE (Vault or Potty Toilet)	STATE FOREST
PARK AND RIDE LOT	NATIONAL TRAIL
PORT OF ENTRY	WILDLIFE REFUGUE AREA
PUBLIC ACCESS POINT	WILDLIFE MANAGEMENT AREA
MN STATE COLLEGE AND UNIVERSITY SYSTEM (MNSCU)	HYDROLOGIC FEATURES
UNIVERSITY OF MN SYSTEM	RIVER OR STREAM (PERENNIAL)
FAIRGROUNDS	LAKE, POND OR RESERVOIR
	STREAM (INTERMITTENT)
CULTURAL FEATURES	DRAINAGE DITCH
STATE HISTORICAL MARKER	WETLAND
HISTORIC DISTRICT	ISLAND OR LAND
HISTORIC SITE	REGIONAL WATERSHED
MONUMENT	

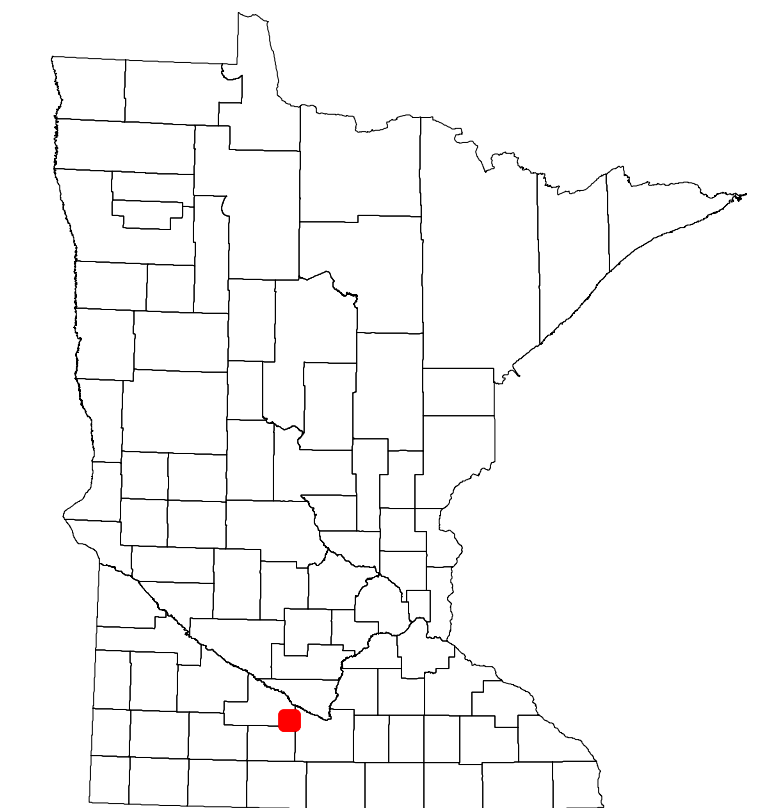

Population (U.S. Census 2010): 295

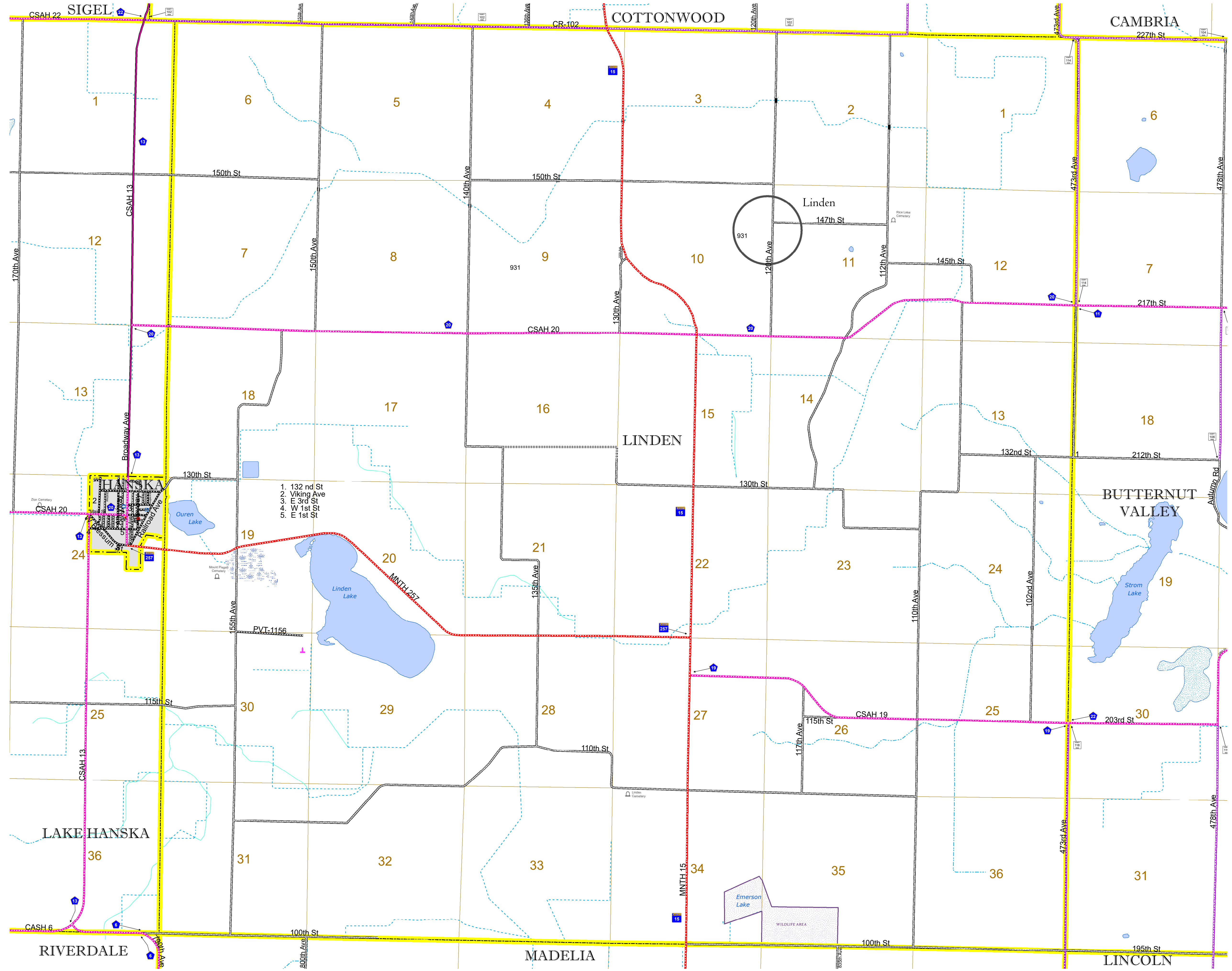

1. 132 nd St
2. Viking Ave
3. E 3rd St
4. W 1st St
5. E 1st St

To request information from this document in an alternative format, call 651-366-4718 or 1-800-657-3774 (Greater Minnesota); 711 or 1-800-627-3529 (Minnesota Relay). You may also send an e-mail to ADRequest.dot@state.mn.us. (Please request at least one week in advance.)