

TOWNSHIP OF HOLY CROSS

PREPARED BY THE
MINNESOTA DEPARTMENT OF TRANSPORTATION
OFFICE OF TRANSPORTATION SYSTEM MANAGEMENT

IN COOPERATION WITH
U.S. DEPARTMENT OF TRANSPORTATION
FEDERAL HIGHWAY ADMINISTRATION

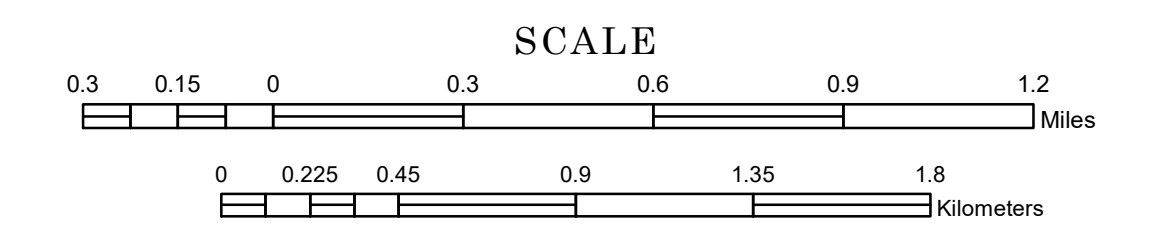

1 in = 1,600 ft

2023

Projection:
Transverse Mercator
NAD 1986
UTM Zone 15

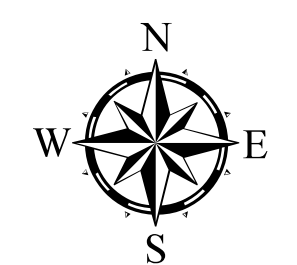

North American Datum
of 1986

ROAD AND ROADWAY FEATURES		AVIATION FEATURES	
INTERSTATE	CONCRETE	COMMERCIAL AIRPORT	TRIAL LAND
US HIGHWAY	BITUMINOUS	GENERAL AIRPORT	STATE OF MINNESOTA
MN HIGHWAY	GRAVEL	AIRSTRIP	COUNTY
COUNTY STATE AID HIGHWAY	DIRT/UNIMPROVED	SEAPLANE	MUNICIPALITY
COUNTY ROAD	OTHER	AIRPORT RUNWAY	UNORGANIZED TERRITORY
TOWNSHIP ROAD	UNKNOWN		FEDERAL ADJUSTED URBAN AREA (2014)
UNORGANIZED TERRITORY ROAD			CIVIL TOWNSHIP
OTHER ROADS			CONGRESSIONAL TOWNSHIP
Municipal	RAMP OR CONNECTOR		SECTION
Private	INTERSTATE EXIT		MILITARY
National Monument	GREAT RIVER ROAD		VOYAGEUR'S NATIONAL PARK
Nature Service			BOUNDARY WATERS CANOE AREA WILDERNESS
Mulden			STATE PARK
			REGIONAL PARK
RAILROAD AND RAILWAY FEATURES		BOUNDARY FEATURES	
EMPIRE BUILDER STATION (AMTRAK)	COMMERCIAL AIRPORT		NATIONAL FOREST
NORTHSTAR STATION (COMMITTEE)	GENERAL AIRPORT		NATIONAL AND STATE FOREST
LIGHT RAIL	AIRSTRIP		STATE FOREST
BLUE LINE	SEAPLANE		NATIONAL TRAIL
GREEN LINE	AIRPORT RUNWAY		WILDLIFE REFUGE AREA
			WILDLIFE MANAGEMENT AREA
INFRASTRUCTURE FEATURES		HYDROLOGIC FEATURES	
LONG BRIDGE (200' OR GREATER SPAN)	TRIAL LAND		RIVER OR STREAM (PERMANENT)
MAJOR BRIDGE (20' TO 200' SPAN)	STATE OF MINNESOTA		LAKE, POND OR RESERVOIR
MINOR BRIDGE (5' TO 20' SPAN)	COUNTY		STREAM (INTERMITTENT)
DAM	MUNICIPALITY		DRAINAGE DITCH
LOCK AND DAM	UNORGANIZED TERRITORY		WETLAND
	FEDERAL ADJUSTED URBAN AREA (2014)		ISLAND OR LAND
	CIVIL TOWNSHIP		REGIONAL WATERSHED
	CONGRESSIONAL TOWNSHIP		
CITY CENTERS			
STATE CAPITAL	SECTION		
COUNTY SEAT	MILITARY		
CITY CENTER	VOYAGEUR'S NATIONAL PARK		
UNINCORPORATED COMMUNITY	BOUNDARY WATERS CANOE AREA WILDERNESS		
	STATE PARK		
PUBLIC SERVICE FEATURES			
MNDOT OFFICE	REGIONAL PARK		
MNDOT TRUCK STATION	NATIONAL FOREST		
HIGHWAY PATROL DISTRICT OFFICE	NATIONAL AND STATE FOREST		
STATE TRAVEL INFORMATION CENTER	STATE FOREST		
REST AREA (FULL SERVICE)	NATIONAL TRAIL		
REST AREA (VAULT TOILET)	WILDLIFE REFUGE AREA		
WAYSIDE (VAULT OR PIT TOILET)	WILDLIFE MANAGEMENT AREA		
PARK AND RIDE LOT	RIVER OR STREAM (PERMANENT)		
PORT OF ENTRY	LAKE, POND OR RESERVOIR		
PUBLIC ACCESS POINT	STREAM (INTERMITTENT)		
MN STATE COLLEGE AND UNIVERSITY SYSTEM (MNSCU)	DRAINAGE DITCH		
UNIVERSITY OF MN SYSTEM	WETLAND		
FAIRGROUNDS	ISLAND OR LAND		
	REGIONAL WATERSHED		
CULTURAL FEATURES			
STATE HISTORICAL MARKER			
HISTORIC DISTRICT			
HISTORIC SITE			
MONUMENT			

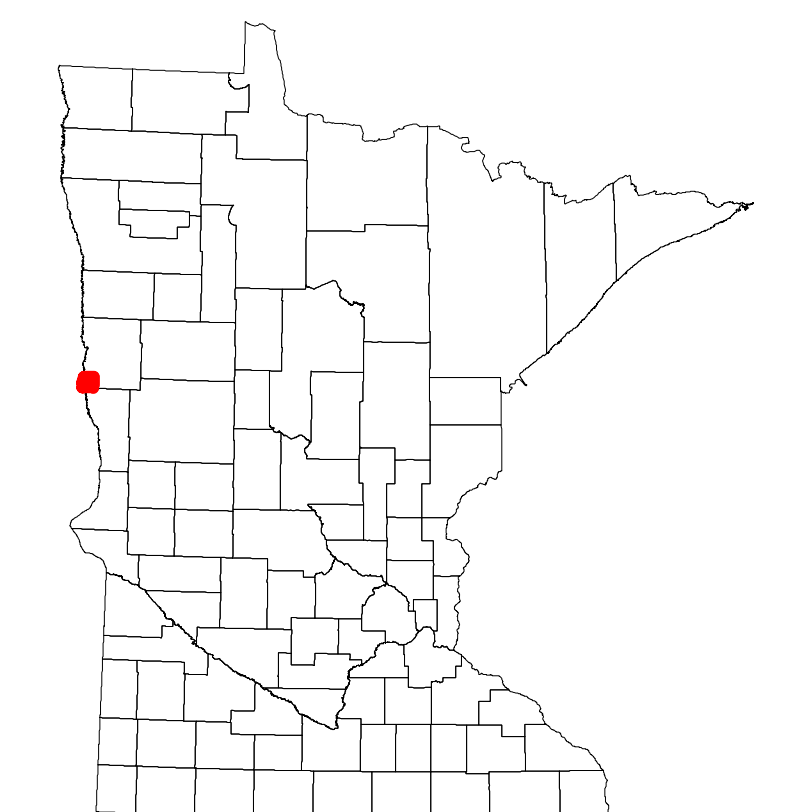

Population (U.S. Census 2010): 140

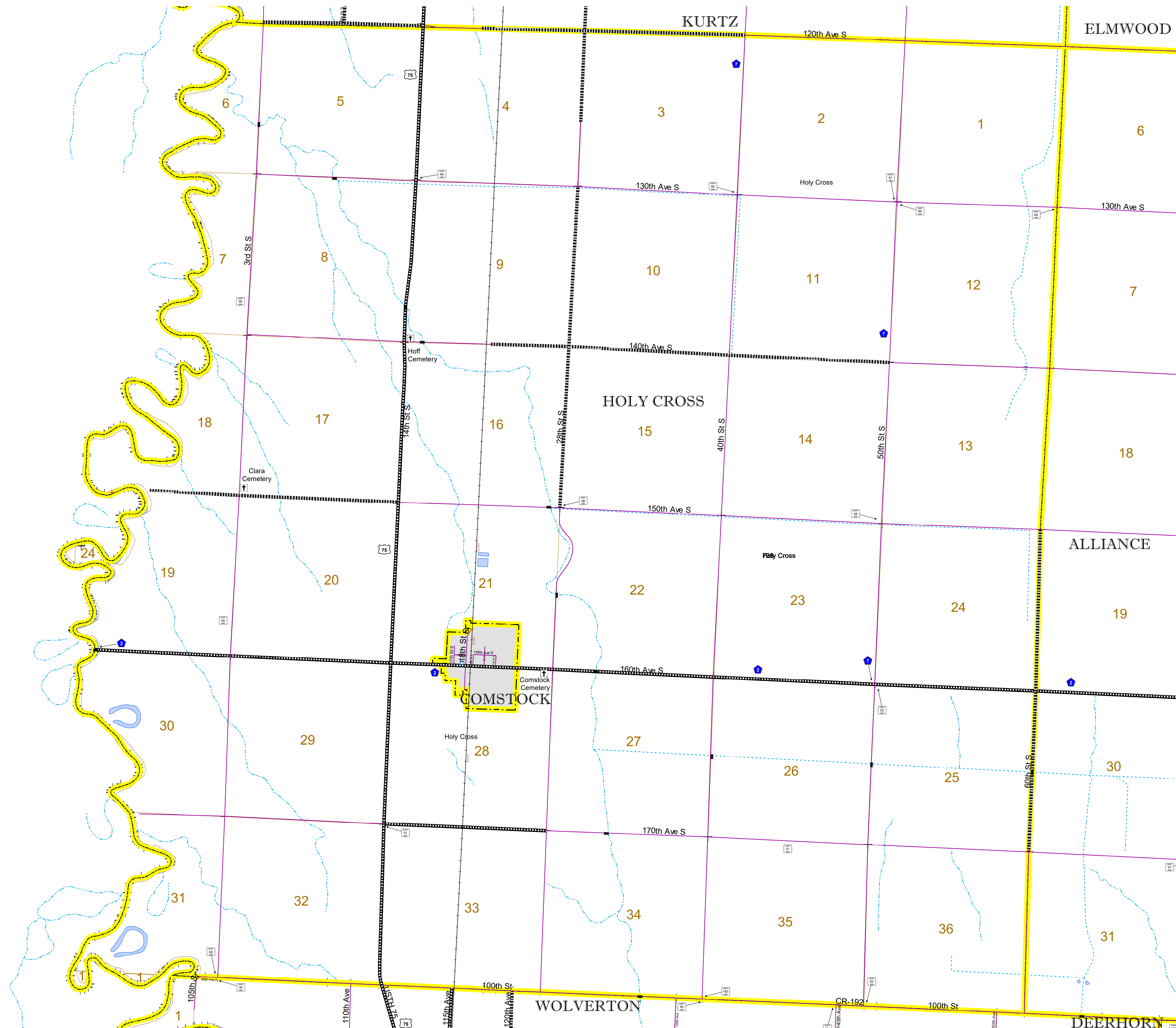

To request information from this document in an alternative format, call 651-366-4718 or 1-800-657-3774 (Greater Minnesota); 711 or 1-800-627-3529 (Minnesota Relay). You may also send an e-mail to ADARrequest.dot@state.mn.us. (Please request at least one week in advance.)