

TOWNSHIP OF GREENVALE

PREPARED BY THE
MINNESOTA DEPARTMENT OF TRANSPORTATION
OFFICE OF TRANSPORTATION SYSTEM MANAGEMENT

IN COOPERATION WITH
U.S. DEPARTMENT OF TRANSPORTATION
FEDERAL HIGHWAY ADMINISTRATION

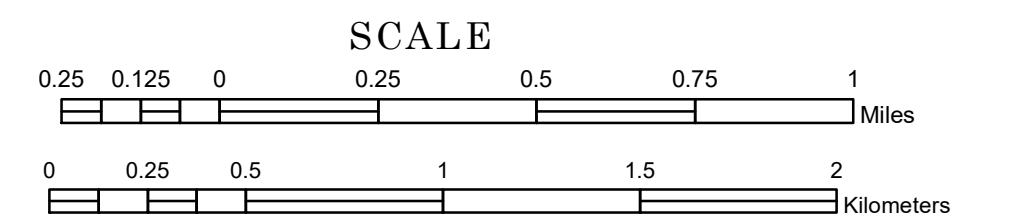

1 in = 1,600 ft

2022

Projection:
Transverse Mercator
NAD 1986
UTM Zone 15

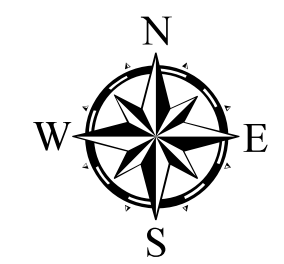

North American Datum
of 1986

ROAD AND ROADWAY FEATURES	
INTERSTATE	CONCRETE
US HIGHWAY	BITUMINOUS
MN HIGHWAY	GRAVEL
COUNTY STATE AID HIGHWAY	DIRT/UNIMPROVED
COUNTY ROAD	OTHER
TOWNSHIP ROAD	UNKNOWN
UNORGANIZED TERRITORY ROAD	
OTHER ROADS	RAMP OR CONNECTOR
Municipal	National Monument
Private	State Forest
Nature Service	National Wildlife
Military	State Game
	Preserve
RAILROAD AND RAILWAY FEATURES	
EMPIRE BUILDER STATION (AMTRAK)	COMMERCIAL AIRPORT
NORTHSTAR STATION (COMPUTER)	GENERAL AIRPORT
	AIRSTRIP
LIGHT RAIL	SEAPLANE
BLUE LINE	AIRPORT RUNWAY
GREEN LINE	
INFRASTRUCTURE FEATURES	
LONG BRIDGE (200' OR GREATER SPAN)	TRIAL LAND
MAJOR BRIDGE (20' TO 200' SPAN)	STATE OF MINNESOTA
MINOR BRIDGE (5' TO 20' SPAN)	COUNTY
DAM	MUNICIPALITY
LOCK AND DAM	UNORGANIZED TERRITORY
	FEDERAL ADJUSTED URBAN AREA (2014)
	CIVIL TOWNSHIP
	CONGRESSIONAL TOWNSHIP
CITY CENTERS	
STATE CAPITAL	SECTION
COUNTY SEAT	MILITARY
CITY CENTER	VOYAGEURS NATIONAL PARK
UNINCORPORATED COMMUNITY	BOUNDARY WATERS CANOE AREA WILDERNESS
PUBLIC SERVICE FEATURES	
MNDOT OFFICE	STATE PARK
MNDOT TRUCK STATION	REGIONAL PARK
HIGHWAY PATROL DISTRICT OFFICE	NATIONAL FOREST
STATE TRAVEL INFORMATION CENTER	NATIONAL AND STATE FOREST
REST AREA (FULL SERVICE)	STATE FOREST
REST AREA (VAULT TOILET)	NATIONAL TRAIL
WAYSIDE (VAULT OR PITY TOILET)	WILDLIFE REFUGUE AREA
PARK AND RIDE LOT	WILDLIFE MANAGEMENT AREA
PORT OF ENTRY	HYDROLOGIC FEATURES
PUBLIC ACCESS POINT	RIVER OR STREAM (PERENNIAL)
MN STATE COLLEGE AND UNIVERSITY SYSTEM (MNSCU)	LAKE, POND OR RESERVOIR
UNIVERSITY OF MN SYSTEM	STREAM (INTERMITTENT)
FAIRGROUNDS	DRAINAGE DITCH
CULTURAL FEATURES	
STATE HISTORICAL MARKER	HISTORIC DISTRICT
HISTORIC DISTRICT	HISTORIC SITE
HISTORIC SITE	MONUMENT
MONUMENT	REGIONAL WATERSHED

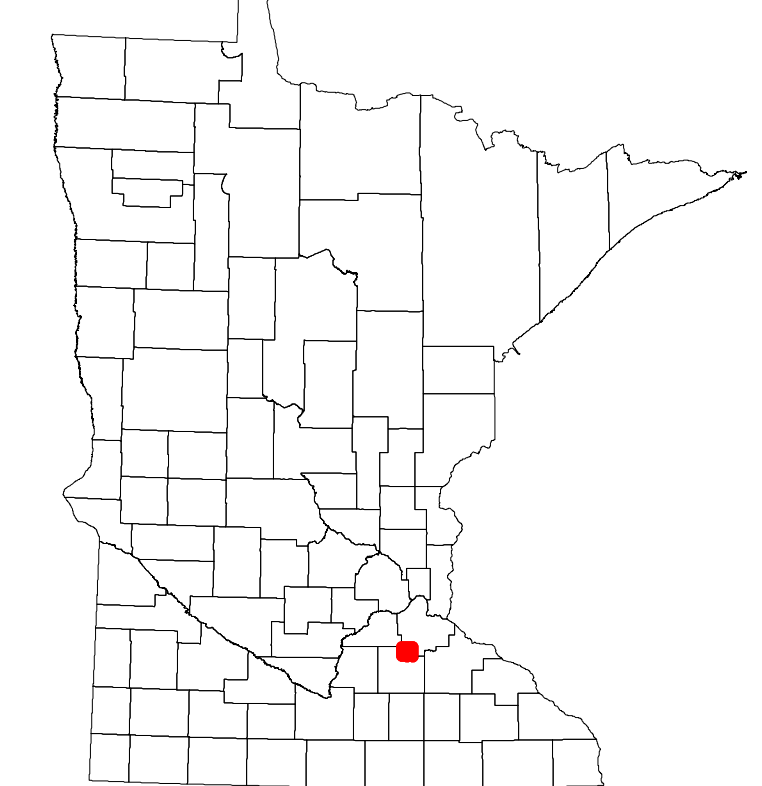

Population (U.S. Census 2010): 803

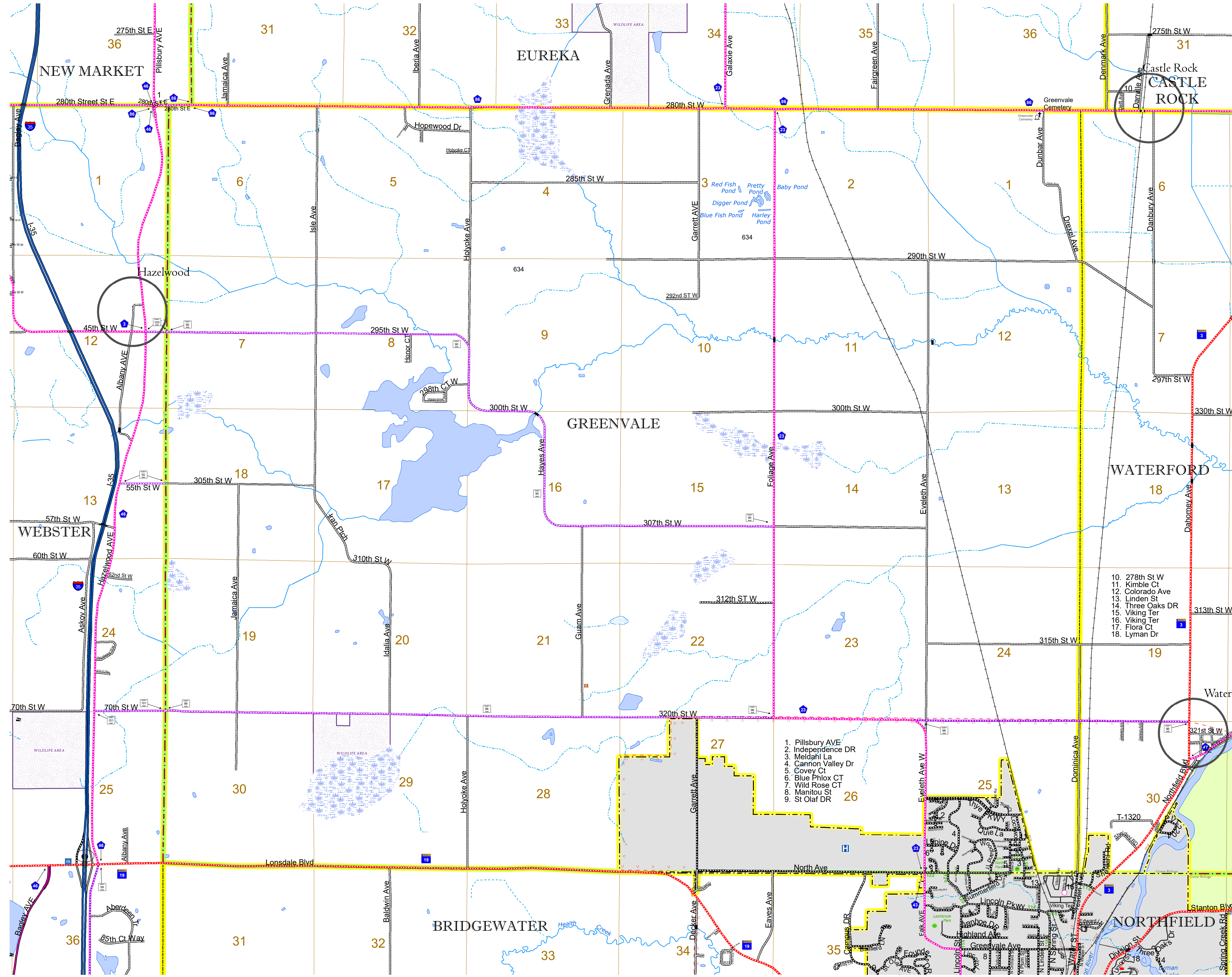

- 1. Pillsbury Ave
- 2. Independence Dr
- 3. Meldahl La
- 4. Cannon Valley Dr
- 5. Covey Ct
- 6. Blue Phlox Ct
- 7. Wild Rose Ct
- 8. Manitou St
- 9. St Olaf Dr

To request information from this document in an alternative format, call 651-366-4718 or 1-800-657-3774 (Greater Minnesota); 711 or 1-800-627-3529 (Minnesota Relay). You may also send an e-mail to ADAREquest.dot@state.mn.us. (Please request at least one week in advance.)