

# TOWNSHIP OF DELAVAN

PREPARED BY THE  
MINNESOTA DEPARTMENT OF TRANSPORTATION  
OFFICE OF TRANSPORTATION SYSTEM MANAGEMENT

IN COOPERATION WITH  
U.S. DEPARTMENT OF TRANSPORTATION  
FEDERAL HIGHWAY ADMINISTRATION

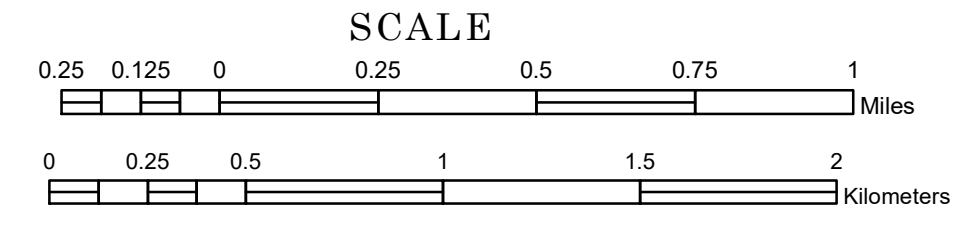

2022

Projection:  
Transverse Mercator  
NAD 1986  
UTM Zone 15

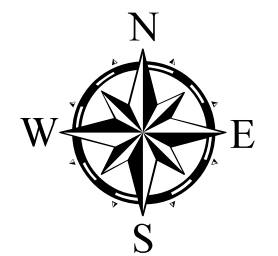

North American Datum  
of 1986

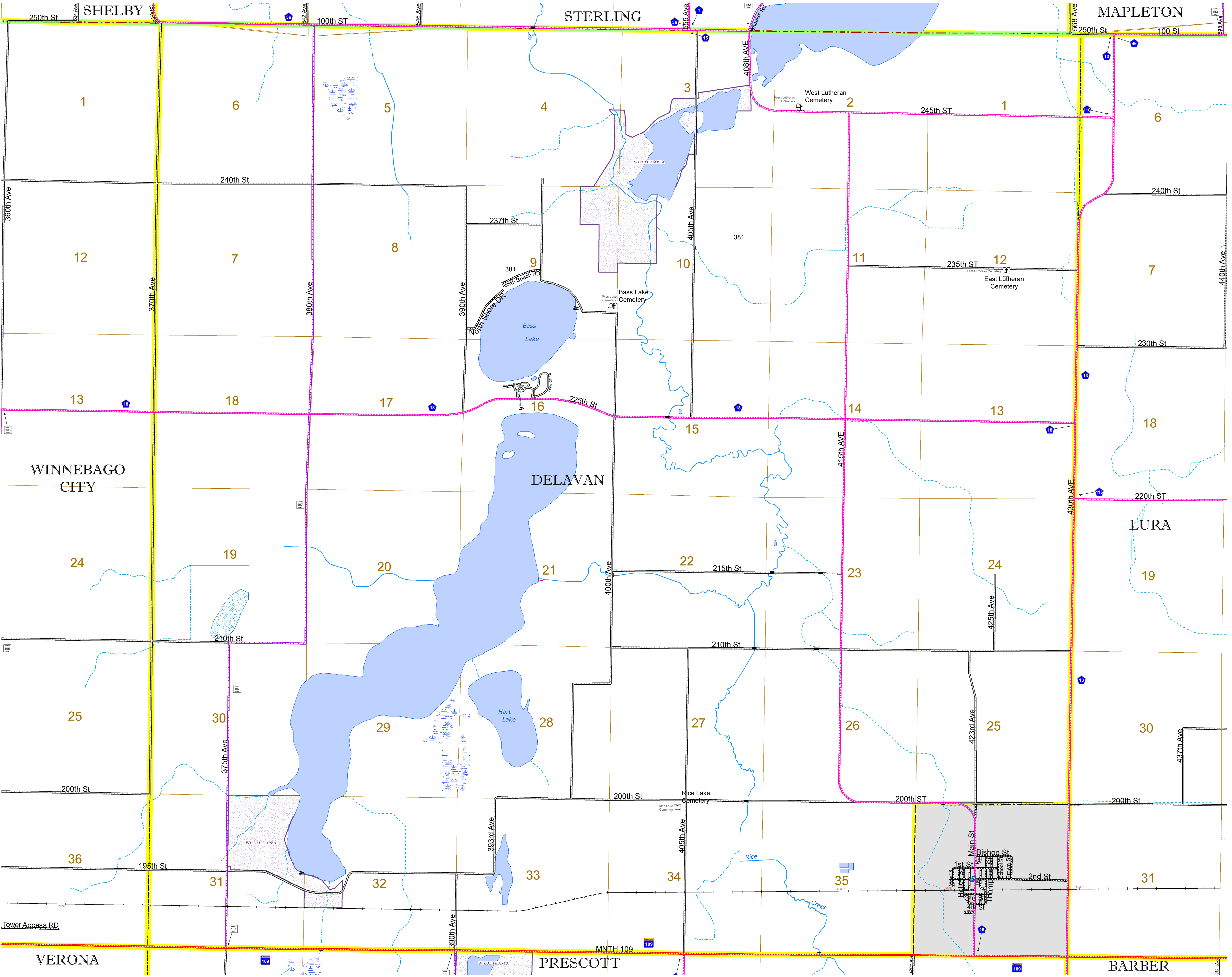

| ROAD AND ROADWAY FEATURES  |                 | AVIATION FEATURES  |                                       |
|----------------------------|-----------------|--------------------|---------------------------------------|
| INTERSTATE                 | CONCRETE        | COMMERCIAL AIRPORT | TRIAL LAND                            |
| US HIGHWAY                 | BITUMINOUS      | GENERAL AIRPORT    | STATE OF MINNESOTA                    |
| MN HIGHWAY                 | GRAVEL          | AIRSTRIP           | COUNTY                                |
| COUNTY STATE AID HIGHWAY   | DIRT/UNIMPROVED | SEAPLANE           | MUNICIPALITY                          |
| COUNTY ROAD                | OTHER           | AIRPORT RUNWAY     | UNORGANIZED TERRITORY                 |
| TOWNSHIP ROAD              | UNKNOWN         |                    | FEDERAL ADJUSTED URBAN AREA (2014)    |
| UNORGANIZED TERRITORY ROAD |                 |                    | CIVIL TOWNSHIP                        |
| OTHER ROADS                |                 |                    | CONGRESSIONAL TOWNSHIP                |
| Municipal                  |                 |                    | SECTION                               |
| Private                    |                 |                    | MILITARY                              |
| National Monument          |                 |                    | VOYAGEURS NATIONAL PARK               |
| National Park              |                 |                    | BOUNDARY WATERS CANOE AREA WILDERNESS |
| National Wildlife          |                 |                    | STATE PARK                            |
| State Park                 |                 |                    | REGIONAL PARK                         |
| Preserve                   |                 |                    | NATIONAL FOREST                       |
|                            |                 |                    | NATIONAL AND STATE FOREST             |
|                            |                 |                    | STATE FOREST                          |
|                            |                 |                    | NATIONAL TRAIL                        |
|                            |                 |                    | WILDLIFE REFUGUE AREA                 |
|                            |                 |                    | WILDLIFE MANAGEMENT AREA              |
|                            |                 |                    | HYDROLOGIC FEATURES                   |
|                            |                 |                    | RIVER OR STREAM (PERMANENT)           |
|                            |                 |                    | LAKE, POND OR RESERVOIR               |
|                            |                 |                    | STREAM (INTERMITTENT)                 |
|                            |                 |                    | DRAINAGE DITCH                        |
|                            |                 |                    | WETLAND                               |
|                            |                 |                    | ISLAND OR LAND                        |
|                            |                 |                    | REGIONAL WATERSHED                    |

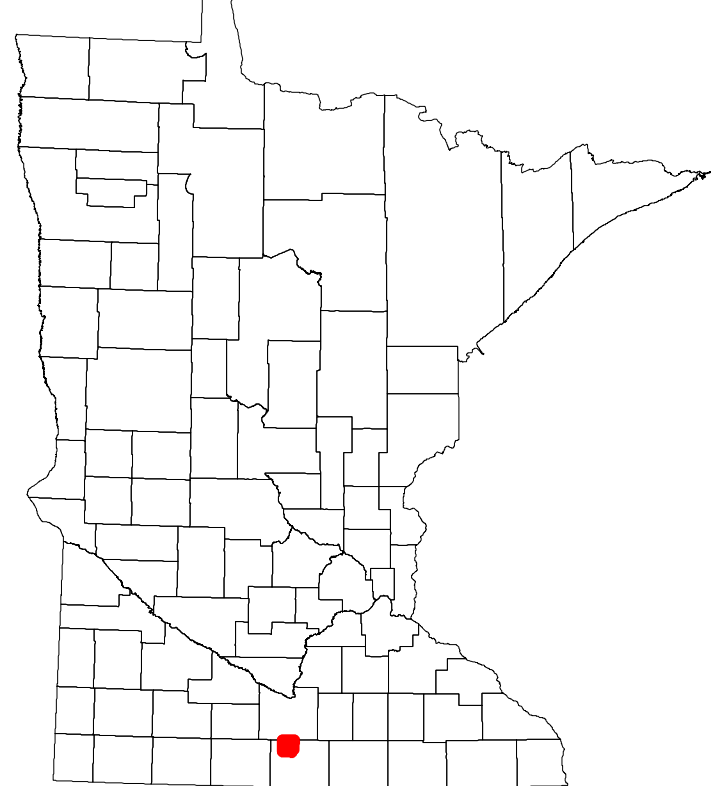

Population (U.S. Census 2010): 228

To request information from this document in an alternative format, call 651-366-4718 or 1-800-657-3774 (Greater Minnesota); 711 or 1-800-627-3529 (Minnesota Relay). You may also send an e-mail to ADRequest.dot@state.mn.us. (Please request at least one week in advance.)