

# TOWNSHIP OF EMERALD

PREPARED BY THE  
MINNESOTA DEPARTMENT OF TRANSPORTATION  
OFFICE OF TRANSPORTATION SYSTEM MANAGEMENT

IN COOPERATION WITH  
U.S. DEPARTMENT OF TRANSPORTATION  
FEDERAL HIGHWAY ADMINISTRATION

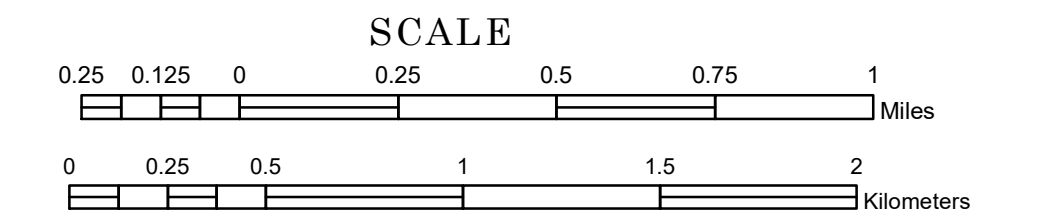

1 in = 1,600 ft  
**2022**

Projection:  
Transverse Mercator  
NAD 1986  
UTM Zone 15

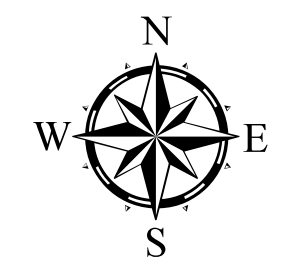

North American Datum  
of 1986

ROAD AND ROADWAY FEATURES		AVIATION FEATURES	
INTERSTATE		CONCRETE	
US HIGHWAY		BITUMINOUS	
MN HIGHWAY		GRAVEL	
COUNTY STATE AID HIGHWAY		DIRT/UNIMPROVED	
COUNTY ROAD		OTHER	
TOWNSHIP ROAD		UNKNOWN	
UNORGANIZED TERRITORY ROAD			
OTHER ROADS		RAMP OR CONNECTOR	
Municipal		INTERSTATE EXIT	
Private		COMMERCIAL AIRPORT	
National Monument		GENERAL AIRPORT	
State Forest		AIRSTRIP	
National Park		SEAPLANE	
National Wildlife Refuge		AIRPORT RUNWAY	
State Park			
Preserve			
RAILROAD AND RAILWAY FEATURES		BOUNDARY FEATURES	
EMPIRE BUILDER STATION (AMTRAK)		TRIBAL LAND	
NORTHSTAR STATION (COMMUTER)		STATE OF MINNESOTA	
LIGHT RAIL		COUNTY	
BLUE LINE		MUNICIPALITY	
GREEN LINE		UNORGANIZED TERRITORY	
INFRASTRUCTURE FEATURES		FEDERAL ADJUSTED URBAN AREA (2014)	
LONG BRIDGE (200' OR GREATER SPAN)		CIVIL TOWNSHIP	
MAJOR BRIDGE (20' TO 200' SPAN)		CONGRESSIONAL TOWNSHIP	
MINOR BRIDGE (5' TO 20' SPAN)		SECTION	
DAM		MILITARY	
LOCK-AND-DAM		VOYAGEUR'S NATIONAL PARK	
CITY CENTERS		BOUNDARY WATERS CANOE AREA WILDERNESS	
STATE CAPITAL		STATE PARK	
COUNTY SEAT		REGIONAL PARK	
CITY CENTER		NATIONAL FOREST	
UNINCORPORATED COMMUNITY		NATIONAL AND STATE FOREST	
PUBLIC SERVICE FEATURES		STATE FOREST	
MNDOT OFFICE		NATIONAL TRAIL	
MNDOT TRUCK STATION		WILDLIFE REFUGUE AREA	
HIGHWAY PATROL DISTRICT OFFICE		WILDLIFE MANAGEMENT AREA	
STATE TRAVEL INFORMATION CENTER		HYDROLOGIC FEATURES	
REST AREA (FULL SERVICE)		RIVER OR STREAM (PERMANENT)	
REST AREA (VAULT TOILET)		LAKE, POND OR RESERVOIR	
WAYSIDE (VAULT OR PIT TOILET)		STREAM (INTERMITTENT)	
PARK AND RIDE LOT		DRAINAGE DITCH	
PORT OF ENTRY		WETLAND	
PUBLIC ACCESS POINT		ISLAND OR LAND	
MN STATE COLLEGE AND UNIVERSITY SYSTEM (MNSCU)		REGIONAL WATERSHED	
UNIVERSITY OF MN SYSTEM			
FAIRGROUNDS			
CULTURAL FEATURES			
STATE HISTORICAL MARKER			
HISTORIC DISTRICT			
HISTORIC SITE			
MONUMENT			

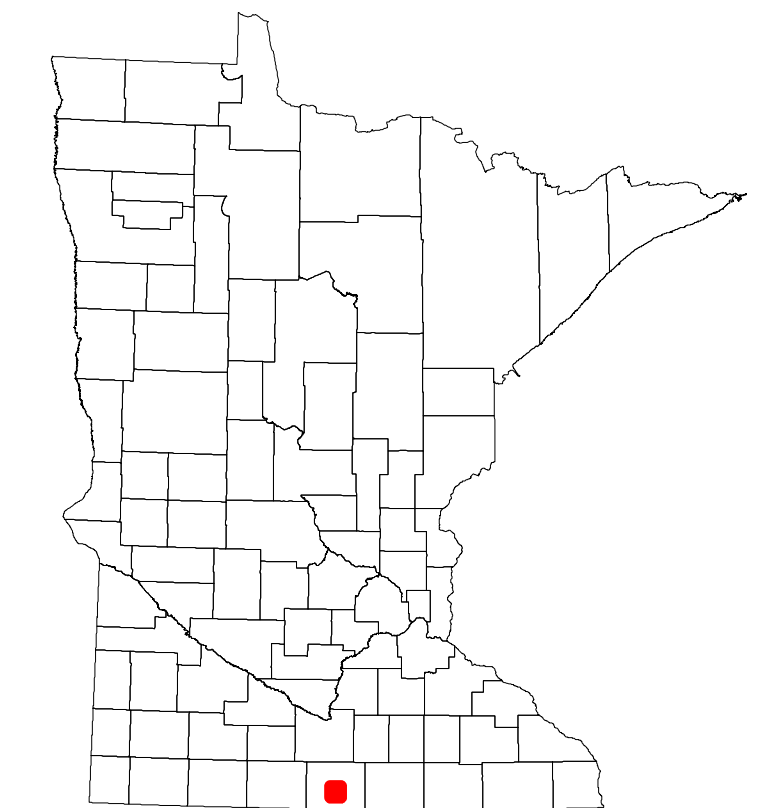

Population (U.S. Census 2010): 222

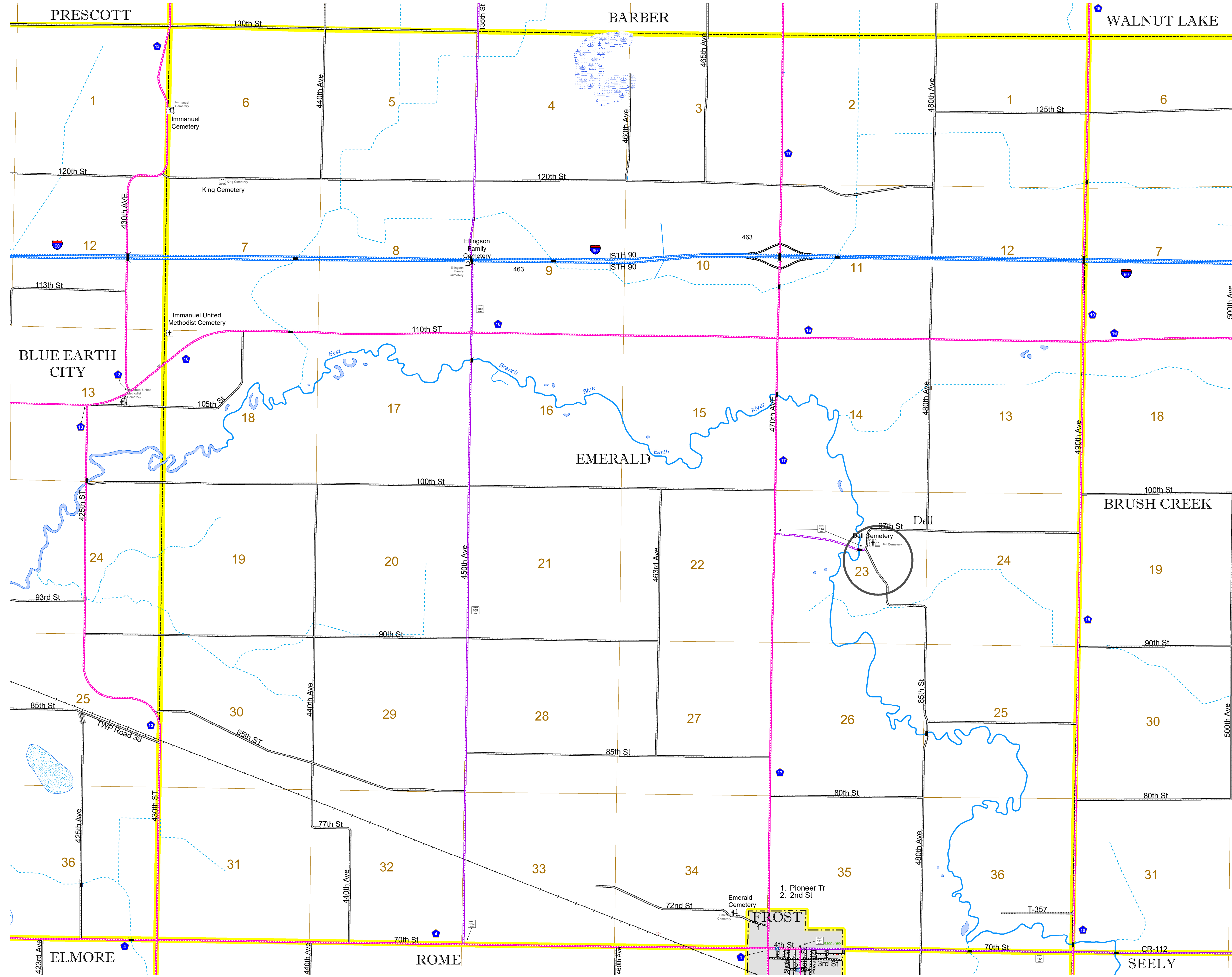

To request information from this document in an alternative format, call 651-366-4718 or 1-800-657-3774 (Greater Minnesota); 711 or 1-800-627-3529 (Minnesota Relay). You may also send an e-mail to ADarequest.dot@state.mn.us. (Please request at least one week in advance.)