

TOWNSHIP OF AMIRET

PREPARED BY THE
MINNESOTA DEPARTMENT OF TRANSPORTATION
OFFICE OF TRANSPORTATION SYSTEM MANAGEMENT

IN COOPERATION WITH
U.S. DEPARTMENT OF TRANSPORTATION
FEDERAL HIGHWAY ADMINISTRATION



2023

Projection:
Transverse Mercator
NAD 1986
UTM Zone 15



North American Datum
of 1986

ROAD AND ROADWAY FEATURES		BOUNDARY FEATURES	
INTERSTATE	CONCRETE	TRIBAL LAND	STATE OF MINNESOTA
US HIGHWAY	BITUMINOUS	STATE OF MINNESOTA	COUNTY
MN HIGHWAY	GRAVEL	MUNICIPALITY	MUNICIPALITY
COUNTY STATE AID HIGHWAY	DIRT/UNIMPROVED	UNORGANIZED TERRITORY	UNORGANIZED TERRITORY
COUNTY ROAD	OTHER	FEDERAL ADJUSTED URBAN AREA (2014)	CIVIL TOWNSHIP
TOWNSHIP ROAD	UNKNOWN	CONGRESSIONAL TOWNSHIP	CONGRESSIONAL TOWNSHIP
UNORGANIZED TERRITORY ROAD		SECTION	MILITARY
OTHER ROADS		VOYAGEURS NATIONAL PARK	BOUNDRARY WATERS CANOE AREA WILDERNESS
Municipal	RAMP OR CONNECTOR	STATE PARK	REGIONAL PARK
Private	INTERSTATE EXIT	NATIONAL FOREST	NATIONAL AND STATE FOREST
National Monument	GREAT RIVER ROAD	STATE FOREST	NATIONAL TRAIL
National Wildlife		WILDLIFE REFUGUE AREA	WILDLIFE MANAGEMENT AREA
State Game		WILDLIFE MANAGEMENT AREA	HYDROLOGIC FEATURES
State Park		RIVER OR STREAM (PERMANENT)	LAKE, POND OR RESERVOIR
Preserve		STREAM (INTERMITTENT)	DRAINAGE DITCH
		WETLAND	ISLAND OR LAND
		REGIONAL WATERSHED	

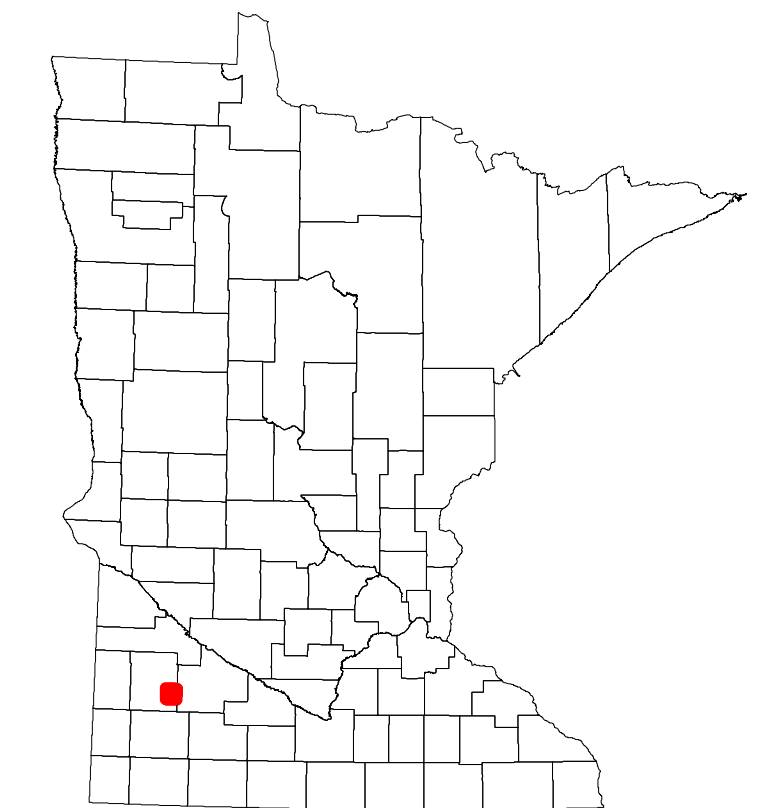

Population (U.S. Census 2010): 245

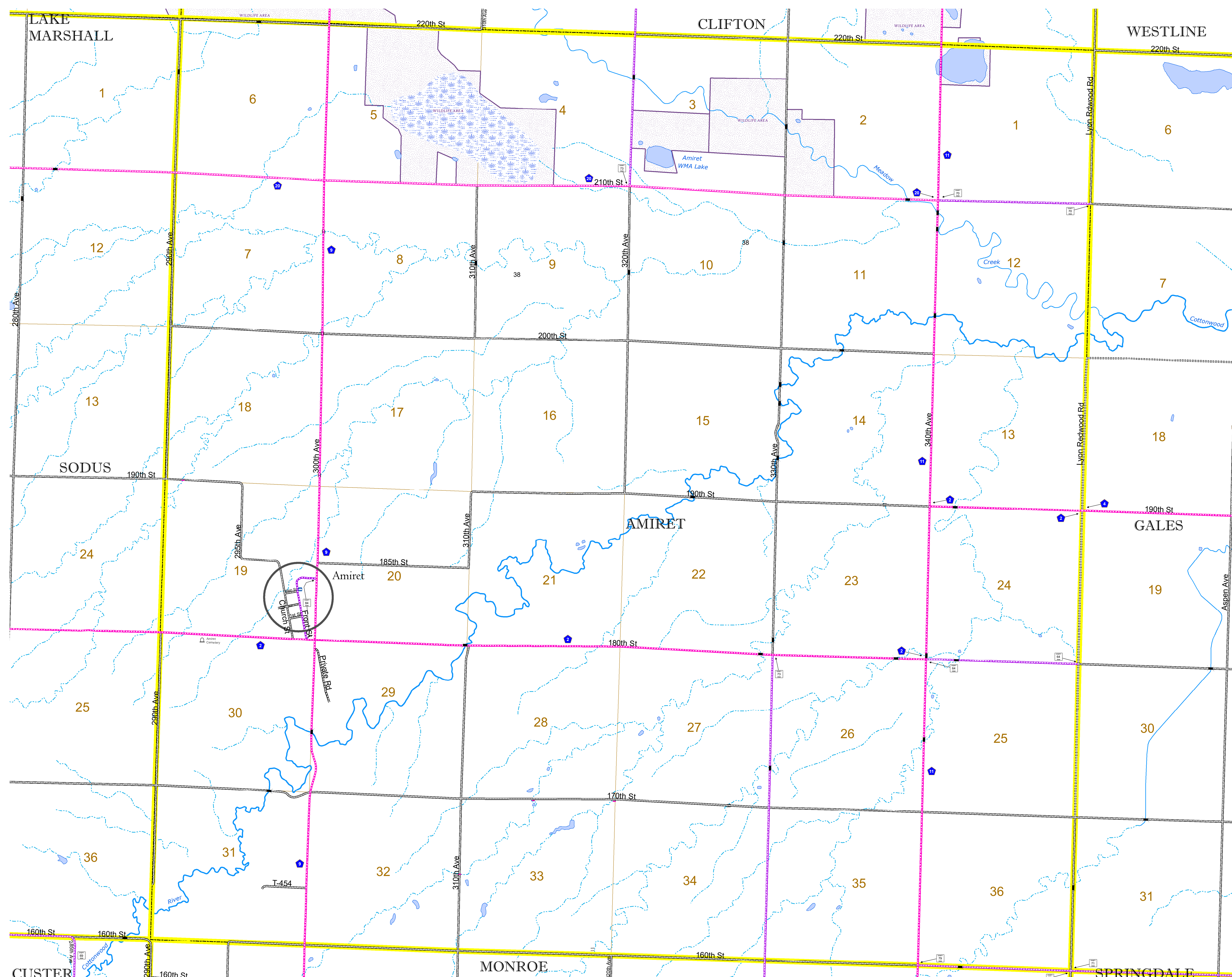

To request information from this document in an alternative format, call 651-366-4718 or 1-800-657-3774 (Greater Minnesota); 711 or 1-800-627-3529 (Minnesota Relay). You may also send an e-mail to ADRequest.dot@state.mn.us. (Please request at least one week in advance.)