

# TOWNSHIP OF BOXVILLE

PREPARED BY THE  
MINNESOTA DEPARTMENT OF TRANSPORTATION  
OFFICE OF TRANSPORTATION SYSTEM MANAGEMENT

IN COOPERATION WITH  
U.S. DEPARTMENT OF TRANSPORTATION  
FEDERAL HIGHWAY ADMINISTRATION



1 in = 1,600 ft  
**2022**

Projection:  
Transverse Mercator  
NAD 1986  
UTM Zone 15

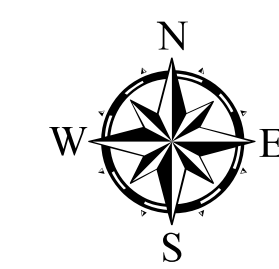

North American Datum  
of 1986

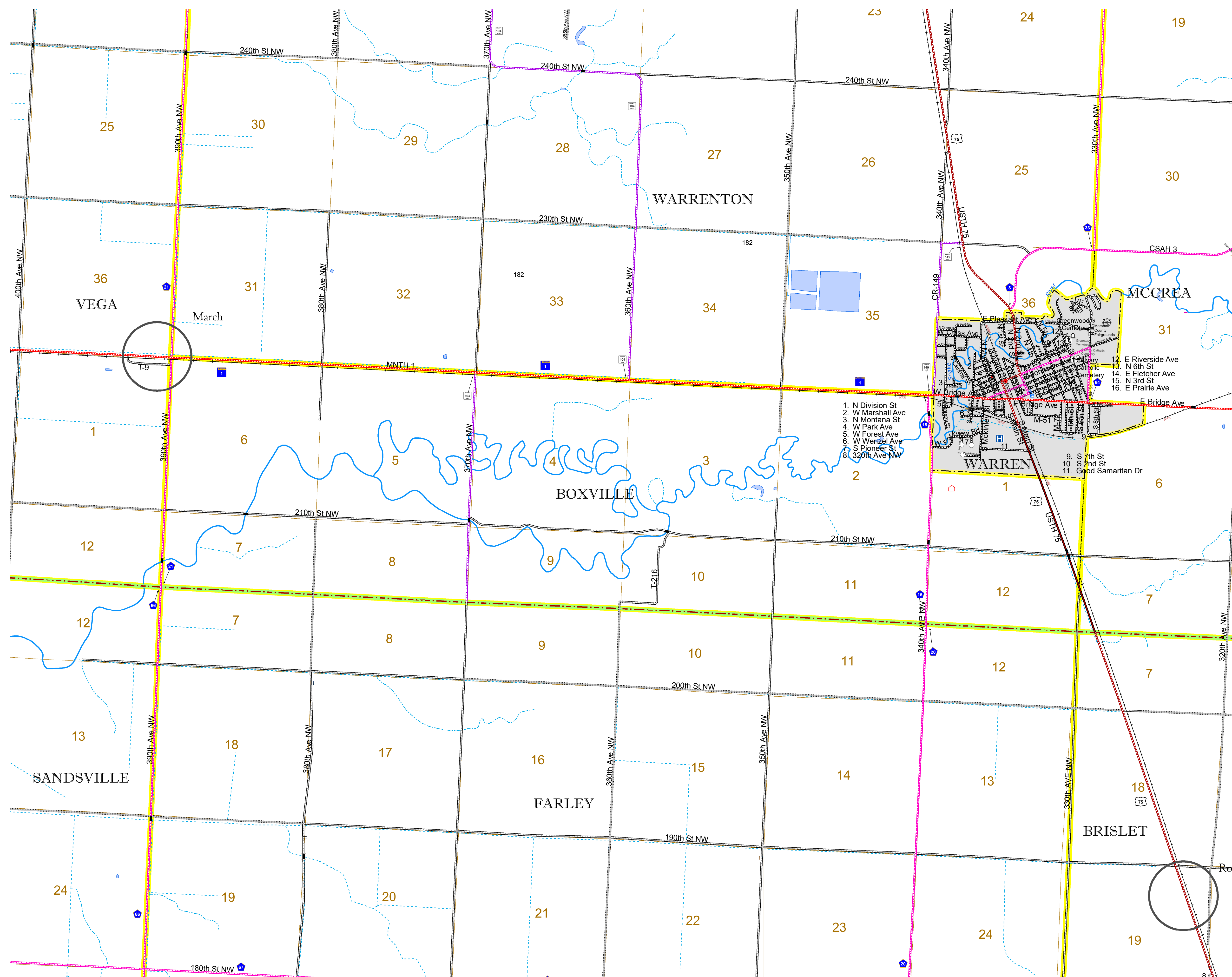

ROAD AND ROADWAY FEATURES		BOUNDARY FEATURES	
INTERSTATE	CONCRETE	TRIBAL LAND	STATE OF MINNESOTA
US HIGHWAY	BITUMINOUS	COUNTY	MUNICIPALITY
MN HIGHWAY	GRAVEL	UNORGANIZED TERRITORY	FEDERAL ADJUSTED URBAN AREA (2014)
COUNTY STATE AID HIGHWAY	DIRT/UNIMPROVED	CIVIL TOWNSHIP	CONGRESSIONAL TOWNSHIP
COUNTY ROAD	OTHER	SECTION	MILITARY
TOWNSHIP ROAD	UNKNOWN	VOYAGEURS NATIONAL PARK	BOUNDARY WATERS CANOE AREA WILDERNESS
UNORGANIZED TERRITORY ROAD		STATE PARK	REGIONAL PARK
OTHER ROADS		NATIONAL FOREST	NATIONAL AND STATE FOREST
Municipal	RAMP OR CONNECTOR	STATE FOREST	WILDLIFE REFUGUE AREA
Private	INTERSTATE EXIT	WILDLIFE MANAGEMENT AREA	HYDROLOGIC FEATURES
National Monument	GREAT RIVER ROAD	RIVER OR STREAM (PERMANENT)	LAKE, POND OR RESERVOIR
National Wildlife Refuge		STREAM (INTERMITTENT)	DRAINAGE DITCH
State Park		WETLAND	ISLAND OR LAND
Preserve		REGIONAL WATERSHED	
RAILROAD AND RAILWAY FEATURES		AVIATION FEATURES	
EMPIRE BUILDER STATION (AMTRAK)	COMMERCIAL AIRPORT	GENERAL AIRPORT	
NORTHSTAR STATION (COMMUTER)	AIRSTRIP	SEAPLANE	
LIGHT RAIL	SEAPLANE	AIRPORT RUNWAY	
BLUE LINE			
GREEN LINE			
INFRASTRUCTURE FEATURES		CITY CENTERS	
LONG BRIDGE (200' OR GREATER SPAN)	STATE CAPITAL	COUNTY SEAT	CITY CENTER
MAJOR BRIDGE (20' TO 200' SPAN)	UNINCORPORATED COMMUNITY		
MINOR BRIDGE (5' TO 20' SPAN)			
DAM			
LOCK AND DAM			
PUBLIC SERVICE FEATURES		CULTURAL FEATURES	
MN DOT OFFICE	STATE HISTORICAL MARKER	HISTORIC DISTRICT	HISTORIC SITE
MN DOT TRUCK STATION			
HIGHWAY PATROL DISTRICT OFFICE			
STATE TRAVEL INFORMATION CENTER			
REST AREA (FULL SERVICE)			
REST AREA (VAULT TOILET)			
WAYSIDE (VAULT OR PIT TOILET)			
PARK AND RIDE LOT			
PORT OF ENTRY			
PUBLIC ACCESS POINT			
MN STATE COLLEGE AND UNIVERSITY SYSTEM (MNSCU)			
UNIVERSITY OF MN SYSTEM			
FAIRGROUNDS			

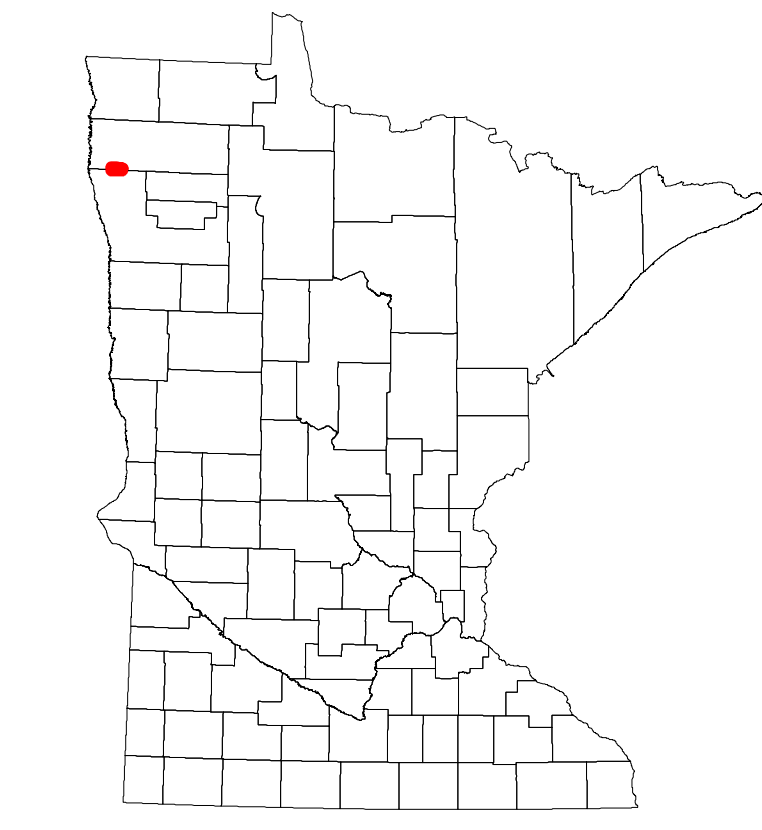

Population (U.S. Census 2010): 39

To request information from this document in an alternative format, call 651-366-4718 or 1-800-657-3774 (Greater Minnesota); 711 or 1-800-627-3529 (Minnesota Relay). You may also send an e-mail to ADarequest.dot@state.mn.us. (Please request at least one week in advance.)