

TOWNSHIP OF DAILEY

PREPARED BY THE
MINNESOTA DEPARTMENT OF TRANSPORTATION
OFFICE OF TRANSPORTATION SYSTEM MANAGEMENT

IN COOPERATION WITH
U.S. DEPARTMENT OF TRANSPORTATION
FEDERAL HIGHWAY ADMINISTRATION

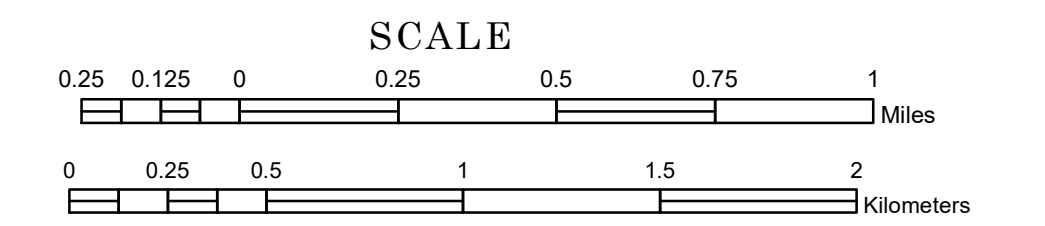

1 in = 1,600 ft

2022

Projection:
Transverse Mercator
NAD 1986
UTM Zone 15

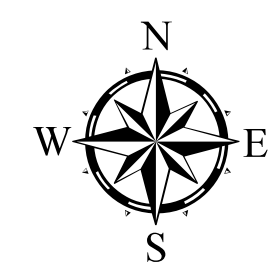

North American Datum
of 1986

| ROAD AND ROADWAY FEATURES | | RAILROAD AND RAILWAY FEATURES | | AVIATION FEATURES | |
|-----------------------------|--|--|--|---------------------------------------|--|
| INTERSTATE | | EMPIRE BUILDER STATION (AMTRAK) | | COMMERCIAL AIRPORT | |
| US HIGHWAY | | NORTHSTAR STATION (COMMERCE) | | GENERAL AIRPORT | |
| MN HIGHWAY | | LIGHT RAIL | | AIRSTRIP | |
| COUNTY STATE AID HIGHWAY | | BLUE LINE | | SEAPLANE | |
| COUNTY ROAD | | GREEN LINE | | AIRPORT RUNWAY | |
| TOWNSHIP ROAD | | LONG BRIDGE (200' OR GREATER SPAN) | | TRIAL LAND | |
| UNORGANIZED TERRITORY ROAD | | MAJOR BRIDGE (20' TO 200' SPAN) | | STATE OF MINNESOTA | |
| OTHER ROADS | | MINOR BRIDGE (5' TO 20' SPAN) | | COUNTY | |
| MUNICIPAL | | DAM | | MUNICIPALITY | |
| PRIVATE | | LOCK AND DAM | | UNORGANIZED TERRITORY | |
| NATIONAL MONUMENT | | CITY CENTERS | | FEDERAL ADJUSTED URBAN AREA (2014) | |
| NATIONAL WILDLIFE REFUGE | | STATE CAPITAL | | CIVIL TOWNSHIP | |
| STATE PARK | | COUNTY SEAT | | CONGRESSIONAL TOWNSHIP | |
| STATE FOREST | | CITY CENTER | | SECTION | |
| NATIONAL AND STATE FOREST | | UNINCORPORATED COMMUNITY | | MILITARY | |
| STATE FOREST | | MNDOT OFFICE | | VOYAGEURS NATIONAL PARK | |
| NATIONAL TRAIL | | MNDOT TRUCK STATION | | BOUNDARY WATERS CANOE AREA WILDERNESS | |
| WILDLIFE REFUGE AREA | | HIGHWAY PATROL DISTRICT OFFICE | | STATE PARK | |
| WILDLIFE MANAGEMENT AREA | | STATE TRAVEL INFORMATION CENTER | | REGIONAL PARK | |
| RIVER OR STREAM (PERMANENT) | | REST AREA (FULL SERVICE) | | NATIONAL FOREST | |
| LAKE, POND OR RESERVOIR | | REST AREA (VAULT TOILET) | | NATIONAL AND STATE FOREST | |
| STREAM (INTERMITTENT) | | WAYSIDE (VAULT OR PIT TOILET) | | STATE FOREST | |
| DRAINAGE DITCH | | PARK AND RIDE LOT | | NATIONAL TRAIL | |
| WETLAND | | PORT OF ENTRY | | WILDLIFE REFUGE AREA | |
| ISLAND OR LAND MONUMENT | | PUBLIC ACCESS POINT | | WILDLIFE MANAGEMENT AREA | |
| REGIONAL WATERSHED | | MN STATE COLLEGE AND UNIVERSITY SYSTEM (MNSCU) | | HYDROLOGIC FEATURES | |
| | | UNIVERSITY OF MN SYSTEM | | | |
| | | FAIRGROUNDS | | | |
| | | CULTURAL FEATURES | | | |
| | | STATE HISTORICAL MARKER | | | |
| | | HISTORIC DISTRICT | | | |
| | | HISTORIC SITE | | | |
| | | MONUMENT | | | |

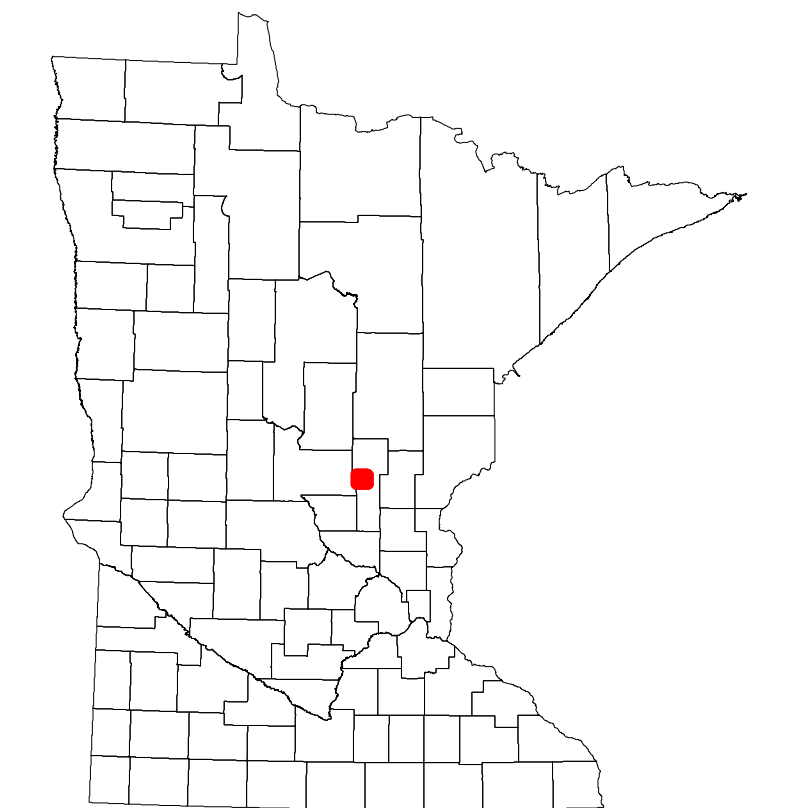

Population (U.S. Census 2010): 234

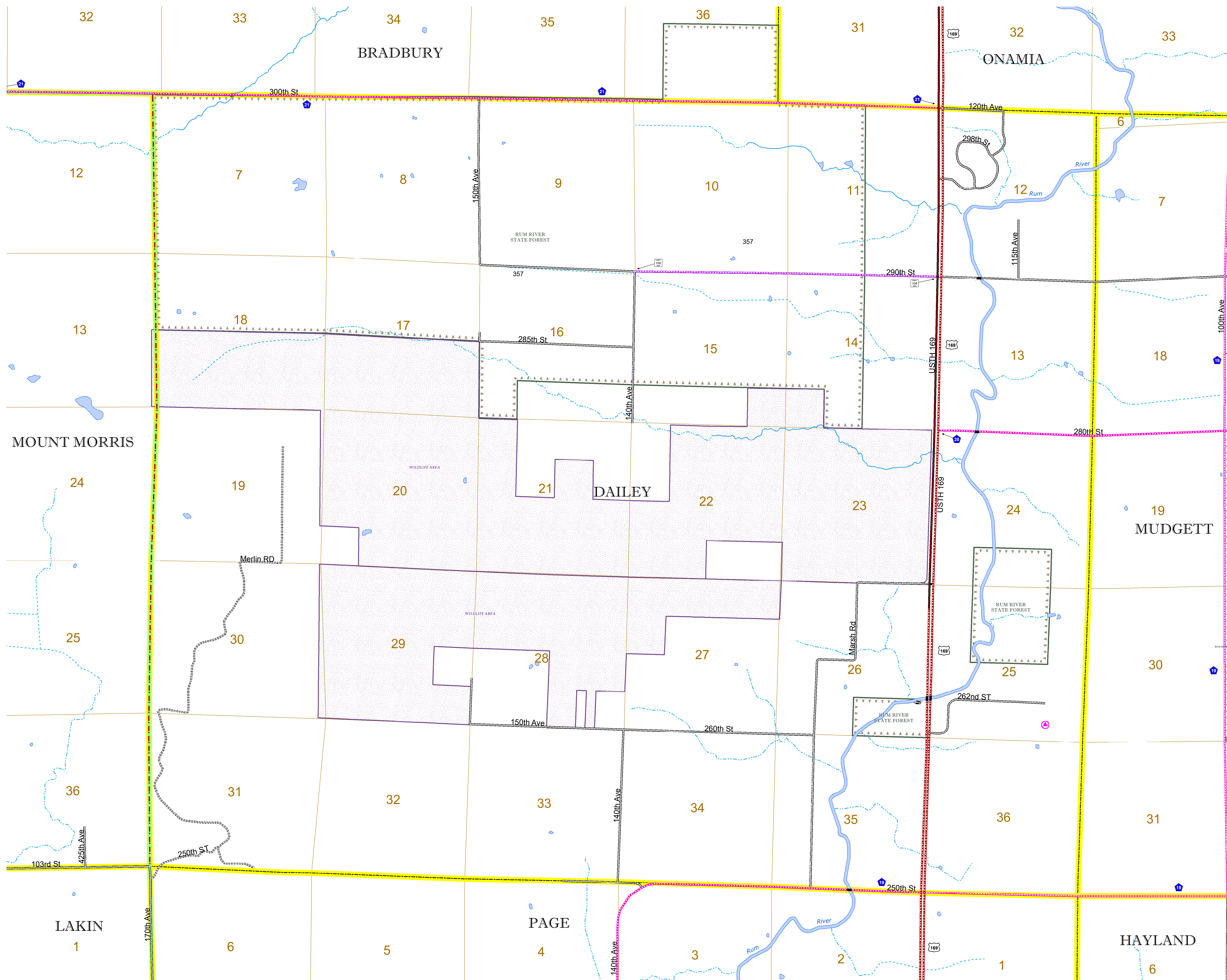

To request information from this document in an alternative format, call 651-366-4718 or 1-800-657-3774 (Greater Minnesota); 711 or 1-800-627-3529 (Minnesota Relay). You may also send an e-mail to ADarequest.dot@state.mn.us. (Please request at least one week in advance.)