

# TOWNSHIP OF LAKE PRAIRIE

PREPARED BY THE  
MINNESOTA DEPARTMENT OF TRANSPORTATION  
OFFICE OF TRANSPORTATION SYSTEM MANAGEMENT

IN COOPERATION WITH  
U.S. DEPARTMENT OF TRANSPORTATION  
FEDERAL HIGHWAY ADMINISTRATION

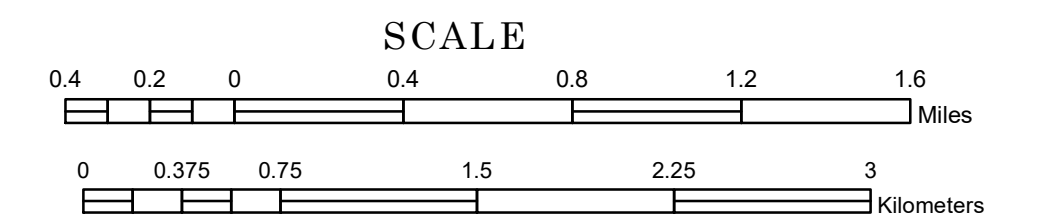

2022

Projection:  
Transverse Mercator  
NAD 1986  
UTM Zone 15



North American Datum  
of 1986

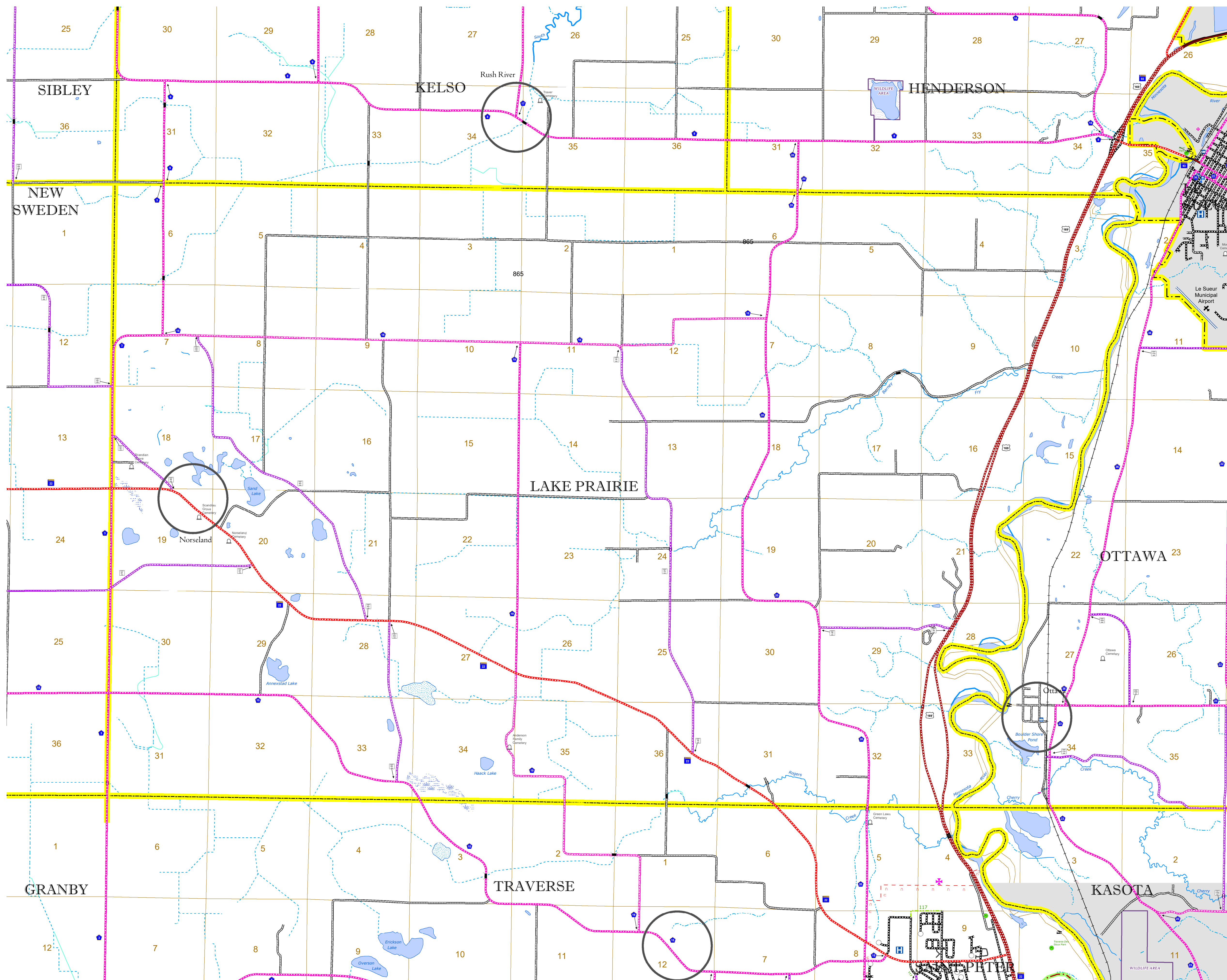

ROAD AND ROADWAY FEATURES		RAILROAD AND RAILWAY FEATURES		CITY CENTERS		PUBLIC SERVICE FEATURES		CULTURAL FEATURES	
INTERSTATE	CONCRETE	EMPIRE BUILDER STATION (AMTRAK)	COMMERCIAL AIRPORT	STATE CAPITAL	MILITARY	STATE HISTORICAL MARKER	HISTORIC DISTRICT	STATE HISTORICAL MARKER	HISTORIC DISTRICT
US HIGHWAY	BITUMINOUS	NORTHSTAR STATION (COMMUTER)	GENERAL AIRPORT	COUNTY SEAT	VOYAGEURS NATIONAL PARK	HISTORIC DISTRICT	HISTORIC DISTRICT	HISTORIC DISTRICT	HISTORIC DISTRICT
MN HIGHWAY	GRAVEL	LIGHT RAIL	AIRSTRIP	CITY CENTER	BOUNDARY WATERS CANOE AREA WILDERNESS	HISTORIC DISTRICT	HISTORIC DISTRICT	HISTORIC DISTRICT	HISTORIC DISTRICT
COUNTY STATE AID HIGHWAY	DIRT/UNIMPROVED	BLUE LINE	SEAPLANE	UNINCORPORATED COMMUNITY	STATE PARK	HISTORIC DISTRICT	HISTORIC DISTRICT	HISTORIC DISTRICT	HISTORIC DISTRICT
COUNTY ROAD	OTHER	GREEN LINE	AIRPORT RUNWAY		NATIONAL FOREST	HISTORIC DISTRICT	HISTORIC DISTRICT	HISTORIC DISTRICT	HISTORIC DISTRICT
TOWNSHIP ROAD	UNKNOWN				NATIONAL AND STATE FOREST	HISTORIC DISTRICT	HISTORIC DISTRICT	HISTORIC DISTRICT	HISTORIC DISTRICT
UNORGANIZED TERRITORY ROAD					STATE FOREST	HISTORIC DISTRICT	HISTORIC DISTRICT	HISTORIC DISTRICT	HISTORIC DISTRICT
OTHER ROADS					WILDLIFE REFUGUE AREA	HISTORIC DISTRICT	HISTORIC DISTRICT	HISTORIC DISTRICT	HISTORIC DISTRICT
Municipal	RAMP OR CONNECTOR				WILDLIFE MANAGEMENT AREA	HISTORIC DISTRICT	HISTORIC DISTRICT	HISTORIC DISTRICT	HISTORIC DISTRICT
Private	INTERSTATE EXIT				HYDROLOGIC FEATURES	HISTORIC DISTRICT	HISTORIC DISTRICT	HISTORIC DISTRICT	HISTORIC DISTRICT
National Monument	GREAT RIVER ROAD				RIVER OR STREAM (PERMANENT)	HISTORIC DISTRICT	HISTORIC DISTRICT	HISTORIC DISTRICT	HISTORIC DISTRICT
National Park					LAKE, POND OR RESERVOIR	HISTORIC DISTRICT	HISTORIC DISTRICT	HISTORIC DISTRICT	HISTORIC DISTRICT
National Wildlife Refuge					STREAM (INTERMITTENT)	HISTORIC DISTRICT	HISTORIC DISTRICT	HISTORIC DISTRICT	HISTORIC DISTRICT
State Park					DRAINAGE DITCH	HISTORIC DISTRICT	HISTORIC DISTRICT	HISTORIC DISTRICT	HISTORIC DISTRICT
Preserve					WETLAND	HISTORIC DISTRICT	HISTORIC DISTRICT	HISTORIC DISTRICT	HISTORIC DISTRICT
					ISLAND OR LAND	HISTORIC DISTRICT	HISTORIC DISTRICT	HISTORIC DISTRICT	HISTORIC DISTRICT
					REGIONAL WATERSHED	HISTORIC DISTRICT	HISTORIC DISTRICT	HISTORIC DISTRICT	HISTORIC DISTRICT



Population (U.S. Census 2010): 672

To request information from this document in an alternative format, call 651-366-4718 or 1-800-657-3774 (Greater Minnesota); 711 or 1-800-627-3529 (Minnesota Relay). You may also send an e-mail to ADAREquest.dot@state.mn.us. (Please request at least one week in advance.)