

TOWNSHIP OF FARMINGTON

PREPARED BY THE
MINNESOTA DEPARTMENT OF TRANSPORTATION
OFFICE OF TRANSPORTATION SYSTEM MANAGEMENT

IN COOPERATION WITH
U.S. DEPARTMENT OF TRANSPORTATION
FEDERAL HIGHWAY ADMINISTRATION



1 in = 1,600 ft

2022

Projection:
Transverse Mercator
NAD 1986
UTM Zone 15

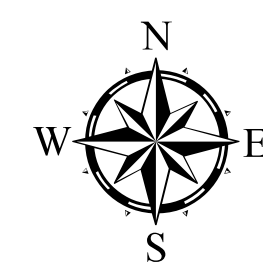

North American Datum
of 1986

ROAD AND ROADWAY FEATURES		BOUNDARY FEATURES	
INTERSTATE	CONCRETE	TRIBAL LAND	SECTION
US HIGHWAY	BITUMINOUS	STATE OF MINNESOTA	MILITARY
MN HIGHWAY	GRAVEL	COUNTY	VOYAGEURS NATIONAL PARK
COUNTY STATE AID HIGHWAY	DIRT/UNIMPROVED	MUNICIPALITY	BOUNDARY WATERS CANOE AREA WILDERNESS
COUNTY ROAD	OTHER	UNINCORPORATED TOWNSHIP	STATE PARK
TOWNSHIP ROAD	UNKNOWN	CIVIL TOWNSHIP	NATIONAL FOREST
UNORGANIZED TERRITORY ROAD		CONGRESSIONAL TOWNSHIP	NATIONAL AND STATE FOREST
OTHER ROADS			STATE FOREST
Municipal	RAMP OR CONNECTOR		WILDLIFE REFUGUE AREA
Private	INTERSTATE EXIT		WILDLIFE MANAGEMENT AREA
National Monument	GREAT RIVER ROAD		HYDROLOGIC FEATURES
National Wildlife			RIVER OR STREAM (PERMANENT)
State Game			LAKE, POND OR RESERVOIR
State Park			STREAM (INTERMITTENT)
Preserve			DRAINAGE DITCH
			WETLAND
			ISLAND OR LAND
			REGIONAL WATERSHED
RAILROAD AND RAILWAY FEATURES		AVIATION FEATURES	
EMPIRE BUILDER STATION (AMTRAK)	COMMERCIAL AIRPORT	GENERAL AIRPORT	
NORTHSTAR STATION (COMMUTER)	AIRSTRIP	AIRSTRIP	
	SEAPLANE	SEAPLANE	
	AIRPORT RUNWAY	AIRPORT RUNWAY	
INFRASTRUCTURE FEATURES		CITY CENTERS	
LONG BRIDGE (200' OR GREATER SPAN)	STATE CAPITAL	COUNTY SEAT	CITY CENTER
MAJOR BRIDGE (20' TO 200' SPAN)	UNINCORPORATED COMMUNITY		
MINOR BRIDGE (5' TO 20' SPAN)			
DAM			
LOCK AND DAM			
PUBLIC SERVICE FEATURES		CULTURAL FEATURES	
MNDOT OFFICE	STATE HISTORICAL MARKER	HISTORIC DISTRICT	
MNDOT TRUCK STATION	HISTORIC SITE	MONUMENT	
HIGHWAY PATROL DISTRICT OFFICE			
STATE TRAVEL INFORMATION CENTER			
REST AREA (FULL SERVICE)			
REST AREA (VAULT TOILET)			
WAYSIDE (VAULT OR PIT TOILET)			
PARK AND RIDE LOT			
PORT OF ENTRY			
PUBLIC ACCESS POINT			
MN STATE COLLEGE AND UNIVERSITY SYSTEM (MNSCU)			
UNIVERSITY OF MN SYSTEM			
FAIRGROUNDS			

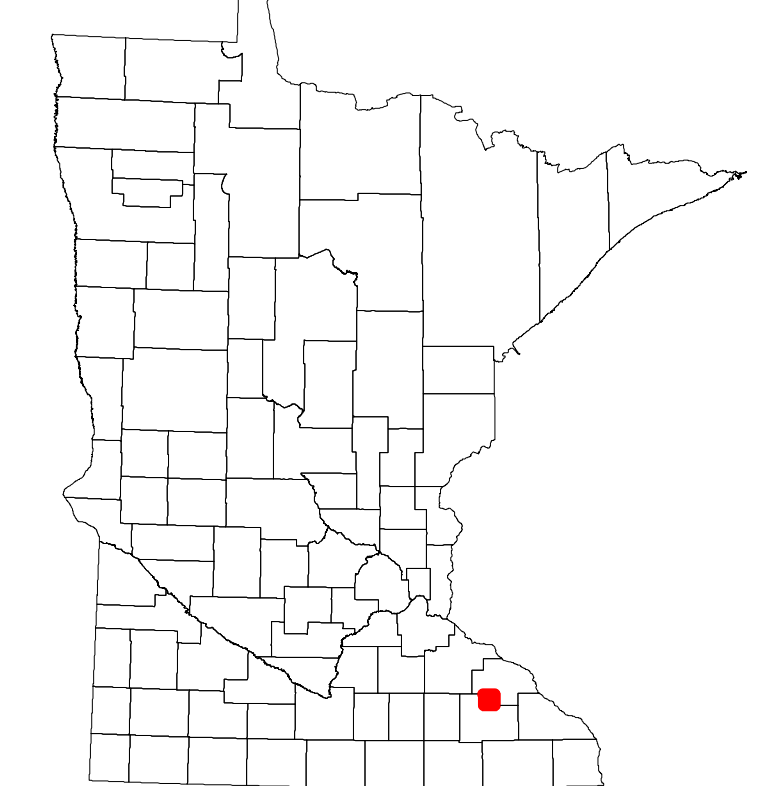

Population (U.S. Census 2010): 444

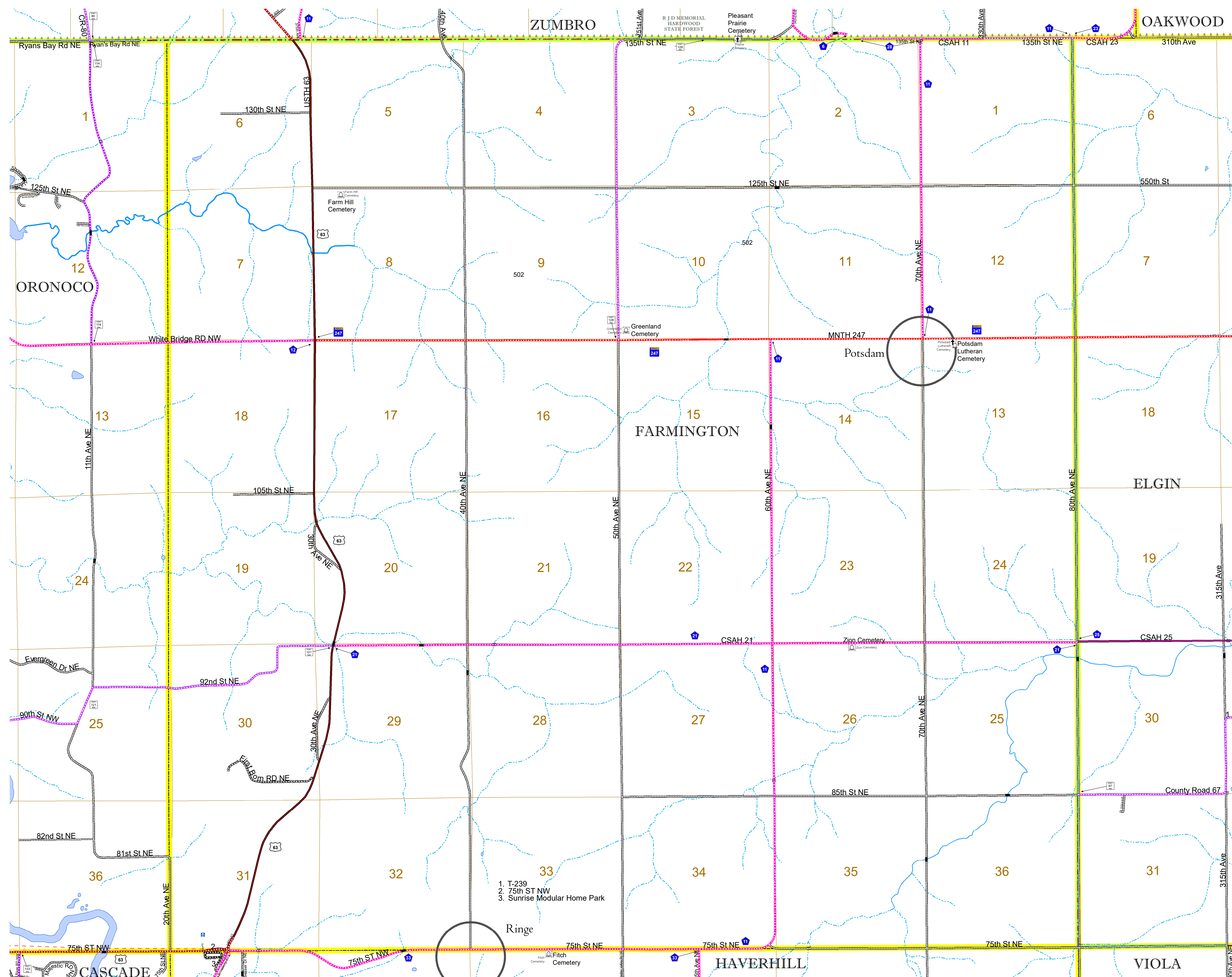

1. T-239
2. 75th St NW
3. Sunrise Modular Home Park

To request information from this document in an alternative format, call 651-366-4718 or 1-800-657-3774 (Greater Minnesota); 711 or 1-800-627-3529 (Minnesota Relay). You may also send an e-mail to ADarequest.dot@state.mn.us. (Please request at least one week in advance.)