

TOWNSHIP OF QUINCY

PREPARED BY THE
MINNESOTA DEPARTMENT OF TRANSPORTATION
OFFICE OF TRANSPORTATION SYSTEM MANAGEMENT

IN COOPERATION WITH
U.S. DEPARTMENT OF TRANSPORTATION
FEDERAL HIGHWAY ADMINISTRATION

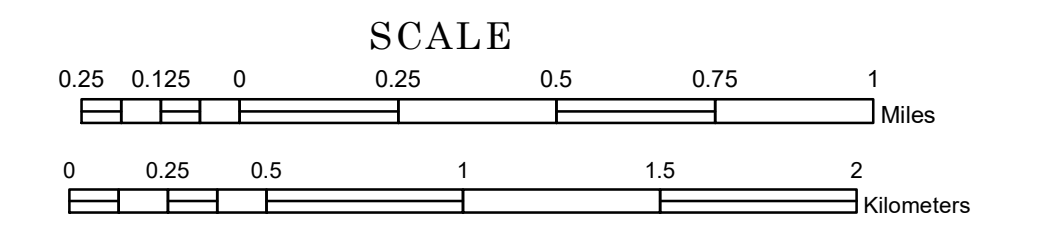

1 in = 1,600 ft
2022

Projection:
Transverse Mercator
NAD 1986
UTM Zone 15

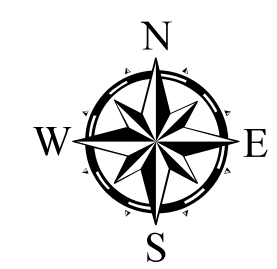

North American Datum
of 1986

ROAD AND ROADWAY FEATURES		AVIATION FEATURES	
INTERSTATE	CONCRETE	COMMERCIAL AIRPORT	GENERAL AIRPORT
US HIGHWAY	BITUMINOUS	AIRSTRIP	AIRSTRIP
MN HIGHWAY	GRAVEL	SEAPLANE	SEAPLANE
COUNTY STATE AID HIGHWAY	DIRT/UNIMPROVED	AIRPORT RUNWAY	AIRPORT RUNWAY
COUNTY ROAD	OTHER		
TOWNSHIP ROAD	UNKNOWN		
UNORGANIZED TERRITORY ROAD			
OTHER ROADS			
Municipal	RAMP OR CONNECTOR		
Private	INTERSTATE EXIT		
National Monument	GREAT RIVER ROAD		
National Wildlife			
State Game			
Military			
RAILROAD AND RAILWAY FEATURES		BOUNDARY FEATURES	
EMPIRE BUILDER STATION (AMTRAK)	TRIBAL LAND	STATE OF MINNESOTA	COUNTY
NORTHSTAR STATION (COMMUTER)	STATE OF MINNESOTA	MUNICIPALITY	MUNICIPALITY
LIGHT RAIL	COUNTY	UNORGANIZED TERRITORY	FEDERAL ADJUSTED URBAN AREA (2014)
BLUE LINE	CITY CENTER	CIVIL TOWNSHIP	CIVIL TOWNSHIP
GREEN LINE	CITY CENTER	CONGRESSIONAL TOWNSHIP	CONGRESSIONAL TOWNSHIP
	CITY CENTER	SECTION	MILITARY
	CITY CENTER	SECTION	VOYAGEURS NATIONAL PARK
	CITY CENTER	SECTION	BOUNDARY WATERS CANOE AREA WILDERNESS
	CITY CENTER	SECTION	STATE PARK
	CITY CENTER	SECTION	REGIONAL PARK
	CITY CENTER	SECTION	NATIONAL FOREST
	CITY CENTER	SECTION	NATIONAL AND STATE FOREST
	CITY CENTER	SECTION	STATE FOREST
	CITY CENTER	SECTION	NATIONAL TRAIL
	CITY CENTER	SECTION	WILDLIFE REFUGUE AREA
	CITY CENTER	SECTION	WILDLIFE MANAGEMENT AREA
	CITY CENTER	SECTION	HYDROLOGIC FEATURES
	CITY CENTER	SECTION	RIVER OR STREAM (PERENNIAL)
	CITY CENTER	SECTION	LAKE, POND OR RESERVOIR
	CITY CENTER	SECTION	STREAM (INTERMITTENT)
	CITY CENTER	SECTION	DRAINAGE DITCH
	CITY CENTER	SECTION	WETLAND
	CITY CENTER	SECTION	ISLAND OR LAND
	CITY CENTER	SECTION	REGIONAL WATERSHED

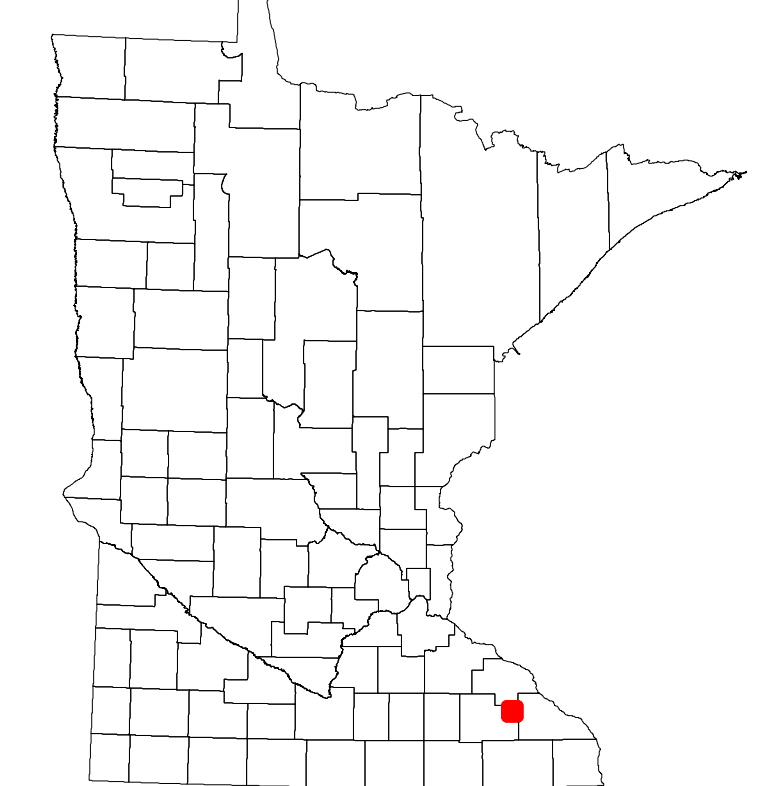

Population (U.S. Census 2010): 339

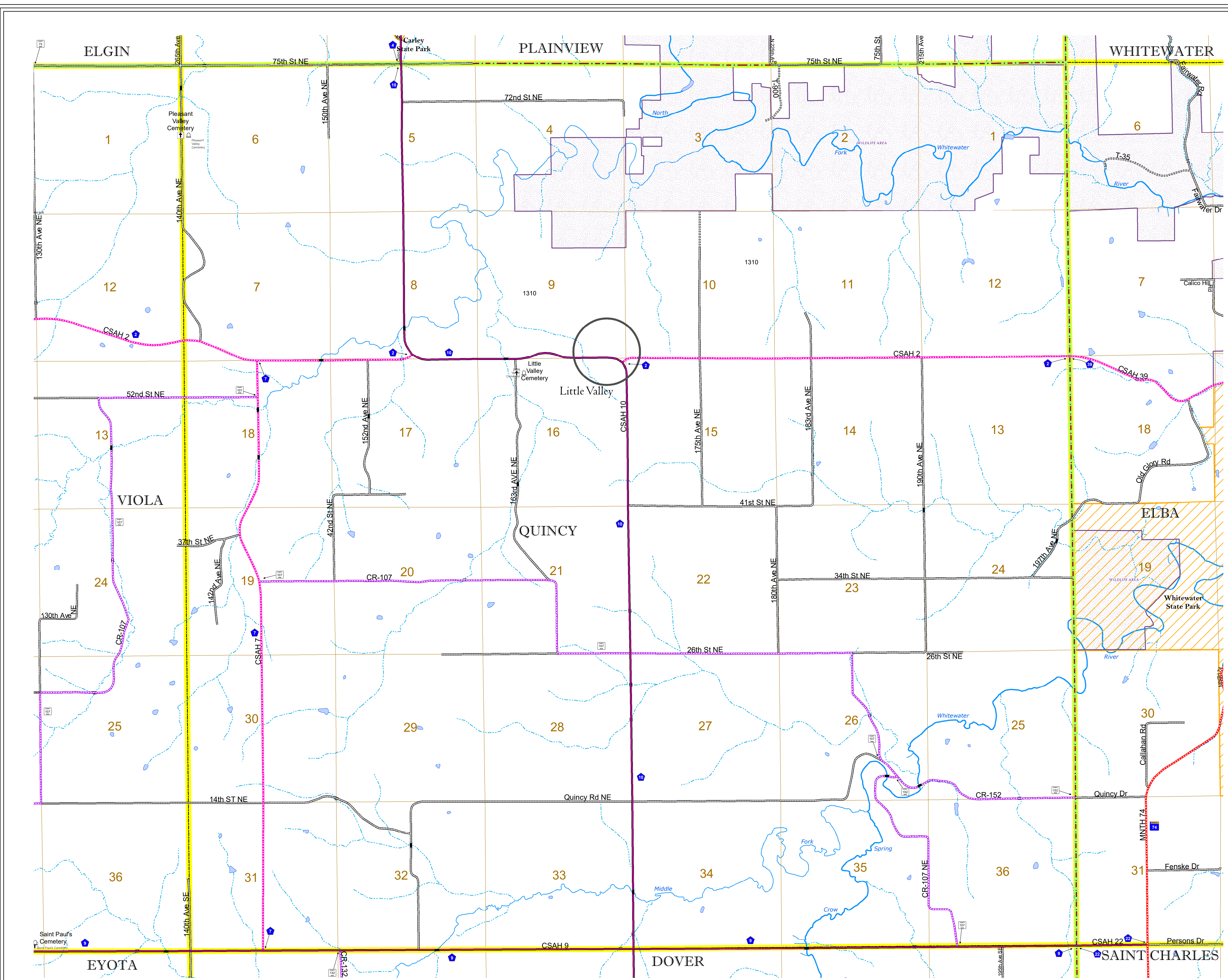

To request information from this document in an alternative format, call 651-366-4718 or 1-800-657-3774 (Greater Minnesota); 711 or 1-800-627-3529 (Minnesota Relay). You may also send an e-mail to ADRequest.dot@state.mn.us. (Please request at least one week in advance.)