

# TOWNSHIP OF RUSH LAKE

PREPARED BY THE  
MINNESOTA DEPARTMENT OF TRANSPORTATION  
OFFICE OF TRANSPORTATION SYSTEM MANAGEMENT

IN COOPERATION WITH  
U.S. DEPARTMENT OF TRANSPORTATION  
FEDERAL HIGHWAY ADMINISTRATION

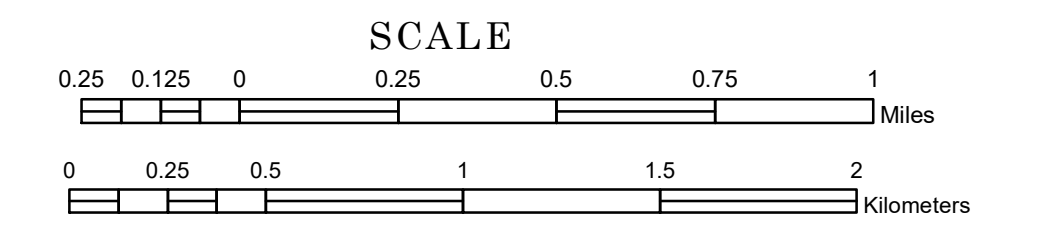

2022

Projection:  
Transverse Mercator  
NAD 1986  
UTM Zone 15

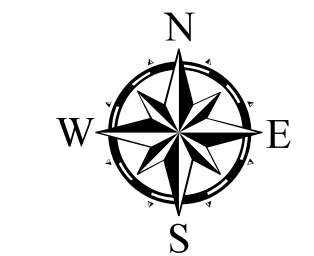

North American Datum  
of 1986

ROAD AND ROADWAY FEATURES	RAILROAD AND RAILWAY FEATURES	AVIATION FEATURES	BOUNDARY FEATURES
INTERSTATE	EMPIRE BUILDER STATION (AMTRAK)	COMMERCIAL AIRPORT	TRIBAL LAND
US HIGHWAY	NORTHSTAR STATION (COMMITTEE)	GENERAL AIRPORT	STATE OF MINNESOTA
MN HIGHWAY	LIGHT RAIL	AIRSTRIP	COUNTY
COUNTY STATE AID HIGHWAY	BLUE LINE	SEAPLANE	MUNICIPALITY
COUNTY ROAD	GREEN LINE	AIRPORT RUNWAY	UNORGANIZED TERRITORY
TOWNSHIP ROAD	LONG BRIDGE (200' OR GREATER SPAN)		FEDERAL ADJUSTED URBAN AREA (2014)
UNORGANIZED TERRITORY ROAD	MAJOR BRIDGE (20' TO 200' SPAN)		CIVIL TOWNSHIP
OTHER ROADS	MINOR BRIDGE (5' TO 20' SPAN)		CONGRESSIONAL TOWNSHIP
MUNICIPAL	DAM		SECTION
PRIVATE	LOCK AND DAM		MILITARY
NATIONAL MONUMENT			VOYAGEURS NATIONAL PARK
NATIONAL WILDLIFE REFUGE			BOUNDARY WATERS CANOE AREA WILDERNESS
STATE FOREST			STATE PARK
STATE TRAIL			REGIONAL PARK
WILDLIFE REFUGE AREA			NATIONAL FOREST
WILDLIFE MANAGEMENT AREA			NATIONAL AND STATE FOREST
HYDROLOGIC FEATURES			STATE FOREST
RIVER OR STREAM (PERMANENT)			NATIONAL TRAIL
LAKE, POND OR RESERVOIR			WILDLIFE REFUGE AREA
STREAM (INTERMITTENT)			WILDLIFE MANAGEMENT AREA
DRAINAGE DITCH			CULTURAL FEATURES
WETLAND			STATE HISTORICAL MARKER
ISLAND OR LAND			HISTORIC DISTRICT
REGIONAL WATERSHED			HISTORIC SITE
			MONUMENT

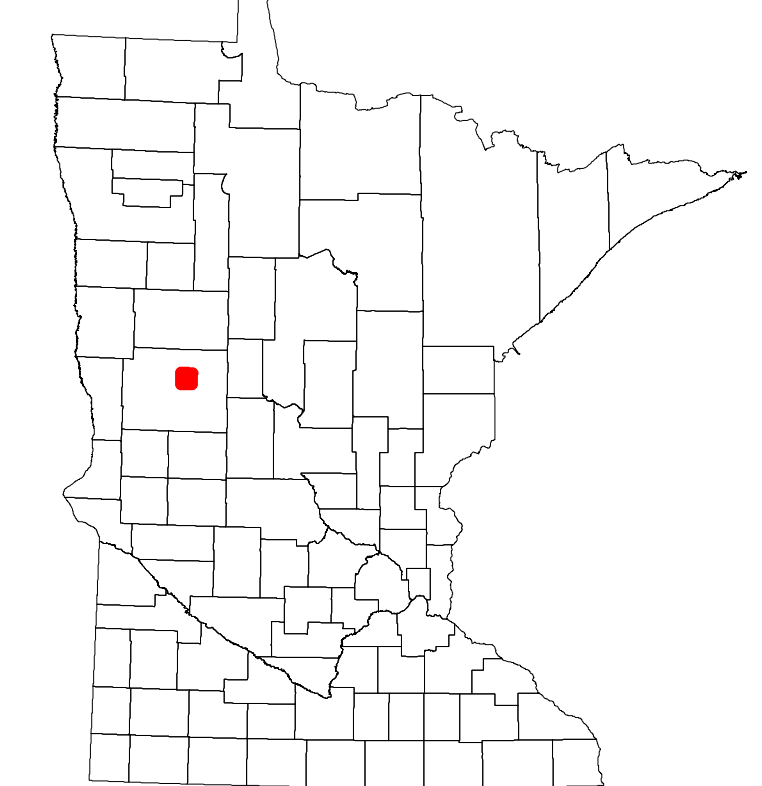

Population (U.S. Census 2010): 970

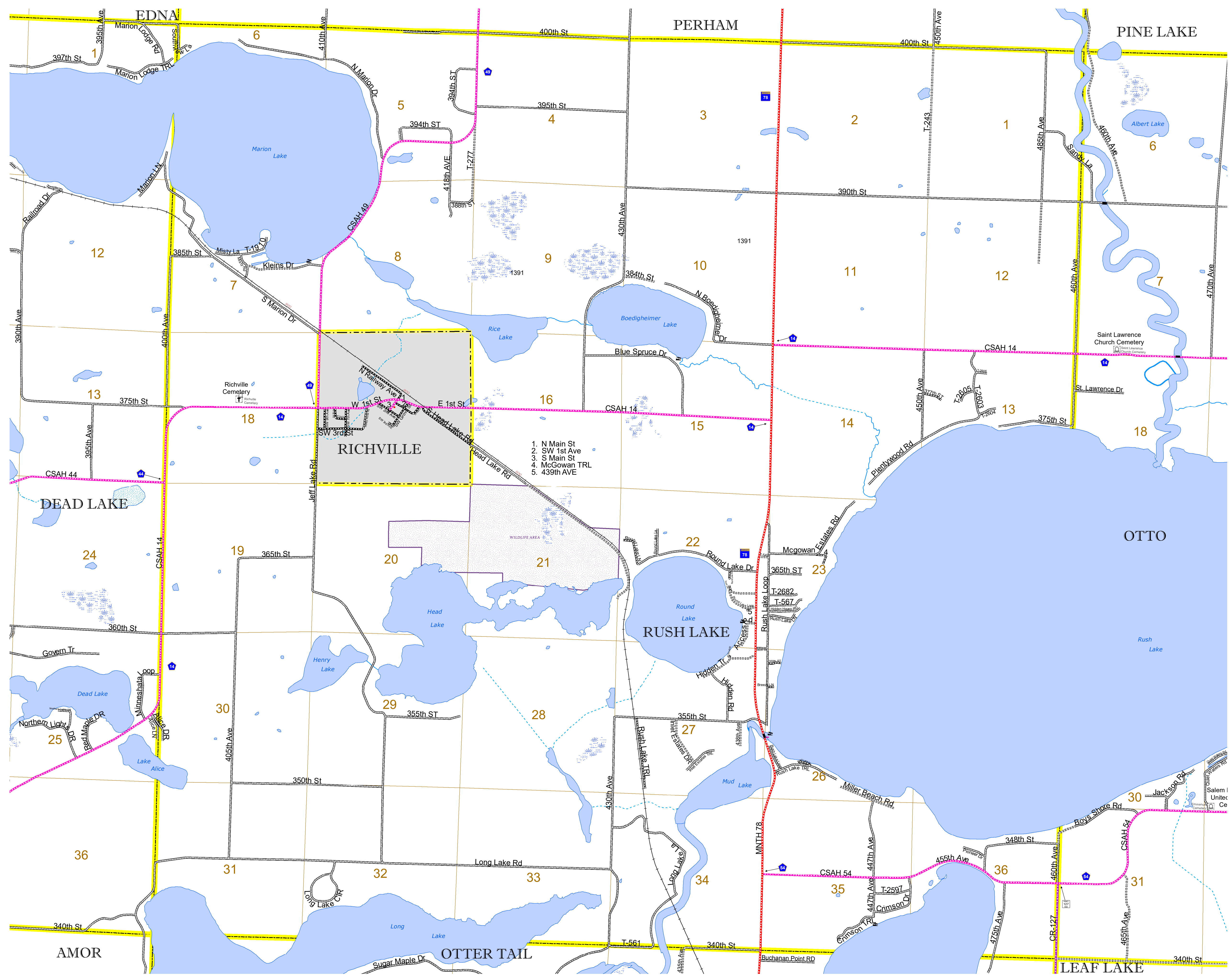

1. N Main St
2. SW 1st Ave
3. S Main St
4. McGowan TRL
5. 439th AVE

To request information from this document in an alternative format, call 651-366-4718 or 1-800-657-3774 (Greater Minnesota); 711 or 1-800-627-3529 (Minnesota Relay). You may also send an e-mail to ADarequest.dot@state.mn.us. (Please request at least one week in advance.)