

# TOWNSHIP OF MICKINOCK

PREPARED BY THE  
MINNESOTA DEPARTMENT OF TRANSPORTATION  
OFFICE OF TRANSPORTATION SYSTEM MANAGEMENT

IN COOPERATION WITH  
U.S. DEPARTMENT OF TRANSPORTATION  
FEDERAL HIGHWAY ADMINISTRATION



1 in = 2,000 ft

2022

Projection:  
Transverse Mercator  
NAD 1986  
UTM Zone 15



North American Datum  
of 1986

ROAD AND ROADWAY FEATURES		BOUNDARY FEATURES	
INTERSTATE	CONCRETE	TRIBAL LAND	STATE OF MINNESOTA
US HIGHWAY	BITUMINOUS	COUNTY	MUNICIPALITY
MN HIGHWAY	GRAVEL	UNORGANIZED TERRITORY	FEDERAL ADJUSTED URBAN AREA (2014)
COUNTY STATE AID HIGHWAY	DIRT/UNIMPROVED	CIVIL TOWNSHIP	CONGRESSIONAL TOWNSHIP
COUNTY ROAD	OTHER	SECTION	MILITARY
TOWNSHIP ROAD	UNKNOWN	VOYAGEURS NATIONAL PARK	BOUNDARY WATERS CANOE AREA WILDERNESS
UNORGANIZED TERRITORY ROAD		STATE PARK	REGIONAL PARK
OTHER ROADS		NATIONAL FOREST	NATIONAL AND STATE FOREST
Municipal	RAMP OR CONNECTOR	STATE FOREST	NATIONAL TRAIL
Private	INTERSTATE EXIT	WILDLIFE REFUGUE AREA	WILDLIFE MANAGEMENT AREA
National Monument	GENERAL AIRPORT	WILDLIFE REFUGUE AREA	WILDLIFE MANAGEMENT AREA
National Park	AIRSTRIP	HYDROLOGIC FEATURES	HYDROLOGIC FEATURES
National Wildlife Refuge	SEAPLANE	RIVER OR STREAM (PERMANENT)	LAKE, POND OR RESERVOIR
Mulden	AIRPORT RUNWAY	STATE HISTORICAL MARKER	DRAINAGE DITCH
Preserve		HISTORIC DISTRICT	WETLAND
RAILROAD AND RAILWAY FEATURES		HISTORIC SITE	ISLAND OR LAND
EMPIRE BUILDER STATION (AMTRAK)	COMMERCIAL AIRPORT	MONUMENT	REGIONAL WATERSHED
NORTHSTAR STATION (COMPUTER)	GENERAL AIRPORT		
LIGHT RAIL	AIRSTRIP		
BLUE LINE	SEAPLANE		
GREEN LINE	AIRPORT RUNWAY		
INFRASTRUCTURE FEATURES			
LONG BRIDGE (200' OR GREATER SPAN)	TRIBAL LAND		
MAJOR BRIDGE (20' TO 200' SPAN)	STATE OF MINNESOTA		
MINOR BRIDGE (5' TO 20' SPAN)	COUNTY		
DAM	MUNICIPALITY		
LOCK AND DAM	UNORGANIZED TERRITORY		
	FEDERAL ADJUSTED URBAN AREA (2014)		
	CIVIL TOWNSHIP		
	CONGRESSIONAL TOWNSHIP		
	SECTION		
	MILITARY		
	VOYAGEURS NATIONAL PARK		
	BOUNDARY WATERS CANOE AREA WILDERNESS		
	STATE PARK		
	REGIONAL PARK		
	NATIONAL FOREST		
	NATIONAL AND STATE FOREST		
	STATE FOREST		
	NATIONAL TRAIL		
	WILDLIFE REFUGUE AREA		
	WILDLIFE MANAGEMENT AREA		
	HYDROLOGIC FEATURES		
	RIVER OR STREAM (PERMANENT)		
	LAKE, POND OR RESERVOIR		
	STREAM (INTERMITTENT)		
	DRAINAGE DITCH		
	WETLAND		
	ISLAND OR LAND		
	REGIONAL WATERSHED		

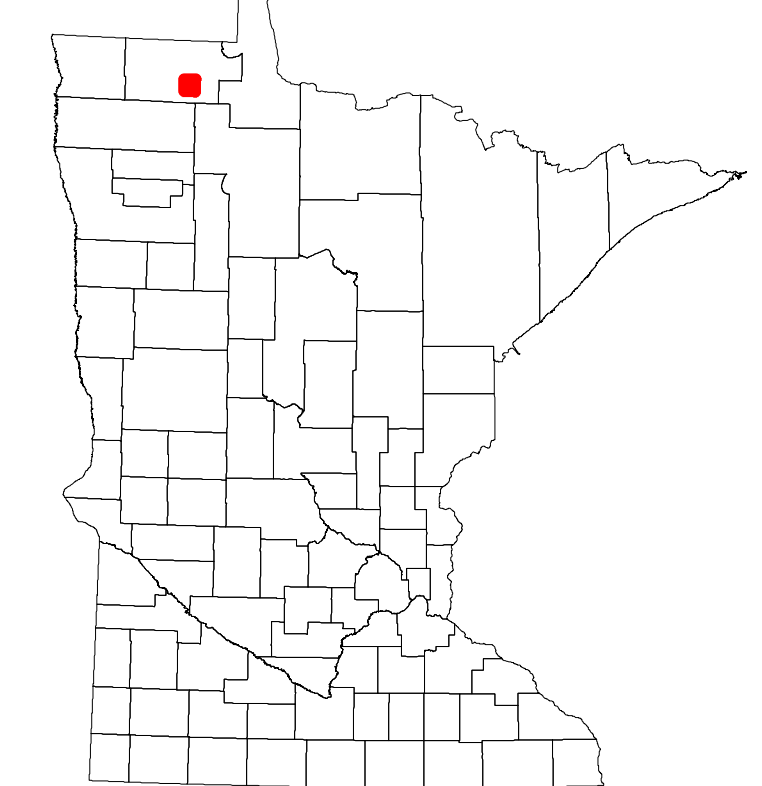

Population (U.S. Census 2010): 301

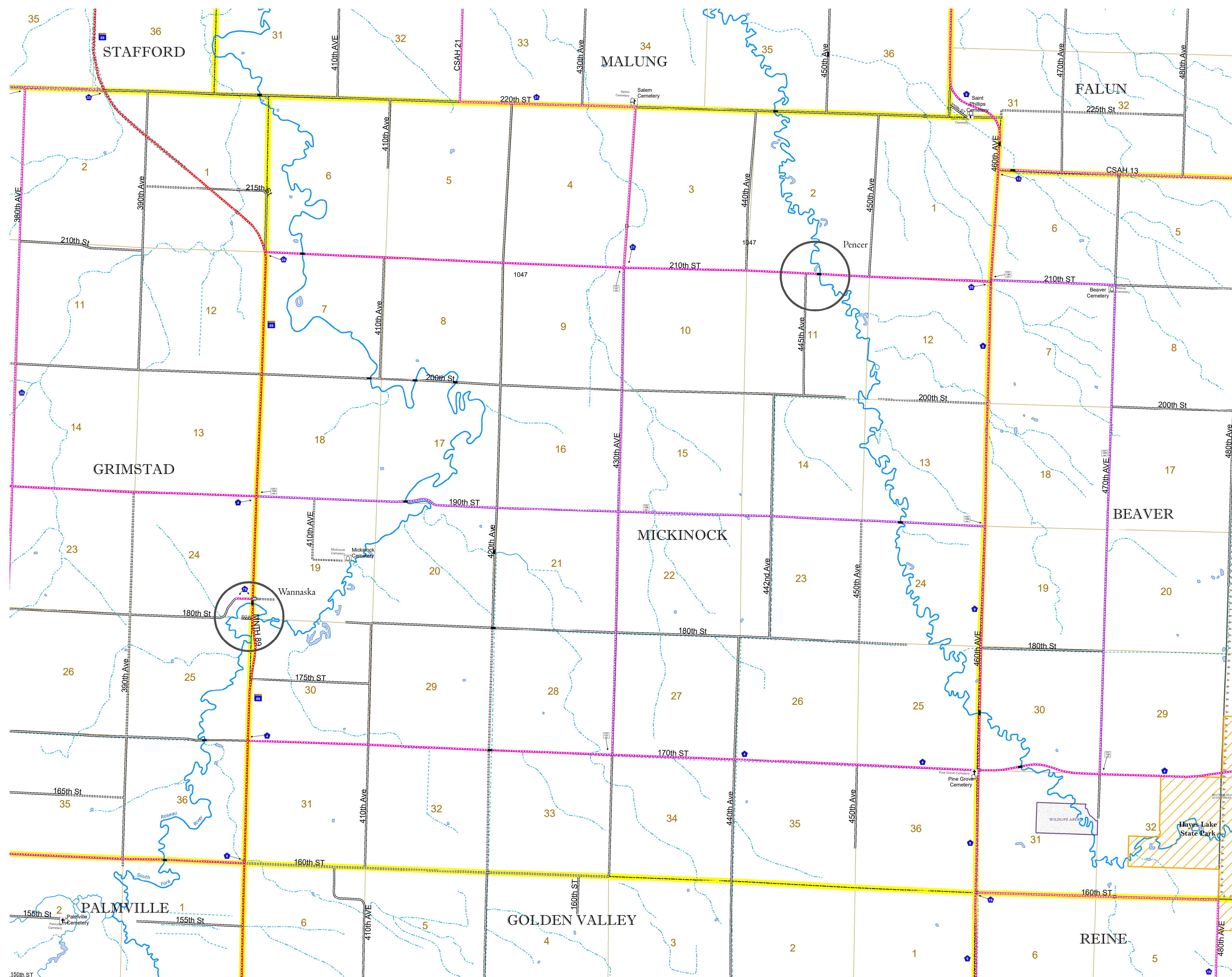

To request information from this document in an alternative format, call 651-366-4718 or 1-800-657-3774 (Greater Minnesota); 711 or 1-800-627-3529 (Minnesota Relay). You may also send an e-mail to ADAREquest.dot@state.mn.us. (Please request at least one week in advance.)