

LAVELL

MCDAVITT

ELLSBURG

# TOWNSHIP OF KELSEY

PREPARED BY THE  
MINNESOTA DEPARTMENT OF TRANSPORTATION  
OFFICE OF TRANSPORTATION SYSTEM MANAGEMENT

IN COOPERATION WITH  
U.S. DEPARTMENT OF TRANSPORTATION  
FEDERAL HIGHWAY ADMINISTRATION

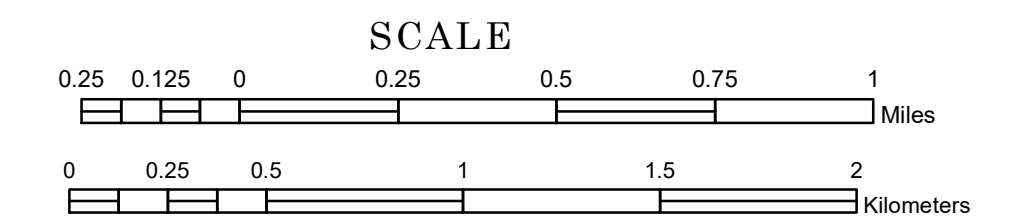

1 in = 1,600 ft

2022

Projection:  
Transverse Mercator  
NAD 1986  
UTM Zone 15

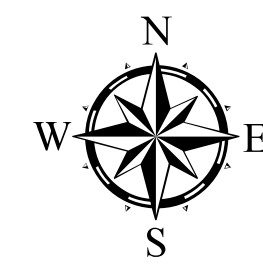

North American Datum  
of 1986

ROAD AND ROADWAY FEATURES			
INTERSTATE	CONCRETE		
US HIGHWAY	BITUMINOUS		
MN HIGHWAY	GRAVEL		
COUNTY STATE AID HIGHWAY	DIRT/UNIMPROVED		
COUNTY ROAD	OTHER		
TOWNSHIP ROAD	UNKNOWN		
UNORGANIZED TERRITORY ROAD			
OTHER ROADS	RAMP OR CONNECTOR		
Municipal	Private	National Monument	State Forest
Nature Service	National Park	National Wildlife	State Game
Military	National Forest	State Park	Preserve
RAILROAD AND RAILWAY FEATURES			
EMPIRE BUILDER STATION (AMTRAK)	COMMERCIAL AIRPORT		
NORTHSTAR STATION (COMPUTER)	GENERAL AIRPORT		
LIGHT RAIL	AIRSTRIP		
BLUE LINE	SEAPLANE		
GREEN LINE	AIRPORT RUNWAY		
INFRASTRUCTURE FEATURES			
LONG BRIDGE (200' or Greater Span)	TRIBAL LAND		
MAJOR BRIDGE (20' to 200' Span)	STATE OF MINNESOTA		
MINOR BRIDGE (5' to 20' Span)	COUNTY		
LOCK AND DAM	MUNICIPALITY		
CITY CENTERS			
STATE CAPITAL	COUNTY SEAT	CITY CENTER	UNINCORPORATED COMMUNITY
PUBLIC SERVICE FEATURES			
MNDOT OFFICE	MNDOT TRUCK STATION	HIGHWAY PATROL DISTRICT OFFICE	STATE TRAVEL INFORMATION CENTER
REST AREA (Full Service)	REST AREA (Vault Toilet)	WAYSIDE (Vault or P/T Toilet)	PARK AND RIDE LOT
PORT OF ENTRY	PUBLIC ACCESS POINT	MN STATE COLLEGE AND UNIVERSITY SYSTEM (MNSCU)	UNIVERSITY OF MN SYSTEM
FAIRGROUNDS	CULTURAL FEATURES		
STATE HISTORICAL MARKER	HISTORIC DISTRICT	HISTORIC SITE	MONUMENT
BOUNDARY FEATURES		HYDROLOGIC FEATURES	
STATE OF MINNESOTA	COUNTY	MUNICIPALITY	UNORGANIZED TERRITORY
FEDERAL ADJUSTED URBAN AREA (2014)	CIVIL TOWNSHIP	CONGRESSIONAL TOWNSHIP	SECTION
MILITARY	VOYAGEURS NATIONAL PARK	BOUNDARY WATERS CANOE AREA WILDERNESS	STATE PARK
REGIONAL PARK	NATIONAL FOREST	NATIONAL AND STATE FOREST	STATE FOREST
NATIONAL TRAIL	WILDLIFE REFUGUE AREA	WILDLIFE MANAGEMENT AREA	HYDROLOGIC FEATURES
RIVER OR STREAM (PERMANENT)	LAKE, POND OR RESERVOIR	STREAM (INTERMITTENT)	DRAINAGE DITCH
WETLAND	ISLAND OR LAND	REGIONAL WATERSHED	

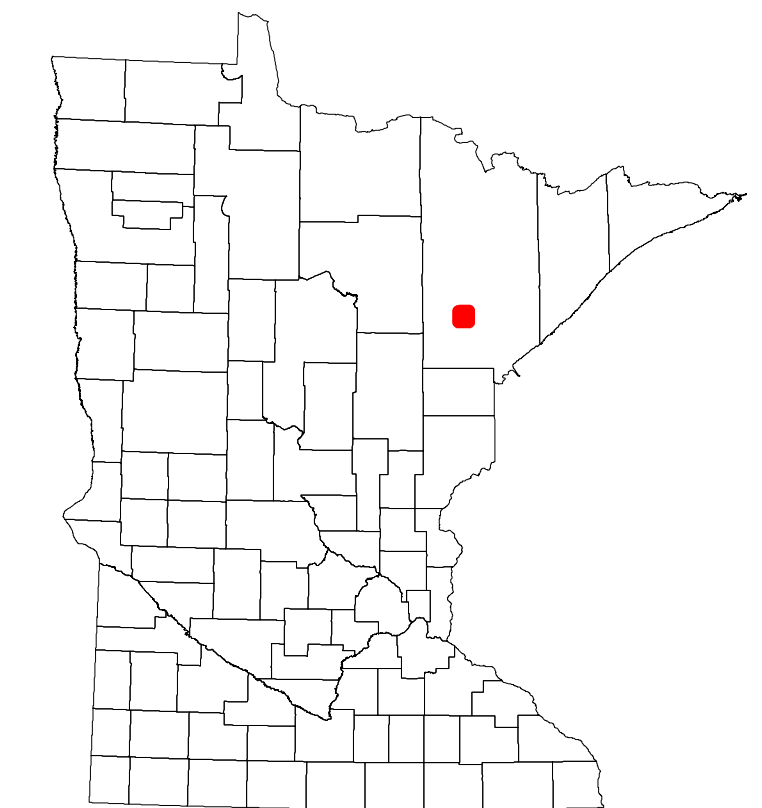

Population (U.S. Census 2010): 140

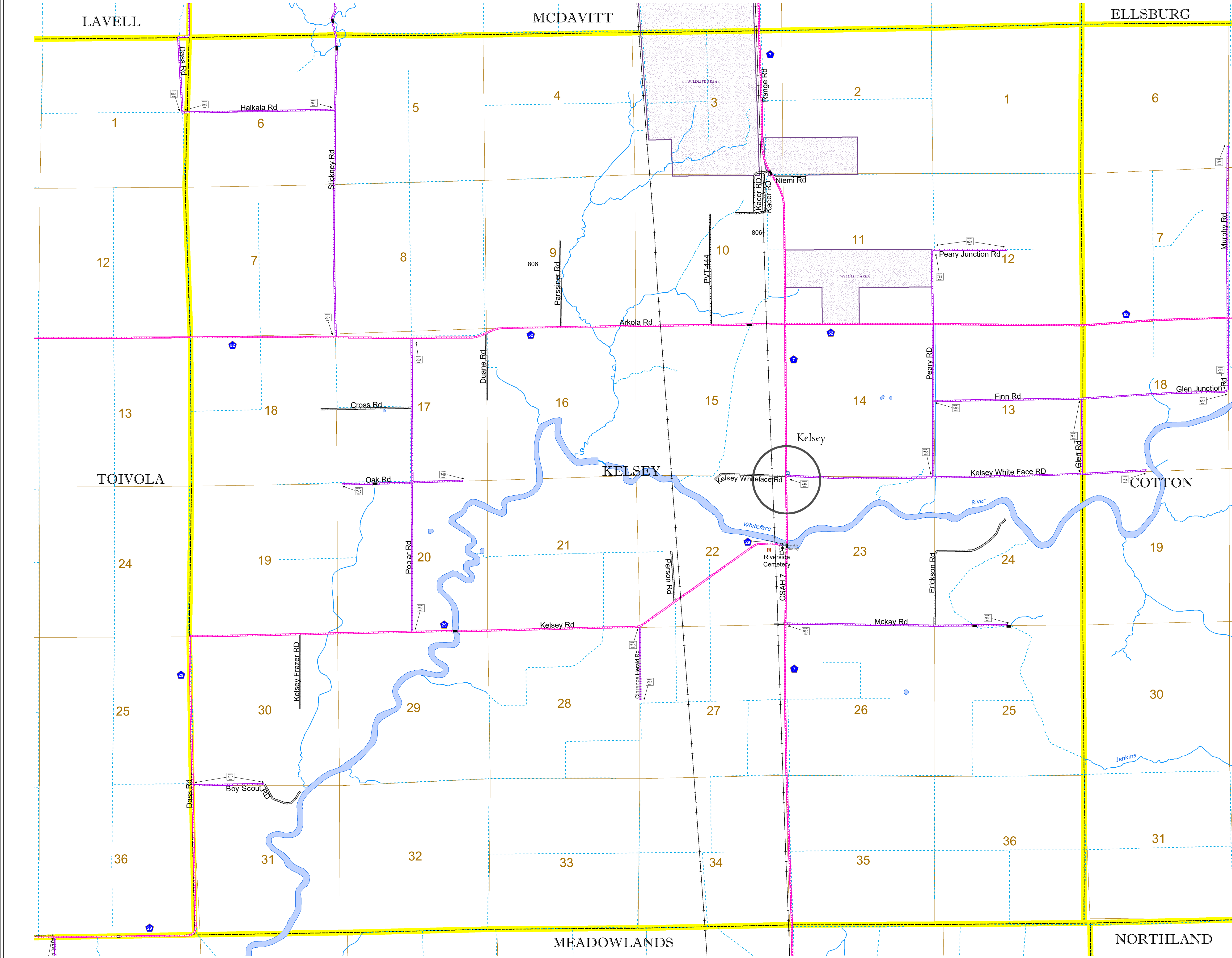

To request information from this document in an alternative format, call 651-366-4718 or 1-800-657-3774 (Greater Minnesota); 711 or 1-800-627-3529 (Minnesota Relay). You may also send an e-mail to ADArequest.dot@state.mn.us. (Please request at least one week in advance.)