

TOWNSHIP OF HELENA

PREPARED BY THE
MINNESOTA DEPARTMENT OF TRANSPORTATION
OFFICE OF TRANSPORTATION SYSTEM MANAGEMENT

IN COOPERATION WITH
U.S. DEPARTMENT OF TRANSPORTATION
FEDERAL HIGHWAY ADMINISTRATION

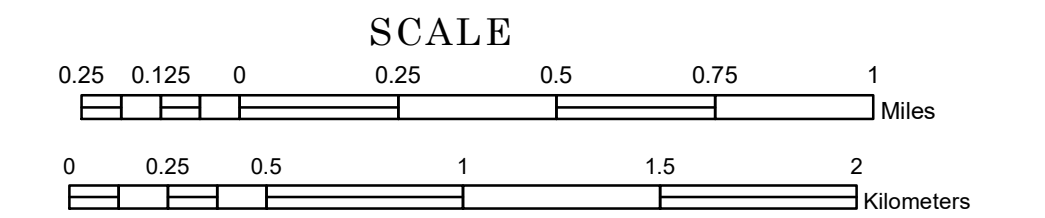

1 in = 1,600 ft
2022

Projection:
Transverse Mercator
NAD 1986
UTM Zone 15

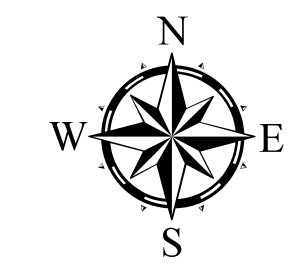

North American Datum
of 1986

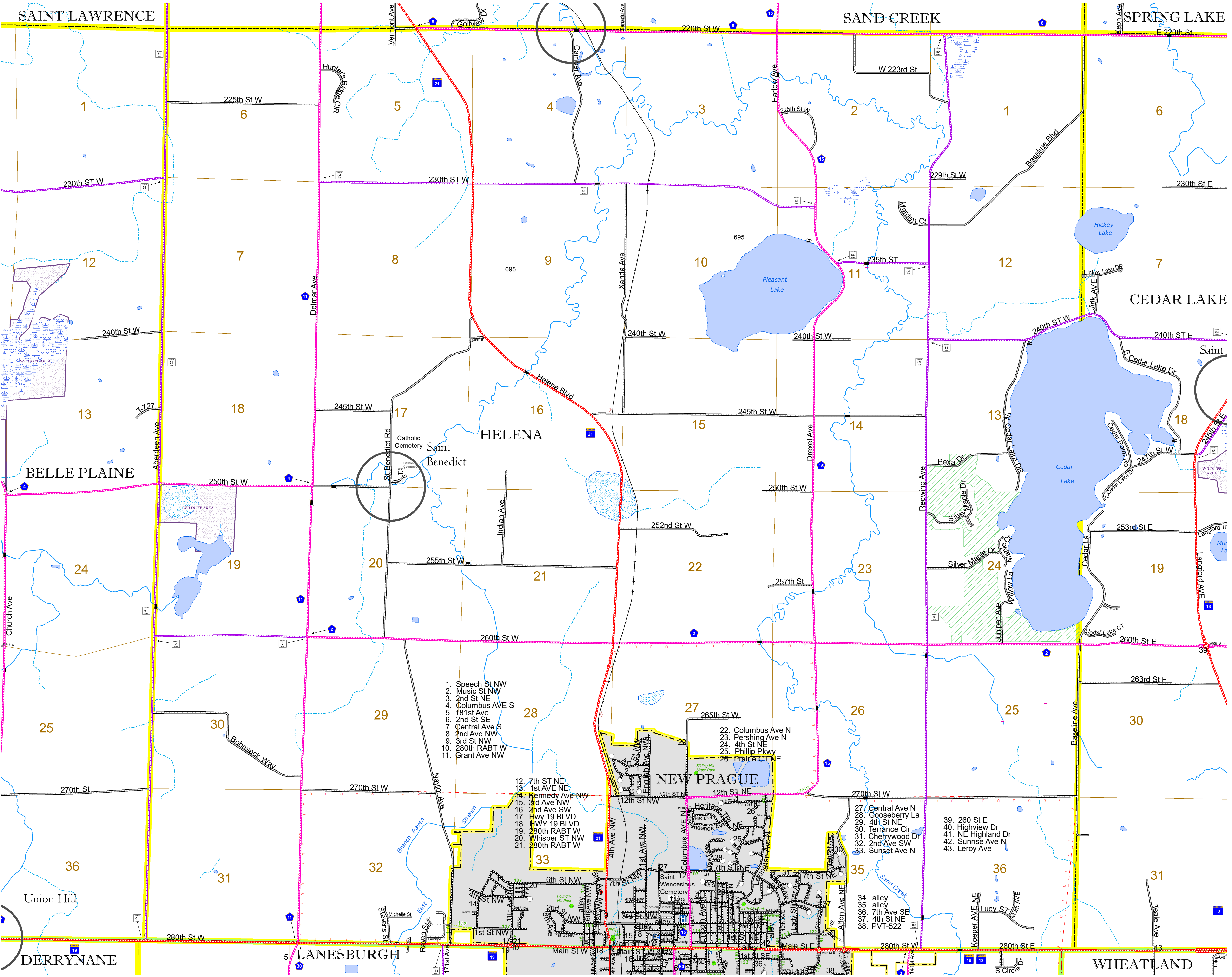

ROAD AND ROADWAY FEATURES		
INTERSTATE	CONCRETE	
US HIGHWAY	BITUMINOUS	
MN HIGHWAY	GRAVEL	
COUNTY STATE AID HIGHWAY	DIRT/UNIMPROVED	
COUNTY ROAD	OTHER	
TOWNSHIP ROAD	UNKNOWN	
UNORGANIZED TERRITORY ROAD		
OTHER ROADS		
MUNICIPAL	RAMP OR CONNECTOR	
PRIVATE	STATE FOREST	
NATIONAL MONUMENT	NATIONAL WILDLIFE REFUGES	
NATIONAL PARK	NATIONAL FOREST	
NATIONAL WILDLIFE REFUGES	STATE PARK	
NATIONAL FOREST	PRESERVE	
RAILROAD AND RAILWAY FEATURES		
EMPIRE BUILDER STATION (AMTRAK)	COMMERCIAL AIRPORT	
NORTHSTAR STATION (COMMUTER)	GENERAL AIRPORT	
LIGHT RAIL		
BLUE LINE	AIRSTRIP	
GREEN LINE	SEAPLANE	
INFRASTRUCTURE FEATURES		
LONG BRIDGE (200' OR GREATER SPAN)	AIRPORT RUNWAY	
MAJOR BRIDGE (20' TO 200' SPAN)	BOUNDARY FEATURES	
MINOR BRIDGE (5' TO 20' SPAN)	TRIBAL LAND	
DAM	STATE OF MINNESOTA	
LOCK AND DAM	COUNTY	
CITY CENTERS		
STATE CAPITAL	MUNICIPALITY	
COUNTY SEAT	UNORGANIZED TERRITORY	
CITY CENTER	FEDERAL ADJUSTED URBAN AREA (2014)	
UNINCORPORATED COMMUNITY	CIVIL TOWNSHIP	
PUBLIC SERVICE FEATURES		
MNDOT OFFICE	CONGRESSIONAL TOWNSHIP SECTION	
MNDOT TRUCK STATION	MILITARY	
HIGHWAY PATROL DISTRICT OFFICE	VOYAGEURS NATIONAL PARK	
STATE TRAVEL INFORMATION CENTER	BOUNDARY WATERS CANOE AREA WILDERNESS	
REST AREA (FULL SERVICE)	STATE PARK	
REST AREA (VAULT TOILET)	NATIONAL FOREST	
WAYSIDE (VAULT OR PVI TOILET)	NATIONAL AND STATE FOREST	
PARK AND RIDE LOT	STATE FOREST	
PORT OF ENTRY	NATIONAL TRAIL	
PUBLIC ACCESS POINT	WILDLIFE REFUGE AREA	
MN STATE COLLEGE AND UNIVERSITY SYSTEM (MNSCU)	WILDLIFE MANAGEMENT AREA	
UNIVERSITY OF MN SYSTEM	HYDROLOGIC FEATURES	
FAIRGROUNDS	RIVER OR STREAM (PERMANENT)	
CULTURAL FEATURES		
STATE HISTORICAL MARKER	LAKE, POND OR RESERVOIR	
HISTORIC DISTRICT	STREAM (INTERMITTENT)	
HISTORIC SITE	DRAINAGE DITCH	
MONUMENT	WETLAND	
	ISLAND OR LAND	
	REGIONAL WATERSHED	

- 1. Speech St NW
- 2. Music St NW
- 3. 2nd St NE
- 4. Columbus AVE S
- 5. 181st Ave
- 6. 2nd St SE
- 7. Central Ave S
- 8. 2nd Ave NW
- 9. 3rd St NW
- 10. 280th RABT W
- 11. Grant Ave NW
- 12. 7th St NE
- 13. 1st AVE NE
- 14. Remedy Ave NW
- 15. 3rd Ave NW
- 16. 2nd Ave SW
- 17. Hwy 19 BLVD
- 18. HWY 19 BLVD
- 19. 280th RABT W
- 20. Whisper St NW
- 21. 280th RABT W
- 22. Columbus Ave N
- 23. Pershing Ave N
- 24. 4th St NE
- 25. Philip Pkwy
- 26. Prairie Ct NE
- 27. Central Ave N
- 28. Gooseberry La
- 29. 4th St NE
- 30. Terrace Cir
- 31. Cherrywood Dr
- 32. 2nd Ave SW
- 33. Sunset Ave N
- 34. alley
- 35. alley
- 36. 7th Ave SE
- 37. 4th St NE
- 38. PVT-522
- 39. 260 St E
- 40. Highview Dr
- 41. NE Highland Dr
- 42. Sunrise Ave N
- 43. Leroy Ave

To request information from this document in an alternative format, call 651-366-4718 or 1-800-657-3774 (Greater Minnesota); 711 or 1-800-627-3529 (Minnesota Relay). You may also send an e-mail to ADARquest.dot@state.mn.us. (Please request at least one week in advance.)

Population (U.S Census 2010): 1648