

TOWNSHIP OF TRANSIT

PREPARED BY THE
MINNESOTA DEPARTMENT OF TRANSPORTATION
OFFICE OF TRANSPORTATION SYSTEM MANAGEMENT

IN COOPERATION WITH
U.S. DEPARTMENT OF TRANSPORTATION
FEDERAL HIGHWAY ADMINISTRATION

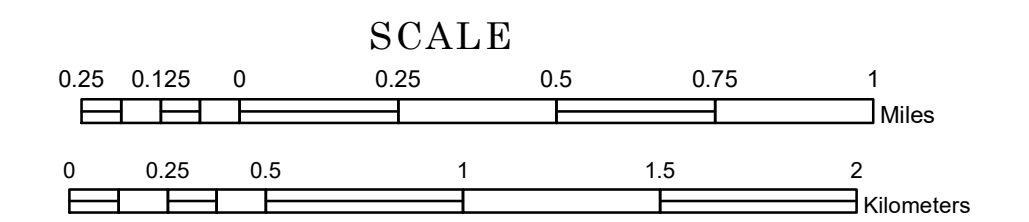

1 in = 1,600 ft
2022

Projection:
Transverse Mercator
NAD 1986
UTM Zone 15

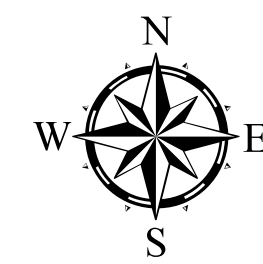

North American Datum
of 1986

ROAD AND ROADWAY FEATURES		RAILROAD AND RAILWAY FEATURES		AVIATION FEATURES	
INTERSTATE		EMPIRE BUILDER STATION (AMTRAK)		COMMERCIAL AIRPORT	
US HIGHWAY		NORTHSTAR STATION (COMMUTER)		GENERAL AIRPORT	
MN HIGHWAY		LIGHT RAIL		AIRSTRIP	
COUNTY STATE AID HIGHWAY		BLUE LINE		SEAPLANE	
COUNTY ROAD		GREEN LINE		AIRPORT RUNWAY	
TOWNSHIP ROAD		LONG BRIDGE (200' OR GREATER SPAN)		AIRPORT TAXIWAY	
UNORGANIZED TERRITORY ROAD		MAJOR BRIDGE (20' TO 200' SPAN)		BOUNDARY FEATURES	
OTHER ROADS		MINOR BRIDGE (5' TO 20' SPAN)		TRIBAL LAND	
MUNICIPAL		DAM		STATE OF MINNESOTA	
PRIVATE		LOCK AND DAM		COUNTY	
NATIONAL MONUMENT		CITY CENTERS		MUNICIPALITY	
NATIONAL WILDLIFE REFUGUE		STATE CAPITAL		UNINCORPORATED COMMUNITY	
STATE PARK		COUNTY SEAT		SECTION	
NATIONAL FOREST		CITY CENTER		MILITARY	
STATE FOREST		UNINCORPORATED COMMUNITY		VOYAGEURS NATIONAL PARK	
NATIONAL TRAIL		MNDOT OFFICE		BOUNDARY WATERS CANOE AREA WILDERNESS	
WILDLIFE REFUGE AREA		MNDOT TRUCK STATION		STATE PARK	
WILDLIFE MANAGEMENT AREA		HIGHWAY PATROL DISTRICT OFFICE		NATIONAL FOREST	
HYDROLOGIC FEATURES		STATE TRAVEL INFORMATION CENTER		NATIONAL AND STATE FOREST	
RIVER OR STREAM (PERENNIAL)		REST AREA (FULL SERVICE)		STATE FOREST	
LAKE, POND OR RESERVOIR		REST AREA (VAULT TOILET)		NATIONAL TRAIL	
STREAM (INTERMITTENT)		WAYSIDE (VAULT OR PITY TOILET)		WILDLIFE REFUGE AREA	
DRAINAGE DITCH		PARK AND RIDE LOT		WILDLIFE MANAGEMENT AREA	
WETLAND		PORT OF ENTRY		HYDROLOGIC FEATURES	
ISLAND OR LAND MONUMENT		PUBLIC ACCESS POINT		RIVER OR STREAM (PERENNIAL)	
		MN STATE COLLEGE AND UNIVERSITY SYSTEM (MNSCU)		LAKE, POND OR RESERVOIR	
		UNIVERSITY OF MN SYSTEM		STREAM (INTERMITTENT)	
		FAIRGROUNDS		DRAINAGE DITCH	
		CULTURAL FEATURES		WETLAND	
		STATE HISTORICAL MARKER		ISLAND OR LAND MONUMENT	
		HISTORIC DISTRICT		REGIONAL WATERSHED	
		HISTORIC SITE			
		MONUMENT			

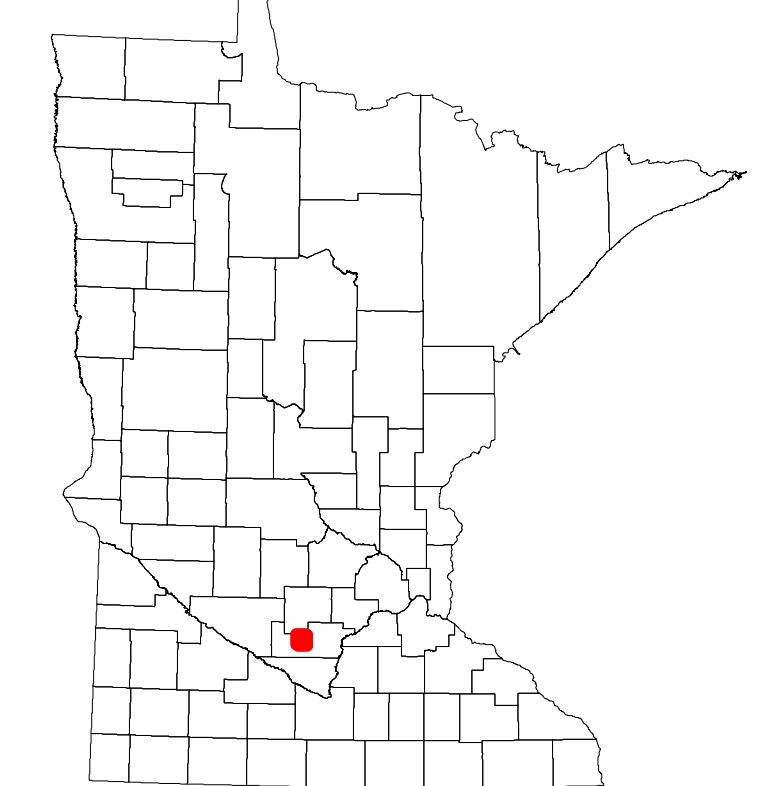

Population (U.S. Census 2010): 276

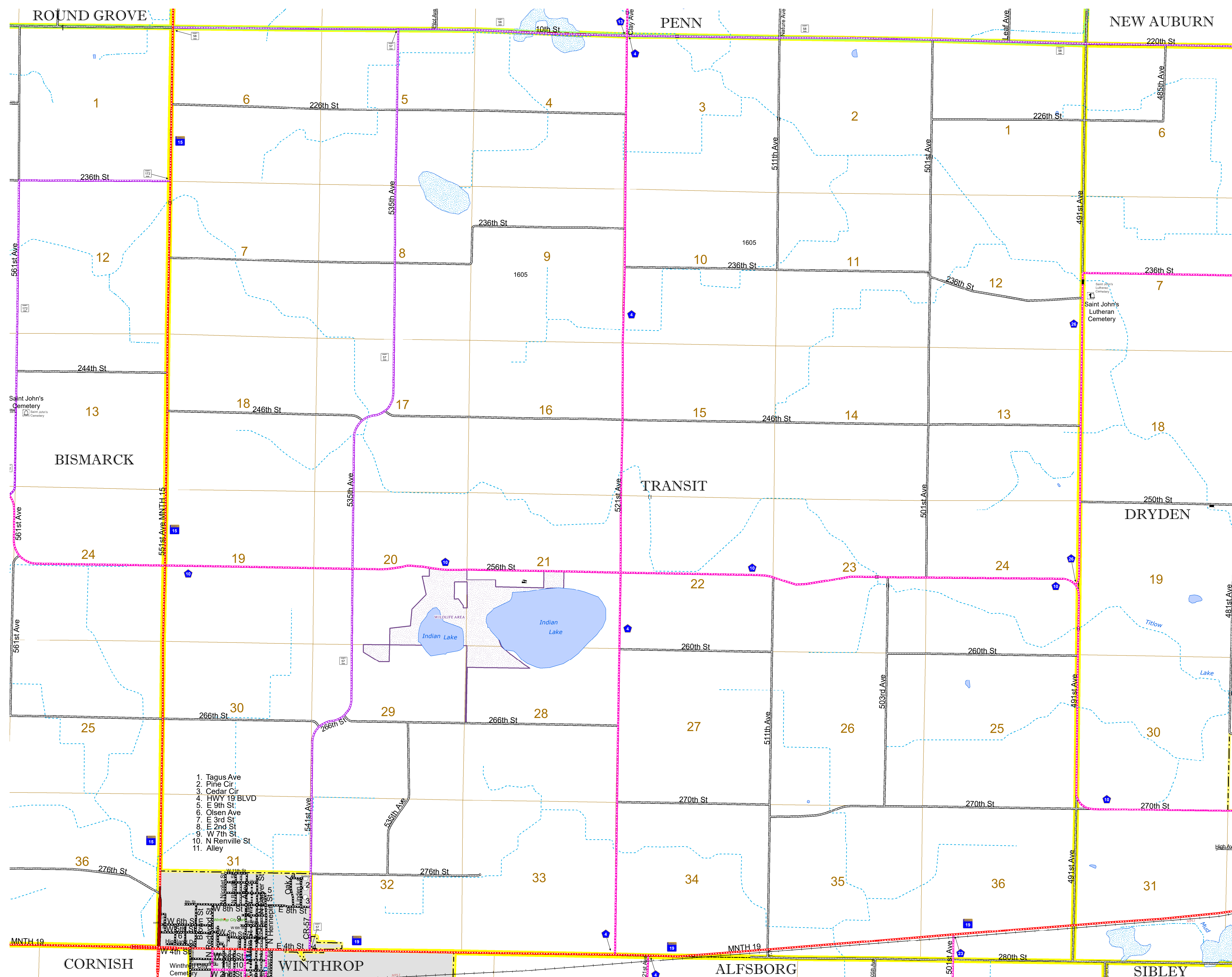

1. Tagus Ave
2. Pine Cir
3. Cedar Cir
4. HWY 19 BLVD
5. E 9th St
6. Olsen Ave
7. E 3rd St
8. 2nd St
9. W 7th St
10. N Renville St
11. Alley

To request information from this document in an alternative format, call 651-366-4718 or 1-800-657-3774 (Greater Minnesota); 711 or 1-800-627-3529 (Minnesota Relay). You may also send an e-mail to ADarequest.dot@state.mn.us. (Please request at least one week in advance.)