

TOWNSHIP OF CLIFTON

PREPARED BY THE
MINNESOTA DEPARTMENT OF TRANSPORTATION
OFFICE OF TRANSPORTATION SYSTEM MANAGEMENT

IN COOPERATION WITH
U.S. DEPARTMENT OF TRANSPORTATION
FEDERAL HIGHWAY ADMINISTRATION



2022

Projection:
Transverse Mercator
NAD 1986
UTM Zone 15



North American Datum
of 1986

ROAD AND ROADWAY FEATURES		BOUNDARY FEATURES	
INTERSTATE	CONCRETE	TRIBAL LAND	STATE OF MINNESOTA
US HIGHWAY	BITUMINOUS	COUNTY	MUNICIPALITY
MN HIGHWAY	GRAVEL	UNORGANIZED TERRITORY	CIVIL TOWNSHIP
COUNTY STATE AID HIGHWAY	DIRT/UNIMPROVED	FEDERAL ADJUSTED URBAN AREA (2014)	CONGRESSIONAL TOWNSHIP
COUNTY ROAD	OTHER	CIVIL TOWNSHIP	SECTION
TOWNSHIP ROAD	UNKNOWN	MILITARY	VOYAGEURS NATIONAL PARK
UNORGANIZED TERRITORY ROAD		SECTION	BOUNDARY WATERS CANOE AREA WILDERNESS
OTHER ROADS		MILITARY	STATE PARK
Municipal		SECTION	REGIONAL PARK
Private		SECTION	NATIONAL FOREST
Nature Service		SECTION	NATIONAL AND STATE FOREST
National Park		SECTION	STATE FOREST
National Wildlife Refuge		SECTION	WILDLIFE REFUGUE AREA
State Park		SECTION	WILDLIFE MANAGEMENT AREA
Preserve		SECTION	HYDROLOGIC FEATURES
		SECTION	RIVER OR STREAM (PERMANENT)
		SECTION	LAKE, POND OR RESERVOIR
		SECTION	STREAM (INTERMITTENT)
		SECTION	DRAINAGE DITCH
		SECTION	WETLAND
		SECTION	ISLAND OR LAND
		SECTION	REGIONAL WATERSHED

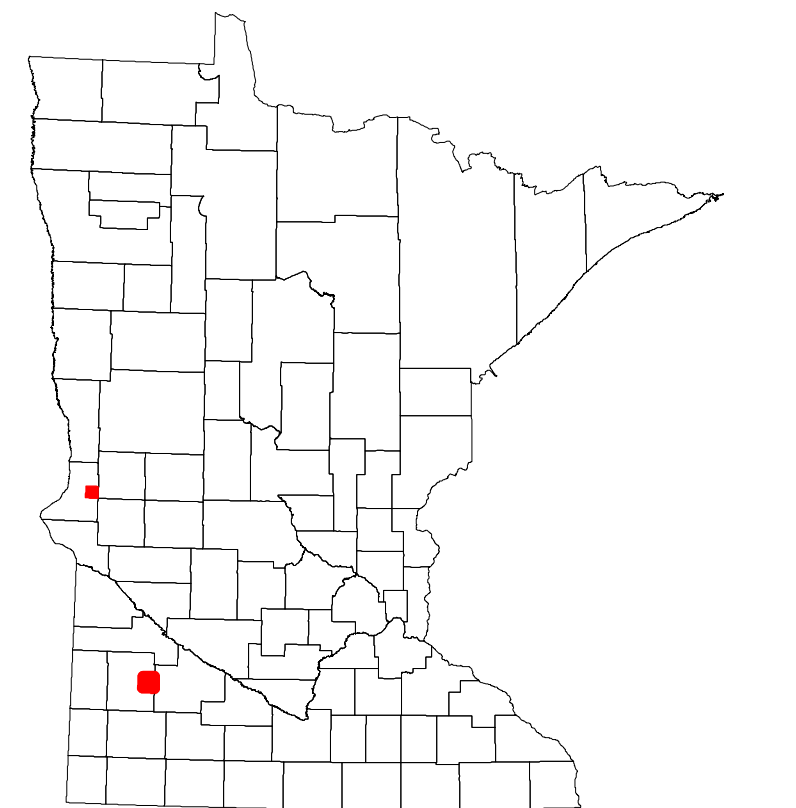

Population (U.S. Census 2010): 249

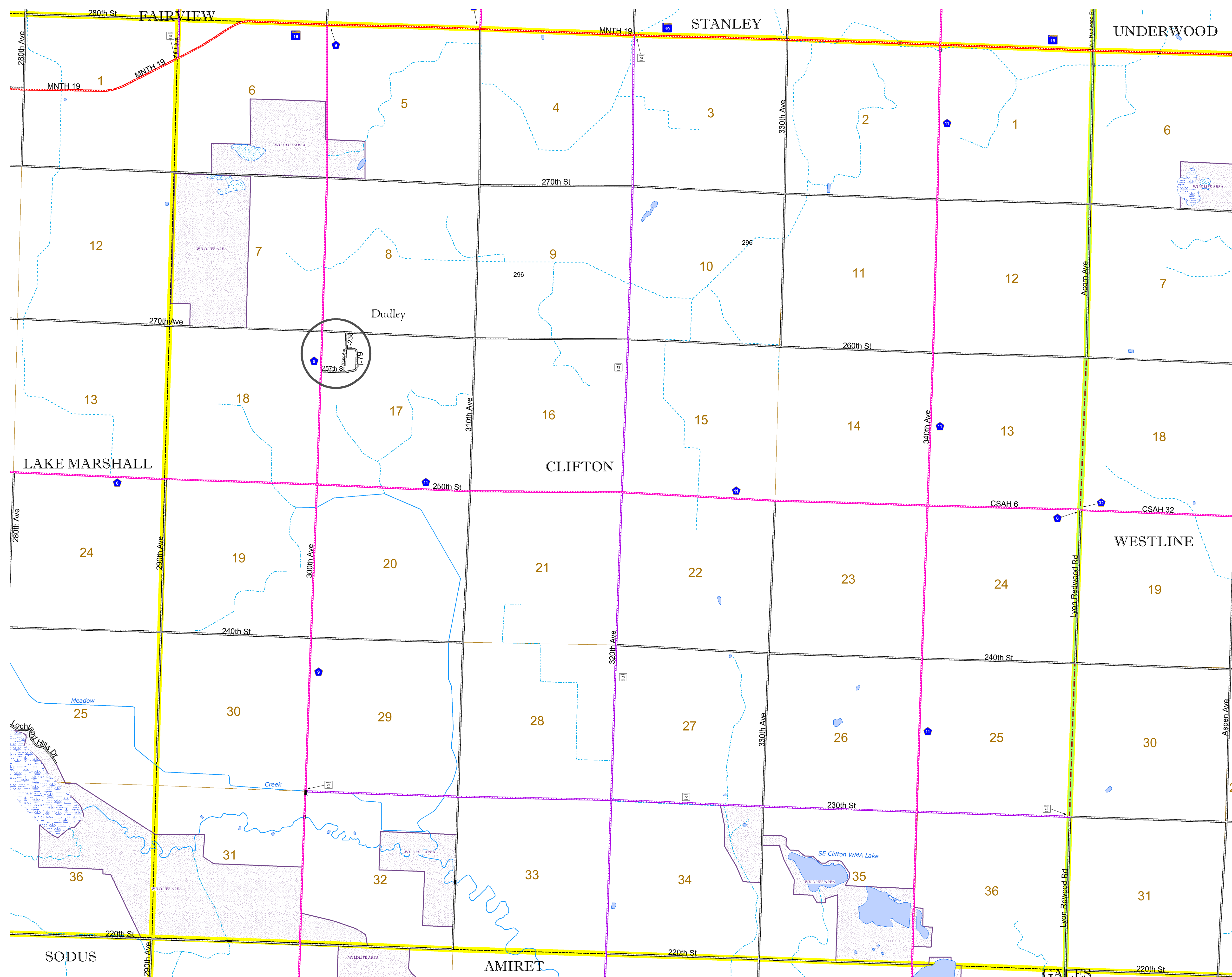

To request information from this document in an alternative format, call 651-366-4718 or 1-800-657-3774 (Greater Minnesota); 711 or 1-800-627-3529 (Minnesota Relay). You may also send an e-mail to ADarequest.dot@state.mn.us. (Please request at least one week in advance.)