

TOWNSHIP OF GILLFORD

PREPARED BY THE
MINNESOTA DEPARTMENT OF TRANSPORTATION
OFFICE OF TRANSPORTATION SYSTEM MANAGEMENT

IN COOPERATION WITH
U.S. DEPARTMENT OF TRANSPORTATION
FEDERAL HIGHWAY ADMINISTRATION

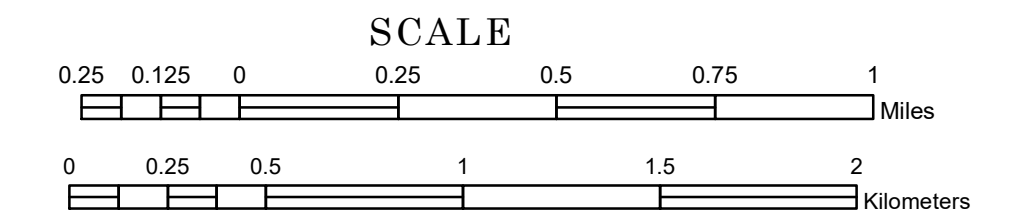

2022

Projection:
Transverse Mercator
NAD 1986
UTM Zone 15

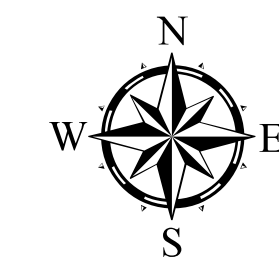

North American Datum
of 1986

ROAD AND ROADWAY FEATURES		RAILROAD AND RAILWAY FEATURES		AVIATION FEATURES		BOUNDARY FEATURES	
INTERSTATE	CONCRETE	EMPIRE BUILDER STATION (AMTRAK)	COMMERCIAL AIRPORT	TRIAL LAND	STATE OF MINNESOTA	COUNTY	MUNICIPALITY
US HIGHWAY	BITUMINOUS	NORTHSTAR STATION (COMMUTER)	GENERAL AIRPORT	STATE OF MINNESOTA	COUNTY	MUNICIPALITY	UNINCORPORATED COMMUNITY
MN HIGHWAY	GRAVEL	LIGHT RAIL	AIRSTRIP	LONG BRIDGE (200' OR GREATER SPAN)	STATE OF MINNESOTA	COUNTY	MUNICIPALITY
COUNTY STATE AID HIGHWAY	DIRT/UNIMPROVED	BLUE LINE	SEAPLANE	MAJOR BRIDGE (20' TO 200' SPAN)	STATE OF MINNESOTA	COUNTY	MUNICIPALITY
COUNTY ROAD	OTHER	GREEN LINE	AIRPORT RUNWAY	MINOR BRIDGE (5' TO 20' SPAN)	STATE OF MINNESOTA	COUNTY	MUNICIPALITY
TOWNSHIP ROAD	UNKNOWN	INFRASTRUCTURE FEATURES	RAILROAD AND RAILWAY FEATURES	DAM	STATE OF MINNESOTA	COUNTY	MUNICIPALITY
UNORGANIZED TERRITORY ROAD		LONG BRIDGE (200' OR GREATER SPAN)	EMPIRE BUILDER STATION (AMTRAK)	LOCK AND DAM	STATE OF MINNESOTA	COUNTY	MUNICIPALITY
OTHER ROADS		MAJOR BRIDGE (20' TO 200' SPAN)	NORTHSTAR STATION (COMMUTER)		STATE OF MINNESOTA	COUNTY	MUNICIPALITY
Municipal	RAMP OR CONNECTOR	MINOR BRIDGE (5' TO 20' SPAN)	LIGHT RAIL		STATE OF MINNESOTA	COUNTY	MUNICIPALITY
Private	INTERSTATE EXIT	DAM	BLUE LINE		STATE OF MINNESOTA	COUNTY	MUNICIPALITY
National Monument	AVIATION FEATURES	LOCK AND DAM	GREEN LINE		STATE OF MINNESOTA	COUNTY	MUNICIPALITY
National Park	GENERAL AIRPORT		INFRASTRUCTURE FEATURES		STATE OF MINNESOTA	COUNTY	MUNICIPALITY
National Wildlife Refuge	AIRSTRIP		LONG BRIDGE (200' OR GREATER SPAN)		STATE OF MINNESOTA	COUNTY	MUNICIPALITY
State Park	SEAPLANE		MAJOR BRIDGE (20' TO 200' SPAN)		STATE OF MINNESOTA	COUNTY	MUNICIPALITY
State Park Preserve	AIRPORT RUNWAY		MINOR BRIDGE (5' TO 20' SPAN)		STATE OF MINNESOTA	COUNTY	MUNICIPALITY
	BOUNDARY FEATURES		DAM		STATE OF MINNESOTA	COUNTY	MUNICIPALITY
	TRIAL LAND		LOCK AND DAM		STATE OF MINNESOTA	COUNTY	MUNICIPALITY
	STATE OF MINNESOTA				STATE OF MINNESOTA	COUNTY	MUNICIPALITY
	COUNTY				STATE OF MINNESOTA	COUNTY	MUNICIPALITY
	MUNICIPALITY				STATE OF MINNESOTA	COUNTY	MUNICIPALITY
	UNINCORPORATED COMMUNITY				STATE OF MINNESOTA	COUNTY	MUNICIPALITY
	SECTION				STATE OF MINNESOTA	COUNTY	MUNICIPALITY
	MILITARY				STATE OF MINNESOTA	COUNTY	MUNICIPALITY
	VOYAGEURS NATIONAL PARK				STATE OF MINNESOTA	COUNTY	MUNICIPALITY
	BOUNDARY WATERS CANOE AREA WILDERNESS				STATE OF MINNESOTA	COUNTY	MUNICIPALITY
	STATE PARK				STATE OF MINNESOTA	COUNTY	MUNICIPALITY
	REGIONAL PARK				STATE OF MINNESOTA	COUNTY	MUNICIPALITY
	NATIONAL FOREST				STATE OF MINNESOTA	COUNTY	MUNICIPALITY
	NATIONAL AND STATE FOREST				STATE OF MINNESOTA	COUNTY	MUNICIPALITY
	STATE FOREST				STATE OF MINNESOTA	COUNTY	MUNICIPALITY
	NATIONAL TRAIL				STATE OF MINNESOTA	COUNTY	MUNICIPALITY
	WILDLIFE REFUGUE AREA				STATE OF MINNESOTA	COUNTY	MUNICIPALITY
	WILDLIFE MANAGEMENT AREA				STATE OF MINNESOTA	COUNTY	MUNICIPALITY
	HYDROLOGIC FEATURES				STATE OF MINNESOTA	COUNTY	MUNICIPALITY
	RIVER OR STREAM (PERENNIAL)				STATE OF MINNESOTA	COUNTY	MUNICIPALITY
	LAKE, POND OR RESERVOIR				STATE OF MINNESOTA	COUNTY	MUNICIPALITY
	STREAM (INTERMITTENT)				STATE OF MINNESOTA	COUNTY	MUNICIPALITY
	DRAINAGE DITCH				STATE OF MINNESOTA	COUNTY	MUNICIPALITY
	WETLAND				STATE OF MINNESOTA	COUNTY	MUNICIPALITY
	ISLAND OR LAND MONUMENT				STATE OF MINNESOTA	COUNTY	MUNICIPALITY
	REGIONAL WATERSHED				STATE OF MINNESOTA	COUNTY	MUNICIPALITY

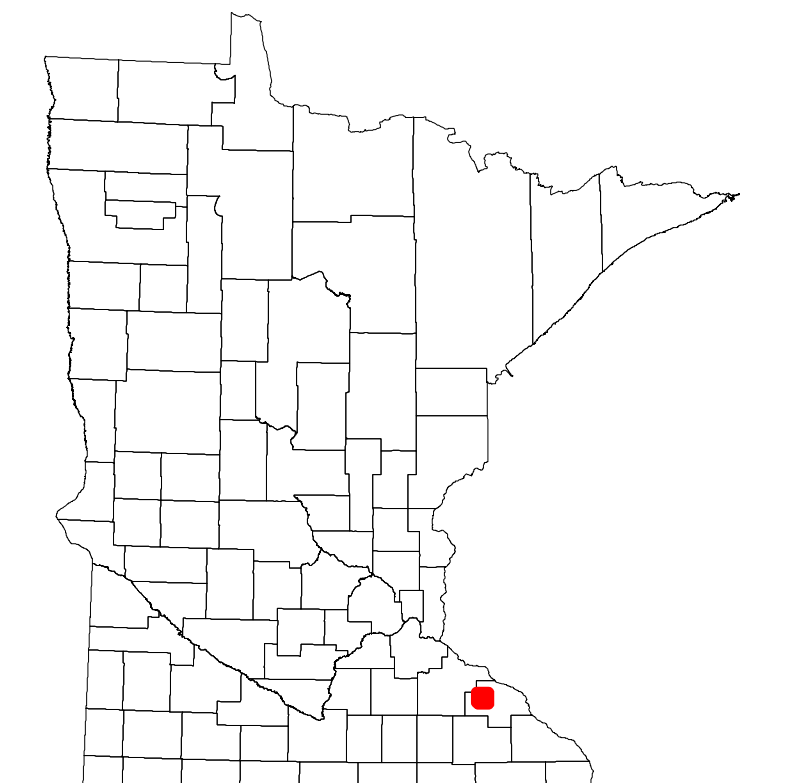

Population (U.S. Census 2010): 572

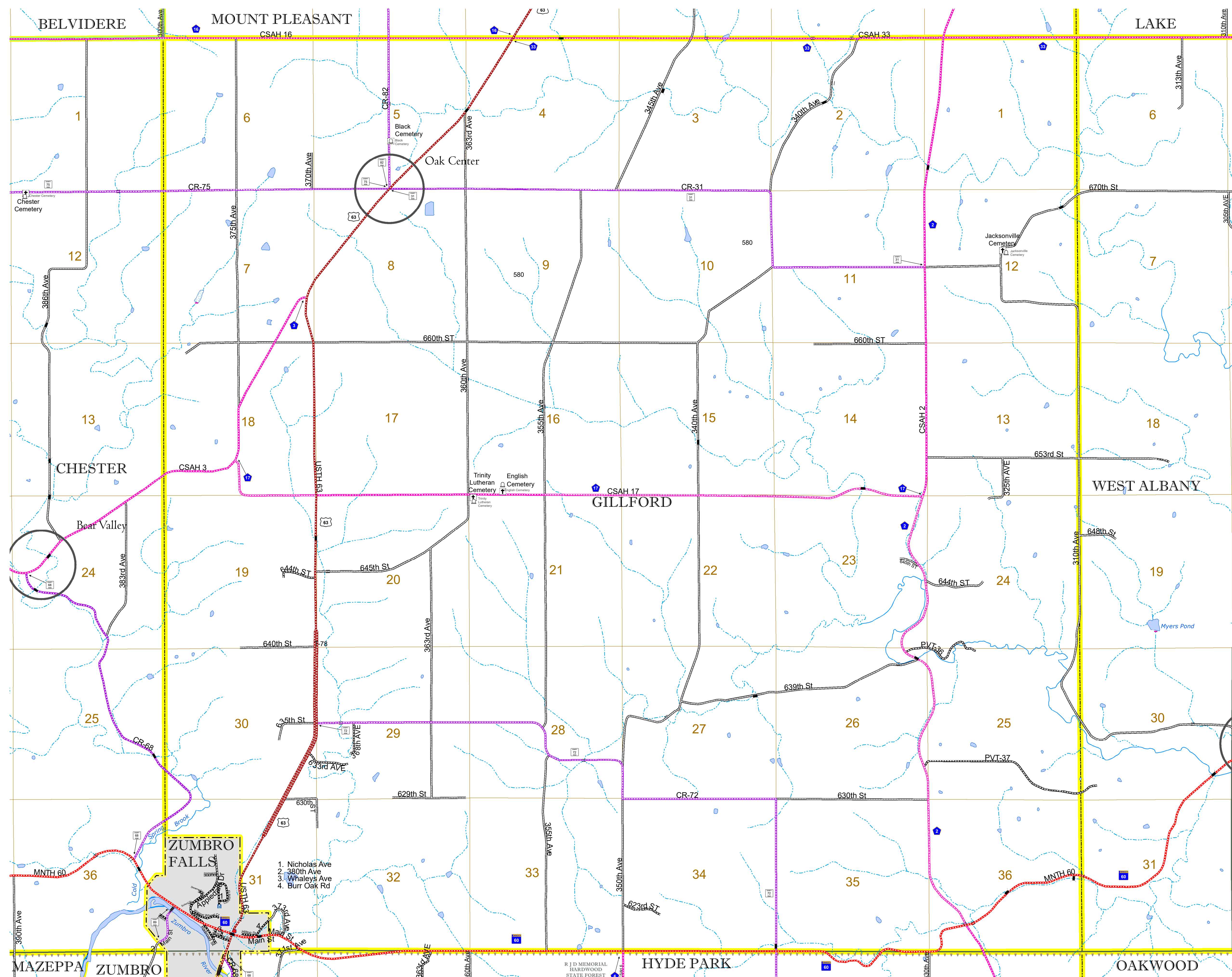

- Nicholas Ave
- 360th Ave
- Whaleys Ave
- Burr Oak Rd

To request information from this document in an alternative format, call 651-366-4718 or 1-800-657-3774 (Greater Minnesota); 711 or 1-800-627-3529 (Minnesota Relay). You may also send an e-mail to ADRequest.dot@state.mn.us. (Please request at least one week in advance.)