

# TOWNSHIP OF THOMASTOWN

PREPARED BY THE  
MINNESOTA DEPARTMENT OF TRANSPORTATION  
OFFICE OF TRANSPORTATION SYSTEM MANAGEMENT

IN COOPERATION WITH  
U.S. DEPARTMENT OF TRANSPORTATION  
FEDERAL HIGHWAY ADMINISTRATION

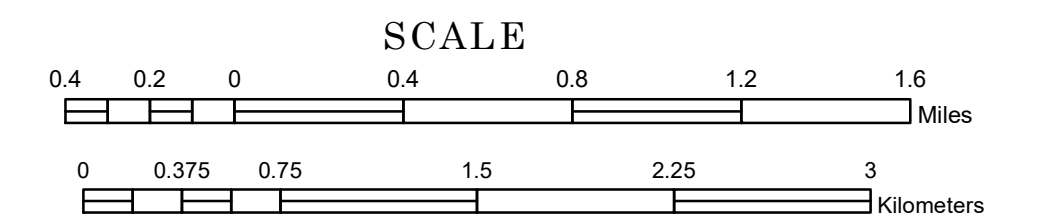

1 in = 2,400 ft

2022

Projection:  
Transverse Mercator  
NAD 1986  
UTM Zone 15



North American Datum  
of 1986

ROAD AND ROADWAY FEATURES		BOUNDARY FEATURES	
INTERSTATE		TRIAL LAND	
US HIGHWAY		STATE OF MINNESOTA	
MN HIGHWAY		COUNTY	
COUNTY STATE AID HIGHWAY		MUNICIPALITY	
COUNTY ROAD		UNORGANIZED TERRITORY	
TOWNSHIP ROAD		FEDERAL ADJUSTED URBAN AREA (2014)	
UNORGANIZED TERRITORY ROAD		CIVIL TOWNSHIP	
OTHER ROADS		CONGRESSIONAL TOWNSHIP	
Municipal		SECTION	
Private		MILITARY	
National Monument		VOYAGEURS NATIONAL PARK	
State Forest		BOUNDARY WATERS CANOE AREA WILDERNESS	
Nature Service		STATE PARK	
Military		REGIONAL PARK	
National Park		NATIONAL FOREST	
National Wildlife		NATIONAL AND STATE FOREST	
State Park		STATE FOREST	
Preserve		WILDLIFE REFUGUE AREA	
RAILROAD AND RAILWAY FEATURES		WILDLIFE MANAGEMENT AREA	
EMPIRE BUILDER STATION (AMTRAK)		HYDROLOGIC FEATURES	
NORTHSTAR STATION (COMPUTER)		RIVER OR STREAM (PERMANENT)	
LIGHT RAIL		LAKE, POND OR RESERVOIR	
BLUE LINE		STREAM (INTERMITTENT)	
GREEN LINE		DRAINAGE DITCH	
INFRASTRUCTURE FEATURES		WETLAND	
LONG BRIDGE (200' OR GREATER SPAN)		ISLAND OR LAND	
MAJOR BRIDGE (20' TO 200' SPAN)		REGIONAL WATERSHED	
MINOR BRIDGE (5' TO 20' SPAN)			
DAM			
LOCK-AND-DAM			
CITY CENTERS			
STATE CAPITAL			
COUNTY SEAT			
CITY CENTER			
UNINCORPORATED COMMUNITY			
PUBLIC SERVICE FEATURES			
MNDOT OFFICE			
MNDOT TRUCK STATION			
HIGHWAY PATROL DISTRICT OFFICE			
STATE TRAVEL INFORMATION CENTER			
REST AREA (FULL SERVICE)			
REST AREA (VAULT TOILET)			
WAYSIDE (VAULT OR PIT TOILET)			
PARK AND RIDE LOT			
PORT OF ENTRY			
PUBLIC ACCESS POINT			
MN STATE COLLEGE AND UNIVERSITY SYSTEM (MNSCU)			
UNIVERSITY OF MN SYSTEM			
FAIRGROUNDS			
CULTURAL FEATURES			
STATE HISTORICAL MARKER			
HISTORIC DISTRICT			
HISTORIC SITE			
MONUMENT			

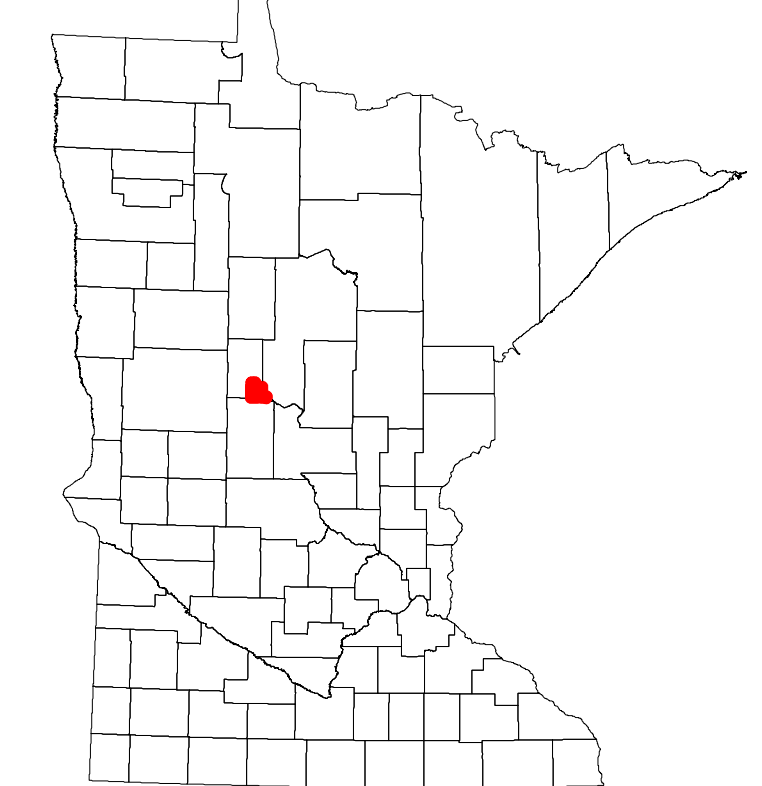

Population (U.S. Census 2010): 819

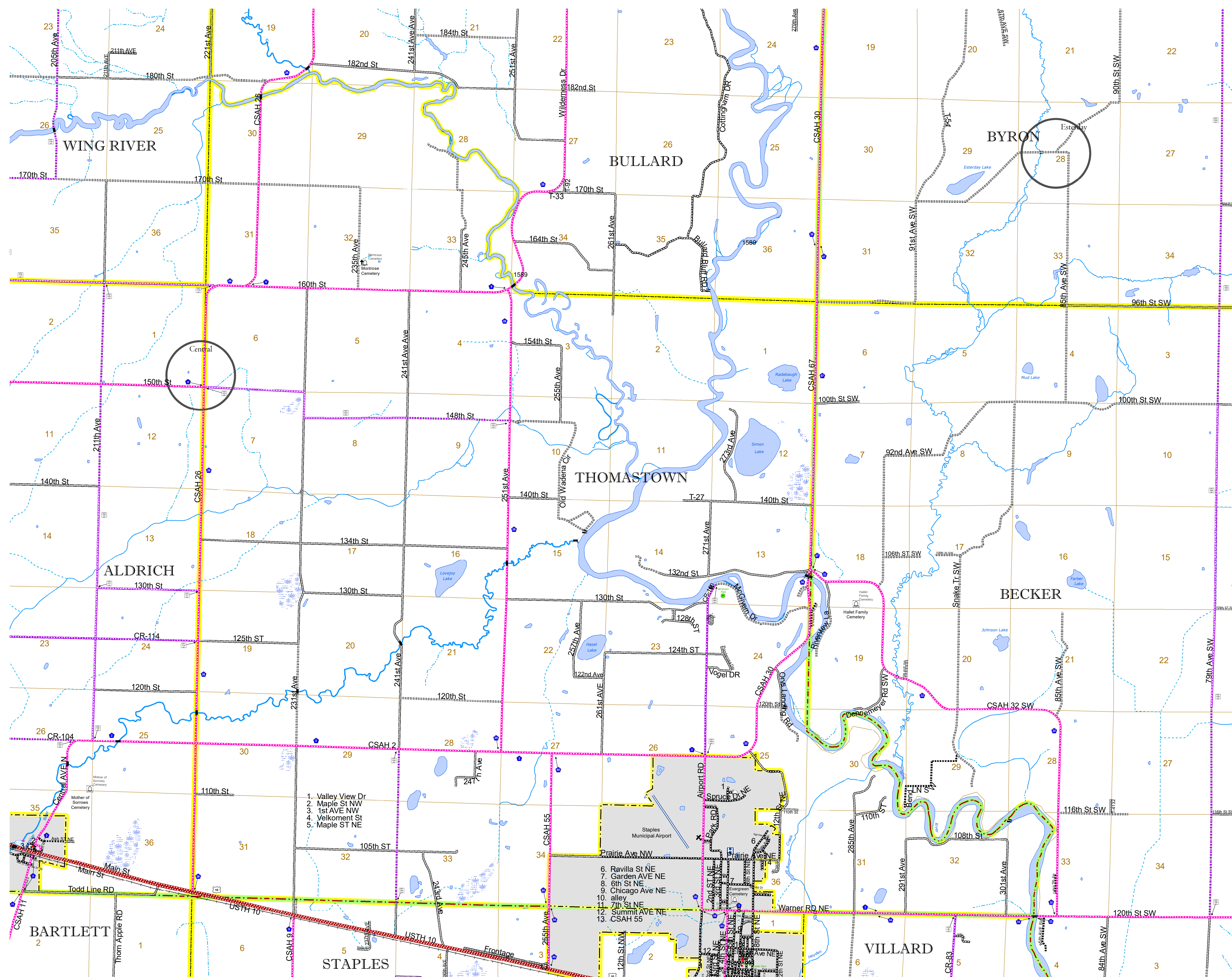

1. Valley View Dr
2. Maple St NW
3. 1st AVE NW
4. Velkomert St
5. Maple ST NE
6. Ravilla St NE
7. Garden AVE NE
8. 6th St NE
9. Chicago Ave NE
10. alley
11. 7th St NE
12. Summit AVE NE
13. CSAH 55

To request information from this document in an alternative format, call 651-366-4718 or 1-800-657-3774 (Greater Minnesota); 711 or 1-800-627-3529 (Minnesota Relay). You may also send an e-mail to ADarequest.dot@state.mn.us. (Please request at least one week in advance.)