

TOWNSHIP OF LONG LAKE

PREPARED BY THE
MINNESOTA DEPARTMENT OF TRANSPORTATION
OFFICE OF TRANSPORTATION SYSTEM MANAGEMENT

IN COOPERATION WITH
U.S. DEPARTMENT OF TRANSPORTATION
FEDERAL HIGHWAY ADMINISTRATION



1 in = 1,600 ft

2022

Projection:
Transverse Mercator
NAD 1986
UTM Zone 15



North American Datum
of 1986

ROAD AND ROADWAY FEATURES		BOUNDARY FEATURES	
INTERSTATE	CONCRETE	TRIBAL LAND	STATE OF MINNESOTA
US HIGHWAY	BITUMINOUS	COUNTY	MUNICIPALITY
MN HIGHWAY	GRAVEL	UNINCORPORATED TOWNSHIP	CIVIL TOWNSHIP
COUNTY STATE AID HIGHWAY	DIRT/UNIMPROVED	SECTION	MILITARY
TOWNSHIP ROAD	OTHER	VOYAGEURS NATIONAL PARK	BOUNDARY WATERS CANOE AREA WILDERNESS
UNORGANIZED TERRITORY ROAD	UNKNOWN	STATE PARK	NATIONAL FOREST
OTHER ROADS:		NATIONAL AND STATE FOREST	STATE FOREST
Municipal	Private	National Trail	WILDLIFE REFUGUE AREA
Nature Service	National Monument	Wildlife Management Area	WILDLIFE MANAGEMENT AREA
Mulden	National Wildlife	River or Stream (Perennial)	LAKE, POND OR RESERVOIR
	State Park	Stream (Intermittent)	DRAINAGE DITCH
	Preserve	WETLAND	ISLAND OR LAND
		MONUMENT	REGIONAL WATERSHED
RAILROAD AND RAILWAY FEATURES		CITY CENTERS	
EMPIRE BUILDER STATION (AMTRAK)	COMMERCIAL AIRPORT	STATE CAPITAL	COUNTY SEAT
NORTHSTAR STATION (COMMUTER)	GENERAL AIRPORT	CITY CENTER	UNINCORPORATED COMMUNITY
LIGHT RAIL	AIRSTRIP		
BLUE LINE	SEAPLANE		
GREEN LINE	AIRPORT RUNWAY		
INFRASTRUCTURE FEATURES		PUBLIC SERVICE FEATURES	
LONG BRIDGE (200' OR GREATER SPAN)	TRIAL	MNDOT OFFICE	STATE TRUCK STATION
MAJOR BRIDGE (20' TO 200' SPAN)	STATE OF MINNESOTA	HIGHWAY PATROL DISTRICT OFFICE	STATE TRAVEL INFORMATION CENTER
MINOR BRIDGE (5' TO 20' SPAN)	COUNTY	REST AREA (FULL SERVICE)	REST AREA (VAULT TOILET)
DAM	MUNICIPALITY	REST AREA (VAULT OR PIT TOILET)	PARK AND RIDE LOT
LOCK AND DAM	UNINCORPORATED TOWNSHIP	PORT OF ENTRY	PUBLIC ACCESS POINT
	CIVIL TOWNSHIP	MINN STATE COLLEGE AND UNIVERSITY SYSTEM (MNSCU)	UNIVERSITY OF MN SYSTEM
	CONGRESSIONAL TOWNSHIP	FAIRGROUNDS	
	SECTION		
	MILITARY		
	VOYAGEURS NATIONAL PARK		
	BOUNDARY WATERS CANOE AREA WILDERNESS		
	STATE PARK		
	NATIONAL FOREST		
	NATIONAL AND STATE FOREST		
	STATE FOREST		
	NATIONAL TRAIL		
	WILDLIFE REFUGUE AREA		
	WILDLIFE MANAGEMENT AREA		
HYDROLOGIC FEATURES		CULTURAL FEATURES	
RIVER OR STREAM (PERENNIAL)	LAKE, POND OR RESERVOIR	STATE HISTORICAL MARKER	HISTORIC DISTRICT
Stream (Intermittent)	DRAINAGE DITCH	HISTORIC SITE	MONUMENT
WETLAND	ISLAND OR LAND		
REGIONAL WATERSHED			

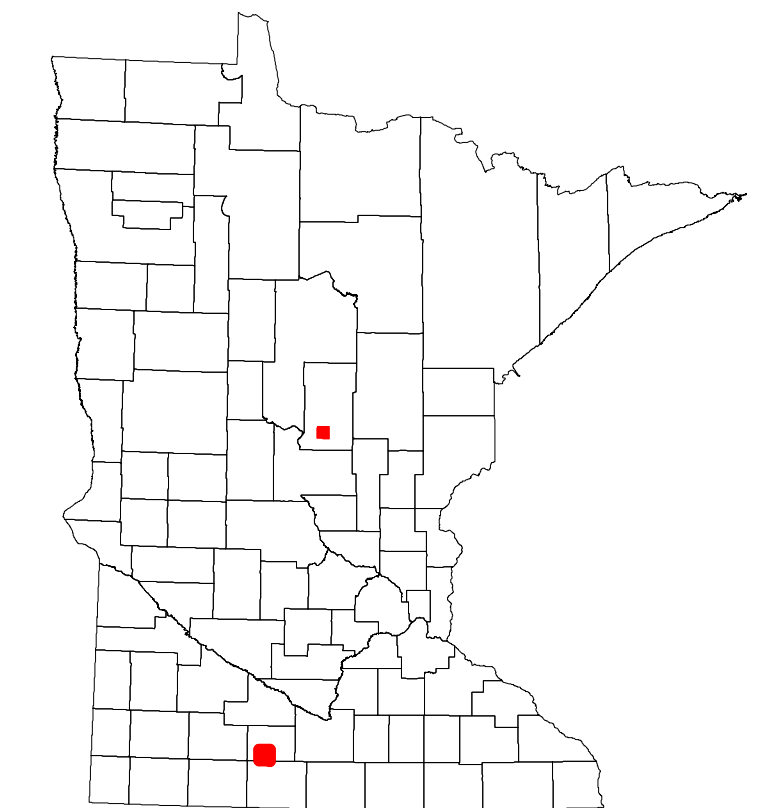

Population (U.S. Census 2010): 338

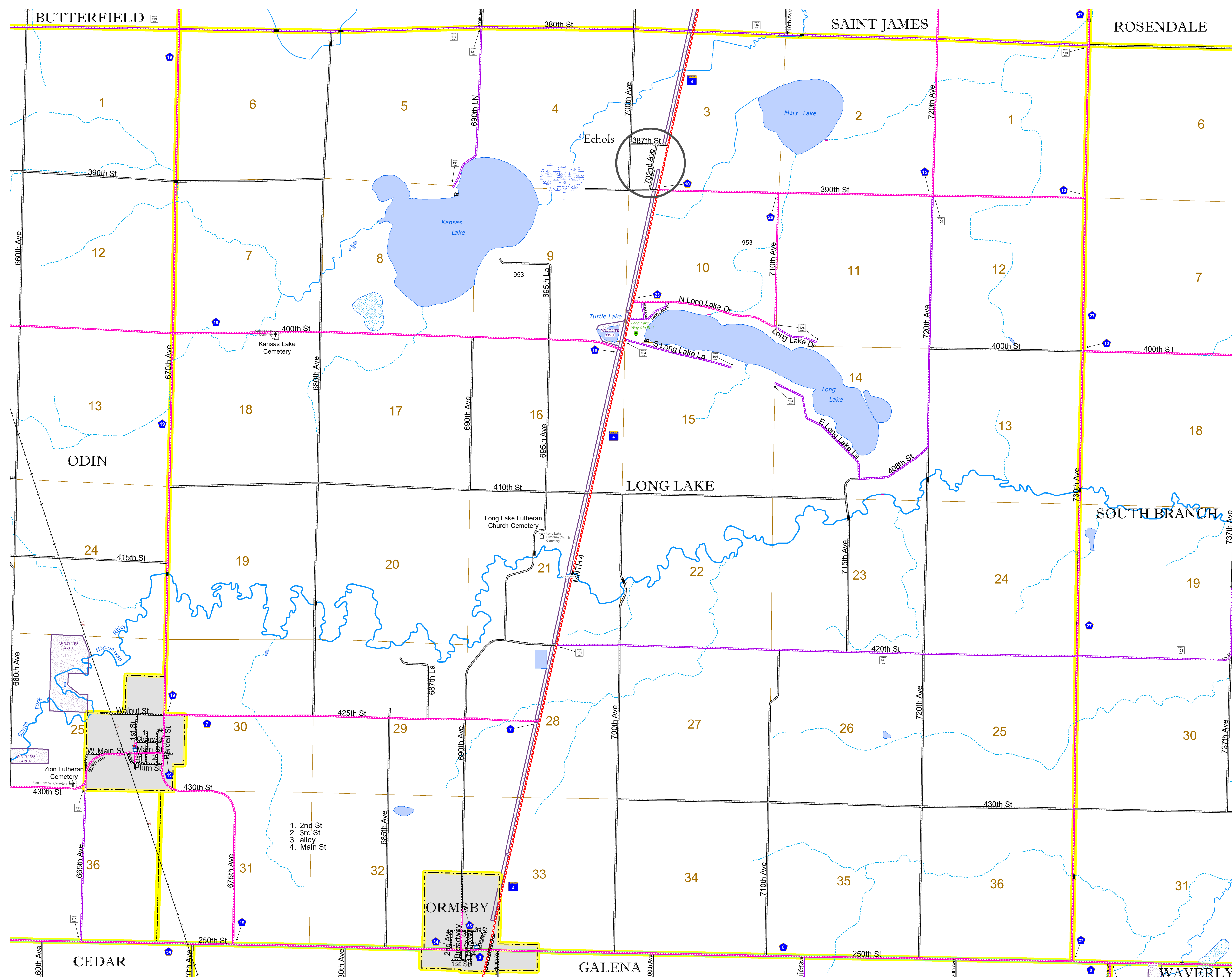

1. 2nd St
2. 3rd St
3. alley
4. Main St

To request information from this document in an alternative format, call 651-366-4718 or 1-800-657-3774 (Greater Minnesota); 711 or 1-800-627-3529 (Minnesota Relay). You may also send an e-mail to ADRequest.dot@state.mn.us. (Please request at least one week in advance.)