

LAKE HANŠKA

LINDEN

BUTTERNUT VALLEY

TOWNSHIP OF MADELIA

PREPARED BY THE
MINNESOTA DEPARTMENT OF TRANSPORTATION
OFFICE OF TRANSPORTATION SYSTEM MANAGEMENT

IN COOPERATION WITH
U.S. DEPARTMENT OF TRANSPORTATION
FEDERAL HIGHWAY ADMINISTRATION

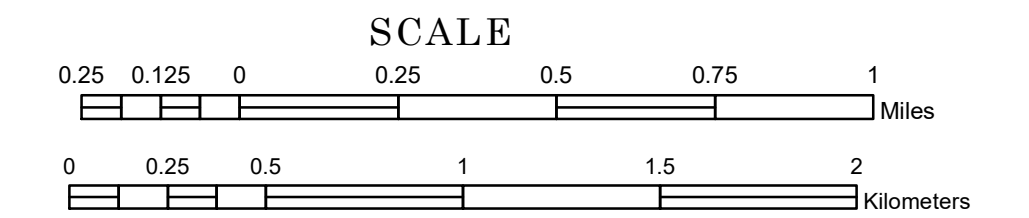

1 in = 1,600 ft

2022

Projection:
Transverse Mercator
NAD 1986
UTM Zone 15

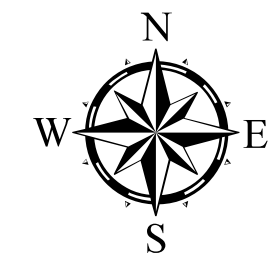

North American Datum
of 1986

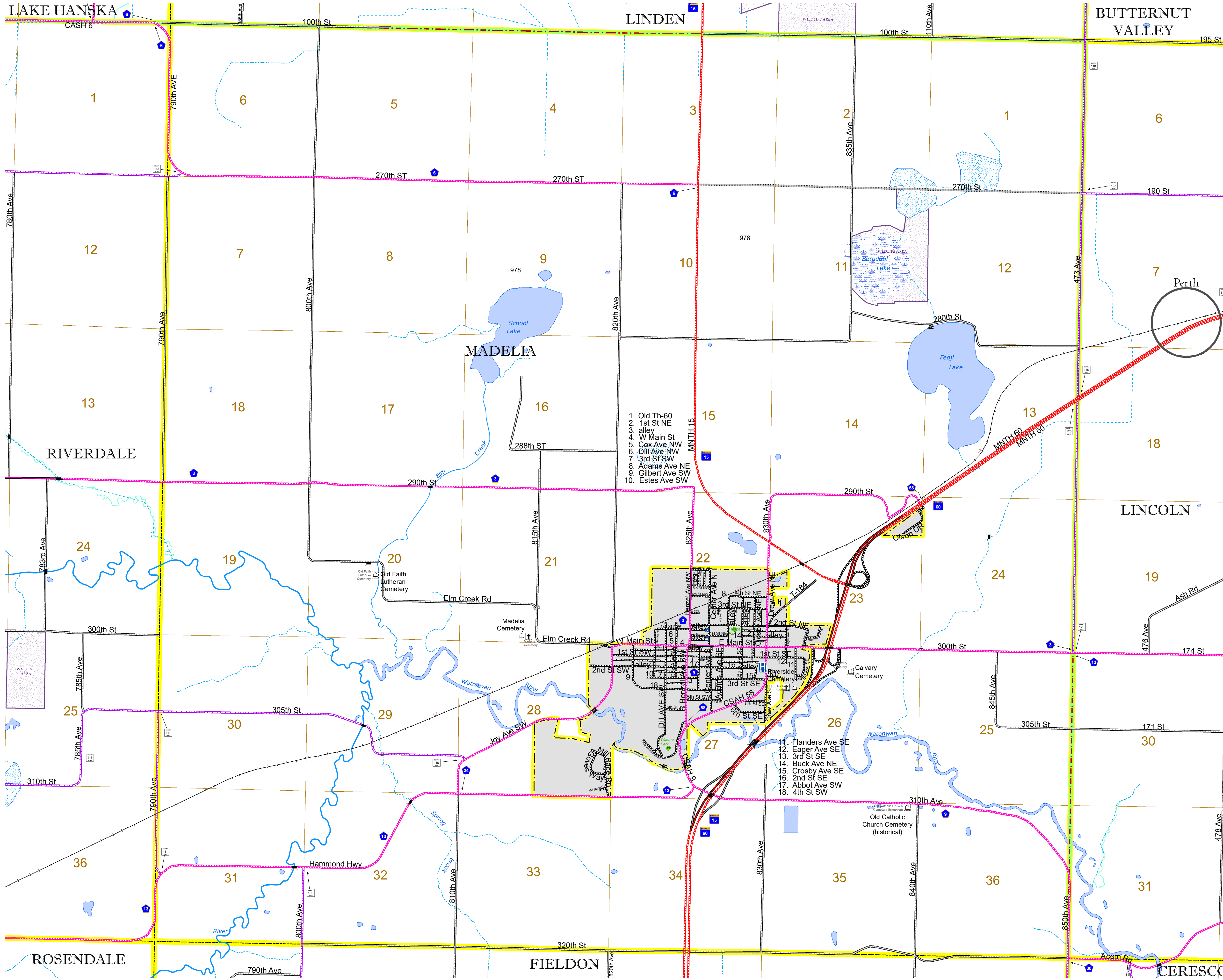

1. Old Th-60
2. 1st St NE
3. alley
4. W Main St
5. Cox Ave NW
6. Dill Ave NW
7. 3rd St SW
8. Adams Ave NE
9. Gilbert Ave SW
10. Estes Ave SW

11. Flanders Ave SE
12. Eager Ave SE
13. 3rd St SE
14. Buck Ave NE
15. Crosby Ave SE
16. 2nd St SE
17. Abbot Ave SW
18. 4th St SW

ROAD AND ROADWAY FEATURES		RAILROAD AND RAILWAY FEATURES		INFRASTRUCTURE FEATURES		CITY CENTERS		PUBLIC SERVICE FEATURES		CULTURAL FEATURES	
INTERSTATE	CONCRETE	EMPIRE BUILDER STATION (AMTRAK)	COMMERCIAL AIRPORT	LONG BRIDGE (200' OR GREATER SPAN)	TRIBAL LAND	STATE CAPITAL	MILITARY	STATE HISTORICAL MARKER	STATE HISTORICAL DISTRICT	STATE HISTORICAL SITE	STATE HISTORICAL MONUMENT
US HIGHWAY	BITUMINOUS	NORTHSTAR STATION (COMMUTER)	GENERAL AIRPORT	MAJOR BRIDGE (20' TO 200' SPAN)	STATE OF MINNESOTA	COUNTY SEAT	VOYAGEURS NATIONAL PARK	HISTORIC DISTRICT	HISTORIC DISTRICT	HISTORIC SITE	HISTORIC MONUMENT
MN HIGHWAY	GRAVEL	LIGHT RAIL	AIRSTRIP	MINOR BRIDGE (5' TO 20' SPAN)	COUNTY	CITY CENTER	BOUNDARY NATIONAL PARK	HISTORIC DISTRICT	HISTORIC DISTRICT	HISTORIC SITE	HISTORIC MONUMENT
COUNTY STATE AID HIGHWAY	DIRT/UNIMPROVED	BLUE LINE	SEAPLANE	LOCK AND DAM	MUNICIPALITY	UNINCORPORATED COMMUNITY	BOUNDARY WATERS CANOE AREA WILDERNESS	HISTORIC DISTRICT	HISTORIC DISTRICT	HISTORIC SITE	HISTORIC MONUMENT
TOWNSHIP ROAD	OTHER	GREEN LINE	AIRPORT RUNWAY		UNORGANIZED TERRITORY		STATE PARK	HISTORIC DISTRICT	HISTORIC DISTRICT	HISTORIC SITE	HISTORIC MONUMENT
UNORGANIZED TERRITORY ROAD	UNKNOWN				FEDERAL ADJUSTED URBAN AREA (2014)		NATIONAL FOREST	HISTORIC DISTRICT	HISTORIC DISTRICT	HISTORIC SITE	HISTORIC MONUMENT
OTHER ROADS					CIVIL TOWNSHIP		NATIONAL AND STATE FOREST	HISTORIC DISTRICT	HISTORIC DISTRICT	HISTORIC SITE	HISTORIC MONUMENT
Municipal					CONGRESSIONAL TOWNSHIP		STATE FOREST	HISTORIC DISTRICT	HISTORIC DISTRICT	HISTORIC SITE	HISTORIC MONUMENT
Private							WILDLIFE REFUGUE AREA	HISTORIC DISTRICT	HISTORIC DISTRICT	HISTORIC SITE	HISTORIC MONUMENT
National Monument							WILDLIFE MANAGEMENT AREA	HISTORIC DISTRICT	HISTORIC DISTRICT	HISTORIC SITE	HISTORIC MONUMENT
National Wildlife Refuge							HYDROLOGIC FEATURES	HISTORIC DISTRICT	HISTORIC DISTRICT	HISTORIC SITE	HISTORIC MONUMENT
State Park							RIVER OR STREAM (PERMANENT)	HISTORIC DISTRICT	HISTORIC DISTRICT	HISTORIC SITE	HISTORIC MONUMENT
Preserve							LAKE, POND OR RESERVOIR	HISTORIC DISTRICT	HISTORIC DISTRICT	HISTORIC SITE	HISTORIC MONUMENT
							STREAM (INTERMITTENT)	HISTORIC DISTRICT	HISTORIC DISTRICT	HISTORIC SITE	HISTORIC MONUMENT
							WETLAND	HISTORIC DISTRICT	HISTORIC DISTRICT	HISTORIC SITE	HISTORIC MONUMENT
							ISLAND OR LAND	HISTORIC DISTRICT	HISTORIC DISTRICT	HISTORIC SITE	HISTORIC MONUMENT
							REGIONAL WATERSHED	HISTORIC DISTRICT	HISTORIC DISTRICT	HISTORIC SITE	HISTORIC MONUMENT

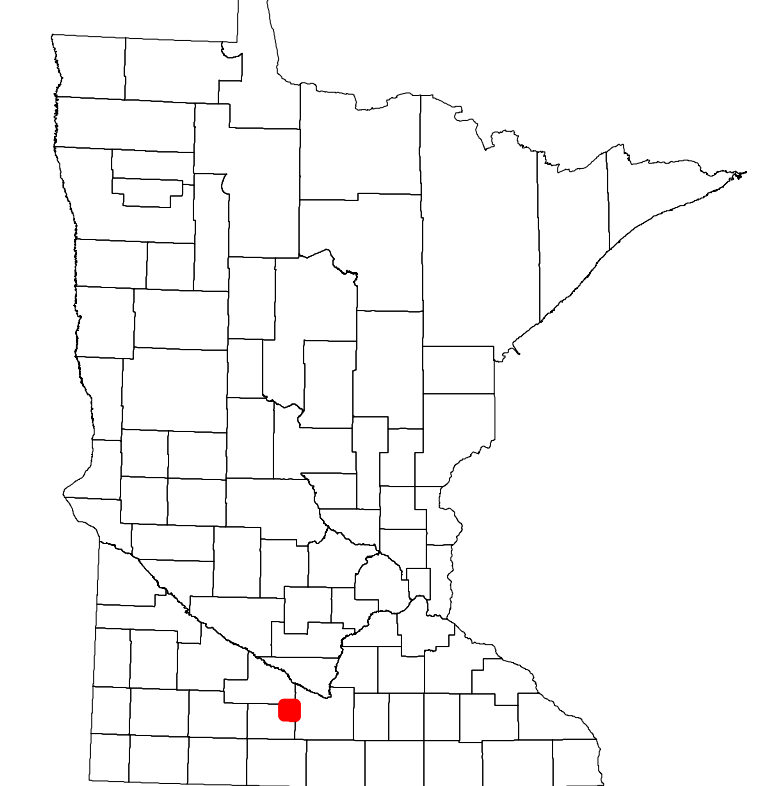

Population (U.S. Census 2010): 351

To request information from this document in an alternative format, call 651-366-4718 or 1-800-657-3774 (Greater Minnesota); 711 or 1-800-627-3529 (Minnesota Relay). You may also send an e-mail to ADAREquest.dot@state.mn.us. (Please request at least one week in advance.)