

PREPARED BY
HIGHWAY PLANNING SURVEY
IN COOPERATION WITH
U. S. PUBLIC ROADS ADMINISTRATION

STATE OF MINNESOTA
DEPARTMENT OF HIGHWAYS
ROAD LIFE STUDIES
CONSTRUCTION PROJECT LOG RECORD

CONTROL SECTION 0401
TRUNK HIGHWAY Beltrami
COUNTY Beltrami
DISTRICT 2A

LIMITS: West Co. Line - North Jct. T.H. 89

Ref. Pt. 073+00.353 - 089+00.331

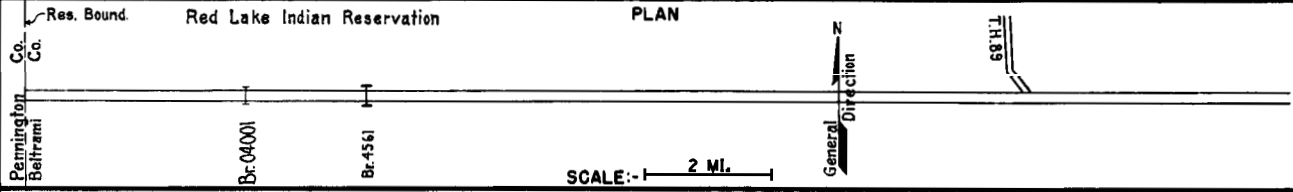

YEAR BUILT	PROJECT N°	DESCRIPTION				CODE N° DIST
		TYPE	WIDTH	THICKNESS	REMARKS	
1926		Gravel	20'	2"	Co. Job N° 2608. Added in 1934.	126
		Br. N° 4561	19'		22' B.S.	
M	1940 A.F.E. 15	Regraveling			504 C.Y./Mi. Maint. Dept.	
M	1970 A.F.E. 6	Gravel Resurfacing			8927 Tons	
C	1959 A.F.E. 826	Grading Gravel	28'			1359
C	1962 0401-02	Grading 12" Select Granular Mat'l.	34'		Gravel wearing course	361
	0401-04001	Br. 04001	32'		217' P.C.S.	461
C	1963 0401-03	Grading 12" Select Granular Mat'l. Gravel Wearing Course	34'			162
C	1963 SF	Road Mix Bit. (Base)	25'	2"	Prime MC-2, 12672 Gal. MC-2, 138823 Gal. Agg. 11880 Tons	1063
C	1964 SF	Mixed Bit. (Base)	25'	2"	MC-2, 125039 Gal. Agg. 9213 Tons (Float)	2064
M	1965 C	Light Bit. Seal	25'		RS-1C, 29281 Gal. Agg. 1055 C.Y.	465
M	1969 SF	Bit. Resurfacing	24'	1"	MC-250-113,902 Gal. Agg. 8,057 Tons	2869
C	1977 0401-06	Pl. Mix. Bit. Resurf. GRAY SHLD.	24'	3"	6' RT. & 6' LT.	2176
M	1979 SF	Bit. Seal Coat	24'		CRS-1 Seal 31901 Gal. FA-1 Agg. 1272 Cu. Yd.	1079
C	1973 0401-05	Br's. 04001 & 4561 PLATE BEAM GUARD RAIL			306' 8" LIN. FT. 354' LIN. FT.	1473
C	1988 0401-07	Bit. Overlay Gravel Shouldering	24'	1 1/2"	Spec 2331	

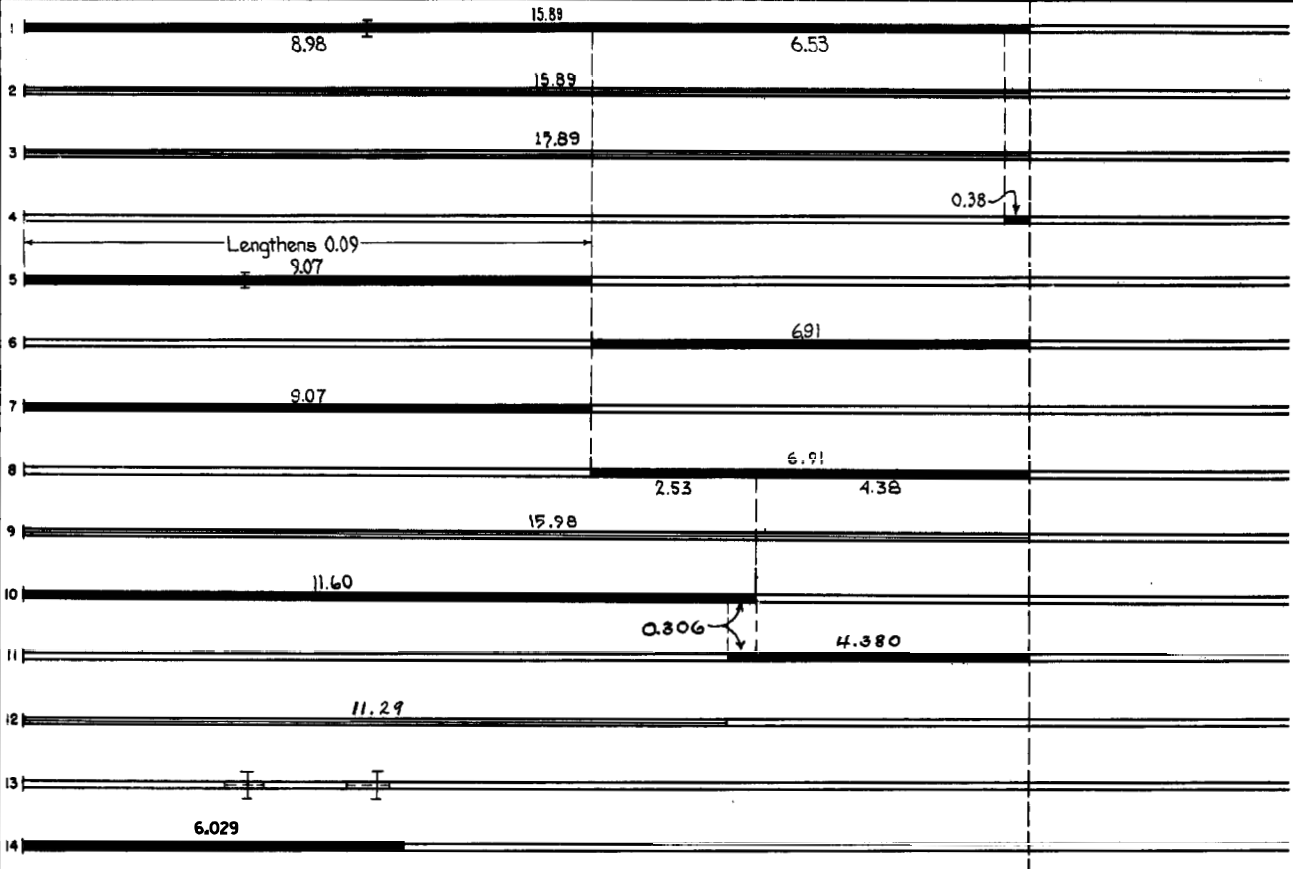

YEARS FROM	TO	TOTAL MILES	UNINCORPORATED		INCORPORATED		RURAL		URBAN	
			RDWY. MI.	BR. MI.	RDWY. MI.	BR. MI.	RDWY. MI.	BR. MI.	RDWY. MI.	BR. MI.
1934	1961	15.89	15.88	0.01	0.00	0.00	15.88	0.01	0.00	0.00
1962		15.96	15.93	0.05	0.00	0.00	15.93	0.05	0.00	0.00

REMARKS: Layout is to scale as of 1934

