

PREPARED BY
HIGHWAY PLANNING SURVEY
IN COOPERATION WITH
U. S. PUBLIC ROADS ADMINISTRATION

STATE OF MINNESOTA
DEPARTMENT OF HIGHWAYS
ROAD LIFE STUDIES
CONSTRUCTION PROJECT LOG RECORD

CONTROL SECTION 0414
TRUNK HIGHWAY 89
COUNTY Beltrami
DISTRICT 2A

LIMITS: Jct. T.H. 2 - Jct. T.H. 1 near Red Lake

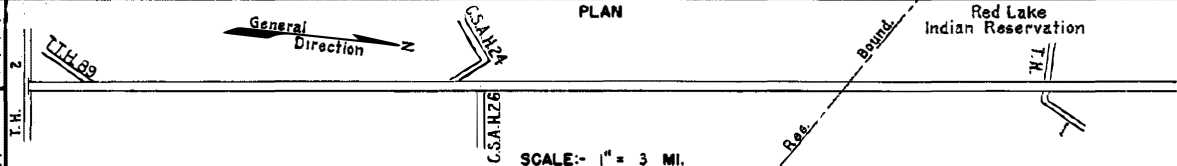

YEAR BUILT	PROJECT N ^o	DESCRIPTION			CODE N ^o DIST.
		TYPE	WIDTH	THICKNESS	
		Gravel	20'	1 1/4"	No Record of Constr.
					Added in 1934.
1936	89-156-22-182A	Grading	24'		Built by Red Lake Indian Dept.
1937	89-156-22-282C	Grading	24'		334
1938	A.F.E. 14	Gravel	24'	1 3/4"	Maint. Dept.
C (1)	1940 A.F.E. 31	Bit. Surf. Treat.	27'	3/4"	Maint. Dept.
M	1941 A.F.E. 32	Regraveling & Grade Lift (Spots)	28'		502 CY./Mi. Maint. Dept.
M	1942 A.F.E. 6	Regraveling			523 CY./Mi. Maint. Dept.
M	1942 A.F.E. 4	Bit. Retreat	24'		RT-5, 6359 Gal./Mi. Grav. 335 CY./Mi. Maint. Dept.
M	1944 A.F.E. 5	Bit. Seal Coat			RT-5, 2592 Gal./Mi. Grav. 71 CY./Mi. Maint. Div.
M	1945 A.F.E. 6	Grav. Resurfacing			500 C.Y./Mi. Maint. Div.
C	1948 0414-02	Grading	30'		
		Stab. Gravel	24'	9'-12"	247
		C46 x 37			
C (2)	1948 A.F.E. 25	Bit. Resurfacing Mixed Bit.	24'	1" added	MC38563, 50562 Gal. Agg. 3870 Tons
M	1948 A.F.E. 6	Grav. Resurfacing			6811 Tons
C	1949 0414-04	Plant Mix Bit.	24'	1 1/2"	4449

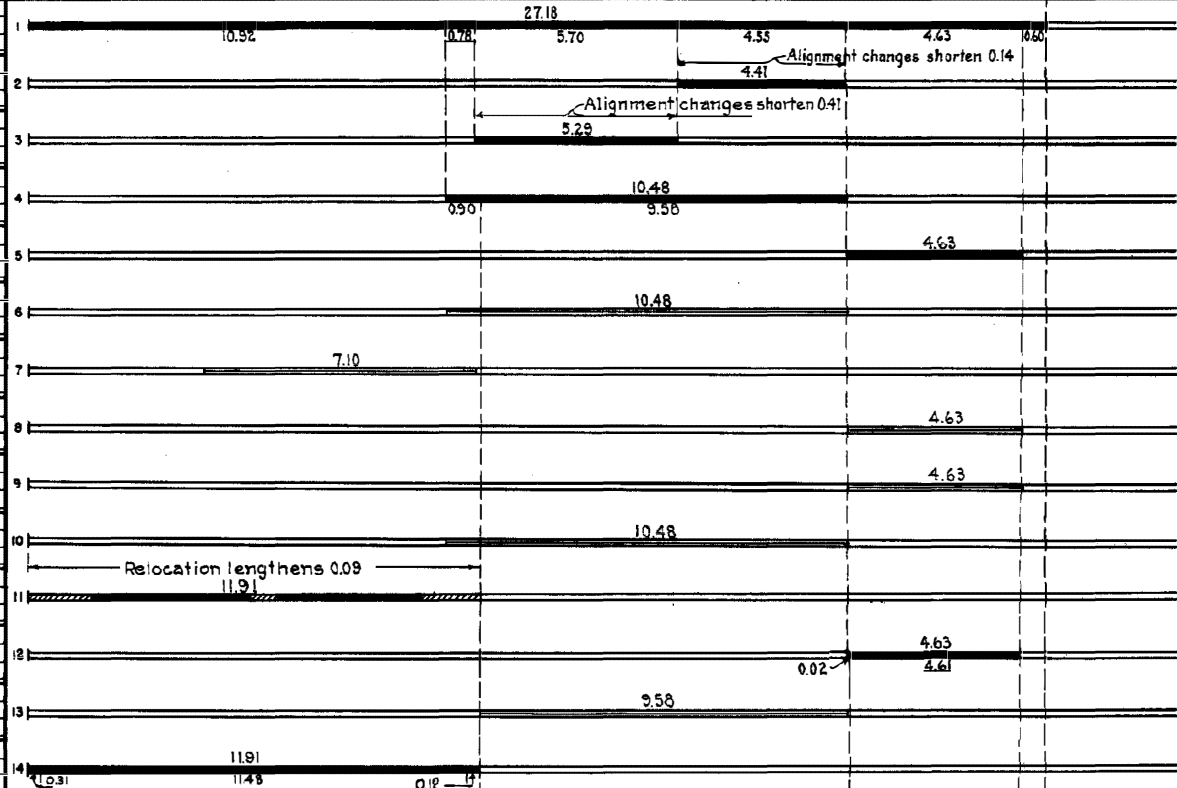

YEARS FROM	TO	TOTAL MILES	UNINCORPORATED		INCORPORATED		RURAL		URBAN	
			RDWY. MI.	BR. MI.	RDWY. MI.	BR. MI.	RDWY. MI.	BR. MI.	RDWY. MI.	BR. MI.
1934	1935	27.18	27.18	0.00	0.00	0.00	27.18	0.00	0.00	0.00
1935	1936	27.04	27.04	0.00	0.00	0.00	27.04	0.00	0.00	0.00
1937	1947	26.53	26.53	0.00	0.00	0.00	26.53	0.00	0.00	0.00
1948	1955	26.72	26.72	0.00	0.00	0.00	26.72	0.00	0.00	0.00
1956	1967	26.36	26.36	0.00	0.00	0.00	26.36	0.00	0.00	0.00
1968		26.33	26.33	0.00	0.00	0.00	26.33	0.00	0.00	0.00

REMARKS: Layout is to scale as of 1937 Plan revised for 1948 relocation.

(1) A.F.E. 31 included Bit. Surf. Treat. of 0.68 Mion. E. leg of T.H. 89 in addition to 4.63 Mi. shown.

(2) A.F.E. 25 included Mixed Bit. on East leg of T.H. 89

4.74

PREPARED BY
HIGHWAY PLANNING SURVEY
IN COOPERATION WITH
U.S. PUBLIC ROADS ADMINISTRATION

STATE OF MINNESOTA
DEPARTMENT OF HIGHWAYS
ROAD LIFE STUDIES
CONSTRUCTION PROJECT LOG RECORD

CONTROL SECTION 0414
TRUNK HIGHWAY 89
COUNTY Beltrami
DISTRICT 2A

LIMITS: Jct. T.H. 2 to Jct. T.H. 1 near Red Lake

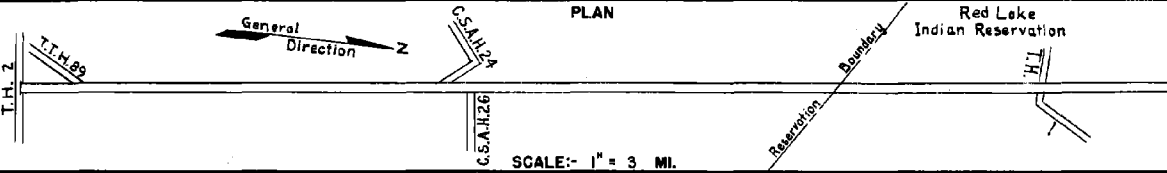

YEAR BUILT	PROJECT N°	DESCRIPTION			CODE N° DIST.
		TYPE	WIDTH	THICKNESS	
M 1970	(3) A.F.E. 4	Fog Seal	24'		
C 1951	0414-07	Gravel Base Bit. Surf. Base (Mixed Bit)	28' 24'	7-13" 2"	150
M 1954	A.F.E. 823	Spot Base Repair Bit. Surface Mixed Bit.	24'		2453 2554
M 1955	A.F.E. 605	Light Bit. Seal	24'		
C&M 1955	A.F.E. 820 A.F.E. 827	Bit. Resurfacing Mixed Bit. Shoulder Repair	24'	1"	
C 1956	Built as conn. under 0403-02 A.F.E. 823	Grading Granular Mat. Mixed Bit (Mixed Pr.)	36' 36'	12" 1 1/2"	155
M 1957	A.F.E. 605	Light Bit. Seal	25'		
C 1957	A.F.E. 820	Bit. Resurfacing Mixed Bit	24'	1" added	
M 1959	A.F.E. 605	Light Bit. Seal	25'		
M 1963		Light Bit. Seal	25'		1363
C 1968	0406-07	Grade, Gravel Base Bit. Base, Bit. Surf., & Gravel Shldr.		2"	348
M 1968	SF	Bit. Surf. Repair	24'	1 1/2"	1168
C 1973	0414-11	Grading, Gravel Base Bit. Surface & Gravel Shoulders	24'	1 1/2"	873
C 1978	0414-10	Bit. Resurfacing Rt. Turn Lanes	24'	1 1/2"	1176

1			4.67
2		9.60	
3	0.54		
4	11.91		4.61
5		9.60	
6			Shortens 0.36
7		9.60	
8			4.85
9			4.85
10	11.91		
11	relocation shortens 0.03 +0.28		
12		9.58 (Net 5.00)	
13			14.28 (Relocation Shortens 0.29 Mi)
14	11.61		

YEARS FROM	TOTAL MILES TO	UNINCORPORATED		INCORPORATED		RURAL		URBAN	
		RDWY. MI.	BR. MI.	RDWY. MI.	BR. MI.	RDWY. MI.	BR. MI.	RDWY. MI.	BR. MI.

REMARKS: See Sheet No 1
(3) Includes Fog Seal on East Leg of T.H. 89 (4) Contract not final but work substantially complete in 1951

