

PREPARED BY
HIGHWAY PLANNING SURVEY
IN COOPERATION WITH
U. S. PUBLIC ROADS ADMINISTRATION

STATE OF MINNESOTA
DEPARTMENT OF HIGHWAYS
ROAD LIFE STUDIES
CONSTRUCTION PROJECT LOG RECORD

CONTROL SECTION 0801
TRUNK HIGHWAY 4
COUNTY Brown
DISTRICT 78

LIMITS: S Co. Line ~ Jct. T.H. 14 in Sleepy Eye

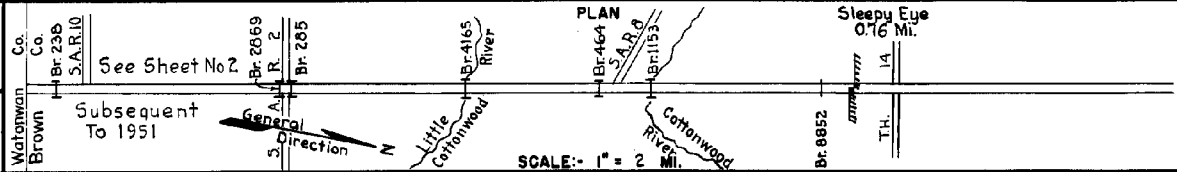

YEAR BUILT	PROJECT N°	DESCRIPTION			CODE N°
		TYPE	WIDTH	THICKNESS	
		Gravel	24'	1 1/2"	No Record of Constr. Added in 1934.
		Br.*4165 & 464	19'		80' L.T. & 14' B.S. & W107
1923		Gravel	24'	1 1/2"	Co. Job #2301. Added in 1934. 800 CY./Mi.
		Br.*238, 2869 & 285	19"		8' B.S. 20' C.S. & 10' B.S.
1933		Gravel	24'	1 1/2"	Built by County. Added in 1934.
		Br.*1153 & 4694	19"		140' B.S. & L.T. & 35' B.S.
1934		Stab. Gravel	24'	2"	With CaCl ₂ & Binder Soil. Maint. Dept.
1934		Asphalt Tr. Gravel	24'	1"	Maint. Dept.
1936		Asphalt Tr. Gravel	24'	1"	13333 Gal./Mile. Maint. Dept.
M	1940 A.F.E. 18	Bit. Seal Coat	26'		RC-3-3484 Gal./Mi. Grav. 136 C.Y./Mi. Maint. Dept.
M	1940 A.F.E. 7	Regravelling			85 C.Y./Mile. Maint. Dept.
M	1943 A.F.E. 4	Spot Treat. Bit. Surf. Repair	24'		MC-283, 271 Gal./Mi. Agg. 53 C.Y./Mi. Maint. Dept.
M	1943 A.F.E. 6	Grav. Resurface			234 C.Y./Mi. Maint. Dept.
M	1944 A.F.E. 4	Bit. Surf. Repair	24'		MC-3, 2400 Gal./Mi. Grav. 67 C.Y./Mi. Maint. Div.
M	1945 A.F.E. 6	Grav. Resurfacing			303 C.Y./Mi. Maint. Div.
M	1945 A.F.E. 4	Spot Treat. Bit. Surf. Repair			MC-3, 1917 Gal./Mi. Grav. 55 C.Y./Mi. Maint. Div.
M	1946 A.F.E. 4	Spot Treat. Bit. Surf. Repair & Fog Seal	24'	24'	SC3-FC3 7925 Gal. Agg. 172 C.Y.

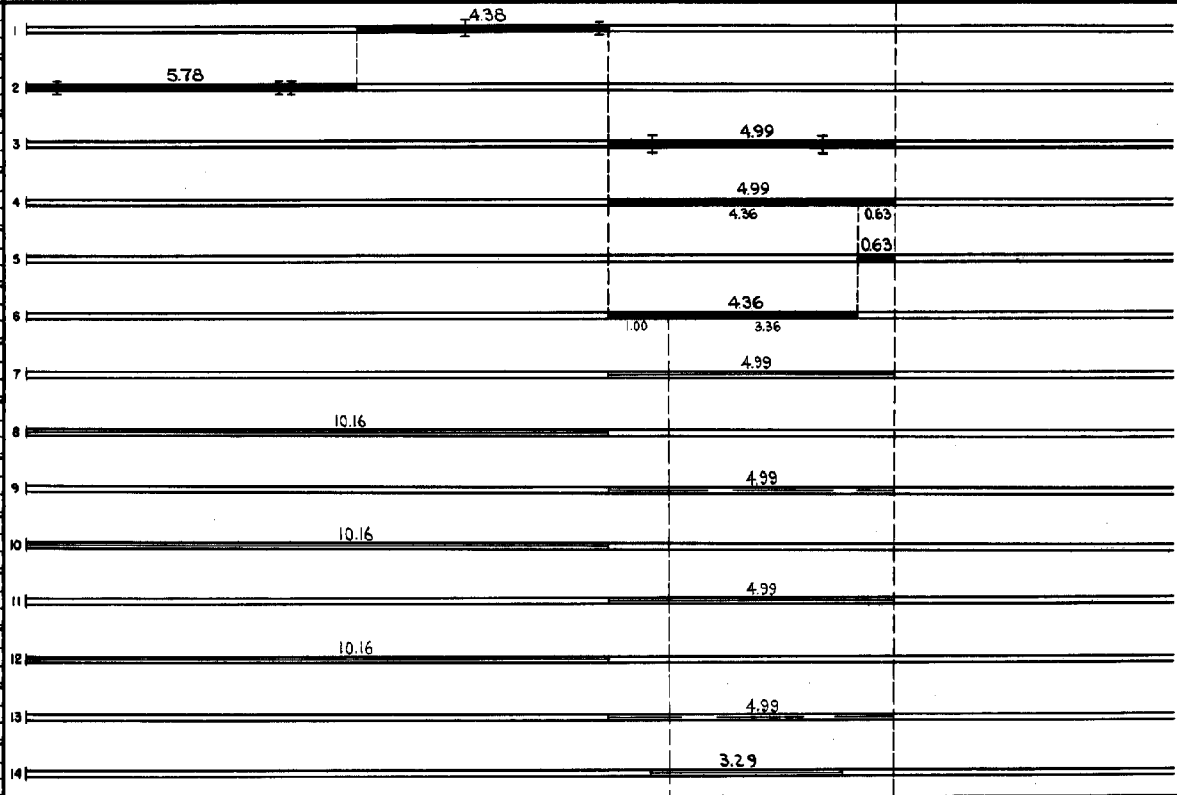

YEARS FROM	YEARS TO	TOTAL MILES	UNINCORPORATED		INCORPORATED		RURAL		URBAN	
			RDWY. MI.	BR. MI.	RDWY. MI.	BR. MI.	RDWY. MI.	BR. MI.	RDWY. MI.	BR. MI.
1934	1950	15.15	14.46	0.06	0.63	0.00	14.46	0.06	0.63	0.00
1951	1971	13.16	12.47	0.06	0.63	0.00	12.47	0.06	0.63	0.00
1972	1974	13.16	12.37	0.06	0.73	0.00	12.37	0.06	0.73	0.00
1974		13.16	12.34	0.06	0.76		12.34	0.06	0.76	

REMARKS: Layout is to scale as of 1934. Plan revised for 1951 relocation.

11-73

PREPARED BY
HIGHWAY PLANNING SURVEY
IN COOPERATION WITH
U. S. PUBLIC ROADS ADMINISTRATION

STATE OF MINNESOTA
DEPARTMENT OF HIGHWAYS
ROAD LIFE STUDIES
CONSTRUCTION PROJECT LOG RECORD

CONTROL SECTION 0801
TRUNK HIGHWAY 4
COUNTY Brown
DISTRICT 76

LIMITS: S. Co. Line - Jct. T.H. 14 in Sleepy Eye

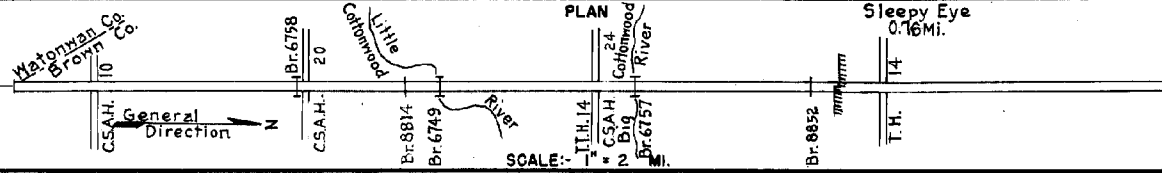

YEAR BUILT	PROJECT N°	DESCRIPTION		REMARKS	CODE N°
		TYPE	WIDTH THICKNESS		
M 1947	A.F.E. 4	Spot Treat Bit. Surf. Repair & Spot Fog Seal		SC-4 & RC-4, 14142 Gal. Agg. 602 C.Y.	
M 1947	A.F.E. 6	Grav. Resurfacing	24'	2357 C.Y.	
M 1949	A.F.E. 6	Grav. Resurfacing	24'	2334 C.Y.	
M 1949	A.F.E. 24	Grade Lift (Spots) Ditch Cleaning (Spots)	2'-4"		
M 1950	A.F.E. 4	Fog Seal Coat	24'	RC5-1, 4478 Gal. Agg. 60 C.Y.	
C 1951	0801-03	Grading Gravel C108x40	34' 30'	700 CY/Mi.	
C 1951	0801-04	Br. 6749	32'	98' B.S.	
C 1951	0801-06	Br. 6758	32'	20' C.S.	
C 1951	0801-07	2 Cattle Passes		Precast Conc.	
M 1952	A.F.E. 4	Spot Treat Bit. Surf. Repair	24'	SC-3 & RS-1, 11652 Gal. Agg. 478 C.Y.	
M 1952	A.F.E. 5	Spot Light Bit. Seal	24'		
M 1952	A.F.E. 6	Grav. Resurfacing	24'	4417 Tons.	
C 1952	0801-09	Approaches & Br. 8814		C105 T	
C 1952	0801-05	Br. 6757	30'	215' Cant. B.S.	
C 1954	0801-10	Grading (3.99 Mi.)	28.50'	Br. 8852 (C1010D)	
(I) 1954	0801-08	Bit. Stab. Base Plant Mix Bit.	2'-6" 2'	On 0-11" sand-Grav. Sub-base	
M 1962		Light Bit. Seal Coat	24'	RS-2, 24538 Gals. Agg. 873 C.Y.	
M 1964	SF	Spot Treat Bit. Surf. Repair	24'	MC-3, 61483 Gal. Agg. 3415 C.Y.	
M 1965	SF	Spot Treat Bit. Surf. Repair	24'	MC-800, 54053 Gal. Agg. 2590 C.Y.	
M 1966	SF	Bit. Surf. Repair	24' 1/2"	RC2 Bit, 500 Gal. Pl. Mix Bit, 343 Ton	

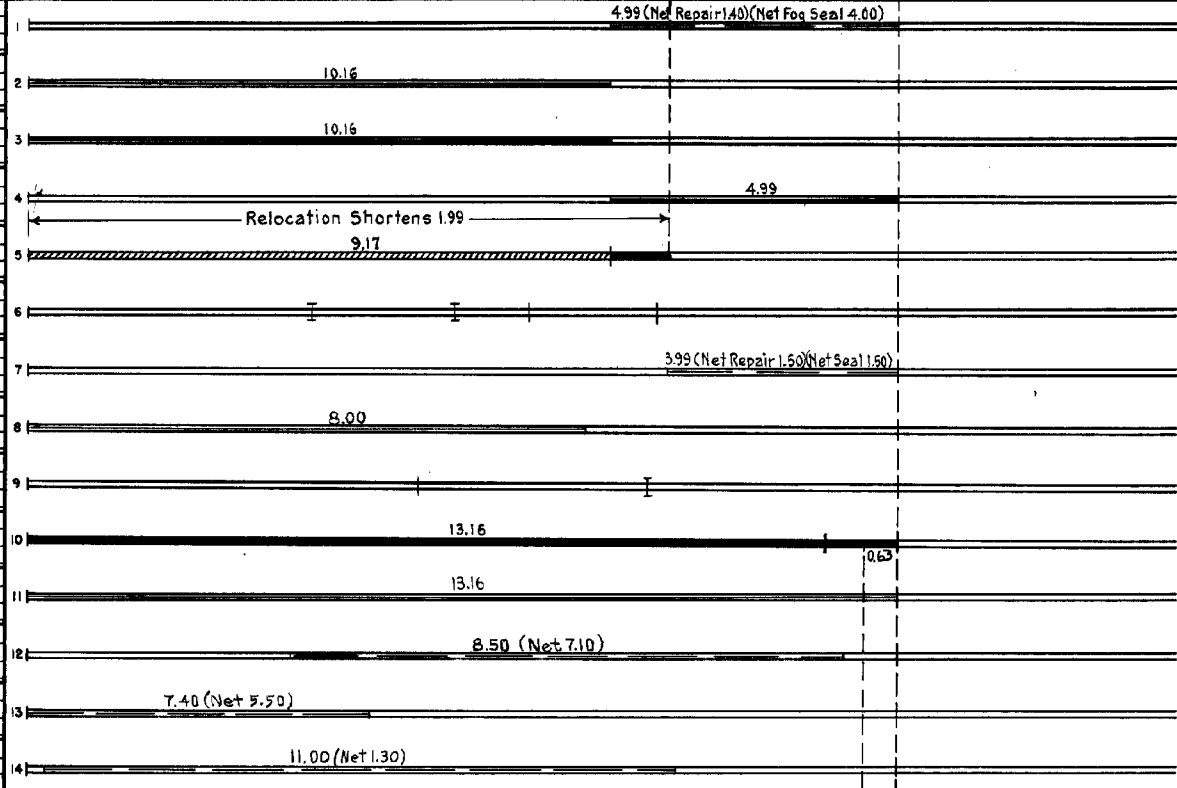

YEARS FROM TO	TOTAL MILES	UNINCORPORATED		INCORPORATED		RURAL		URBAN	
		RDWY. MI.	BR. MI.	RDWY. MI.	BR. MI.	RDWY. MI.	BR. MI.	RDWY. MI.	BR. MI.

REMARKS: See Sheet N°1
(1) Contract not final but work substantially complete

12-8

PREPARED BY
TRANSPORTATION & TRANSIT PLANNING & PROGRAMMING DIVISION
IN COOPERATION WITH
U.S. DEPARTMENT OF TRANSPORTATION-BUREAU OF PUBLIC ROADS

STATE OF MINNESOTA
DEPARTMENT OF HIGHWAYS
ROAD LIFE STUDIES
CONSTRUCTION PROJECT LOG RECORD

CONTROL SECTION OBO
TRUNK HIGHWAY 4
COUNTY Brown
DISTRICT 7B

LIMITS: S. Co. Line - Jct. T.H. 14 in Sleepy Eye
Ref. Pt. 049+00.834 - 062+00.998

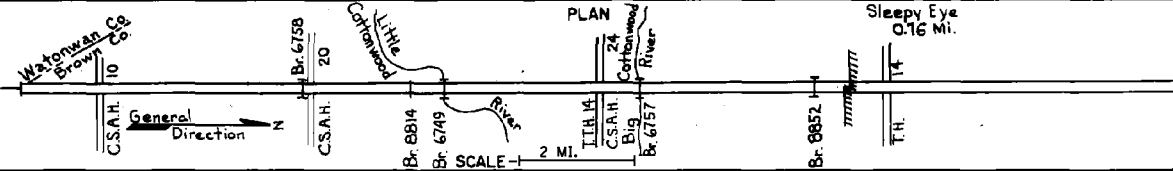

YEAR BUILT	PROJECT NO.	DESCRIPTION				REMARKS
		TYPE	WIDTH	THICKNESS		
C	1970 0801-15	Bit. Mix Overlay	Var.	1 3/4"		
C	1978 0801-18	Bit. RESURFACING	24'	2"		
M	1977 SF	Bit. OVERLAY	24'	1 1/2"		
M	1976 SF	Bit Spot Overlay				
M	1976 SF	SEAL COAT			FA-1 IRC #00	
M	1977 SF	SEAL COAT			FA-1 IRC #00	
M	1977 SF	Bit. Spot Overlay		1 1/2"	P.Mix AC	
C	1980 0801-19	Guardrail Improvement Bridges 87.60				
C	1983 0801-8767	Bridge Deck Repair & Overlay	30'	3"		
M	1983 SF	Seal Coat			CRS-2 & FA-2 Mod.	
M	1985 SF	Seal Coat	24' 50'		CRS-2 & FA-2 Mod. CRS-2 & FA-2 Quartzite	
M	1988 SF	Bit. Overlay	24'	1 1/2"	Spec. 2331	
M	1989 SF	Bit. Overlay	24'	1 1/2"	Spec. 2331	
M	1989 SF	Spot Overlay	24'	1 1/2"	Spec. 2331	

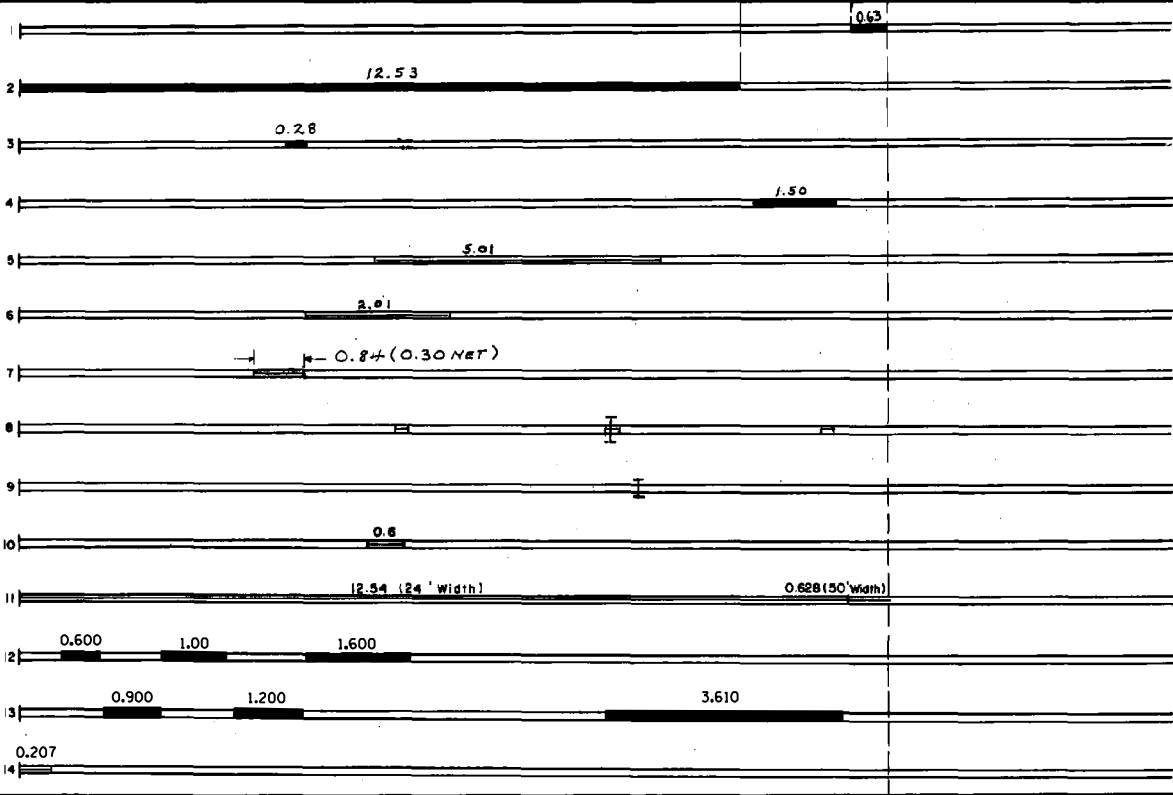

YEARS FROM	TOTAL MILES TO	UNINCORPORATED		INCORPORATED		RURAL		URBAN	
		RDWY. MI.	BR. MI.	RDWY. MI.	BR. MI.	RDWY. MI.	BR. MI.	RDWY. MI.	BR. MI.

REMARKS: See Sheet No. 1

