

PREPARED BY
HIGHWAY PLANNING SURVEY
IN COOPERATION WITH
U.S. PUBLIC ROADS ADMINISTRATION

STATE OF MINNESOTA
DEPARTMENT OF HIGHWAYS
ROAD LIFE STUDIES
CONSTRUCTION PROJECT LOG RECORD

CONTROL SECTION 1820
TRUNK HIGHWAY 3
COUNTY Dakota
DISTRICT 9A

LIMITS: S. Co. Line-N. Jct. T.H. 50 in Farmington

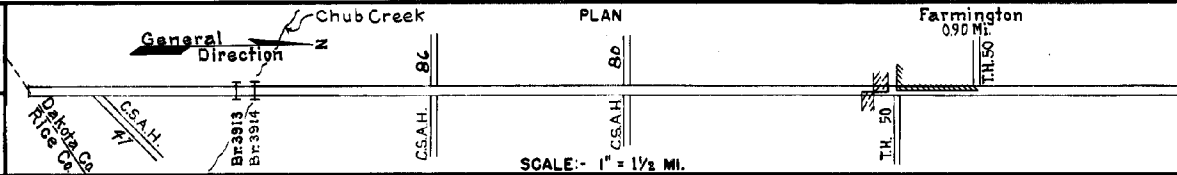

YEAR BUILT	PROJECT N ^o	DESCRIPTION			CODE N ^o
		TYPE	WIDTH	THICK-NESS	
1914		Br. 3913 Br. 3914	18' 18'	16' C.S. 4' C.D.G.	
1921	218-1-21 D&C	Grading Br. 3913 Br. 3914	32' 21' 21'	16' C.S. (Widen) 4' C.D.G. (Widen)	
1922	218-1-33	Grading Concrete Br. M-1067	32' 18'	7 1/2" Pile Bent-U.P.	
1922	218-1-21 D&C	Concrete	18'	7 1/2"	
1922	218-1-18	Asph. Concrete	36x6'	Concrete Base	
1935	218-1-33	Br. 5347	30'	D.P.G. -U.P.	
1937	218-1-21 D	Roadside Develop.			
1937	A.F.E. 35	Plant Mix Bit.	18'	1 1/2" Old Conc. Base Maint. Dept.	
1939	218-1-21 C	Roadside Develop.			
1939	A.F.E. 22	Grav. Shoulders			
C	1946 A.F.E. 27	Install Culvert		48" x 100' C.M.	
C	1920-04	Gravel Base	29'	5 1/2" Over Old Conc. Pav't.	
1948	1920-05	Plant Mix Bit.	25'	3" Extend Mono. Culv's	
	1920-06	Widen Br. 3913 & 3914	36x3'	16' C.S. & 4' C.D.G.	
C	1949	Gravel Base	29'	5" Br. 5347 to be removed (See S.P. 4001-06)	
	1920-08	Plant Mix Bit.	25'	3"	
C	1949	Grading		0.41 Mi. Divided Highway	
	1920-03	Concrete Base	36x6'	6"	
	1920-09	Plant Mix Bit.	36x6'	2"	

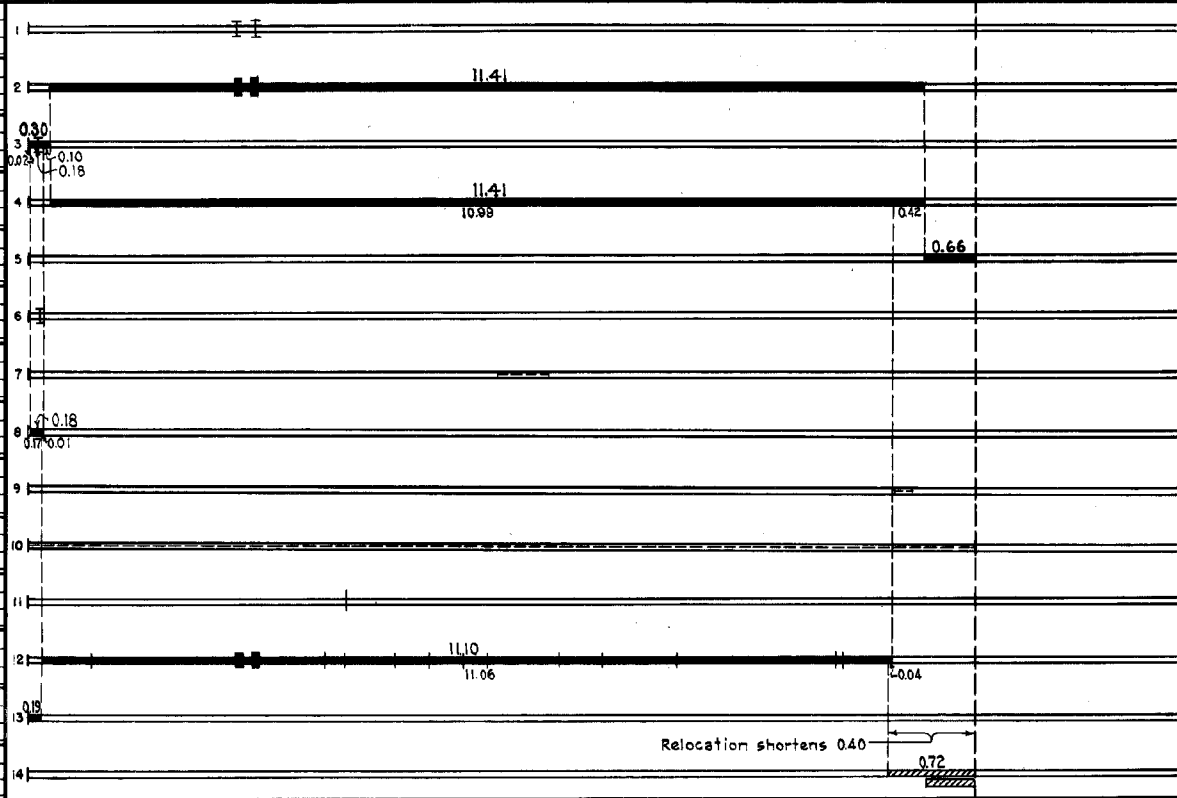

YEARS FROM	TO	TOTAL MILES	UNINCORPORATED		INCORPORATED		RURAL		URBAN	
			RDWY. MI.	BR. MI.	RDWY. MI.	BR. MI.	RDWY. MI.	BR. MI.	RDWY. MI.	BR. MI.
1922	1948	12.37	11.31	0.01	1.05	0.00	11.31	0.01	1.05	0.00
1949	1959	11.97	11.29	0.01	0.67	0.00	11.29	0.01	0.67	0.00
1960	1967	11.97	11.16	0.01	0.80	0.00	11.16	0.01	0.80	0.00
1968		11.97	11.06	0.01	0.90	0.00	11.06	0.01	0.90	0.00

REMARKS: Layout is to scale as of 1922

PREPARED BY
HIGHWAY PLANNING SURVEY
IN COOPERATION WITH
U.S. PUBLIC ROADS ADMINISTRATION

STATE OF MINNESOTA
DEPARTMENT OF HIGHWAYS
ROAD LIFE STUDIES
CONSTRUCTION PROJECT LOG RECORD

CONTROL SECTION 1920
TRUNK HIGHWAY 3
COUNTY Dakota
DISTRICT Metro

LIMITS: S.Co.Line-N.Jct.T.H.50 in Farmington
Ref. Pt. 014+00.022 - 026+00.015

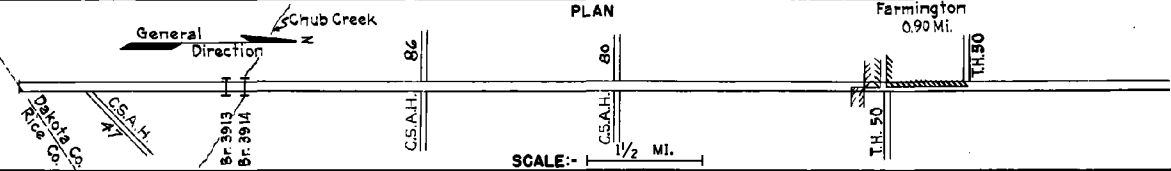

YEAR BUILT	PROJECT N ^o	DESCRIPTION		CODE N ^o
		TYPE	WIDTH THICKNESS	
C	1949 1920-07	Shouldering		
M	A.F.E. 4	Light Bit. Seal	24' 2 3/4"	
	A.F.E. 45	Spot Base Repair Restore Pl. Mix Surf.		
C	1951 1920-13	Traffic Signals		
M	A.F.E. 4	Bit. Fog Seal	24'	
M	1952 1920-14	Spot Plant Mix Surf. Patching & Base Repair		
C	1952 1920-12	Precast Concrete Cattle Pass		
M	1954 A.F.E. 605	Light Bit. Seal		
C	1956 1920-15	Plant Mix Bit.	24' 2 3/4" added	
M	1964 C	Light Bit. Seal	Var.	
C	1969 1920-17	Grade, Base Pl. Mix. Bit. Surf. Gravel Sldrs.		
M	1972 SF	Seal Coat	24'	
C	-21	Widening Turnlanes & Channelization		
C	1978 1920-23	Bit. Overlay, Sldrs & TURN LANES	24' 1 3/4"	
M	1992 SF	Bit. Overlay	24' 1 1/2"	

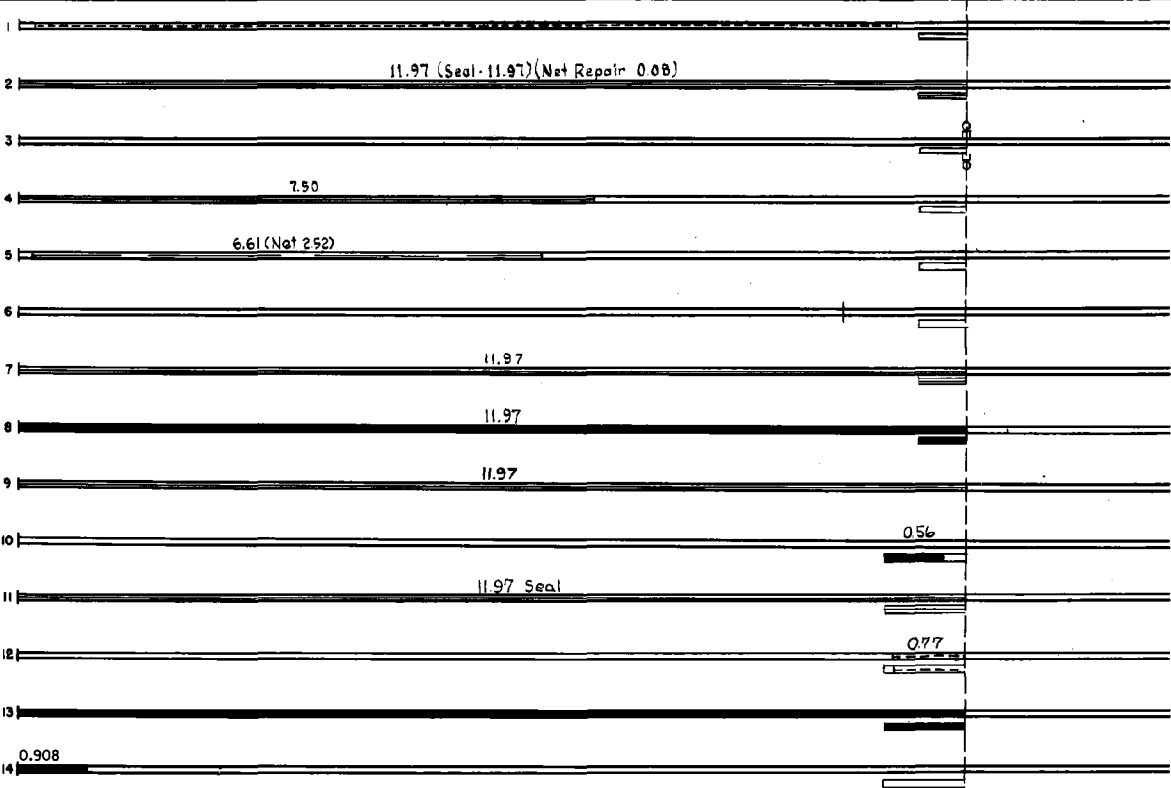

YEARS FROM	TOTAL MILES TO	UNINCORPORATED		INCORPORATED		RURAL		URBAN	
		RDWY. MI.	BR. MI.	RDWY. MI.	BR. MI.	RDWY. MI.	BR. MI.	RDWY. MI.	BR. MI.

REMARKS: See Sheet No. 1

