

PREPARED BY
HIGHWAY PLANNING SURVEY
IN COOPERATION WITH
U. S. PUBLIC ROADS ADMINISTRATION

STATE OF MINNESOTA
DEPARTMENT OF HIGHWAYS
ROAD LIFE STUDIES
CONSTRUCTION PROJECT LOG RECORD

CONTROL SECTION 3602
TRUNK HIGHWAY 1
COUNTY Koochiching
DISTRICT 2A

LIMITS: Jct. T.H. 71 in Northome - E. Co. Line (Jct. T.H. 6)

Northome
1.19 MI.

PLAN

N
General Direction

SCALE: 1" = 2 1/2 MI.

YEAR BUILT	PROJECT N°	DESCRIPTION		REMARKS	CODE N° Dist
		TYPE	WIDTH THICKNESS		
		Gravel Br. # 8012	17' 1/2" 18"	No Record of Constr. Added in 1934. 10' W.S.	
1937	A.F.E. 30	Mixed Bituminous	24' 1 1/2"	Maint. Dept.	
		Re-grading Gravel	28' 2 1/2"	Maint. Dept.	
1938	A.F.E. 20 # 27				
C		Remove Br. 8012 Replace with C.M.		Records not available. Maint. Dept.	
M	1941	A.F.E. 21	Regraveling	28'	405 C.Y./Mi. Maint. Dept.
M	1942	A.F.E. 6	Regraveling Ditch cleaning		555 C.Y./Mi. Maint. Dept.
M	1943	A.F.E. 6	Grav. Resurface		400 C.Y./Mi. Maint. Dept.
M	1945	A.F.E. 6	Grav. Resurfacing		513 C.Y./Mi. Maint. Div.
M	1948	A.F.E. 6	Grav. Resurfacing		11958 CY.
C		Grading	32' 2"		
1949	3602-04	Stab. Gravel	32' 2" (1)	1200 C.Y./Mi.	348
C		Grading (0.23 mi.) Gravel Lift (0.94 mi.) Mixed Bit.	32' 2" 36' 2" 1 1/2"	M02, 1970 Gal. 0.27 Mi. Mixed Prime Bit Seal Coat	
C	1950	A.F.E. 7	Seeding		
M	1951	A.F.E. 6	Grav. Resurfacing		12873 Tons
C		Bit. Resurfacing Mixed Bit. Portable Culverts	36' 2" 1 1/2" 36' 2"	M03, 5925 Gal. Agg. 240 CY.	

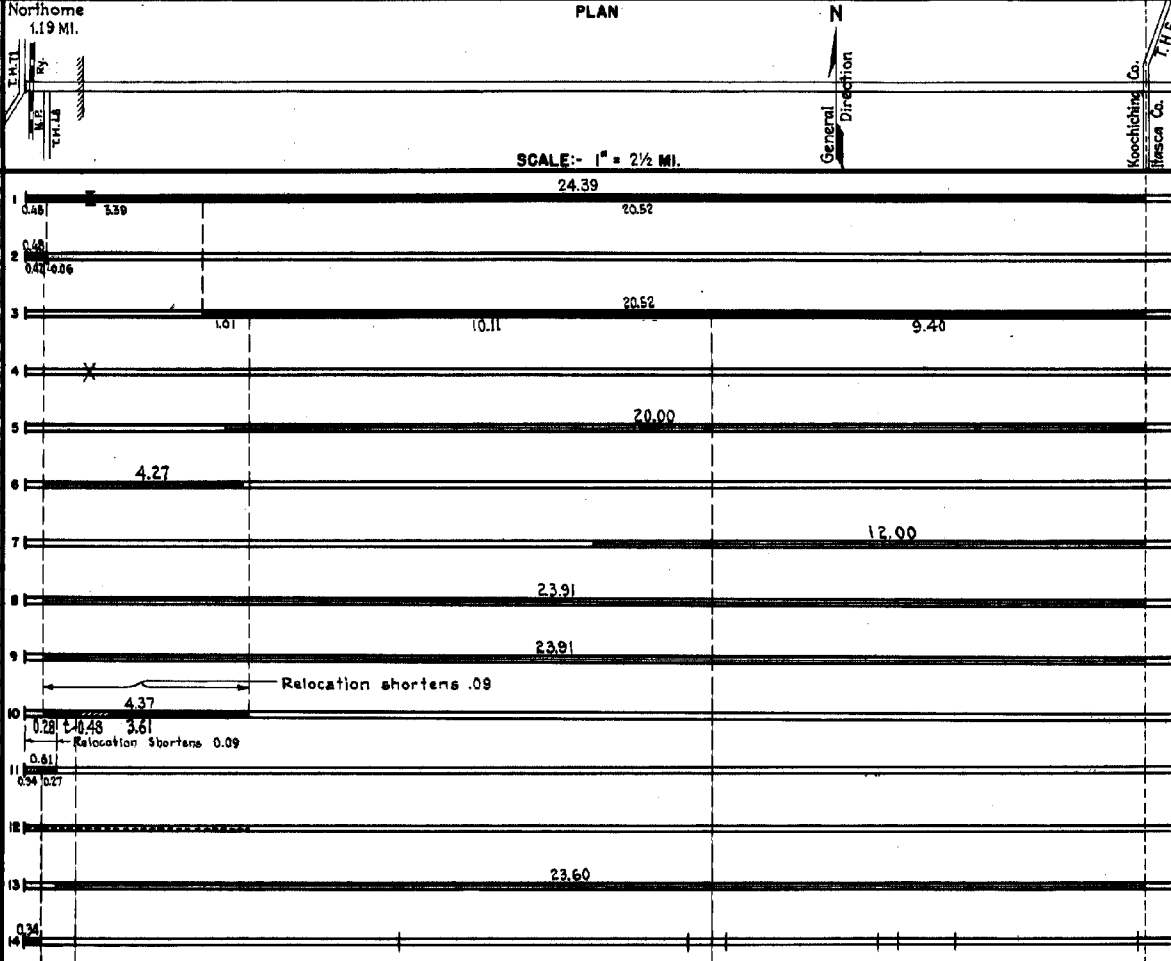

FROM	TO	TOTAL MILES	UNINCORPORATED		INCORPORATED		RURAL		URBAN	
			RDWY. MI.	BR. MI.	RDWY. MI.	BR. MI.	RDWY. MI.	BR. MI.	RDWY. MI.	BR. MI.
1934	1939	24.39	23.15	0.01	1.23	0.00	24.39	0.07	0.00	0.00
1940	1948	24.39	23.16	0.00	1.23	0.00	24.39	0.00	0.00	0.00
1949	1949	24.30	23.02	0.00	1.28	0.00	24.30	0.00	0.00	0.00
1950	1957	24.21	21.02	0.00	1.19	0.00	24.21	0.00	0.00	0.00
1958		23.88	22.69	0.00	1.19	0.00	23.88	0.00	0.00	0.00

REMARKS: Layout is to scale as of 1934
(1) 9'-18" Gravel Base for .14 Mile in Northome

PREPARED BY
HIGHWAY PLANNING SURVEY
IN COOPERATION WITH
U.S. PUBLIC ROADS ADMINISTRATION

STATE OF MINNESOTA
DEPARTMENT OF HIGHWAYS
ROAD LIFE STUDIES
CONSTRUCTION PROJECT LOG RECORD

CONTROL SECTION 3602
TRUNK HIGHWAY
COUNTY Koochiching
DISTRICT 2A

LIMITS: N. Jct. T.H. 71 in Northome - E. Co. Line (Jct. T.H. 6)

Northome
1.19 Mi.

PLAN

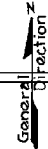
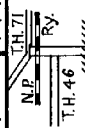

Koochiching Co.
Itasca Co.
T.H. 6

YEAR BUILT	PROJECT NO.	DESCRIPTION			CODE NO.
		TYPE	WIDTH	THICKNESS	
M 1953	A.F.E. 606	Grav. Resurfacing	24'		11840 Tons
C 1956	A.F.E. 818	Bit. Resurf. (0.27 Mi.) Bit. Surf. (0.48 Mi.) Mixed Bit.			MC-2, 9100 Gal. Agg. 770 Tons
C 1957	3602-11	Spot Bit. Stab. Base Plant Mix Bit.	34" 24"	Var. 1 1/2"	957
C 1957	A.F.E. 825	Sand-Grav. Base Mixed Bit. (Mixed Prime)	24" 24"	Var. 1"	Base 84,548 Tons MC-1 & SC-3, 68198 Gal. Agg. 10102 Tons
M 1958	A.F.E. 604	Spot Base Repair Spot Treat Bit. Surf. Repair			Base 4565 Tons Bit. 34774 Gal. Agg. 1290 Tons
C 1958	A.F.E. 824	Sand-Grav. Sub-base Gravel Base	28" 28"	6" 3"	SC-3 & MC-1, 118999 Gal. Agg. 6696 Tons
C & M 1959	A.F.E. 823 A.F.E. 604	Gravel Base Mixed Bit. Bit. Surf. Repair	24" 24"	Var. 1 1/2"	Agg. 31531 Tons MC-1 & SC-3, 20797 Gal. MC-2 & SC-2, 10050 Gal.
M 1960		Spot Treat Bit. Surf. Repair	24'		SC-3, 12900 Gal. Agg. 852 Tons
M 1961		Spot Treat Bit. Surf. Repair Light Bit. Seal	24'		MC-2 & SC-2, 29050 Gal. RC-2, 23915 Gal. 961
M 1962		Light Bit. Seal			RS-2, 2316 Gal. Agg. 80 C.Y. 1262
C 1963	3602-14 & 15	Grading, Sub-base Gravel Base Rd. Mix Bit. (Base)	30" 24"	3" 1 1/2"	6" Gravel Sub-base 862
M 1965	C	Light Bit. Seal	25'		RS-10, 26,696 Gal. Agg. 930 C.Y.
C 1966	3602-16	Shoulder Grading Mixed Bit. Resurf. Gravel Shoulders	32" 24"		1145 365
M 1968	SF	Bit. Surf. Repair Seal Coat	24'	1"	MC-250, 26355 Gal. Agg. 1862 Ton MC-260, 2850 Gal.

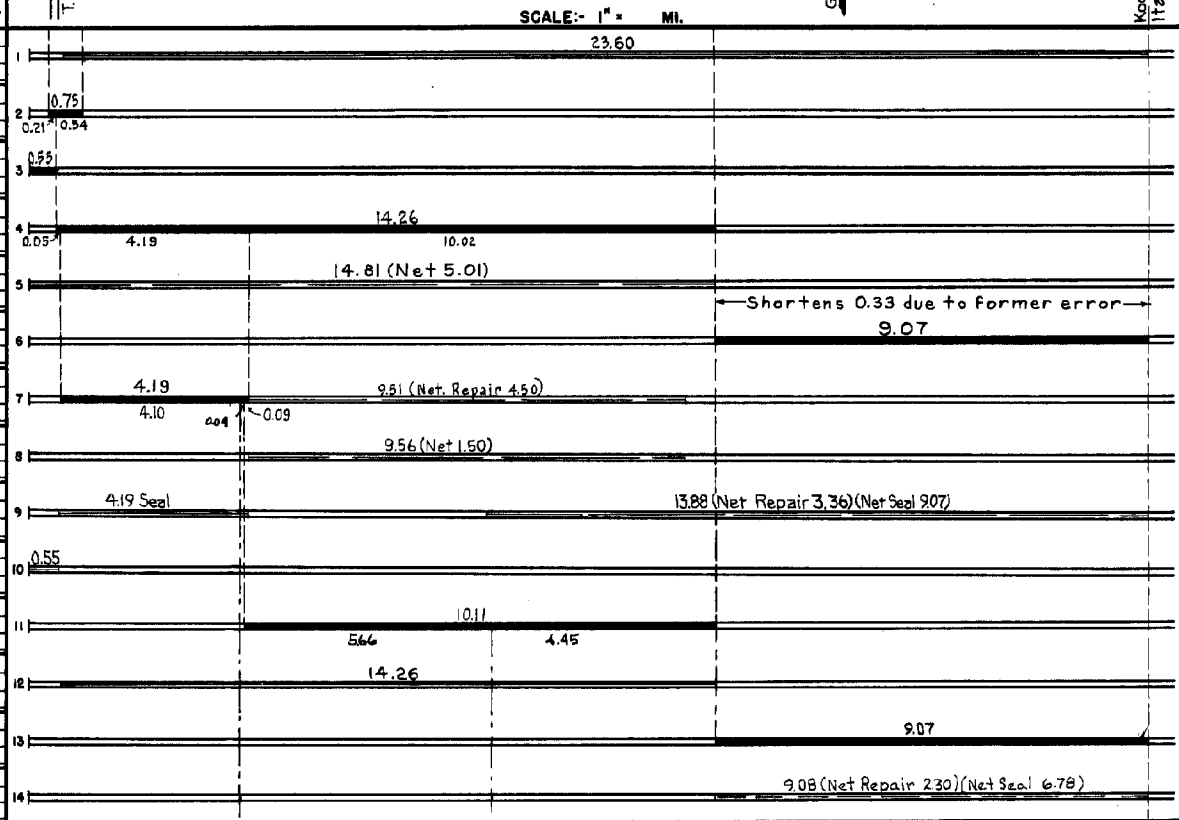

YEARS FROM TO		TOTAL MILES	UNINCORPORATED		INCORPORATED		RURAL		URBAN	
FROM	TO		RDWY. MI.	BR. MI.	RDWY. MI.	BR. MI.	RDWY. MI.	BR. MI.	RDWY. MI.	BR. MI.

REMARKS: See Sheet No. 1
FOR OTHER PROJECTS SEE DIST. No. 1161, 1261, 1264

