

PREPARED BY
HIGHWAY PLANNING SURVEY
IN COOPERATION WITH
U.S. PUBLIC ROADS ADMINISTRATION

STATE OF MINNESOTA
DEPARTMENT OF HIGHWAYS
ROAD LIFE STUDIES
CONSTRUCTION PROJECT LOG RECORD

CONTROL SECTION 3805
TRUNK HIGHWAY 61
COUNTY Lake
DISTRICT 1A

LIMITS: E. Corp. Limits of Two Harbors - N.E. End of Bridge at
Gooseberry River

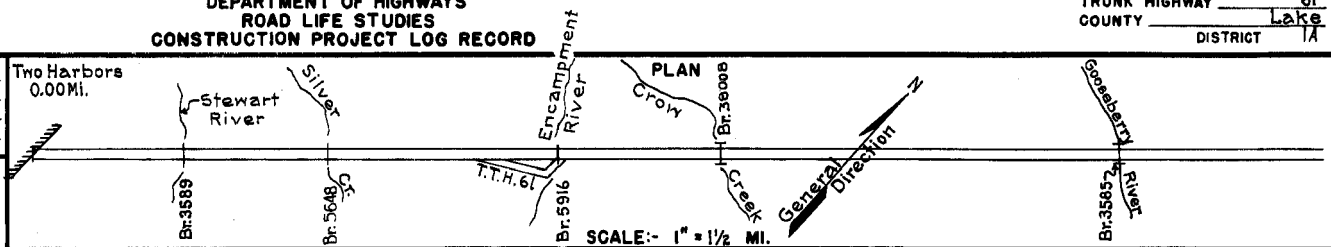

YEAR BUILT	PROJECT N ^o	DESCRIPTION			CODE N ^o
		TYPE	WIDTH	THICKNESS	
1924	61-1-01	Grading Br. 3589, 3588, 3587, 3590, 3584 & 3585	30'		70 CA, 600 PG, 50 C.D.G., 40 C.D.G., 460 DT, 278 A&D PG
1925	61-1-01-3, 4 & 5	Gravel	24'	4 1/4"	2000 C.Y./Mile.
	(1)				
1929	61-1-01-3, 4 & 5	Tar Tr. Gravel	20'	1"	11935 Gal./Mile. Maint. Dept.
	(1)				
1932	61-1-01-5	Oil Tr. Gravel	20'	1 1/2"	16888 Gal./Mile. Maint. Dept.
1936	61-1-29	Br. 5643 Br. 5648			Mono. Culv. W1010 DH.
	(1)				
1937	61-1-29	Remove Br. 3588 & 3587 and Backfill Br. 5643 & 5648			Maint. Dept.
	(1)				
1937	1936 A.F.E. 26 1937 A.F.E. 26 1937 A.F.E. 13	Stab. Gravel Base Mixed Bit.	30' 24'	3'-9" 1"	Maint. Dept.
	(1)				
1937	A.F.E. 8 A.F.E. 13	Stab. Gravel Base Mixed Bit. Surf.	30' 24'	3'-9" 1"	Maint. Dept.
	(1)				
1937	61-1-29	Br. 3585	30'		Br. widening 2-60 D.P.G. & 1-150' Steel Arch.
	(1)				
1939	3805-01 3805-02	Grade widening & sloping Culvert Extensions	32'		
	(1)				
1939	3805-09	Br. 3589	30'		Bridge widening, 70 Conc. Arch.
	(1)				
1939	3805-13	Sand & Gravel Base Stab. Grav. Surf. Grading	32' 32' 32'	9" 3"	
	(1)				
C	1940 A.F.E. 7	Seeding			Maint. Dept.
C	1940 A.F.E. 22	Mixed Bitum. Surf.	28'	1"	Maint. Dept.

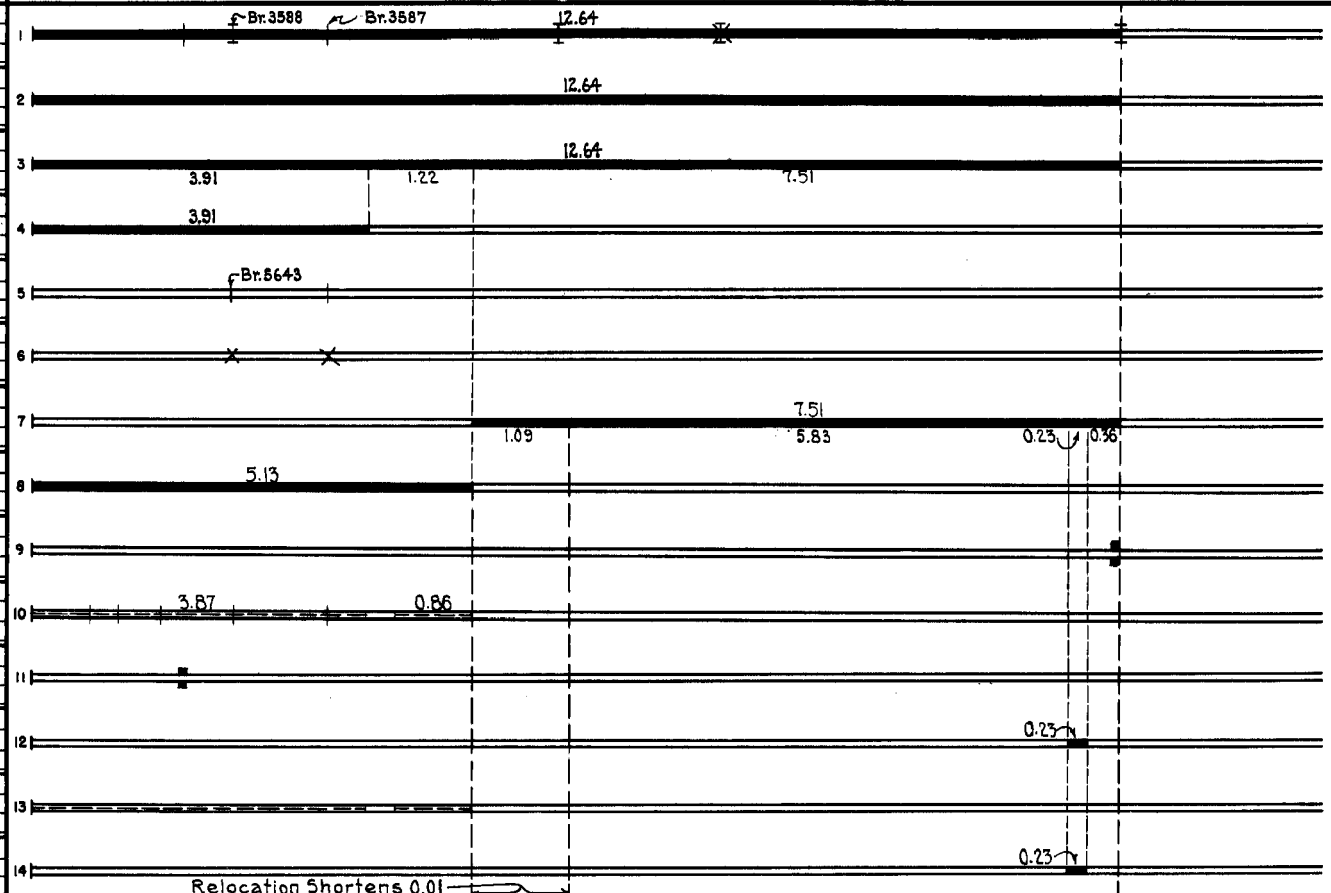

YEARS		TOTAL MILES	UNINCORPORATED		INCORPORATED		RURAL		URBAN		REMARKS
FROM	TO		RDWY. MI.	BR. MI.	RDWY. MI.	BR. MI.	RDWY. MI.	BR. MI.	RDWY. MI.	BR. MI.	
1924	1935	12.64	12.47	0.17	0.00	0.00	12.47	0.17	0.00	0.00	REMARKS: Layout is to scale as of 1924 (1) This work not done under these project numbers but lies within the limits of these projects
1936	1940	12.64	12.49	0.15	0.00	0.00	12.49	0.15	0.00	0.00	
1941	1949	12.63	12.49	0.14	0.00	0.00	12.49	0.14	0.00	0.00	
1950	1968	12.64	12.50	0.14	0.00	0.00	12.50	0.14	0.00	0.00	
1969		12.60	12.46	0.14	0.00	0.00	12.46	0.14	0.00	0.00	

PREPARED BY
HIGHWAY PLANNING SURVEY
IN COOPERATION WITH
U.S. PUBLIC ROADS ADMINISTRATION

STATE OF MINNESOTA
DEPARTMENT OF HIGHWAYS
ROAD LIFE STUDIES
CONSTRUCTION PROJECT LOG RECORD

CONTROL SECTION 3805
TRUNK HIGHWAY 61
COUNTY Lake
DISTRICT 1A

LIMITS: E. Corp. Limits of Two Harbors - N.E. End of Bridge at
Gooseberry River.

Two Harbors
0.00 Mi.

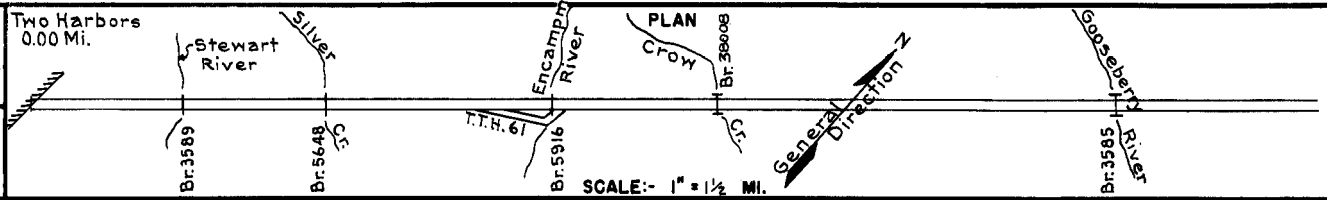

YEAR BUILT	PROJECT N ^o	DESCRIPTION			CODE N ^o
		TYPE	WIDTH	THICKNESS	
C	3805-07	Sand & Gray Base Stab. Sand & Gray Br. 5916	32'	5" 3"	
C	A.F.E. 20 1941 A.F.E. 48	Seeding Mixed Bit.	24'	1"	
M	A.F.E. 8	Bit. Retreat.	24'		
M	A.F.E. 4	Spot Treat. Bit. Surf. Repair	24'		
M	A.F.E. 4	Spot Treat. Bit. Surf. Repair	24'		
M	A.F.E. 4	Spot Treat. Bit. Surf. Repair	24'		
C	3805-25	Base Repair (Spots) Mixed Bit.	25' 26'	9" 1 1/2" Added	
M	A.F.E. 4	Spot Treat. Bit. Surf. Repair	24'		
M	A.F.E. 4	Spot Treat. Bit. Surf. Repair	24'		
M	A.F.E. 4	Bit. Fog Seal	24'		
C	3805-27	Plant Mix Bit.	24'	1 1/2" added	
M	A.F.E. 605	Light Bit. Seal	27'		
C	A.F.E. 824 1957 A.F.E. 825 1958	Guard Rail (6324) Guard Rail (2527)			
C	1960	Extend & Reline Culverts			

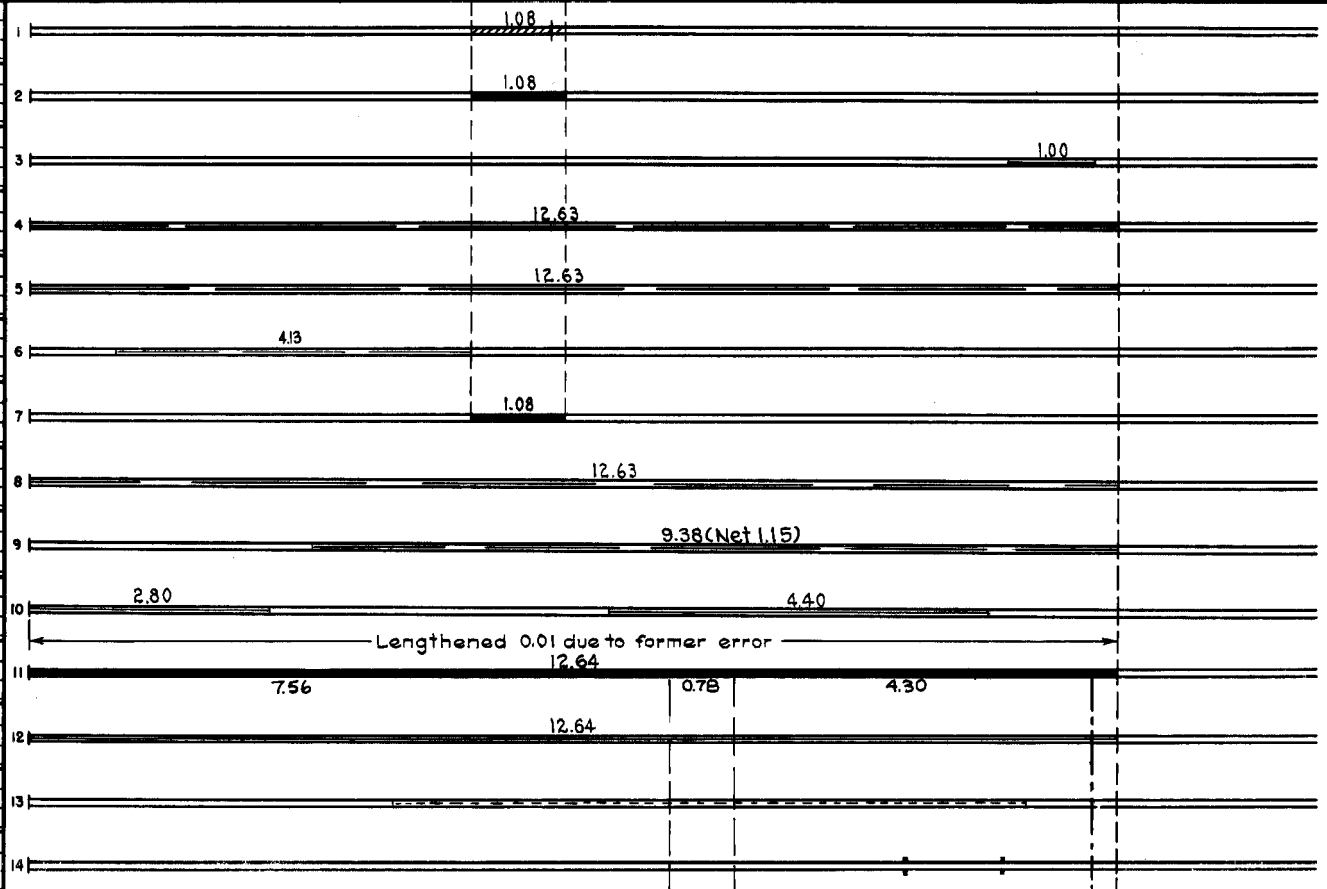

YEARS FROM	TOTAL MILES TO	UNINCORPORATED		INCORPORATED		RURAL		URBAN	
		RDWY. MI.	BR. MI.	RDWY. MI.	BR. MI.	RDWY. MI.	BR. MI.	RDWY. MI.	BR. MI.

REMARKS: See Sheet N^o 1

PREPARED BY
TRAFFIC AND PLANNING DIVISION
IN COOPERATION WITH
U.S. DEPARTMENT OF COMMERCE
BUREAU OF PUBLIC ROADS

STATE OF MINNESOTA
DEPARTMENT OF HIGHWAYS
ROAD LIFE STUDIES
CONSTRUCTION PROJECT LOG RECORD

CONTROL SECTION 3805
TRUNK HIGHWAY 61
COUNTY Lake
DISTRICT 1A

LIMITS: E. Corp. Limits of Two Harbors - N.E. End of Bridge at
Gooseberry River

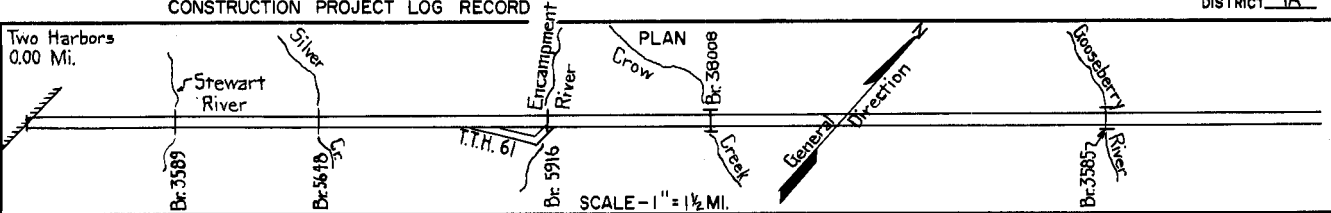

YEAR BUILT	PROJECT NO.	DESCRIPTION			
		TYPE	WIDTH	THICKNESS	REMARKS
M 1961		Spot Treat Bit Surf Repair	26'		Plant Mix 840 Tons Tack 388 Gal. MC-2
M 1962		Spot Treat Bit Surf Repair	27'		Pl. Mix 930 Tons Tack MC-2, 600 Gal.
M 1963		Spot Treat Bit Surf Repair	24'	1"	P. Mix, 108 Tons MC-2, Tack 100 Gal.
M 1964	S.F.	Spot Treat Bit Surf Repair	27'	1"	Pl. Mix 360 Tons Tack MC-2, 150 Gal.
M 1965	S.F.	Spot Treat Bit Surf Repair	27'	1"	Pl. Mix 496 Tons Tack MC-2, 800, 100 Gal.
M 1967	C	Bit Seal Coat			CRS-1 Bit 238.9 Gal. FA-1 Agg. 797.9 C.Y.
M 1968	SF	Bit Surf Repair			MC-250 2800, 600 Gal. Agg. 1069 Ton
C 1969	3805-37	Grade Base P. Mix Bit Surf. Grav. Shldr. Br. 38008			539' B.S.
M 1970	SF	Bit Surface Repair	24'	1"	RC-250 Tack 350 Gal. Agg. 929 Tons
C 1971	3805-45	Asphaltic conc.	24'	3/4"	Overlay
C 1973	3805-46	Shoulder Widening Bit Overlay	24'	1 1/2"	
M 1982	SF	Culverts and Culvert Extension Replacements			Contract # 3931 Various Locations
M 1983	SF	Culvert Replacements			10 Culverts Contract No. 3987
M 1984	3805 SF	Culvert Replacement			36" RCP 58' Long Contract No. 4083

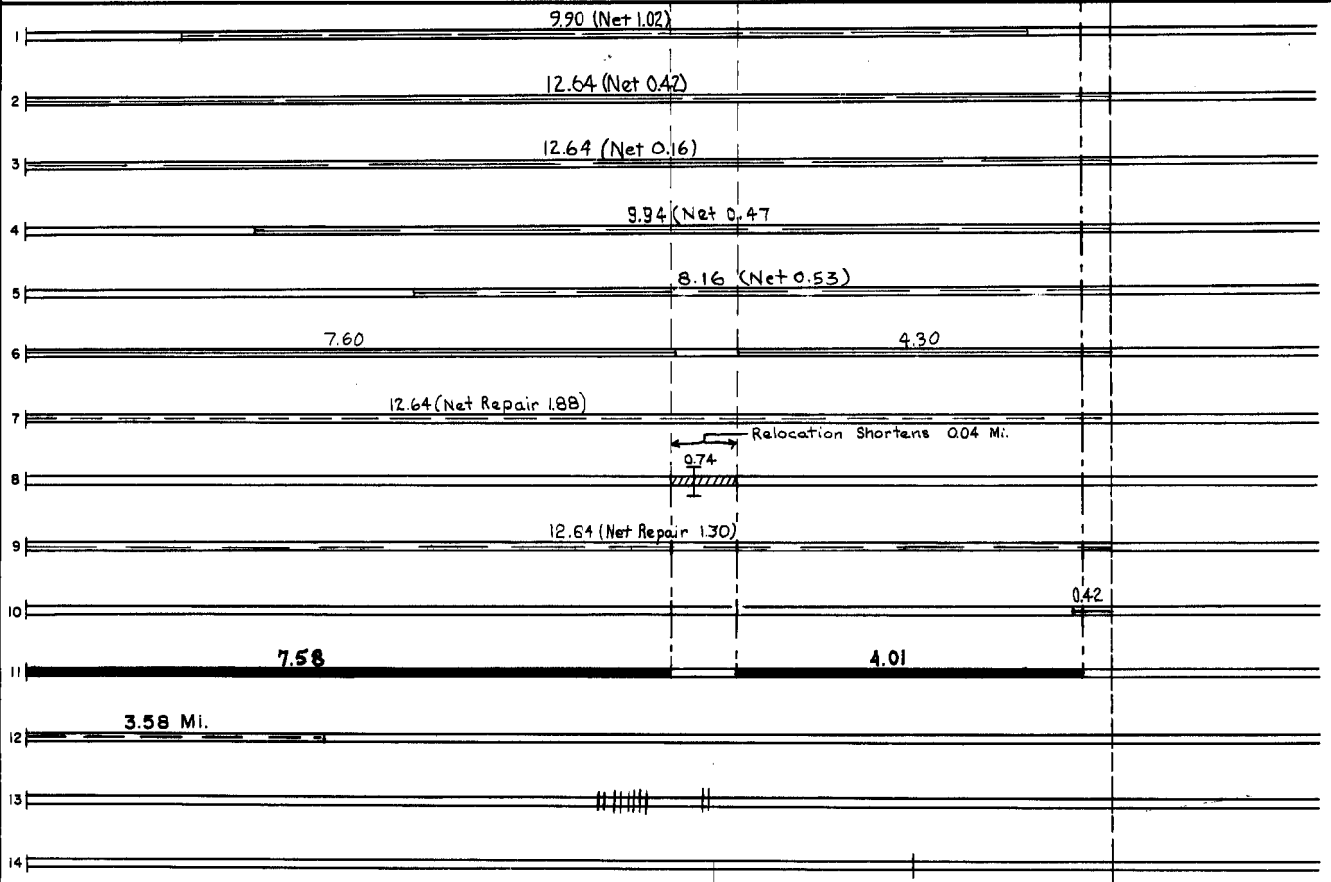

YEARS FROM	TOTAL TO	MILES	UNINCORPORATED		INCORPORATED		RURAL		URBAN	
			RDWY. MI.	BR. MI.	RDWY. MI.	BR. MI.	RDWY. MI.	BR. MI.	RDWY. MI.	BR. MI.

REMARKS: See Sheet No. 1

PREPARED BY
BUREAU OF POLICY & PLANNING
IN COOPERATION WITH
U.S. DEPARTMENT OF TRANSPORTATION-FEDERAL HIGHWAY ADMINISTRATION

STATE OF MINNESOTA
DEPARTMENT OF TRANSPORTATION
CONSTRUCTION PROJECT LOG RECORD

CONTROL SECTION 3805
TRUNK HIGHWAY 61
COUNTY Lake
DISTRICT 1A

LIMITS: E. Corp. Limits of Two Harbors - N.E. End of Bridge at Gooseberry River

Ref. Pt. 026+00.771 - 039+00.320

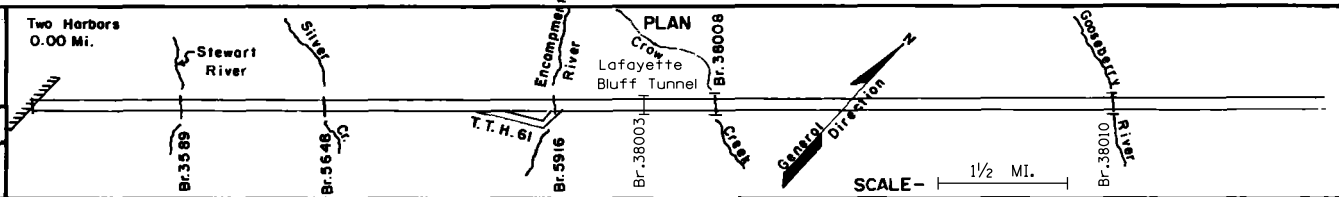

YEAR BUILT	PROJECT NO	DESCRIPTION			
		TYPE	WIDTH	THICKNESS	REMARKS
M 1984	SF	Seg in Rdwy Overlay	20' 35"	0.5"	Sp. 2341 22 Tons
M 1985	3805-57	Bit Surfacing	24'	2"	
M 1987	SF	Spot Overlay	12'	1 1/2"	Spec. 2361 Rt. Shldr only
M 1988	SF	Spot Overlay	24'	1 1/2"	Spec. 2341
C 1990	3805-58	Grading Bit. Surfacing	27'	5" 1"	Spec. 2331 Spec. 2361
C 1992	3805-69	Grading Conc. Surfacing	27'	8"	
C 1996	3805-67	Grading Conc. Surfacing	53' 27'		Spec. 2301
C 1996	3805-74	Grading Surfacing Agg. Base	24', 48' 20', 44' 20', 44'	36" 3"	Class 5
S 2001	8821-46	Bit. Overlay	24'	1 1/2"	Spec. 2350
M 2006	8821-142	Crack Seal			Type 3725
M 2011	8826-104	Bit. Crack Repair			
C 2012	3805-101	Grading Concrete Pavement Conc. Pvt Repair	27'	7.5"	Agg. Base 6' Class 5 Spec. 2301
C 2013	8821-153	Milling Bit. Overlay	24' 24'	2" 3.5"	Spec. 2360
C 2018	3805-103	Bit. Mill & Overlay (tied SP 3808-36)	var.	var.	Spec. 2360

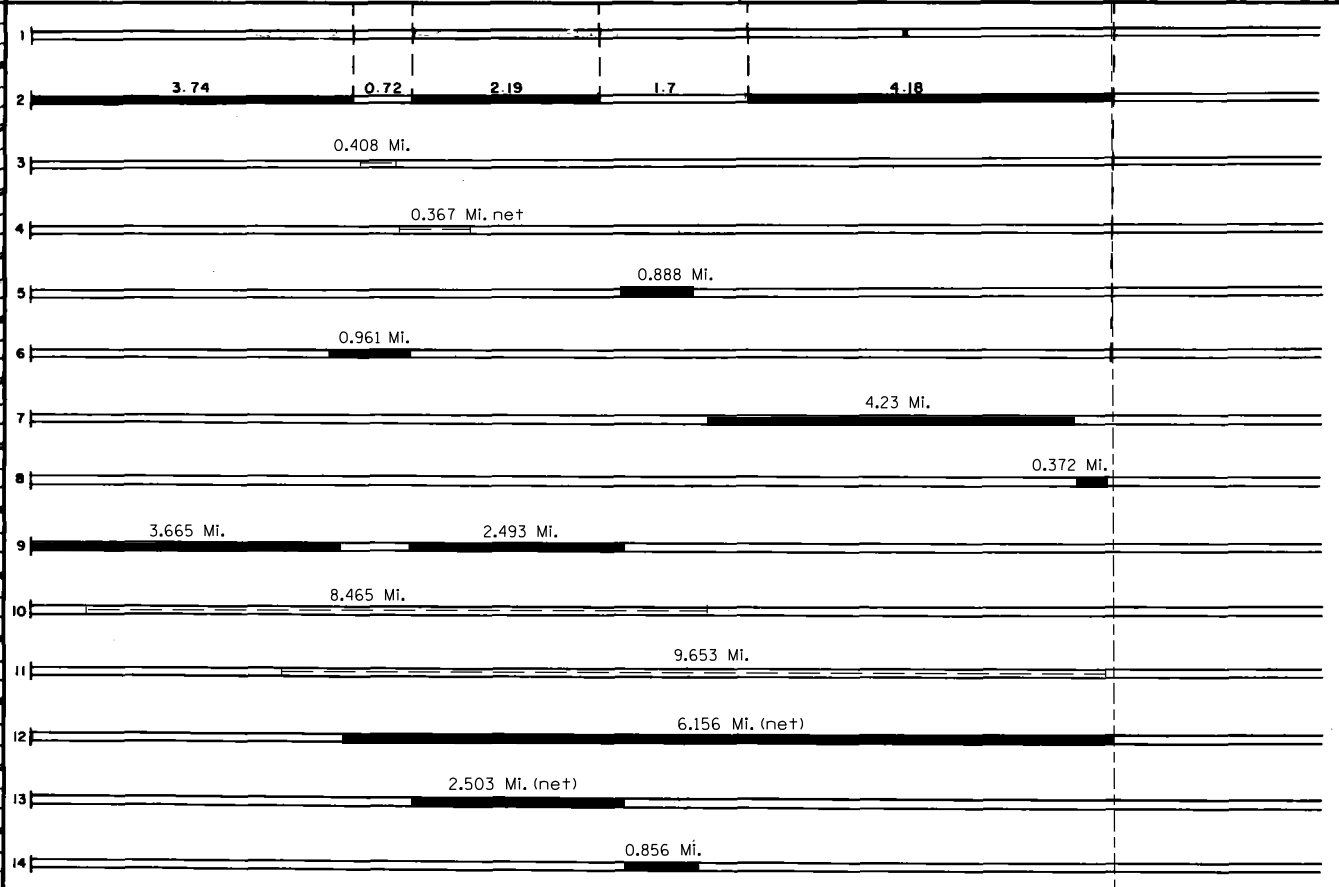

YEARS		TOTAL MILES	UNINCORPORATED		INCORPORATED		RURAL		URBAN	
FROM	TO		RDWY. MI.	BR. MI.	RDWY. MI.	BR. MI.	RDWY. MI.	BR. MI.	RDWY. MI.	BR. MI.

REMARKS:

