

PREPARED BY
HIGHWAY PLANNING SURVEY
IN COOPERATION WITH
U.S. PUBLIC ROADS ADMINISTRATION

STATE OF MINNESOTA
DEPARTMENT OF HIGHWAYS
ROAD LIFE STUDIES
CONSTRUCTION PROJECT LOG RECORD

CONTROL SECTION 3808
TRUNK HIGHWAY 61
COUNTY Lake
DISTRICT IA

LIMITS: Jct. T.H. 1 - E. Co. Line

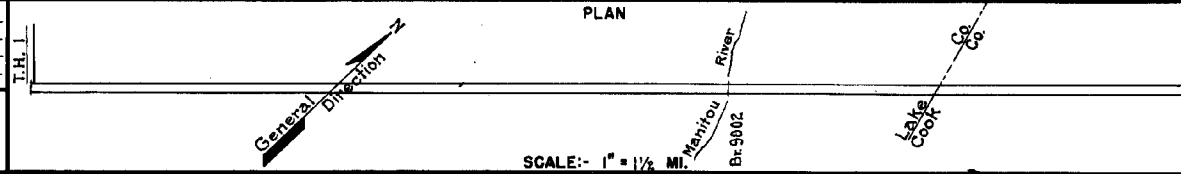

YEAR BUILT	PROJECT N ^o	DESCRIPTION			CODE N ^o
		TYPE	WIDTH	THICKNESS	
1923	61-1-30B	Grading Br. 3439 Br. 3440	30' 19' 19'		380 D.T. & D.P.G. 280 D.T. & D.P.G.
(1)					
1923	61-1-30B	Gravel	24'	2 1/4"	1000 C.Y./Mile. Maint. Dept.
1924	61-1-01	Grading Br. 2460	30' 19'		B.O.L.T.
(1)					
1924	61-1-01-1	Gravel	24'	2"	Status Map Indicates Gravel in 1924.
1930	61-1-01-1 (1) 61-1-30B (1)	Tar Tr. Gravel	24'	1 1/2"	13205 Gal./Mile. Maint. Dept.
1937	1937 A.F.E. 39 1938 A.F.E. 39	Inst. Soil Excavation Stab. Gravel Lifts	30'	7 5/8"	Maint. Dept.
1938	A.F.E. 22	Mixed Bitum.	24'	1 1/2"	Maint. Dept.
M	1940 A.F.E. 15	Bit. Seal Coat			Bit. 4057 Gal./Mi. Sand, 112 C.Y./Mi. Maint. Dept.
C	1947 A.F.E. 28	Culvert			48" x 76 C.M.
M	1948 A.F.E. 4	Bit. Fog Seal	24'		RC5-0, 10271 Gal.
C	1949 3808-09	Plant Mix Bit.	24'	1 1/2" added	
M	1955 A.F.E. 605	Bit. Seal Coat & Spot Reseal (Over 295 MI)	24'		RC-2 & RT-6, 21538 Gal. Agg. 1000 C.Y.
C	1956 3808-11	Grade & Sand Gr. Matl. Bit. Stab. Base Plant Mix Bit.	40' 40' 24'	24" 6" 3"	Const. C 27 & 25 X 239' Conc. Arch. Culv. (Br. 9002)
M	1957 A.F.E. 605 A.F.E. 828	Light Bit Seal Slide Repair #	25'		RC-2, 3456 Gal. Agg. 144 C.Y. #R7, 385-888 & 1027-1035

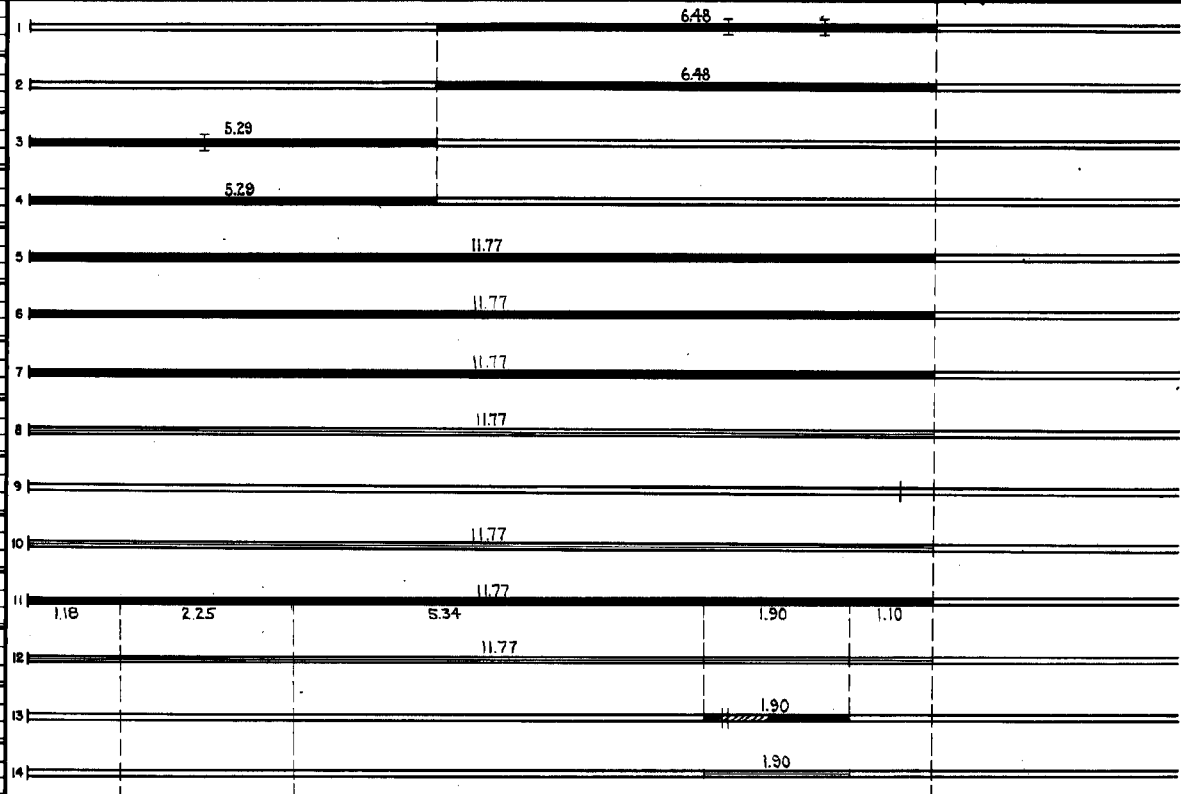

YEARS FROM	TO	TOTAL MILES	UNINCORPORATED		INCORPORATED		RURAL		URBAN	
			RDWY. MI.	BR. MI.	RDWY. MI.	BR. MI.	RDWY. MI.	BR. MI.	RDWY. MI.	BR. MI.
1924	1968	11.77	11.63	0.14	0.00	0.00	11.63	0.14	0.00	0.00
1969		11.60	11.47	0.13	0.00	0.00	11.47	0.13	0.00	0.00

REMARKS: Layout is to scale as of 1924

(1) This work not done under these project numbers but lies within the limits of these projects

