

PREPARED BY
HIGHWAY PLANNING SURVEY
IN COOPERATION WITH
U.S. PUBLIC ROADS ADMINISTRATION

STATE OF MINNESOTA
DEPARTMENT OF HIGHWAYS
ROAD LIFE STUDIES
CONSTRUCTION PROJECT LOG RECORD

CONTROL SECTION 5906
TRUNK HIGHWAY 75
COUNTY Pipestone
DISTRICT 8B

LIMITS: W. Jct. T.H. 30 in Pipestone - N. Co. Line

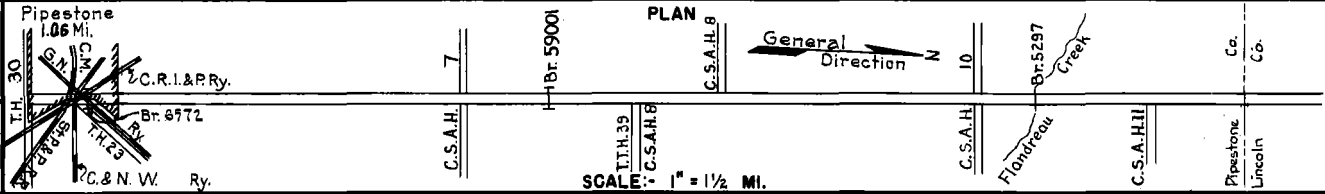

YEAR BUILT	PROJECT N°	DESCRIPTION			CODE N°
		TYPE	WIDTH	THICKNESS	
1920	75-6-20B	Grading Gravel Br. 4719	30' 24' 27'	3 1/2" 3 1/2" 3 1/2"	Co. Job 2006. 1600 C.Y./Mile. 30' B.S.
1921	75-6-20A	Grading Gravel	24'	3 1/2"	1600 C.Y./Mile.
1922	75-6-02A	Concrete Br. 2858	V.M. 19'	7 1/2" 40'	C.D.G.
1922	75-6-01	Grading Gravel	30' 24'	3 1/2" 3 1/2"	1600 C.Y./Mile.
1923	75-6-08	Grading Gravel	30' 24'	3 1/2" 3 1/2"	1600 C.Y./Mile.
1924		Grading Gravel	24'	3 1/2"	Maint. Dept.
1925	75-6-08	Guard Rail			
1926		Oil Tr. Gravel	24'	1 1/2"	10000 Gal./Mile. Maint. Dept.
	(1)				
1926	75-6-20A	Oil Tr. Gravel	24'	1 1/2"	10000 Gal./Mile. Maint. Dept.
	(1)				
1931	75-6-20A & B 75-6-01 & 08	Oil Tr. Gravel	24'	1 1/2"	10000 Gal./Mile. Maint. Dept.
1936	75-6-24	Br. 5297			W1010T
	5906-01	Crossing Signal			G.N. Ry.
1939	5906-02	Crossing Signal			C. St. P.M. & C.R.I. & P.
	5906-03	Crossing Signal			C. M. St. P. & P.R.R.
1939	A.F.E. 78	Shoulder Gravel			
M		Spot Treat			MC-3-1416 Gal./Mi.
1942	A.F.E. 4	Bit Surf. Repair	24'		Grav. 88 C.Y./Mi. Maint. Dept.

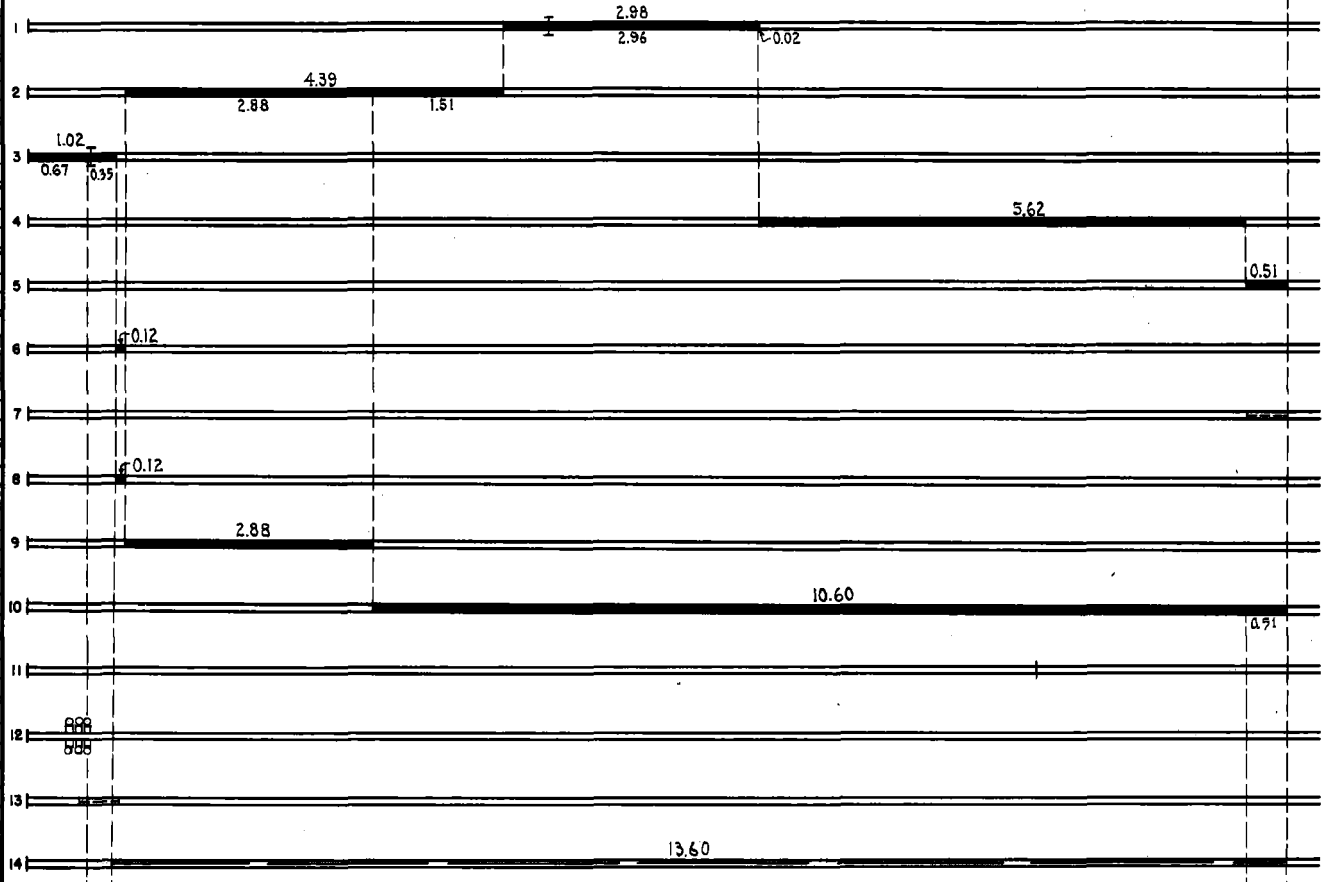

YEARS		TOTAL MILES	UNINCORPORATED		INCORPORATED		RURAL		URBAN	
FROM	TO		RDWY. MI.	BR. MI.	RDWY. MI.	BR. MI.	RDWY. MI.	BR. MI.	RDWY. MI.	BR. MI.
1924	1949	14.62	13.59	0.01	1.01	0.01	13.59	0.01	1.01	0.01
1950	1954	4.07	13.04	0.01	1.01	0.01	13.04	0.01	1.01	0.01
1955	1960	4.05	13.04	0.01	0.99	0.01	13.04	0.01	0.99	0.01
1961	1961	14.05	12.98	0.01	1.05	0.01	12.98	0.01	1.05	0.01
1962		14.05	12.97	0.02	1.05	0.01	12.97	0.02	1.05	0.01

REMARKS: Layout is to scale as of 1924

(1) This work not done under these project numbers but lies within the limits of these projects.

PREPARED BY
HIGHWAY PLANNING SURVEY
IN COOPERATION WITH
U.S. PUBLIC ROADS ADMINISTRATION

STATE OF MINNESOTA
DEPARTMENT OF HIGHWAYS
ROAD LIFE STUDIES
CONSTRUCTION PROJECT LOG RECORD

CONTROL SECTION 5906
TRUNK HIGHWAY 75
COUNTY Pipestone
DISTRICT 88

LIMITS: W. Jct. T.H. 30 in Pipestone - N. Co. Line

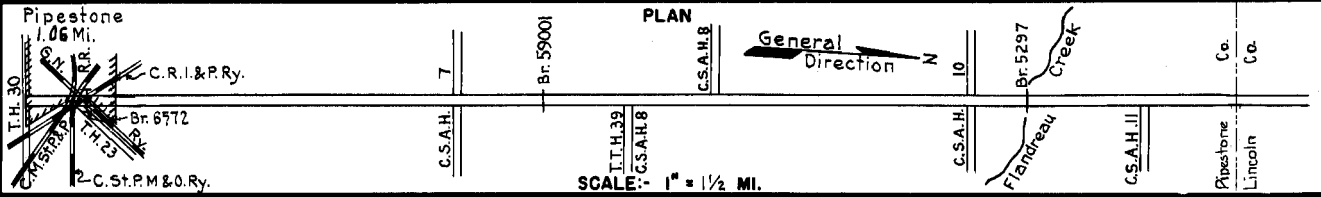

YEAR BUILT	PROJECT N°	DESCRIPTION			CODE N°
		TYPE	WIDTH	THICKNESS	
M 1944	A.F.E. 4	Spot Treat. Bit. Surf. Repair			MC-3, 1039 Gal./Mi. Grav. 36 C.Y./Mi. Maint. Div.
M 1945	A.F.E. 4	Spot Treat. Bit. Surf. Repair			Bit. 2524 Gal./Mi. Grav. 110 C.Y./Mi. Maint. Div.
M 1946	A.F.E. 4	Spot Treat. Bit. Surf. Repair	24'		SC-3, 11771 Gal. Agg. 558 C.Y.
M 1947	A.F.E. 4	Spot Treat. Bit. Surf. Repair	24'		SC-3, 18835 Gal. Agg. 1358 Tons
M 1948	A.F.E. 4	Spot Treat. Bit. Surf. Repair	22'		SC-3, 38300 Gal. Agg. 2785 Tons
M 1949	A.F.E. 4	Spot Treat. Bit. Surf. Repair	22'		MC2&5C3, 21497 Gal. Agg. 1673 Tons
C 1950	5906-13	Grade Widening	48'		
C 1950	5906-12	Br. 6772	30'		90' C.D.G.
C 1950	5906-10	Grading	42'		Removed Br. 8364 &
C 1950	5906-11	Gravel (Galv. Bit. Mixt.) Culverts (2)	78'	3'	8365 (2-W 106 Culv)
C 1951	5906-14	Gravel Base Plant Mix Bit.	36'	6'-10" 24' 1 1/2"	
C 1955	5906-16	Grav. Sub-base Bit. Stab Base Plant Mix Bit.	20' 3/4" 20' 3/4" 50'	12" 5'-8" 3"	Old 30' conc. from Mi. Pt. 0.00-0.52 left imp. & used as part of base
M 1956	A.F.E. 605	Light Bit. Seal	24'		RS-2, 23323 Gal. Agg. 800 C.Y.
M 1958	A.F.E. 604	Spot Treat. Bit. Surf. Repair	24'		SC-3 & MC2, 10858 Gal. Agg. 773 Tons
M 1959	A.F.E. 604	Spot Treat. Bit. Surf. Repair	24'		SC-3, 9864 Gal. Agg. 694 Tons
M 1960		Spot Treat. Bit. Surf. Repair	24'		SC-3 & MC2, 7969 Gal. Agg. 503 Tons

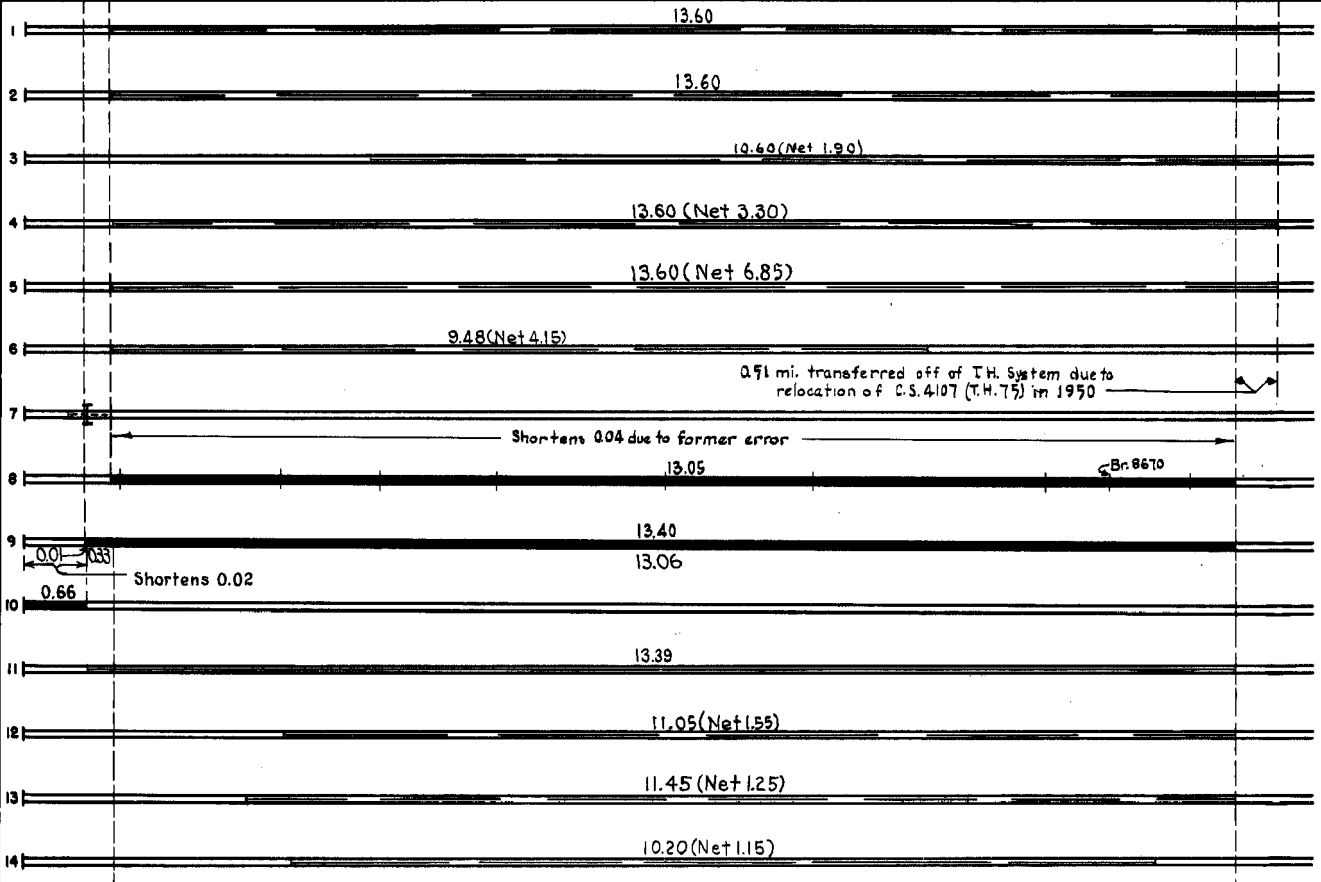

YEARS		TOTAL MILES	UNINCORPORATED		INCORPORATED		RURAL		URBAN	
FROM	TO		RDWY. MI.	BR. MI.	RDWY. MI.	BR. MI.	RDWY. MI.	BR. MI.	RDWY. MI.	BR. MI.

REMARKS: See Sheet No 1
(2) 2-C84; 2-C86; ext. W64; C57; C88, C108 & 82 (Br. 8670); 4-C55.

PREPARED BY
TRAFFIC AND PLANNING DIVISION
IN COOPERATION WITH
U.S. DEPARTMENT OF COMMERCE
BUREAU OF PUBLIC ROADS

STATE OF MINNESOTA
DEPARTMENT OF HIGHWAYS
ROAD LIFE STUDIES
CONSTRUCTION PROJECT LOG RECORD

CONTROL SECTION 5906
TRUNK HIGHWAY 75
COUNTY Pipestone
DISTRICT 8D

LIMITS: W. Jct. TH. 30 in Pipestone - N. Co. Line

Ref. Pt. 035+00.990 - 049+00.991

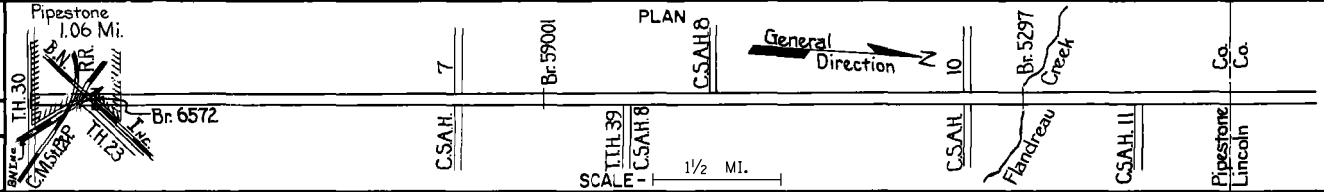

YEAR BUILT	PROJECT NO.	DESCRIPTION			
		TYPE	WIDTH	THICKNESS	REMARKS
C	5906-19	Grading, Base	24'	7"	Rt. & Lt. of surf. in place
	5906-5297	P.C. Concrete Additional barrel			on Br. 5297
C	5906-59001	Bridge 59001	30'		99' Prestressed Slab
M	1963	Bit. Seal Coat	Var.		HS-2K, 5337 Gal. Agg. 233 C.Y.
C	1972-24	Bit. Base Widening	24'-50'		
M	1977	Pl. Mix Bit. SHOULDER SEAL COAT	8'-8"	3/4"	744 Cu. Yd. FA-2 Bit. Mat. CRS-1 20340 GAL. SEAL
M	1980 SF	Seal Coat Shoulders			FA-1 Agg. 25-30 #/Sq. Yd. CRS-1 Bit. 0.22-0.25 Gal. 1 Sq. Yd.
M	1984 5906-27	Bit. Milling	46'	2"	Remove Bit. Surf. (Portion Only)
		Bit. Overlay	40'-46'	2"	
C	1991 5906-31	Bit. Overlay	24'	1 1/2"	Spec. 2331 Spec. 2341
M	1993 M93150	Bit. Sealing			
C	1997 5906-35	Bit. Overlay	30'	Var.	Spec. 2331, 2341
C	1998 5906-34	Bit. Overlay	28'	Var.	Spec. 2350
		Crack Concrete	24'		Class I
		Gravel Surfacing	6'	4 1/2"	
M	2001 8828-33	Bit. Surface Repair	24'		Spec. 2331
		Route and Seal			
M	2003 8828-67	Sealcoat Surfacing			F2
C	2012 5906-38	Bit. Surfacing	28'	1.5"	Spec. 2360

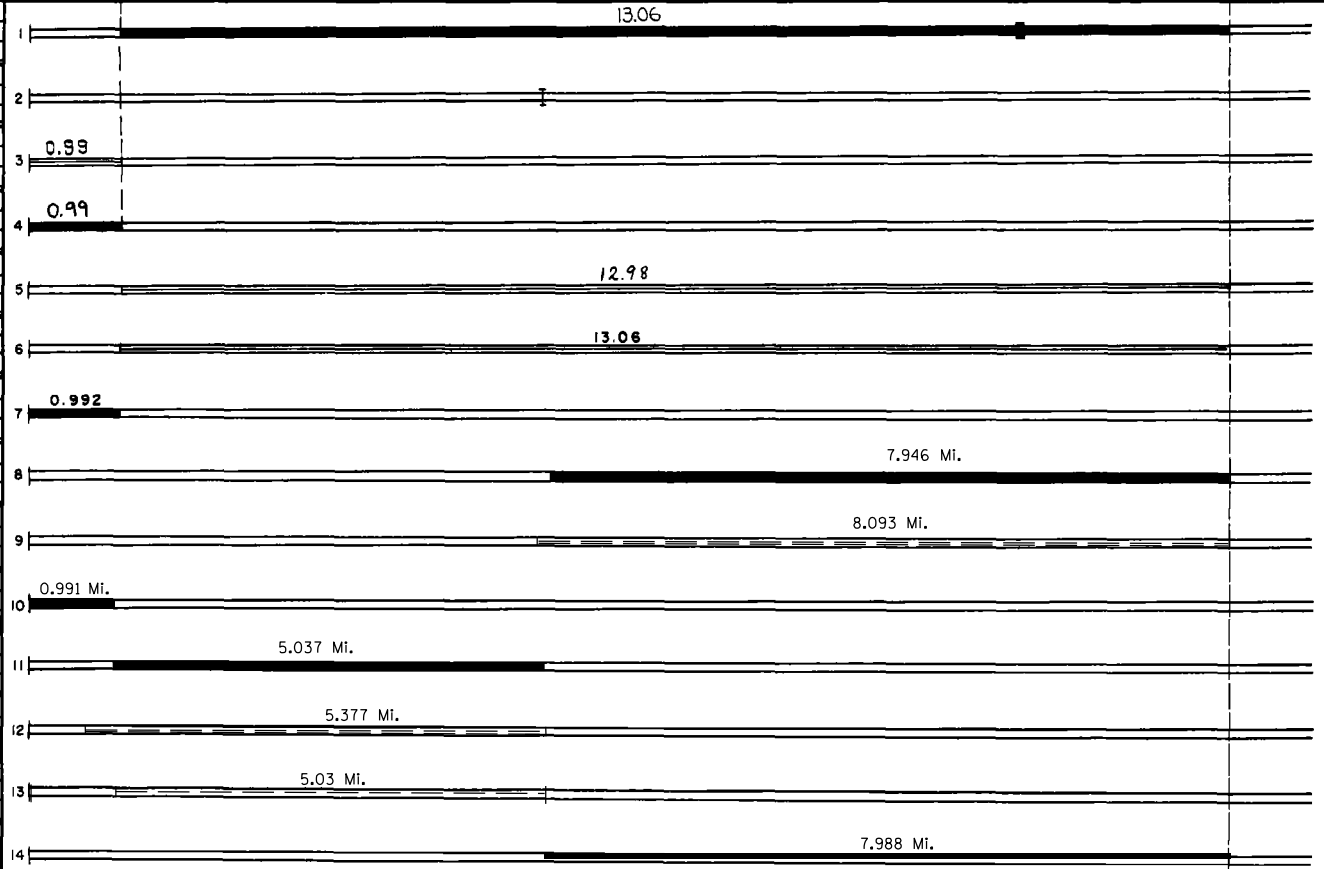

YEARS		TOTAL MILES	UNINCORPORATED		INCORPORATED		RURAL		URBAN	
FROM	TO		RDWY. MI.	BR. MI.	RDWY. MI.	BR. MI.	RDWY. MI.	BR. MI.	RDWY. MI.	BR. MI.

REMARKS: See Sheet No. 1

