

PREPARED BY
HIGHWAY PLANNING SURVEY
IN COOPERATION WITH
U.S. PUBLIC ROADS ADMINISTRATION

STATE OF MINNESOTA
DEPARTMENT OF HIGHWAYS
ROAD LIFE STUDIES
CONSTRUCTION PROJECT LOG RECORD

CONTROL SECTION 6301
TRUNK HIGHWAY 32
COUNTY Red Lake
DISTRICT 2B

LIMITS: So. Co. Line - No. Co. Line

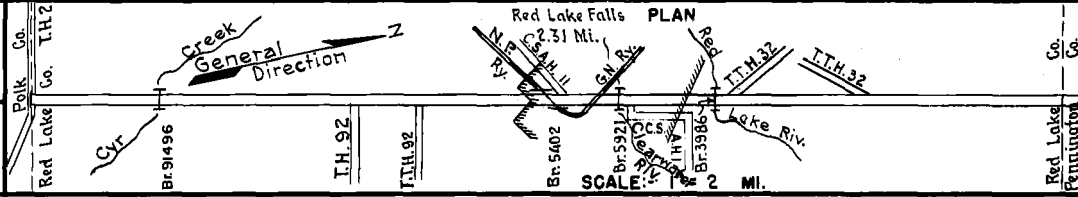

YEAR BUILT	PROJECT N°	DESCRIPTION			CODE N° DIST.	
		TYPE	WIDTH	THICKNESS		
		Gravel	20'	2"	No Record of Const. 200' C.D.G.	
		Gr. 2893 (1)	24'			
1922	32-32-01	Grading	25'			
		Gravel	24'	3 1/4"	1500 G.Y./Mile. 28' C.D.G.	
		Gr. 3739	20'			
1924	32-32-02	Grading	30'			
		Gravel	24'	3 1/4"	1500 G.Y./Mile. 290' H.T. & L.T.	
		Gr. 3986	19'			
(2)	1930	32-32-01	Oil Tr. Gravel	24'	1 1/2"	10683 Gal./Mile. Maint. Dept.
		Oil Tr. Gravel	24'	1 1/2"	10683 Gal./Mile. Maint. Dept.	
(2)	1930	32-32-02	Oil Tr. Gravel	24'	1 1/2"	10683 Gal./Mile. Maint. Dept.
		Grading	32'		333	
1933	32-32-29-2	Gravel	24'	1 3/4"	5500 G.Y./Mile. 28' C.D.G. (Widening) 1234	
		Gr. 3739	27'			
1934	32-32-29-2	Bit. Road Mix	24'	2 1/2"	1" Wearing Course. 1 1/2" Binder Course. 1435	
1935	32-32-29-3	Grading	32'		534	
1936	32-32-29-3	Grading	32'		2336	
		Gr. 5402	30'		120' R.S.O.H.	
1936	32-32-29-2	Bit. Plant Mix	24'	5 1/2"	1 1/2" Wearing Course. 1 1/2" Binder Course. 2 1/2" Base Course.	
(2)	1936	32-32-29-3	Gravel	28'	1 1/2"	Maint. Dept.
		Mixed Bitum.	24'	1"	Maint. Dept.	
A.F.E. 23	1940	Gravel Base. M. Bit. Retreat. 5.0 Mi.	32'	6"		
		Mixed Bit. 1.0 Mi.	24'	1"	Maint. Dept.	

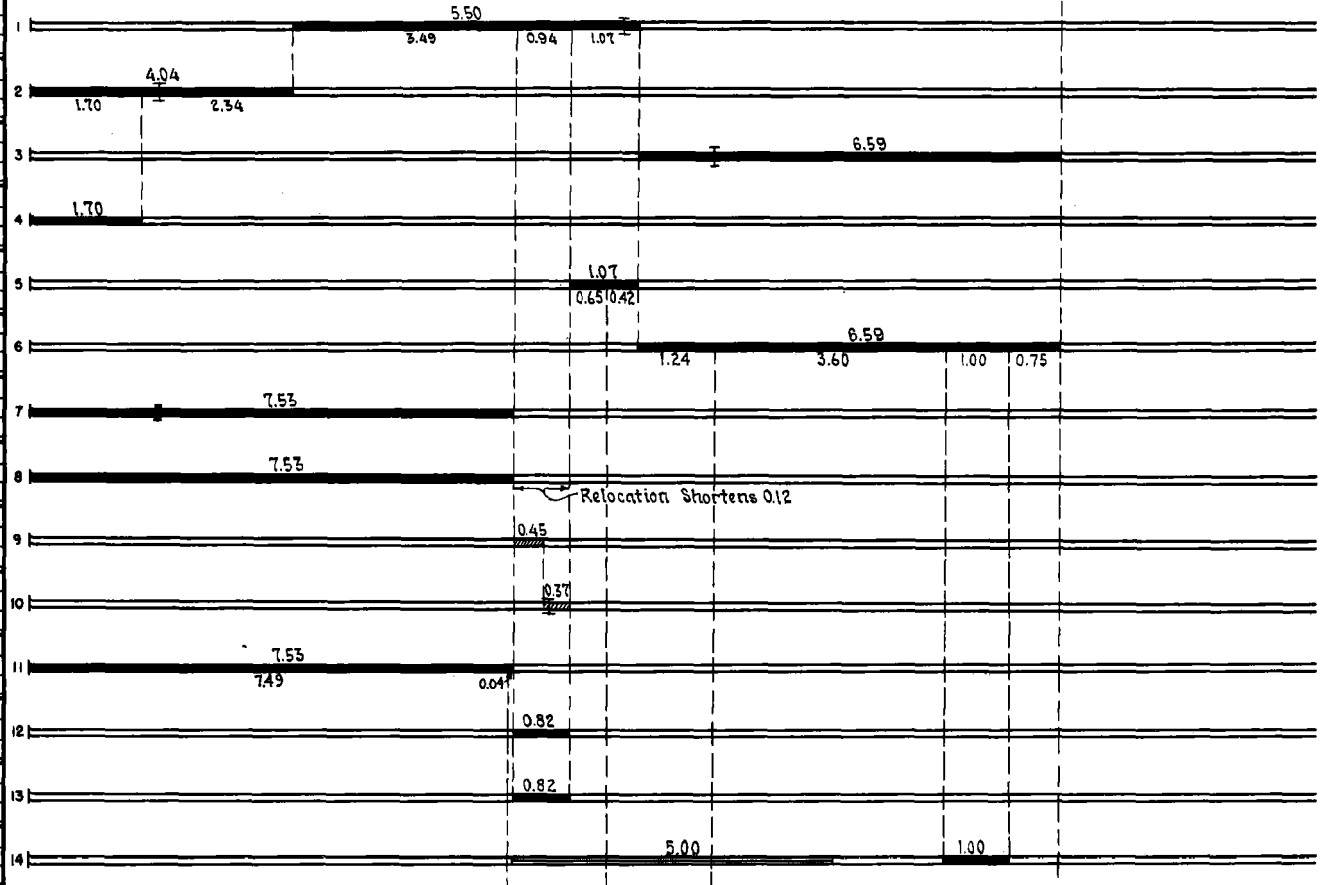

YEARS		TOTAL MILES	UNINCORPORATED		INCORPORATED		RURAL		URBAN	
FROM	TO		RDWY. MI.	BR. MI.	RDWY. MI.	BR. MI.	RDWY. MI.	BR. MI.	RDWY. MI.	BR. MI.
1924	1935	16.13	13.56	0.06	2.47	0.04	13.56	0.06	2.47	0.04
1936	1940	16.01	13.56	0.06	2.33	0.06	13.56	0.06	2.33	0.06
1941	1941	15.93	13.56	0.06	2.24	0.07	13.56	0.06	2.24	0.07
1942		15.95	13.56	0.06	2.24	0.07	13.56	0.06	2.24	0.07

REMARKS: Layout is to scale as of 1936.
(1) Br. 2893 built in 1918. (2) This work not done under these project numbers but lies within the limits of these projects.

PREPARED BY
HIGHWAY PLANNING SURVEY
IN COOPERATION WITH
U.S. PUBLIC ROADS ADMINISTRATION

STATE OF MINNESOTA
DEPARTMENT OF HIGHWAYS
ROAD LIFE STUDIES
CONSTRUCTION PROJECT LOG RECORD

CONTROL SECTION 6301
TRUNK HIGHWAY 32
COUNTY Red Lake
DISTRICT 2B

LIMITS: S. Co. Line - N. Co. Line

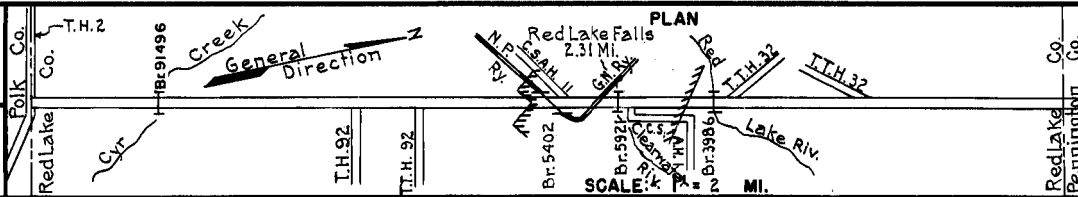

YEAR BUILT	PROJECT N°	DESCRIPTION			CODE N° DIST.
		TYPE	WIDTH	THICKNESS	
C	6103-04	Xing Signals			2040
M	A.F.E. 8	Bit Seal Coat			
					Eml. 3776 Gal./Mi. Agg. 84 C.Y./Mi. Maint. Dept.
C	6301-03	Grading Subor. Treat. Br. 5921	32'0"		1540
					Removed Br. 2893. 240' D.P.G.
C	6301-07	Concrete	32'0"	9-7-9	1641
C	6301-07	Stab. Grav. Base Mixed Bit.	32' 2"		1641
			26'	1"	
C	6301-06	Grading Gravel Subor. Treat.	35'		1541
					Gravel 1700 C.Y./Mi. including salvaged bit material.
C	A.F.E. 7	Seeding			
					Seed supplied by R.S.D. (SP. 6301-14 & 15) Maint. Dept.
C	6301-12	Concrete	26'0"	9-7-9	1147
C	6301-16	Surf. Shoulders			1147
					B' Rt. & Lt.
C	6301-20	Plant Mix Bit. Flume Const. (Mi. Pt. 109)	24'	1 1/2"	3251
C	6301-17	Widen 171' H.T. (Main Span of Br. 3986) to Concrete	27'		1752
			26'7 1/2"	9-7-9	
M	1962	Light Bit Seal	24'		
					RS-2, 12731 Gal. Agg. 464 C.Y.
C	1965	Plant Mix Bit. Gravel Shoulders	24'	3"	1265
					RT-4, Tack 2652 Gal. Bit. Mix 16790 Tons 4' Rt. & Lt.
C	1966	Raise Portals of Br. 3986			
					Increase Vertical Clearance to 16'
M	1967	Light Bit Seal	25'		367
					CRS-1, 16222 Gal. FA-1, Agg. 477 C.Y.

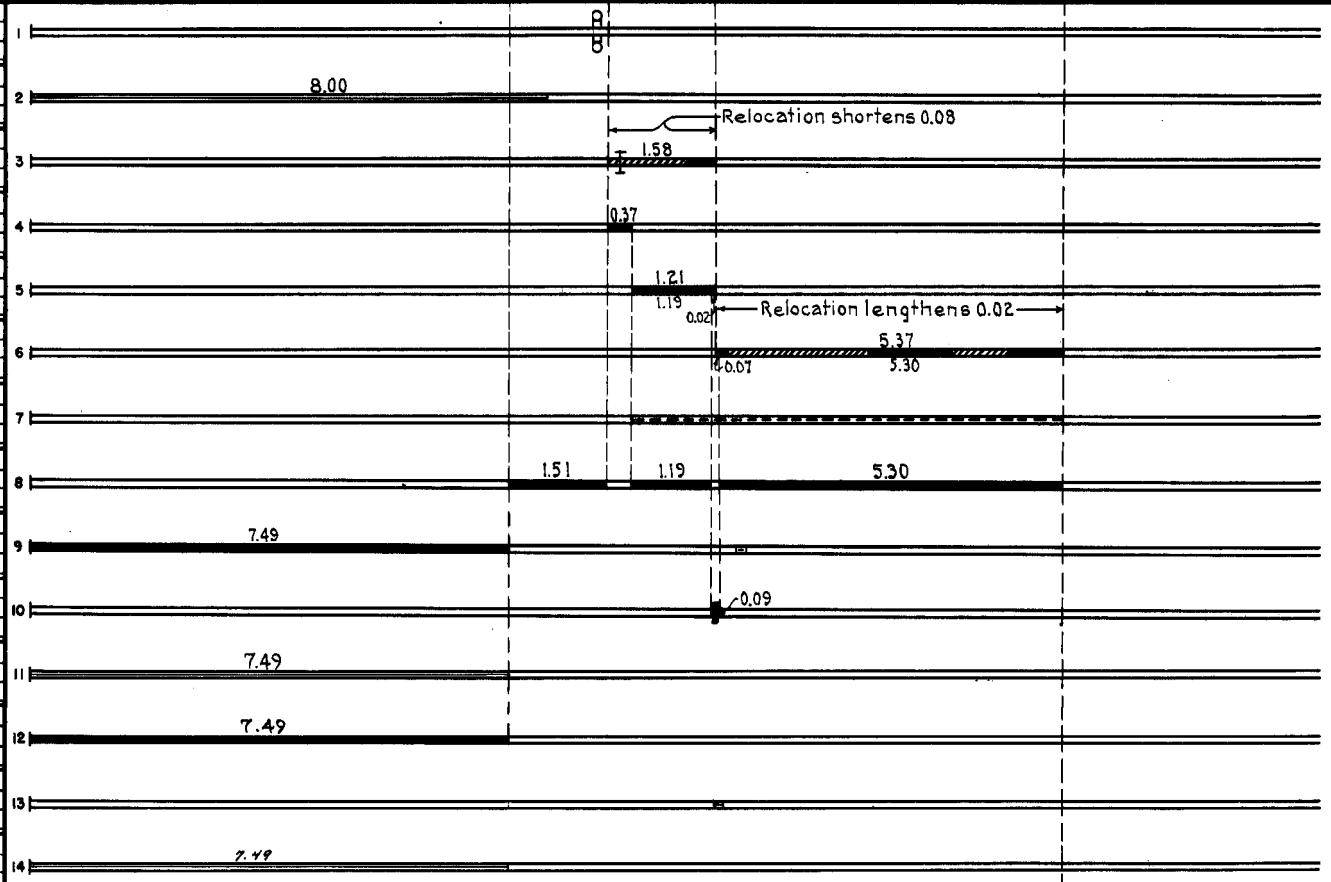

YEARS FROM	TO	TOTAL MILES	UNINCORPORATED		INCORPORATED		RURAL		URBAN	
			ROWY. MI.	BR. MI.	ROWY. MI.	BR. MI.	ROWY. MI.	BR. MI.	ROWY. MI.	BR. MI.

REMARKS: See Sheet N° 1 (D) Contract not final but work substantially complete in 1947.

PREPARED BY
BUREAU OF POLICY & PLANNING
IN COOPERATION WITH
U.S. DEPARTMENT OF TRANSPORTATION-FEDERAL HIGHWAY ADMINISTRATION

STATE OF MINNESOTA
DEPARTMENT OF TRANSPORTATION
CONSTRUCTION PROJECT LOG RECORD

CONTROL SECTION 6301
TRUNK HIGHWAY 32
COUNTY RED LAKE
DISTRICT 2 B

LIMITS: S. Co. LINE — N. Co. LINE

Ref. Pt. 077+00.119 - 093+00.074

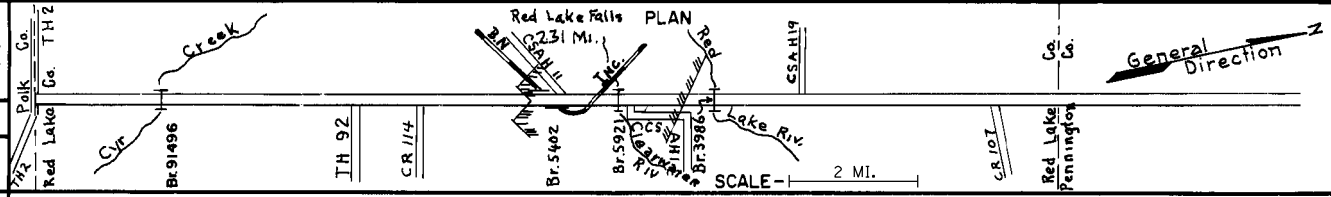

YEAR BUILT	PROJECT NO	DESCRIPTION				REMARKS
		TYPE	WIDTH	THICKNESS		
C	1977 6301-29	Br. 91496				31.3' RCP ARCH Repl. # 3739
C	1979 SF	BIT. SURFACING AGG. SHOULDERS	20' 8'	1 1/2" VAR.		
C	1971 6301-23	PLATE BEAM GUARD RAIL @ BR. 3986				500 LIN. FT.
C	1972 6301-24	PLATE BEAM GUARD RAIL @ BR. 3739				500 LIN. FT.
C	1972 6301-3986	CONC. DECK OVERLAY FOR BR. 3986				
C	1973 6301-25	PAVEMENT WIDENING & STORM SEWER				COOP. AGREE.
M	1977 SF	GRAV. SHOULDER REPAIR	3'			AGG. 2800 TON
C	1977 6301-29	Br. 91496				31.3' RCP-Arch Repl. Br. 3739
C	1979 SF	Bituminous Surfacing Aggregate Shoulders	20' 8'	1 1/2" Var.		
M	1983 SF	Bit. Shoulder Repair	2'	5"		500 Gal. RC 250 Tack 3500 Ton Total for C6301B 5703
M	1984 SF	Bituminous Surfacing	24'	1 1/2"		3800 Ton Sp. 2331
M	1984 SF	Seal Pymt. Joints Joint Repair Crack Repair				25,506 Lbs. 34,579 Lin. Ft. 25,081 Lin. Ft.
C	1984 6301-5921	Widening & Redcking Reconstruction of Approaches				
C	1989 6301-37	Grading Agg. Base Bit. Overlay	44' 43' 24'	Var. Var. 1 1/2"		Class 6 Spec., 2331, 2341

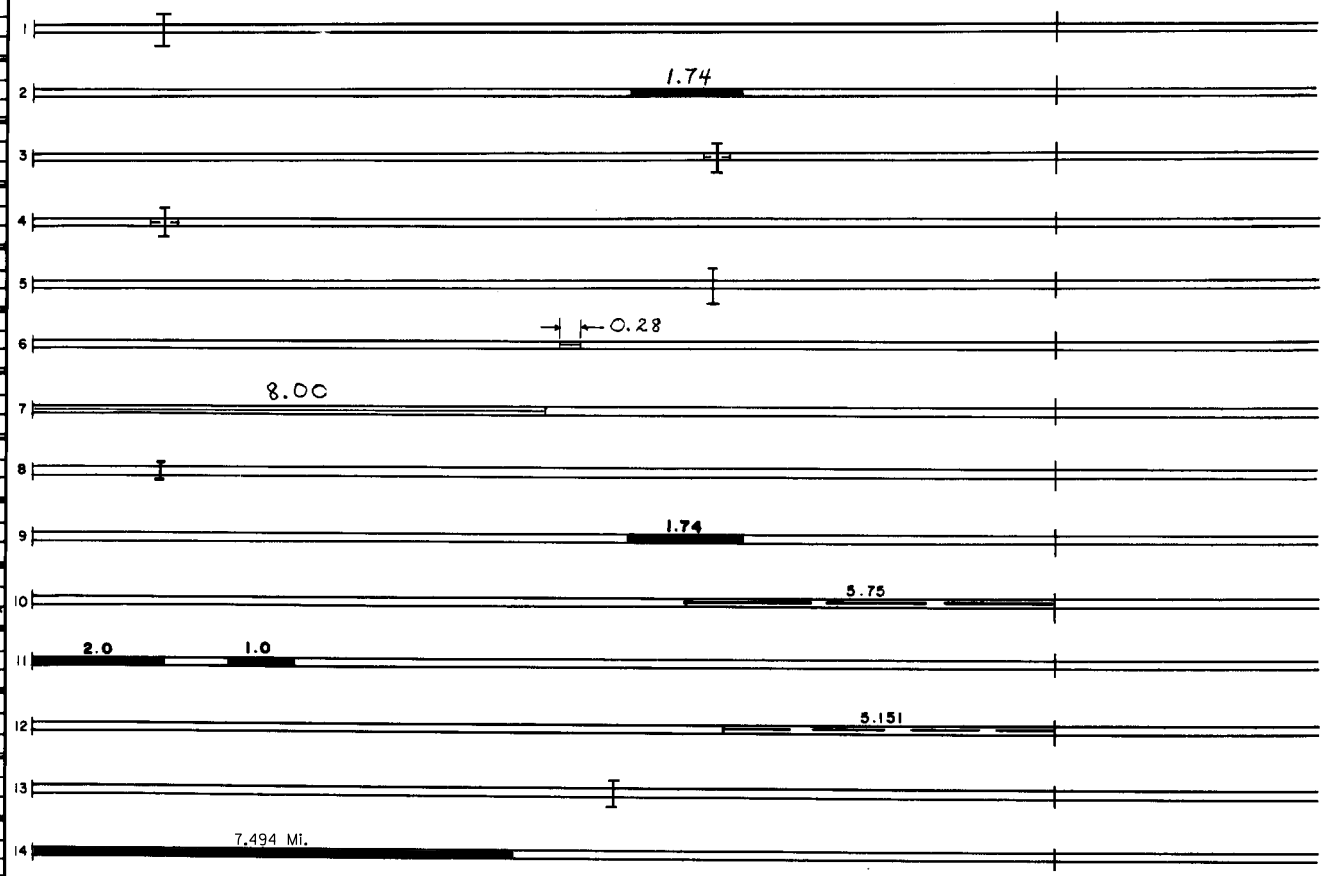

YEARS		TOTAL MILES	UNINCORPORATED		INCORPORATED		RURAL		URBAN	
FROM	TO		RDWY. MI.	BR. MI.	RDWY. MI.	BR. MI.	RDWY. MI.	BR. MI.	RDWY. MI.	BR. MI.

REMARKS: FOR OTHER PROJECTS SEE DIST. NO. 4069, 2471

