

PREPARED BY
HIGHWAY PLANNING SURVEY
IN COOPERATION WITH
U.S. PUBLIC ROADS ADMINISTRATION

STATE OF MINNESOTA
DEPARTMENT OF HIGHWAYS
ROAD LIFE STUDIES
CONSTRUCTION PROJECT LOG RECORD

CONTROL SECTION 7001
TRUNK HIGHWAY 13
COUNTY Scott
DISTRICT 5A

LIMITS: S.Co.Line (Jct.T.H.19) - E.Co.Line (E.Limits of Savage)

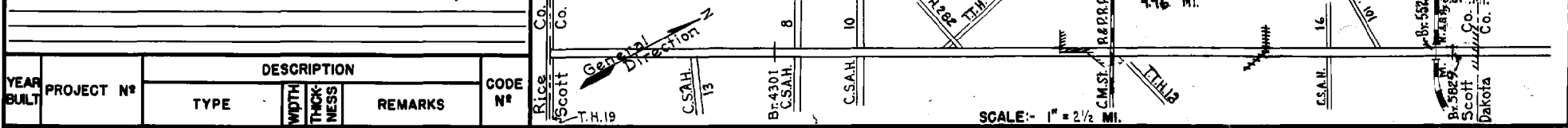

YEAR BUILT	PROJECT NO	DESCRIPTION			CODE NO
		TYPE	WIDTH	THICKNESS	
		Br. 5315	18'		No Record of Const. 112' T.T. - 0.H. Added in 1934.
1923		Gravel	20'	3 1/2"	Co. Job 2307. 1600 C.Y./Mi. Added in 1934.
1923		Grading Gravel Br. 3464	24'	3 1/2"	F.A.P. 93 Added in 1934. 1600 C.Y./Mi. W. 108 D.
1925		Grading Gravel Br. 4301	24'	3 1/2"	Co. Job 2509. Added in 1934. W. 1010 D.
1926		Gravel	20'	3 1/2"	Co. Job 2606. 1600 C.Y./Mi. Added in 1934.
1936		Oil Tr. Gravel	24'	3/8"	6000 Gal./Mi. Maint. Div.
1937		Br. 5315	24'		Rebuild 128' W.P.T.-0.H.
1937	A.F.E. 13	Mixed Bit.	27'	2"	Maint. Div.
1938	A.F.E. 34	Mixed Bit.	30'	1"	Maint. Div.
M 1940	A.F.E. 12 A.F.E. 31	Frost Boil Corr. in Spots & Bit. Retreat.	30'	2"	MG3. 11750 Gal./Mi. Grav. 1231 C.Y./Mi. Maint. Div.
M 1940	A.F.E. 30	Fog Seal	28'		RG4. 1242 Gal./Mi. Sand 36 C.Y./Mi. Maint. Div.
M 1941	A.F.E. 6 A.F.E. 23 A.F.E. 52	Frost Boil Corr. & Spot Treat. Bit. Surf. Repair			SG3. MG3. RT6. 33976/M Grav. 199 C.Y./Mi. Maint. Div.
M 1942	A.F.E. 4	Spot Treat. Bit. Surf. Repair	27'		SG3a. 2162 Gal./Mi. Grav. 88 C.Y./Mi. Maint. Div.
M 1943	A.F.E. 23 A.F.E. 4	Subgrade Treat. Spot Treat. Bit. Surf. Repair	24'		RT-6 & MG2. 13396/Mi. Grav. 399 C.Y./Mi. Maint. Div.

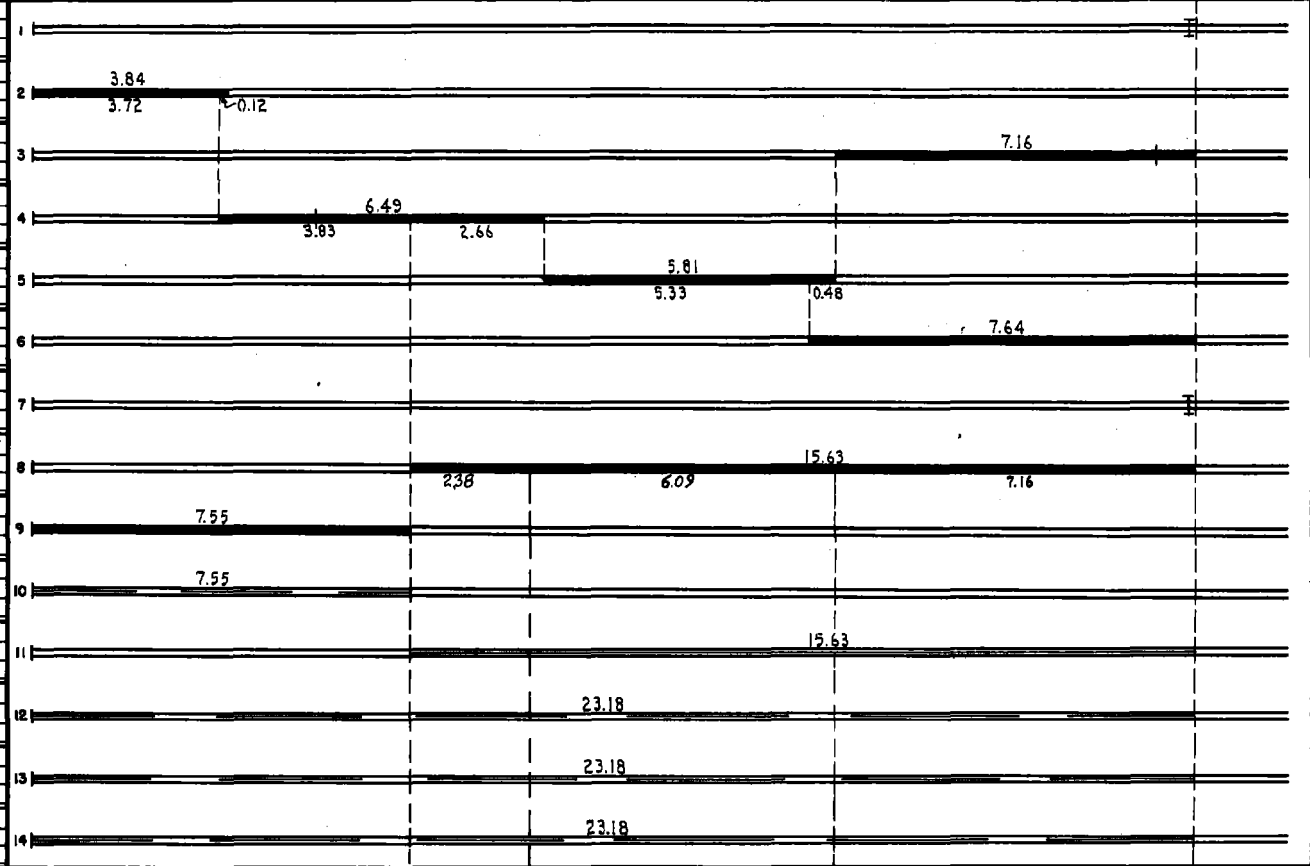

YEARS FROM TO		TOTAL MILES	UNINCORPORATED		INCORPORATED		RURAL		URBAN	
FROM	TO		ROWY. MI.	BR. MI.	ROWY. MI.	BR. MI.	ROWY. MI.	BR. MI.	ROWY. MI.	BR. MI.
1934	1959	23.18	21.24	0.00	1.92	0.02	23.16	0.02	0.00	0.00
1960	1960	23.18	21.06	0.00	2.10	0.02	22.43	0.00	0.73	0.02
1961	1965	22.47	20.71	0.00	1.74	0.02	21.70	0.00	0.75	0.02
1966	1968	22.47	20.40	0.00	2.05	0.02	21.70	0.00	0.75	0.02
1969	1970	22.47	16.35	0.00	6.10	0.02	17.65	0.00	4.80	0.02
1971	1971	22.47	15.36	0.00	7.09	0.02	16.66	0.00	5.79	0.02
1972	1972	22.43	13.88	0.00	8.55	0.02	13.88	0.00	8.53	0.02

REMARKS: Layout is to scale as of 1934

PREPARED BY
HIGHWAY PLANNING SURVEY
IN COOPERATION WITH
U.S. PUBLIC ROADS ADMINISTRATION

STATE OF MINNESOTA
DEPARTMENT OF HIGHWAYS
ROAD LIFE STUDIES
CONSTRUCTION PROJECT LOG RECORD

CONTROL SECTION 7001
TRUNK HIGHWAY 13
COUNTY Scott
DISTRICT 5A

LIMITS: S.Co.Line (Jct T.H.19) - E.Co.Line (E.Limits of Savage)

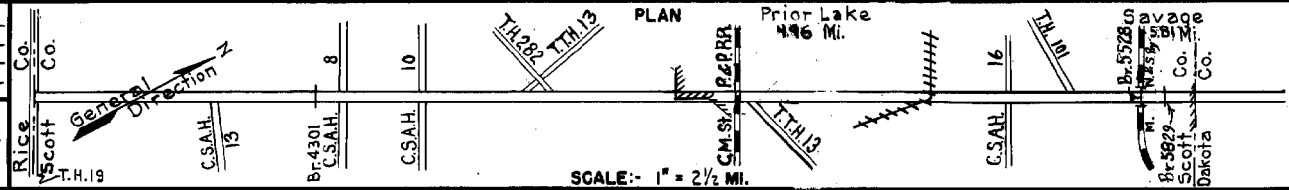

YEAR BUILT	PROJECT N°	DESCRIPTION			CODE N°
		TYPE	WIDTH	THICKNESS	
M 1944	A.F.E.4	Spot Treat Bit.Surf.Repair	24'		
M 1945	A.F.E.4	Spot Treat Bit.Surf.Repair	24'		
M 1946	A.F.E.4	Spot Treat Bit.Surf.Repair &Subgrade.Corr.	24'		
M 1947	A.F.E.4	Spot Treat Bit.Surf.Repair	24'		
M 1948	A.F.E.4	Spot Treat Bit.Surf.Repair	24'		
M 1949	A.F.E.4	Bit.Fog Seal	24'		
M 1950	A.F.E.4	Spot Treat Bit.Surf.Repair	24'		
M 1951	A.F.E.4	Spot Treat Bit.Surf.Repair	22'		
M 1952	A.F.E.4 A.F.E.5	Spot Treat Bit.Surf.Repair Light Bit. Seal			
C 1953	A.F.E.826	Bit.Resurfacing Mixed Bit.	22'	1" added	
M 1953	A.F.E.605	Spot Bit. Seal	24'		
M 1954	A.F.E.605	Light Bit. Seal	22'		
C 1954	A.F.E.824	Bit.Resurfacing Mixed Bit.	22'	1" added	
M 1956	A.F.E.605	Light Bit. Seal	22'		

1	23.18		
2	23.18		
3	15.20 (Net 6.13)		
4	23.18 (Net 8.04)		
5	23.18 (Net 8.35)		
6	15.63		
7	7.97 (Net 5.20)		
8	15.63 (Net 1.90)		
9	23.18 (Net Repair 10.75) (Net Seal 14.73)		
10	7.55		
11	15.63 (Net Seal 7.50)		
12	16.02		
13	7.16		
14	7.16		

YEARS FROM	TO	TOTAL MILES	UNINCORPORATED		INCORPORATED		RURAL		URBAN	
			ROWY. MI.	BR. MI.	ROWY. MI.	BR. MI.	ROWY. MI.	BR. MI.	ROWY. MI.	BR. MI.
1973	1973	22.42	13.87	—	8.55	—	13.87	—	8.55	—
1974	1974	22.42	12.18	—	10.24	—	12.18	—	10.24	—
1974	1975	22.42	11.65	—	10.77	—	11.65	—	10.77	—
1976		22.42	11.65	—	10.77	—	11.65	—	10.77	—

REMARKS: See Sheet N°1

PREPARED BY
HIGHWAY PLANNING SURVEY
IN COOPERATION WITH
U.S. PUBLIC ROADS ADMINISTRATION

STATE OF MINNESOTA
DEPARTMENT OF HIGHWAYS
ROAD LIFE STUDIES
CONSTRUCTION PROJECT LOG RECORD

CONTROL SECTION 7001
TRUNK HIGHWAY 13
COUNTY Scott
DISTRICT 5A

LIMITS: S.Co.Line (Jct.T.H.19) - E.Co.Line (E.Limits of Savage)

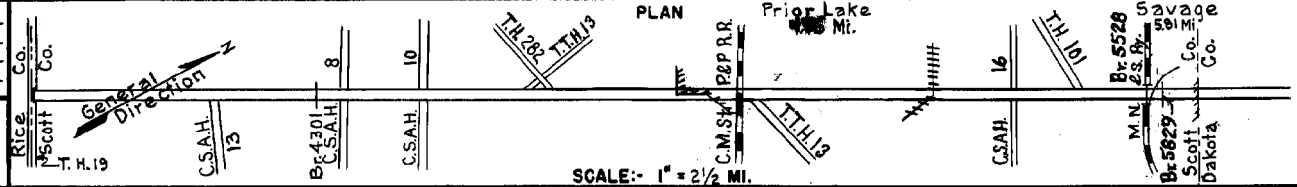

YEAR BUILT	PROJECT N ^o	DESCRIPTION			CODE N ^o
		TYPE	WIDTH	REMARKS	
C&M	A.F.E. 820	Grav.Shldrs.(0.20Mi.)	6' 1 1/2"	Gravel 116 Tons	
1957	A.F.E. 604	Spot Treat		SC-3 19263 Gal.	
		Bit.Surf. Repair	24'	Agg. 1383 Tons	
M	A.F.E. 824	Sub-grade Corr.(Spots)			
1958	A.F.E. 604	Spot Treat		SC-3 22805 Gal.	
		Bit.Surf. Repair	22'	Agg. 1753 Tons	
M					
1960		Bit.Surf. Repair	24'		
C		Grading	55'		
1961	7001-22 & 26	Gravel Base	43' 5"	on 12' sand-grav sub base	
		Road Mix Bit. (Base)	26' 1 1/2"		
C					
1957	7005-26	Plant Mix Bit.	24' 3"		
1957	7001-17 (I)	Plant Mix Bit.	24' 3"	0.66 Mi. Divided Highway	
1938	7001-01	Br. 5829		F106D	
1939	7001-06	Br. 5528	60'	D.P.G. & W.P.T. - U.P.	
C					
1963	7001-23	Plant Mix Bit.	24' 3"		
		Bit Shoulders			
M				11175 Gal.	
1964	C	Bit Seal Coat	Var.	Agg. 468 C.Y.	
1965	C	Bit Seal (10.22 Mi.)	24'		
C		Grading, Select gran.		Divided Highway	
1966	7001-27	Gravel & Bit. Base	Van	Const. on new W.B.	
		Asph. Conc. & Pl. Mix Bit	24' 1 1/2-3"	rdwy. only for 1.32 mi.	
C					
1969	7001-28	Asph. Conc. Surf.	24' 1 1/2"	on E.B. Rdwy.	
		Pl. Mix Bit. Shldrs.		10' out 3' in.	
C					
1973	7001-24 & 29	Grading, Gravel	62'	Divided Highway	
		Bit. Base	17' 1"	Const. for 1.54 mi.	
		Plant Mix Bit	26' 2"		
C					
1972	7001-41	Pl. Mix Resurf.	24' 2"		
		Grav. Shoulders	35'		
C					
1974	7001-40	BIT OVERLAY	24' 2 1/2"	ALL WORK DONE ON W.B. ROADWAY	
		SHLDRS, TURN LANES		EXCEPTION 0.91 MI.	
C					
1979	7001-46	TRAFFIC CONT. SIG. SYS; MISC. GRAD. & SPUR		AT INT. THIS & CANZ. & 13 th AV. COMM. IN PRIOR LAKE	
		RS4031 (T)			

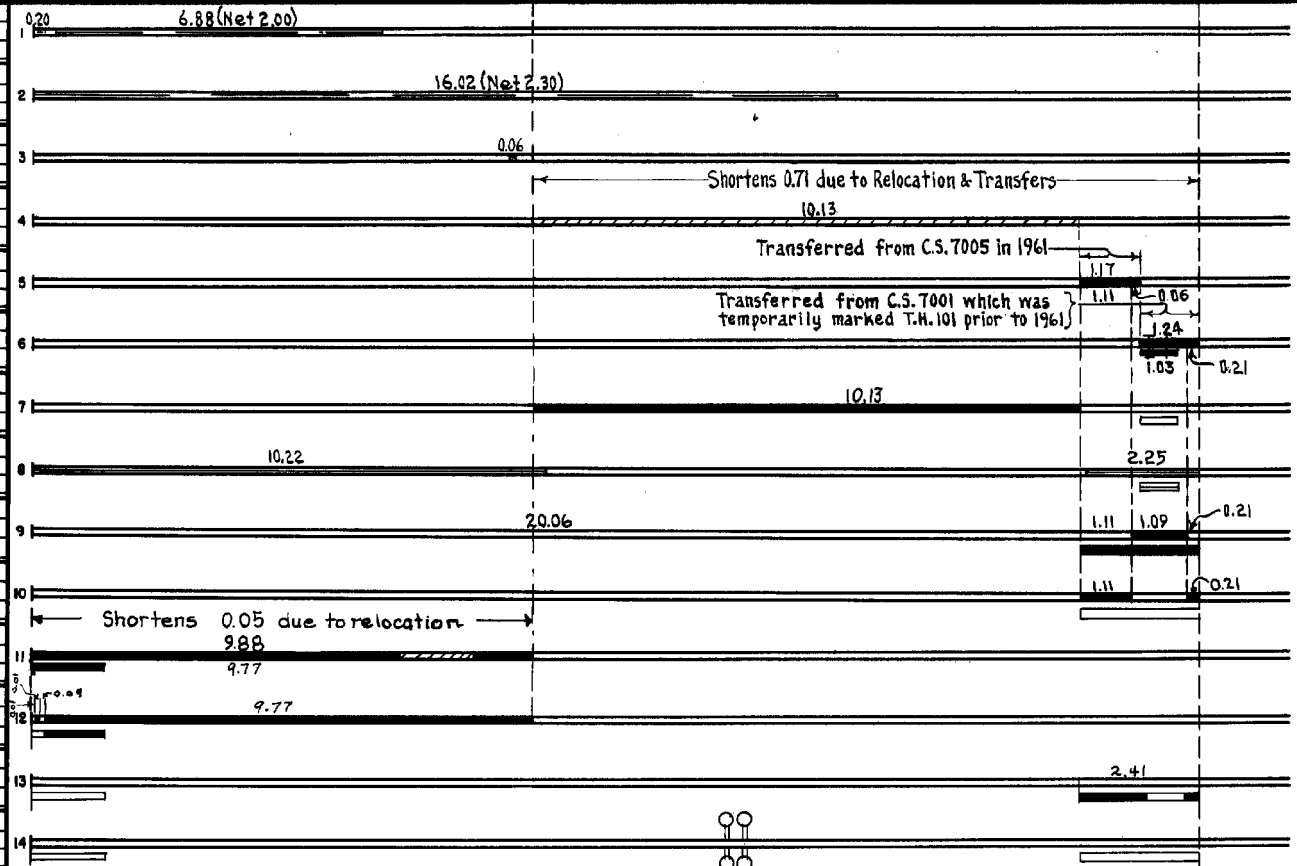

YEARS FROM	TOTAL MILES TO	UNINCORPORATED		INCORPORATED		RURAL		URBAN	
		ROWY. MI.	BR. MI.	ROWY. MI.	BR. MI.	ROWY. MI.	BR. MI.	ROWY. MI.	BR. MI.

REMARKS: See Sheet No. 1
(1) See Sheet A1 of 1 for history on this 1.24 miles.

PREPARED BY
HIGHWAY PLANNING SURVEY
IN COOPERATION WITH
U. S. PUBLIC ROADS ADMINISTRATION

STATE OF MINNESOTA
DEPARTMENT OF HIGHWAYS
ROAD LIFE STUDIES
CONSTRUCTION PROJECT LOG RECORD

CONTROL SECTION 7001
TRUNK HIGHWAY (1) (New 13)
COUNTY Scott
DISTRICT 5A

LIMITS: 0.47 mi. W. of W. Limits of Savage - E. Co. Line (E. Limits of Savage)

PLAN

This portion of T.H. 13 which was temporarily marked T.H. 101 prior to 1961 transferred to regular C.S.

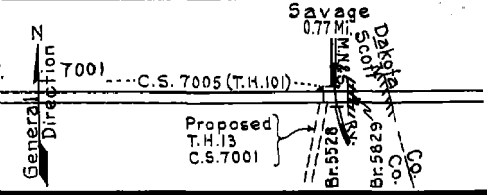

SCALE: 1" = 2 1/2 MI.

YEAR BUILT	PROJECT N ^o	DESCRIPTION			CODE N ^o
		TYPE	WIDTH	THICKNESS	
1938	7001-01	Br. 5829			
					Divided Highway F106D.
1939	7001-02	Grading	38'40"		0.66 Mi. Divided Highway
	7001-08	Gravel	38'40"	8"	
		Br. 5528	60"		D.P.G. & W.P.T.-U.P.
	7001-06				Divided Highway.
1939	7001-10	Roadside Develop.			
C					
1940	7001-03	Seeding			Maint. Div.
	A.F.E. 5				
C					
1940	7001-04	Stab. Gravel	38'40"	2"	0.66 Mi. Divided Highway.
		Bit. Surf. Treat.	26'40"	3/4"	
C					
1941	7001-09	Grading	38'40"		
C					
1941	A.F.E. 9	Seeding			Seed supplied by R.S.D. (S.P. 7001-05) Maint. Div.
C					
1942	A.F.E. 22	Gravel Liff.			SC 3 RT 2, 16539 G./M.
	A.F.E. 20	Mixed Bit.			Grav. 2327 C.Y./Mi. Maint. Div.
	(C.S. 1901)				
M					
1942	A.F.E. 5	Bit. Seal Coat	38'40"		RC-3, 5102 Gal./Mi. Sand 188 C.Y./Mi. Maint. Div.
M					
1947	A.F.E. 4	Bit. Fog Seal			RC-2, 3097 Gal. Sand 26 C.Y.
C					
1949	7001-15	Bit. Resurfacing	24'58"	1 1/2"	
	(2)	Plant Mix Bit.		added	
M					
1954	A.F.E. 605	Light Bit. Seal	26'52"		R52, 3995 Gal. Agg. 155 C.Y.
C					
1957	7001-17	Bit. Resurfacing	24'52"	3"	
		Plant Mix Bit.		added	

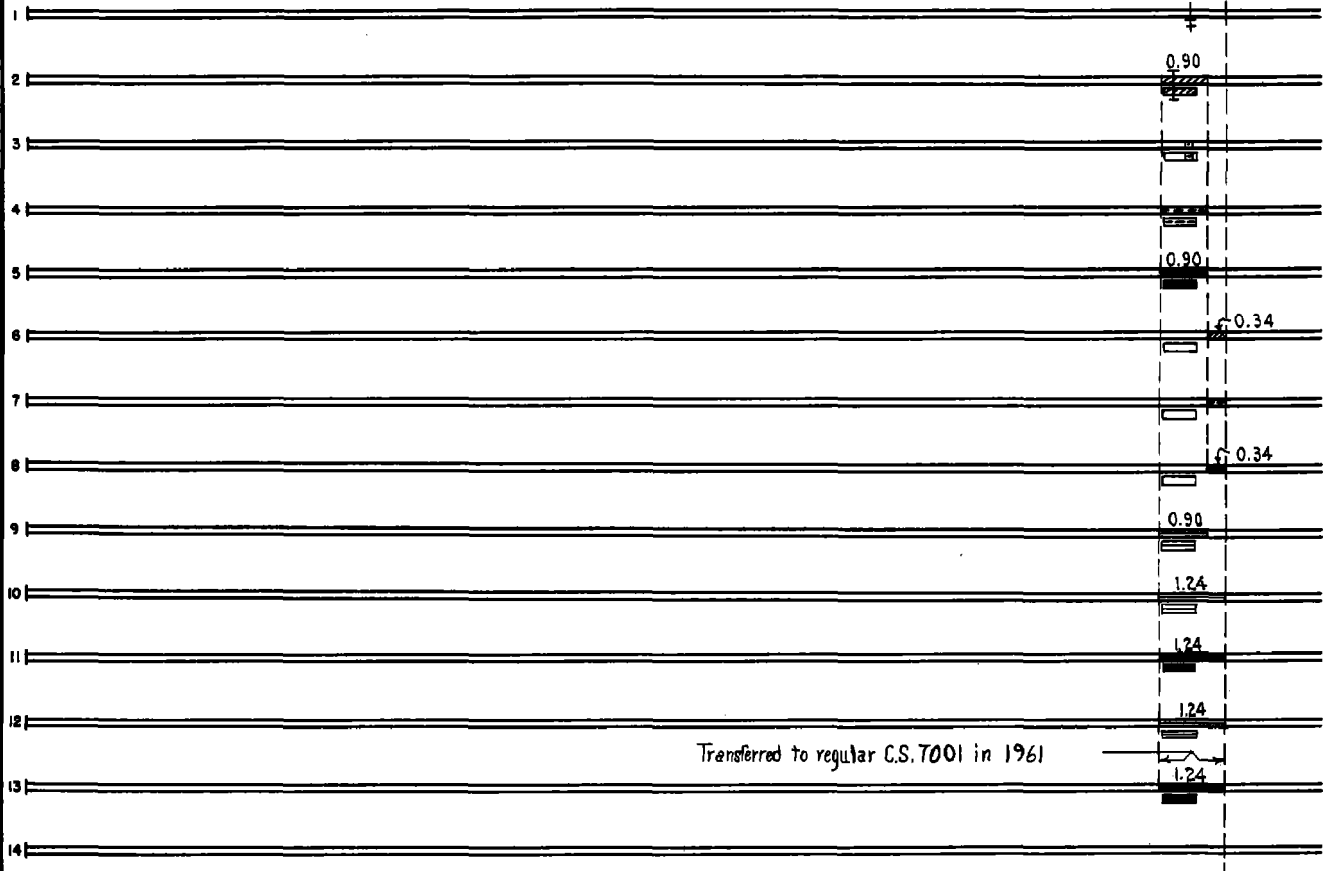

Transferred to regular C.S. 7001 in 1961

YEARS		TOTAL MILES	UNINCORPORATED		INCORPORATED		RURAL		URBAN	
FROM	TO		RDWY. MI.	BR. MI.	RDWY. MI.	BR. MI.	RDWY. MI.	BR. MI.	RDWY. MI.	BR. MI.
1941	1960	1.24	0.47	0.00	0.77	0.00	1.24	0.00	0.00	0.00
1960	1960	1.24	0.47	0.00	0.77	0.00	0.47	0.00	0.77	0.00
1961		0.00	0.00	0.00	0.00	0.00	0.00	0.00	0.00	0.00

REMARKS: Layout is to scale as of 1941
(1) This new construction not in use as T.H. 13 until project connecting T.H. 13 & T.H. 101 west of Savage is built. This 1.24 miles is marked temporarily as T.H. 101. Maint. costs assembled as T.H. 13 (2) Contract not final but work substantially complete in 1949.

PREPARED BY
BUREAU OF POLICY & PLANNING
IN COOPERATION WITH
U. S. DEPARTMENT OF TRANSPORTATION - FEDERAL HIGHWAY ADMINISTRATION

STATE OF MINNESOTA
DEPARTMENT OF TRANSPORTATION
CONSTRUCTION PROJECT LOG RECORD

CONTROL SECTION 7001
TRUNK HIGHWAY 13
COUNTY Scott
DISTRICT Metro

LIMITS: S. Co. Line (Jct. T.H. 19) - E. Co. Line (E. Lim. Savage)
Ref. Pt. 070+00.745 - 093+00.371

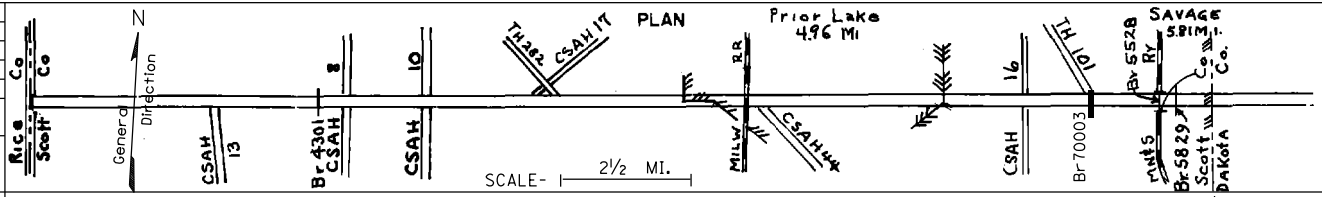

YEAR BUILT	PROJECT No	DESCRIPTION			
		TYPE	WIDTH	THICKNESS	REMARKS
C	7001-104	Grading Bit. Pavement	var.	4" wear, 2" nonwear	Spec. 2360
C	7001-105	Grading Bit. Mill 2" & Overlay & shldr 3' Lt, 10' Rt	24'	2"-4" var. widening bit. pvt 9" 2"-4"	
C	7001-116	Grading Bit. Mill 4" & Overlay	var.	5/8" wear & 5/8" UTBWC 3/2"	
C	7001-115	Grading Milling 1 1/2" - 5" Bit. Surf. Full Depth Reclamation	var.	4 1/2" UTBWC 5/8" 8"	Bit. patching

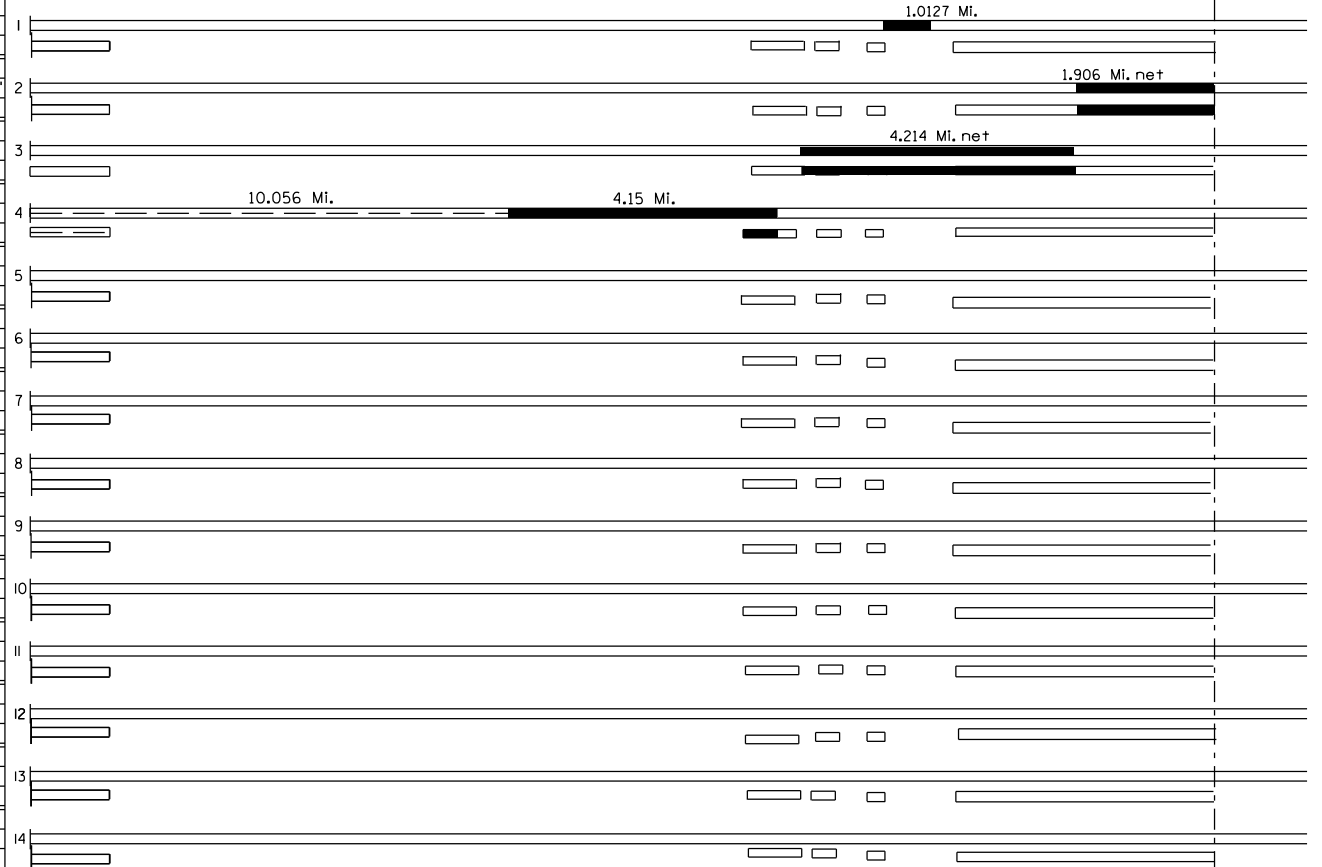

YEARS FROM TO		TOTAL MILES	UNINCORPORATED RDWY. MI. BR. MI.		INCORPORATED RDWY. MI. BR. MI.		RURAL RDWY. MI. BR. MI.		URBAN RDWY. MI. BR. MI.	

REMARKS: