

# BICYCLE MAP CASS COUNTY MINNESOTA

PREPARED BY THE  
MINNESOTA DEPARTMENT OF TRANSPORTATION  
OFFICE OF TRANSPORTATION SYSTEM MANAGEMENT

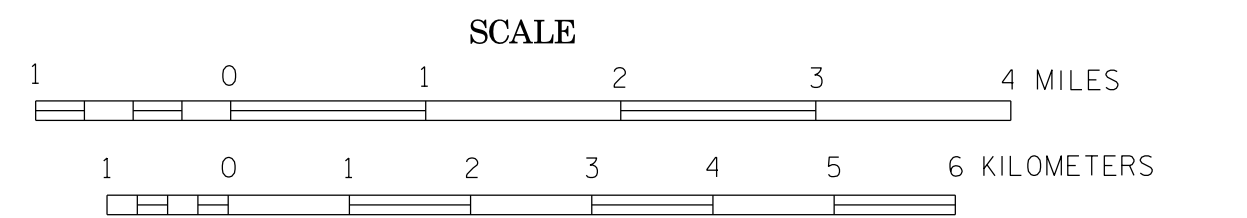

2016  
BASIC DATA - 2015

Projection: Minnesota Coordinate System  
Central Line  
Lambert Conformal Conic  
North American Datum of 1983

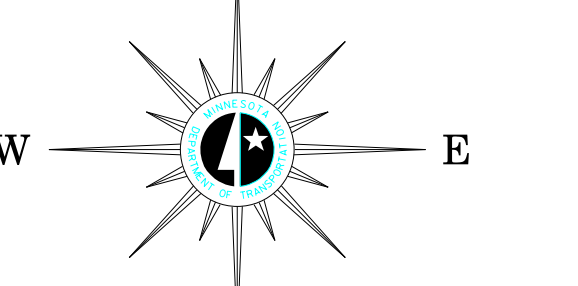

## LEGEND

- |  |  |   |
|--|--|---|
| (Roadways with shoulders less than 4 feet) | 0-750 (Fewer than 3 cars / min)            | (Roadways with shoulders greater than 4 feet) |
| Yellow line                                | 751-2500 (3 cars / min)                    | Orange line                                   |
| Red line                                   | 2501-10,000 (12 cars / min)                | Dark red line                                 |
| Dark red line                              | 10,000+ (24+ cars / min)                   | Black line                                    |
| Green line                                 | Gravel Roadway                             | Green line                                    |
| Blue line                                  | Federal, State and Regional Bicycle Trails | Blue line                                     |
| Light blue line                            | Mississippi River Trail                    | Light blue line                               |
| Dark blue line                             | Interstate / Bicycles Prohibited           | Dark blue line                                |
| Light green area                           | State or National Forests                  | Light green area                              |

## ROAD AND ROADWAY FEATURES

- PROJECTED ROAD
- PRIMITIVE ROAD
- UNIMPROVED ROAD
- GRADED AND DRAINED ROAD
- SOIL SURFACE ROAD
- GRAVEL OR STONE ROAD
- BITUMINOUS ROAD
- PAVED ROAD
- DIVIDED ROAD
- TRUNK HIGHWAY UNDER CONSTRUCTION
- ROADS IN UNINCORPORATED COMPACTS, EXTENSIONS OF LOCAL ROADS NOT F.A.S. WITHIN MUNICIPALITIES AND FRONTAGE ROADS
- GRADE SEPARATION
- FULL TRAFFIC INTERCHANGE
- PARTIAL TRAFFIC INTERCHANGES INDICATING TRAFFIC MOVEMENT

## ROAD SYSTEM DESIGNATIONS

- INTERSTATE TRUNK HIGHWAY
- U.S. NUMBERED TRUNK HIGHWAY
- STATE NUMBERED TRUNK HIGHWAY
- COUNTY STATE AID HIGHWAY
- COUNTY ROAD
- COUNTY STATE AID IN ADJOINING COUNTY
- TERMINATION OF DESIGNATED ROUTE

## BOUNDARIES

- NATIONAL OR STATE
- COUNTY
- CIVIL TOWNSHIP
- CONGRESSIONAL TOWNSHIP (U.S. LAND)
- CORPORATE LINE
- SECTION LINE
- CONGESTED AREA
- INDIAN RESERVATION

## DRAINAGE

- INTERMITTENT STREAM
- NARROW STREAM
- WIDE STREAMS
- MARSH OR SWAMP LAND
- DRAINAGE DITCH
- LAKE OR POND

## CITY CENTERS

- STATE CAPITAL
- COUNTY SEAT
- CITY CENTER
- INCORPORATED CITY (GENERALIZED)

Outline Map of Minnesota showing location of the County within the State.  
Shaded portion is area depicted on this sheet.  
Area of this County 2422 Sq. Miles  
Land Area 2033 Sq. Miles  
2010 Total County Population 28,467

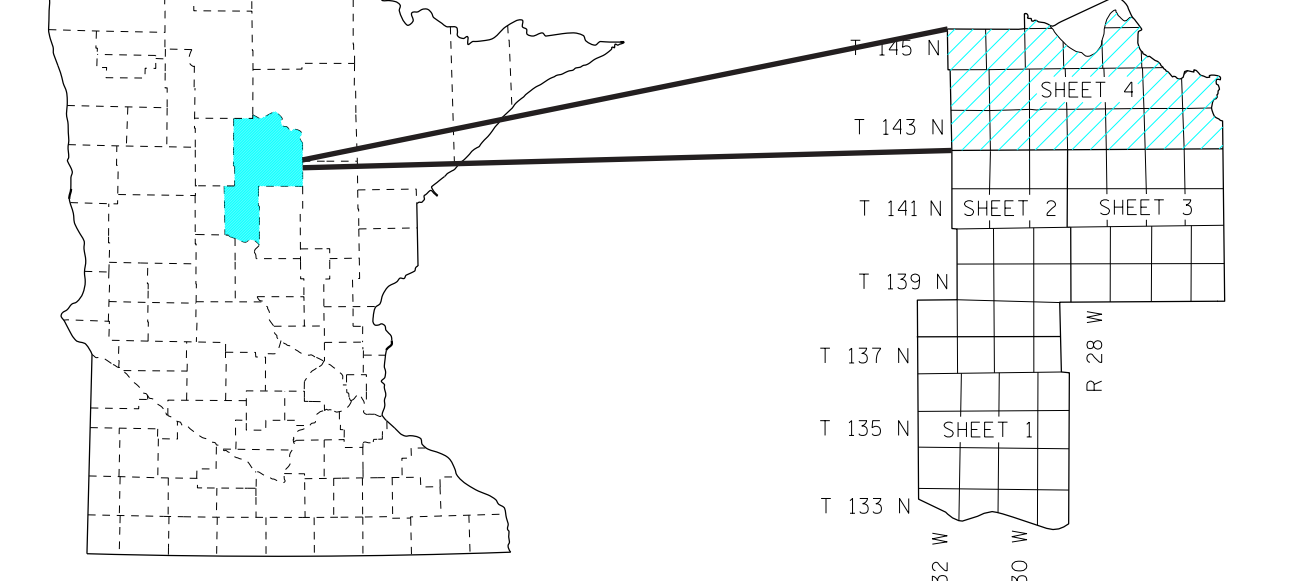

NOTE: FOR DETAIL OF COUNTY STATE AID HIGHWAYS AND COUNTY ROADS IN INCORPORATED PLACES, SEE MAPS OF MUNICIPALITIES.