

PREPARED FOR:
MN DOT

* Do not scale drawing-work to dimensions
* All tolerances +/- 1/64" unless otherwise noted

BILL OF MATERIALS

①	SB8-CTWA48-G	A500 GR. B TUBE, A572 PLATE ZINC A153	1 each
②	SB8C-250A-G	DUCT. IRON CLASS 65-45-12, GAL. ASTM A153	1 each
③	LWX35F-G	STEEL FORGING SAE 1035, GAL. ASTM A153	1 each
④	RTSB-MPHDW	1/2"-13 GRADE 8 HARDWARE GAL. B695	1 kit

③ POST LOCKING WEDGE

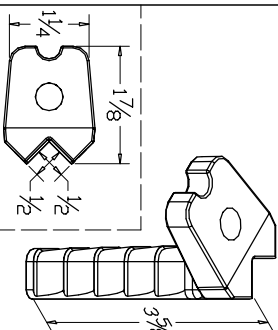

② 2-1/2" SQUARE POST RECEIVER

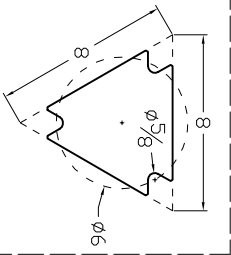

① UNIBASE DIRECT DRIVE ANCHOR STUB

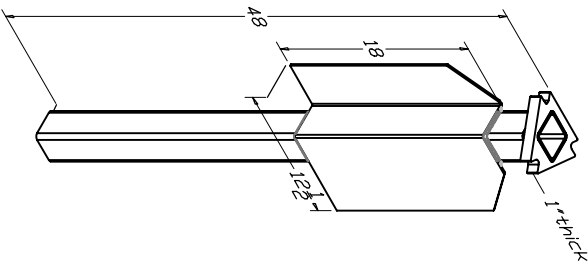

REDI-TORQUE SLIP BASE MATCH PLATE HARDWARE KIT

RTB50-300-G 1/2"-13 X 3" GRADE 8 DOUBLE HEX REDI-TORQUE BOLT, MECHANICAL GALV. PER ASTM B695 (3 EACH PER KIT)	FW58-G 5/8" U.S.S. FLAT WASHER ANSI B 18.22.1, TYPE A WIDE, MECHANICAL GALV. PER ASTM B695 (6 EACH PER KIT)	TCS175-188 1-3/4" SQUARE X 3/16" THICK TEFLON COATED, HARDENED SLIP WASHER (3 EACH PER KIT)	G8L FN50-Z 1/2"-13 GRADE 8 LARGE FLANGE NUT MECHANICAL GALV. PER ASTM B695 (3 EACH PER KIT)
--	--	---	---

GENERAL NOTES

- UNIBASE MAY BE DRIVEN DIRECTLY INTO SOIL WITHOUT A CONCRETE FOOTING.
- SECURE SIGN SUPPORT TO POST RECEIVER WITH USE OF DRIVEABLE LOCKING WEDGE TO ELIMINATE ALL TOLERANCE BETWEEN POST AND COUPLER WITHOUT THE NEED FOR THREADED FASTENERS.
- ALL COMPONENTS OF ORIGINAL INSTALLATION SHALL BE REUSABLE WITH THE EXCEPTION OF THE REDI-TORQUE BOLT.
- BRASS SHIMS MAY BE USED BETWEEN SLIP PLATES TO LEVEL THE UPPER SLIP PLANE.
- MUST BE FHWA ACCEPTED, MEETING CURRENT AASHTO & NCHRP 350 REQUIREMENTS.

INSTALLATION PROCEDURES

- INSTALL UNIBASE PLUMB AND SQUARED UP WITH ROAD. THE POINT CENTERED ON THE FLAT SIDE OF TUBE SHALL FACE ONCOMING TRAFFIC.
- DEPTH OF IMBEDMENT TO LEAVE 2-1/2" FROM GRADE TO TOP OF UNIBASE SLIP PLATE.
- PLACE 1 EACH TEFLON COATED SLIP WASHER ON EACH OF THE THREE NOTCHED POINTS OF THE UNIBASE, POSITIONED SO THAT THE OPENING OF THE SLOT IS FACING THE CENTER OF THE TRIANGLE.
- PLACE THE TOP POST RECEIVER ONTO THE UNIBASE AND SLIP WASHERS SO THAT THE SIGN POST IS IN THE CORRECT POSITION FOR OPTIMAL SIGN VISIBILITY.
- PLACE 1 EACH 5/8" FLAT WASHER ONTO REDI-TORQUE BOLT AND PLACE IN EACH NOTCHED POINT OF THE TRIANGLE. SLIDE 1 EACH 5/8" FLAT WASHER ONTO THE BOLT, FOLLOWED BY THE 1/2" FLANGE NUT ON THE UNDERSIDE OF THE BOTTOM SLIP PLATE. PUSH EACH TEFLON COATED SLIP WASHER AGAINST THE SHANK OF EACH BOLT.
- FULLY TIGHTEN ALL THREE REDI-TORQUE BOLTS, USING THE SMALLER 9/16" HEX HEAD, UNTIL THE UPPER HEX SEPARATES FROM THE LOWER HEX.
NOTE: THE UPPER HEX (9/16") HEAD WILL SEPARATE AT THE DESIRED TORQUE LEVEL TO MEET FEDERAL COMPLIANCE.
- INSERT THE SIGN SUPPORT INTO THE SQUARE PORTION OF THE POST RECEIVER AND SECURE WITH DRIVEABLE LOCKING WEDGE.

*WHERE HIGHER WINDLOAD IS DESIRED, INSERT A 2-3/16" X 10 GA. SQUARE POST INSIDE THE 2-1/2" X 10 GA. SQUARE POST SO THAT THE BOTTOMS OF BOTH POSTS ARE FLUSH.

*ON MULTI-LEG INSTALLATIONS, BE SURE THAT ALL UNIBASES ARE SQUARED AND LINED UP WITH EACH OTHER UNIBASE.

FINISH Hot Dip Galvanize per ASTM A153	DRAWN BY MEL	WEIGHT 62 lbs.
DISCRIPTION REDI-TORQUE MODEL 280 SLIP BASE FOR 2-1/2" SQUARE X 10 GA. POST; DIRECT DRIVE SOIL INSTALLATIONS	Rev A	4-22-13
DWG# RT8UX-25C48W-G	Original	5-28-08

Description of Revision (Supersedes Previous Drawing)

4-22-13
bolt length from 2-3/4" to 3", 1/2" flat washer to 5/8", hardware zinc B633 to B695, locking wedge from ductile iron to forged steel, thickened walls & added gussets to post receiver.

COMPLETE ASSEMBLY

